



RECALL CAMPAIGN BULLETIN

Reference:

NTB16-004

Date:

January 7, 2016

VOLUNTARY RECALL CAMPAIGN 2015 ROGUE SHIFT SELECTOR KNOB

CAMPAIGN ID #: PC415**APPLIED VEHICLE:** 2015 Rogue (T32)**Check Service COMM to confirm campaign eligibility.**

INTRODUCTION

Nissan is conducting a Voluntary Recall Campaign on certain 2015 Rogue vehicles to inspect the shift selector knob and if necessary replace the shift selector knob. This service will be performed at no cost to the customer for parts or labor.

IDENTIFICATION NUMBER

Nissan has assigned identification number PC415 to this campaign. This number must appear on all communications and documentation of any nature dealing with this campaign.

DEALER RESPONSIBILITY

It is the dealer's responsibility to check Service Comm for the campaign status on each vehicle falling within the range of this voluntary recall which for any reason enters the service department. This includes vehicles purchased from private parties or presented by transient (tourist) owners and vehicles in a dealer's inventory. **Federal law requires that new vehicles in dealer inventory which are the subject of a safety recall must be corrected prior to sale. Failure to do so can result in civil penalties by the National Highway Traffic Safety Administration.** While federal law applies only to new vehicles, Nissan strongly encourages dealers to correct any used vehicles in their inventory before they are retailed.

Nissan Bulletins are intended for use by qualified technicians, not 'do-it-yourselfers'. Qualified technicians are properly trained individuals who have the equipment, tools, safety instruction, and know-how to do a job properly and safely. **NOTE:** If you believe that a described condition may apply to a particular vehicle, DO NOT assume that it does. See your Nissan dealer to determine if this applies to your vehicle.

SERVICE PROCEDURE

Removal

1. Apply the parking brake.
2. Pull DOWN the shift selector knob cover (chrome finisher).
3. Remove the retaining clip using a suitable tool.
4. Pull the shift selector knob UP to remove it.

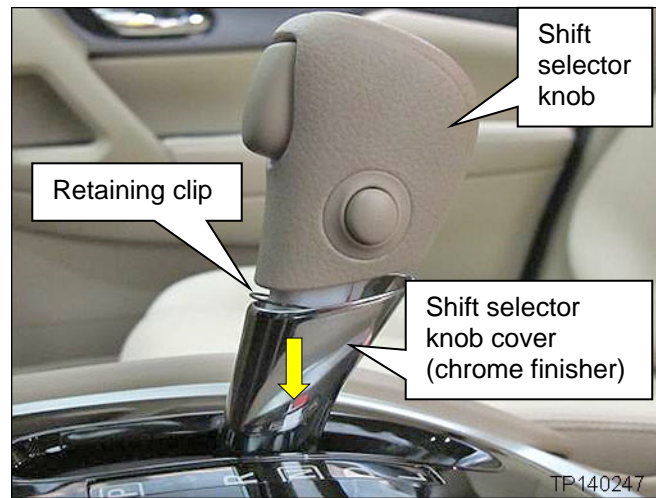

Figure 1

5. Inspect the front of the shift selector knob shaft for the number "2" (Figure 2).
NOTE: The number is very small and hard to see. A magnifying glass may be helpful.
6. Is the number 2 present?
 - No: Replace the shift selector knob with new part.
 - Yes: Inspection is complete and no replacement is required.

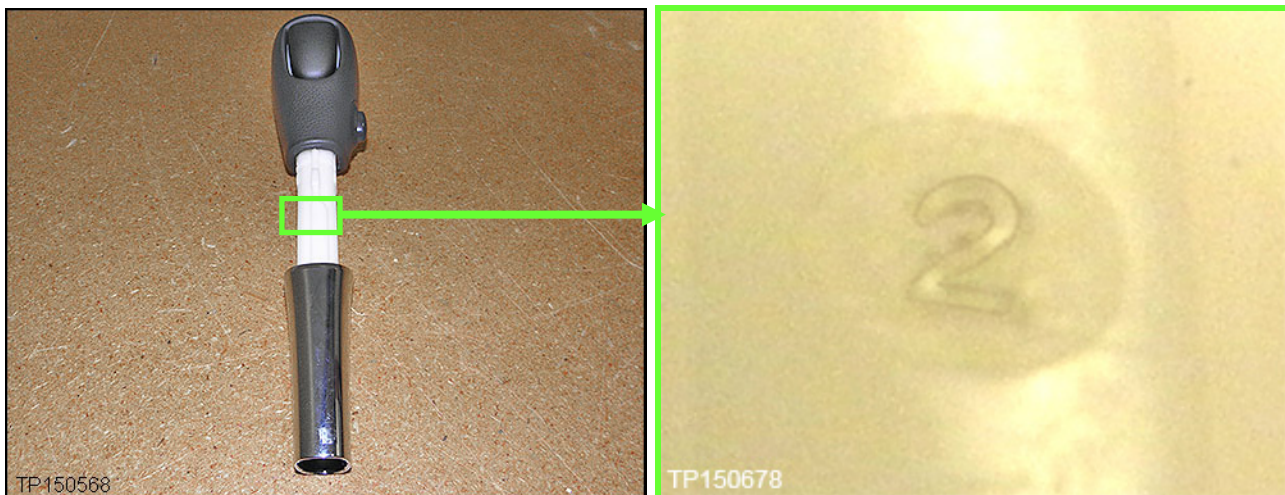

Figure 2

Installation

1. Confirm that the new part has the blue mark shown in Figure 3 and/or the black mark shown in Figure 4.



Figure 3



Figure 4

2. Make sure the retaining clip is installed on the shift selector knob.
3. Slide the chrome finisher up and snap in place.

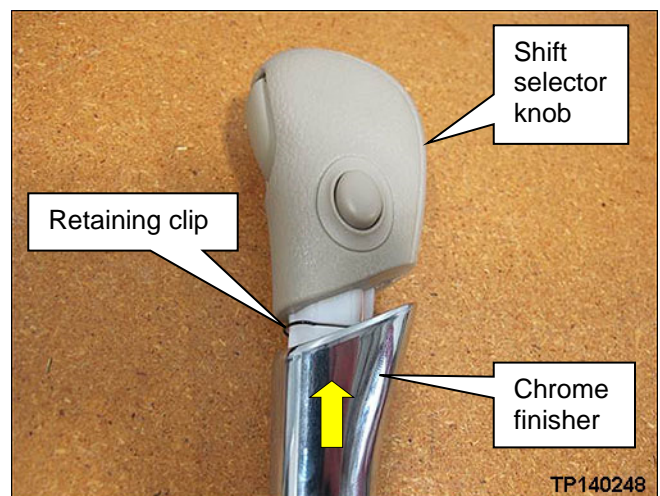

Figure 5

4. Use a pick tool to pull out the shift selector knob button, and hold it out.
5. While holding the button out, slide the shift selector knob onto the shift shaft until you feel it click into place.
6. Release the shift selector knob button.
7. Pull UP on the shift selector knob to make sure it is locked in place, and does not come off.



Figure 6

NOTE: If the block and spring are removed when removing shifter knob, refer to Appendix A for installation instructions.

Appendix A

Block-pull and Spring Installation

With the shift selector knob removed, the block-pull and spring will be exposed.

If for any reason the block-pull and spring are removed as shown in Figure 8:

- **DO NOT** replace the entire shifter assembly if the block-pull and spring have been removed.
- Make sure they are reinstalled correctly, as shown in Figure 7.
- The opening at the bottom of the block-pull must be aligned with the slot on the shift shaft as shown in Figure 7.
- Figure 8 shows the block-pull and spring removed.

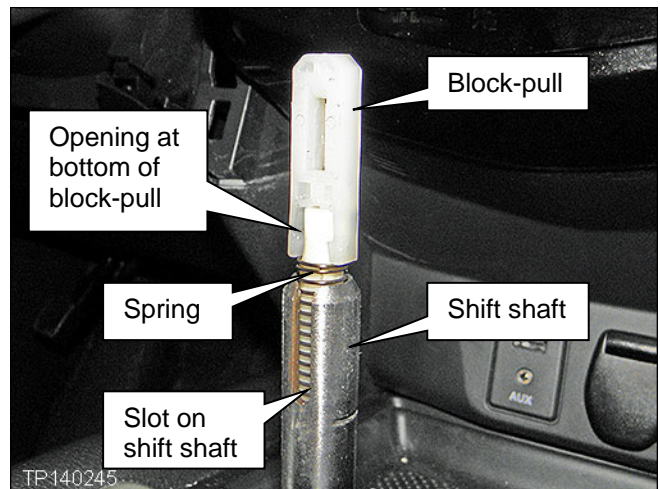

Figure 7

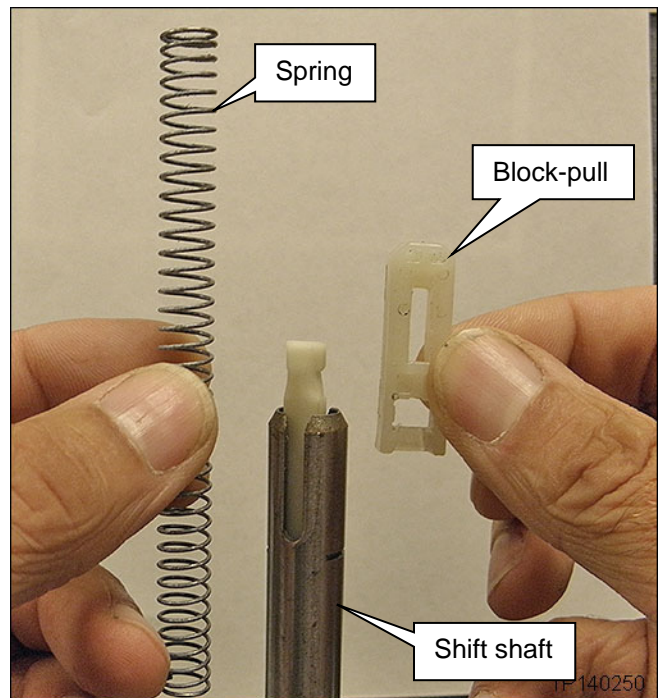

Figure 8

PARTS INFORMATION

DESCRIPTION	COLOR	MATERIAL	PART NUMBER	QUANTITY
SHIFT SELECTOR KNOB	G (Charcoal)	Leather (1)	34910-4BA1A	1
		Vinyl (2)	34910-4BA1C	1
	C (Almond)	Leather(1)	34910-4BA1B	1
		Vinyl (2)	34910-4BA1D	1

(1) Leather shift selector knob shown in Figure 9.

(2) Vinyl shift selector knob shown in Figure 10 with simulated seam.

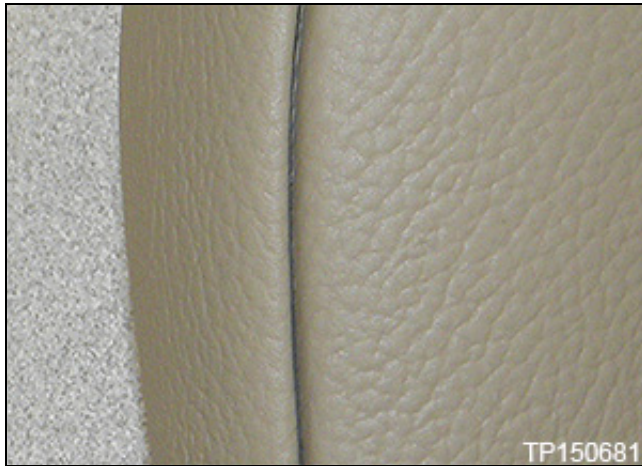

Figure 9

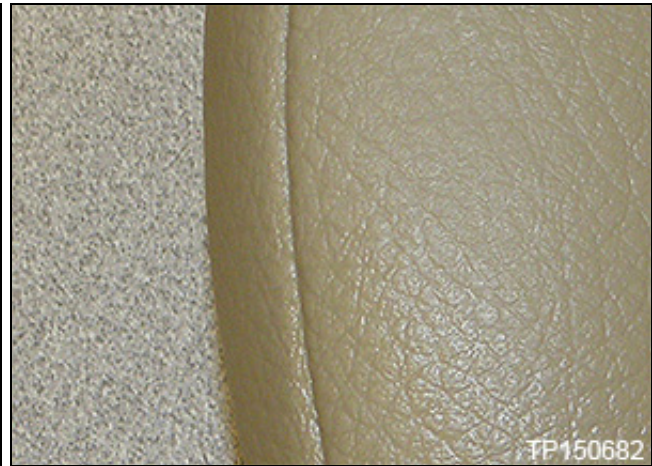

Figure 10

CLAIMS INFORMATION

Submit a Campaign (CM) line claim using the following claims coding:

CAMPAIGN (“CM”) ID	DESCRIPTION	OP CODE	FRT
PC415	Inspect Shift Selector Knob	PC4150	0.2 hrs.