



---

# RECALL CAMPAIGN BULLETIN

---

Reference:

NTB15-074

Date:

August 17, 2015

---

## VOLUNTARY SAFETY RECALL CAMPAIGN 2015 ARMADA FRONT SEAT BELT BUCKLE

**CAMPAIGN ID #:** PC385

**APPLIED VEHICLES:** 2015 Armada (TA60)

**Check Service COMM to confirm campaign eligibility.**

### INTRODUCTION

Nissan is conducting a Voluntary Safety Recall Campaign on certain 2015 Armada vehicles to inspect both front seat belt buckles and if necessary replace them at no charge to customers for parts or labor.

### IDENTIFICATION NUMBER

Nissan has assigned identification number PC385 to this campaign. This number must appear on all communications and documentation of any nature dealing with this campaign.

### DEALER RESPONSIBILITY

It is the dealer's responsibility to check Service Comm for the campaign status on each vehicle falling within the range of this voluntary safety recall campaign which for any reason enters the service department. This includes vehicles purchased from private parties or presented by transient (tourist) owners and vehicles in a dealer's inventory. **Federal law requires that new vehicles in dealer inventory which are the subject of a safety recall must be corrected prior to sale. Failure to do so can result in civil penalties by the National Highway Traffic Safety Administration.** While federal law applies only to new vehicles, Nissan strongly encourages dealers to correct any used vehicles in their inventory before they are retailed.

Nissan Bulletins are intended for use by qualified technicians, not 'do-it-yourselfers'. Qualified technicians are properly trained individuals who have the equipment, tools, safety instruction, and know-how to do a job properly and safely. NOTE: If you believe that a described condition may apply to a particular vehicle, DO NOT assume that it does. See your Nissan dealer to determine if this applies to your vehicle.

## SERVICE PROCEDURE

1. Open the door on the side of the seat belt buckle that is being inspected.
  - Both sides will be inspected, one at a time.
2. Locate the seat belt buckle as shown in Figure 1.
  - Driver's side shown. Passenger side is similar.



Figure 1

3. Remove two Torx® (T-10H, tamper proof) screws from the seat belt buckle. (Figure 2).
  - Reassembly Torque: 0.45 N•m (0.046 kg-m, 3.98 in-lb)



Figure 2

4. Open the seat belt buckle cover to inspect seat belt buckle latch mechanism as follows:
  - a. Gently pull the "seat belt buckle cover" (buckle cover) away from the bottom of the "seat belt buckle" (buckle); approximately 1/4" (6 mm) (Figure 3).

**IMPORTANT:** Only pull away far enough to allow the buckle cover to slide down, to prevent damage to the wires connected to the buckle cover (see Figure 4).

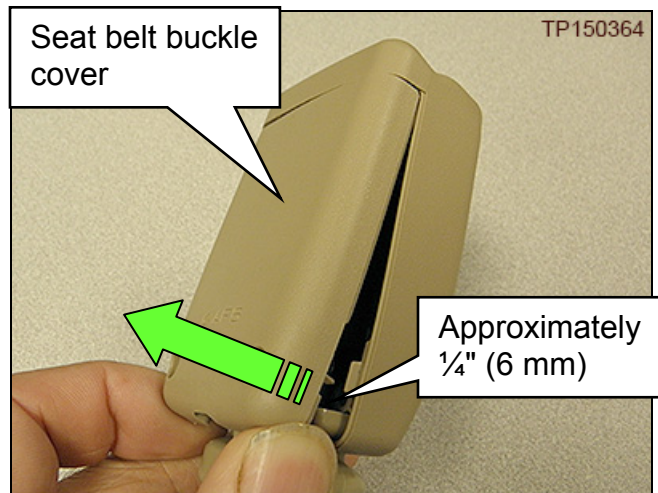

Figure 3

**IMPORTANT:** Take care to not damage the wire harness at the bottom of the seat belt buckle cover shown in Figure 4.

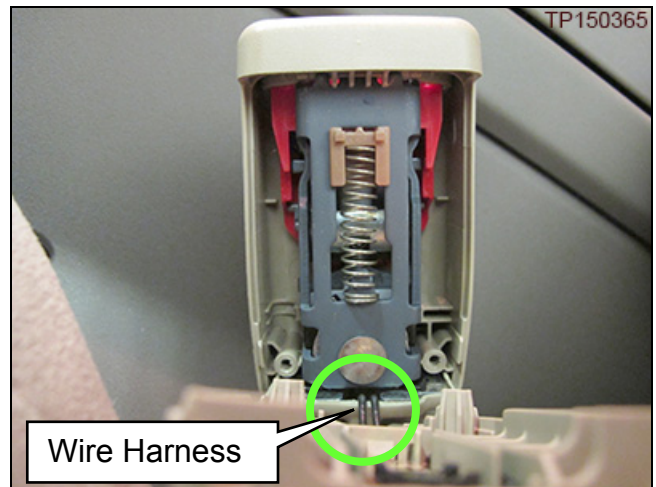

Figure 4

- b. While the bottom of the buckle cover is being held at ¼" (6 mm) from the buckle, slide the buckle cover down to clear the buckle cover tabs (tabs) from buckle (Figure 5).

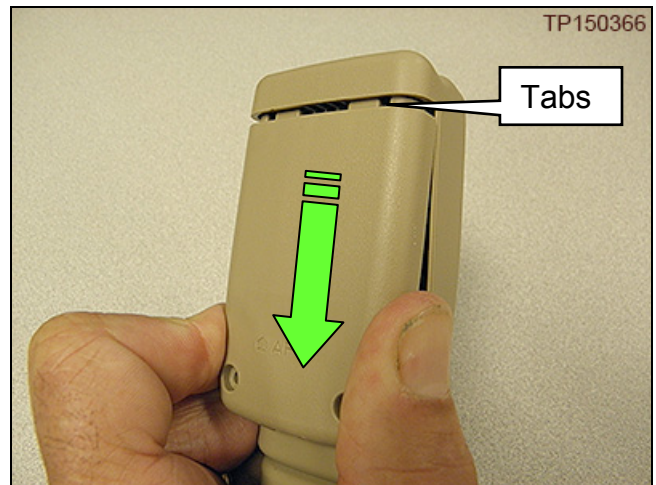

Figure 5

- c. With the bottom of the buckle cover held against the buckle, pivot the top of the buckle cover away from the buckle.
- Only pivot the buckle cover far enough away to inspect the seat belt buckle latch mechanism.

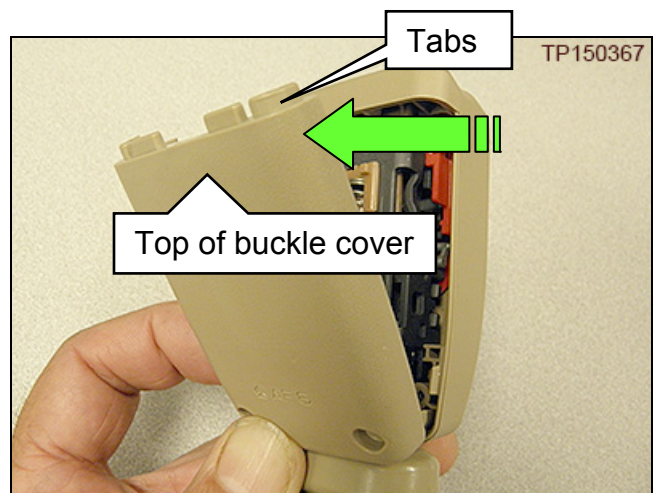

Figure 6

5. Inspect the seat belt buckle latch mechanism for the presence of a magnet.
- See Figure 8 and Figure 9 below.

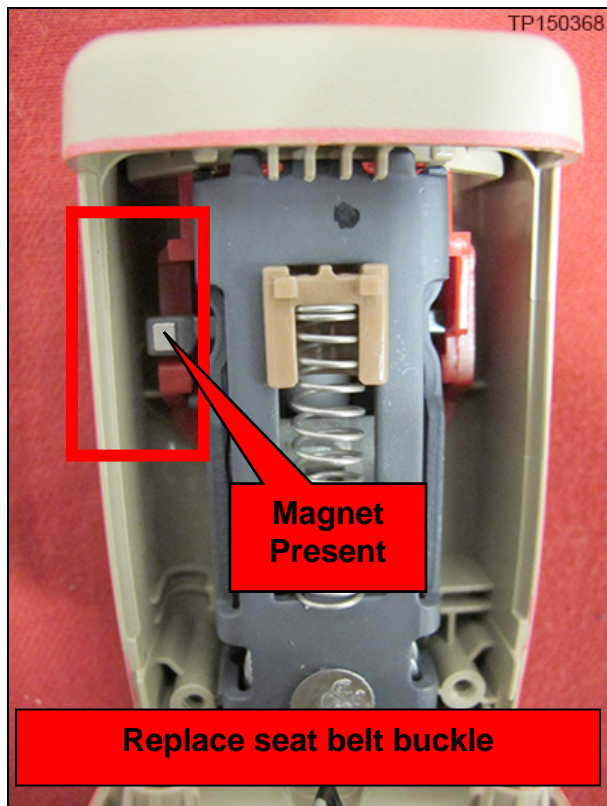

Figure 8

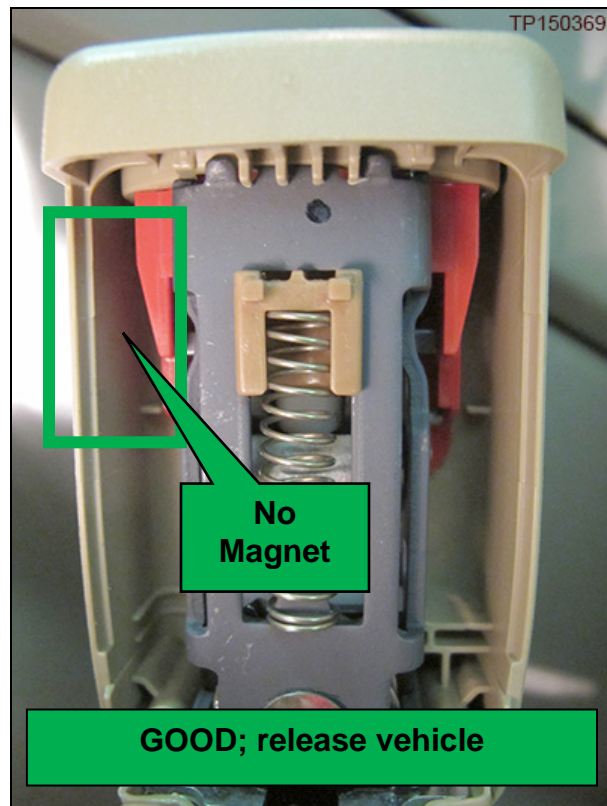

Figure 9

6. Repeat the inspection (Steps 1-5) for the inspection of the second seat belt buckle.
7. If there is **NOT** a magnet present in either seat belt buckle mechanism:
- a. Reassemble the vehicle.
  - b. Confirm the tongue latches and unlatches.
  - c. Submit warranty claim using PC3850 (see Claims Information), and release the vehicle.
8. If a magnet **IS** present in either of the front seat belt buckle mechanisms, as shown in Figure 8, replace the affected front seat belt buckle and confirm tongue latches and unlatches.
- Refer to the 2015 Armada Electronic Service Manual (ESM), Section **SB - Seat Belts**, for seat belt buckle replacement procedures.

**IMPORTANT:** Follow all cautions, warnings, and notes in the Electronic Service Manual (ESM) when working on or near a Supplemental Restraint System (SRS), such as an air bag.

**PARTS INFORMATION**

DESCRIPTION	TRIM	PART #	QUANTITY
Belt Assy- Buckle Pretensioner, Front <b>LH</b> (Seat Belt Buckle)	Y, Z	86873-ZZ58A	1
Belt Assy- Buckle Pretensioner, Front <b>RH</b> (Seat Belt Buckle)		86872-ZZ58A	1
Belt Assy- Buckle Pretensioner, Front <b>LH</b> (Seat Belt Buckle)	G	86873-ZZ58B	1
Belt Assy- Buckle Pretensioner, Front <b>RH</b> (Seat Belt Buckle)		86872-ZZ58B	1

Y=Almond, Z=Almond/Chocolate, G=Charcoal

**CLAIMS INFORMATION**

Submit a “CM” line claim using the following claims coding:

“CM” I.D. PC385

DESCRIPTION	OP CODE	FRT
Inspect Both Front Seat Belt Buckles. Inspection <b>Only</b>	PC3850	0.2

**If One Seat belt buckle is needed**

DESCRIPTION	OP CODE	FRT
Inspect Both Front Seat Belt Buckles. Replace one Seat belt buckle	PC3851	0.6

**If Both Seat belt buckles are needed**

DESCRIPTION	OP CODE	FRT
Inspect Both Front Seat Belt Buckles. Replace both Seat belt buckles	PC3852	0.9

