



Service Bulletin

American Honda Motor Co., Inc.

SAFETY RECALL

2014-2015 CBR1000S (CBR1000RR SP) REAR SHOCK ABSORBER REPAIR

American Honda Motor Co., Inc. is conducting a Safety Recall of certain 2014-2015 CBR1000S motorcycles. Honda has determined that a defect which relates to motor vehicle safety exists in affected units. During assembly of the rear shock, the piston nut may not have been correctly torqued.

Safety Consequence

An improperly torqued piston nut could affect the performance of the rear shock, which may cause the rider to lose control of the motorcycle, increasing the risk of a crash.

CUSTOMER NOTIFICATION

American Honda is sending a letter to owners of all affected 2014-2015 CBR1000S motorcycles, informing them that their motorcycle is being recalled for a safety related defect. The customer will be made aware of the safety risk and advised to contact a Honda dealer to have the repair performed.

For your reference, a copy of the Customer Letter is reproduced on page 13 of this Service Bulletin.

AFFECTED UNITS

2014 CBR1000S

JH2SC596*EK300001 thru JH2SC596*EK300360

2015 CBR1000S

JH2SC596*FK400001 thru JH2SC596*FK400175

(*) Denotes check digit

DEALER INVENTORY

Do not sell any un-repaired units.

According to federal law and Honda policy, any affected units in your new or used inventory cannot be sold or leased until the rear shock absorber is repaired. To identify affected units in your inventory, refer to *Unit Information* and your *eResponsibility Report* on **iN**. Then proceed with the **REPAIR VERIFICATION** section of this Service Bulletin.

REPAIR VERIFICATION

Before you begin the repair procedure, check if the repair has been performed on the unit. Some units within the affected VIN range may have been factory-repaired. See the **IDENTIFICATION** section of this Service Bulletin for more details.

- If there is a punch mark before the first character of the VIN:
 - No further action is necessary

- If there is no punch mark before the first character of the VIN:
 - Check the shock left lower shock mount for a punch mark (see [SHOCK ABSORBER INSTALLATION](#)).
 - If there is a punch mark on the lower shock mount, contact TechLine.
 - If there is no punch mark on the lower shock mount, proceed to the [REPAIR SUMMARY](#) section of this Service Bulletin.

If you have any questions about repair verification, please contact Motorcycle TechLine: (800) 421-1900, option 9 or Online:

iN > Service > TechLine > TechLine Connect

REPAIR SUMMARY

1. Contact Öhlins USA to receive a UPS shipping label.
2. Remove the shock absorber.
3. Ship the shock absorber to Öhlins USA. The shock will be repaired and returned to your dealership. (see [SHOCK ABSORBER SHIPPING](#)).
4. Reinstall the returned shock absorber.
5. Submit a normal warranty claim (see [CLAIM INFORMATION](#)).

ÖHLINS USA

Contact Öhlins USA to receive a UPS shipping label at:
1-800-336-9029, Ext. 309

SHOCK ABSORBER REMOVAL

1. Remove the air intake cover. Remove the three trim clips. Release the two tabs from the inner middle cowl and remove the air intake cover.

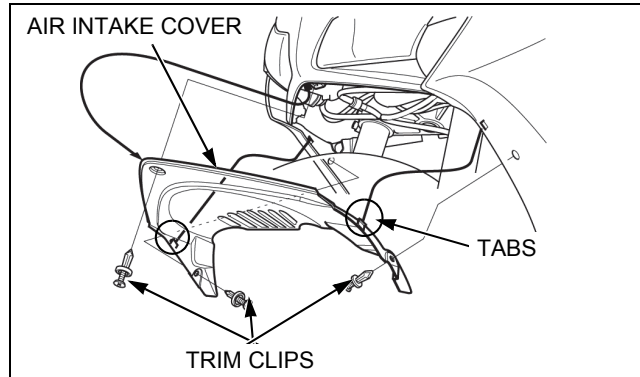

2. Remove the air duct cover. Remove the screw and two tapping screws from the duct cover.

Remove the screw securing the rear end of the middle cowl.

Slide the air duct cover rearward to release the two tabs from the middle cowl while spreading the cowl outward slightly and remove the duct cover.

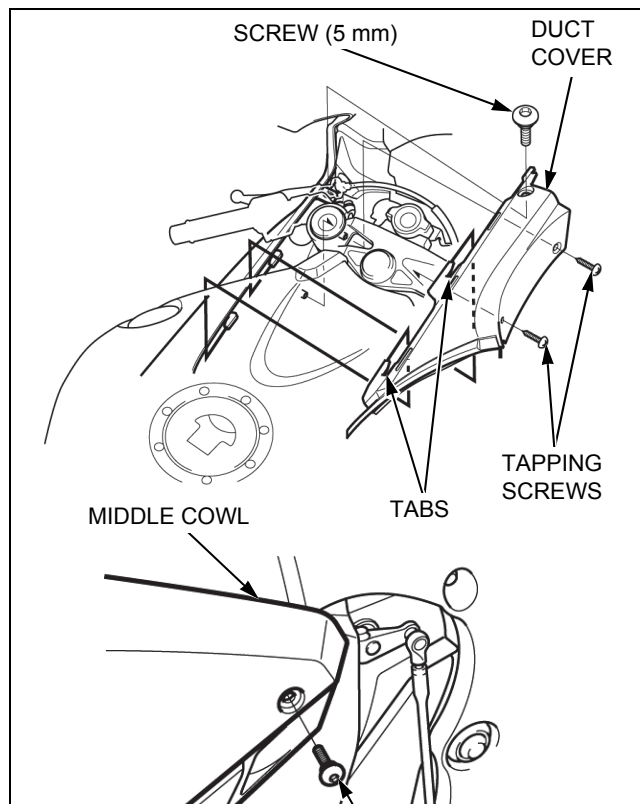

3. Release the hoses from the lower cowl.

Support the rear portion of the lower cowl and remove the four screws.

Release either the left or right three tabs on the middle cowl while sliding the lower cowl rearward, then remove the lower cowl from the other side tabs.

Remove the special nuts from the stays if necessary.

TORQUE

Lower cowl mounting screw (front):

1.5 N·m (0.2 kgf·m, 1.1 lbf·ft)

Lower cowl mounting special screw (rear):

10 N·m(1.0 fgf·m, 7 lbf·ft)

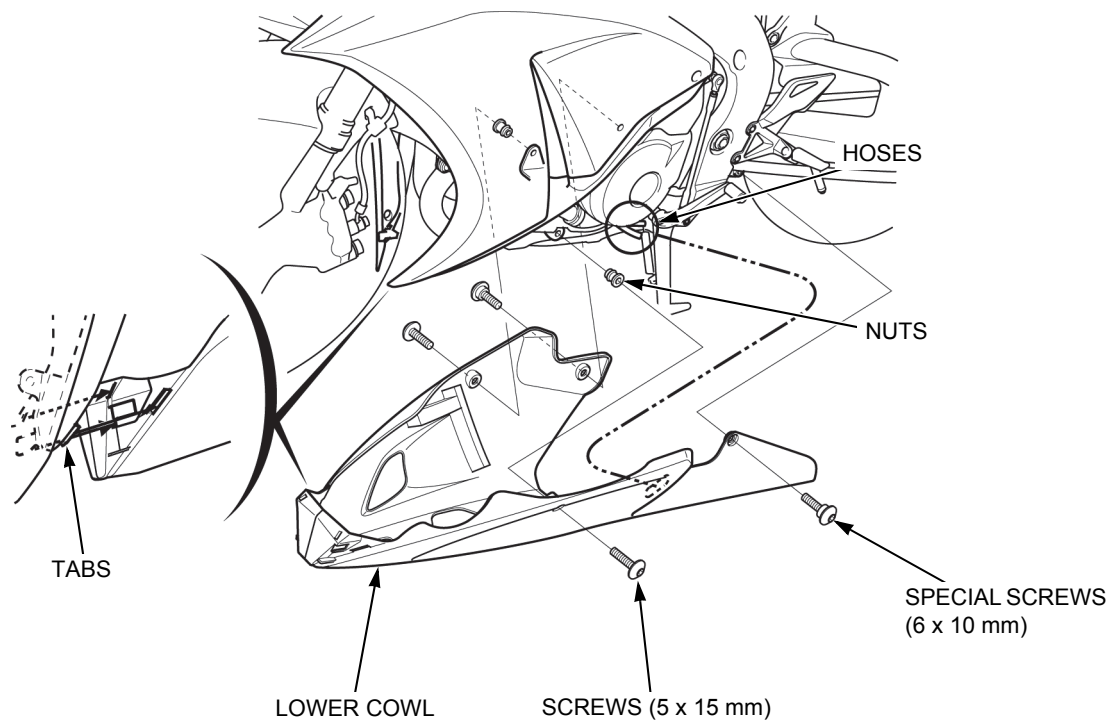

4. Remove the trim clip from the inside of the middle cowl.

While supporting the bottom of the lower cowl (A), and holding the lower side of the middle cowl down (B) to avoid damaging the retaining tabs, disconnect the lower tabs of the middle cowl by sliding it forward (C).

Release the stay off of the headlight housing (D), then turn the middle cowl downward (E) as a pivot point of the upper end to release the front tabs and remove the middle cowl.

Remove the screw and cowl stay if necessary.

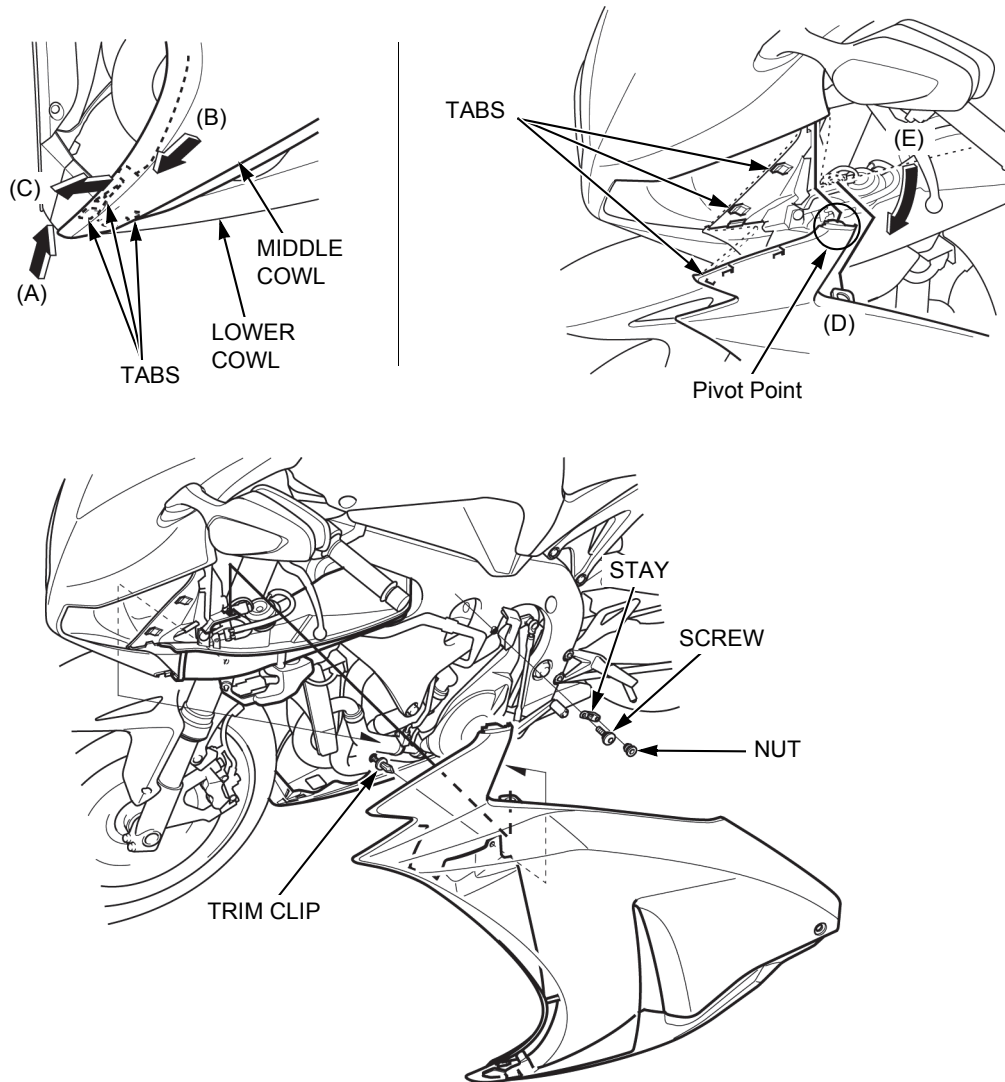

5. Remove the bolt and gearshift arm.

Remove the special screws. Release the cover flange off of the hook and the boss from the grommet, then remove the left rear under cover.

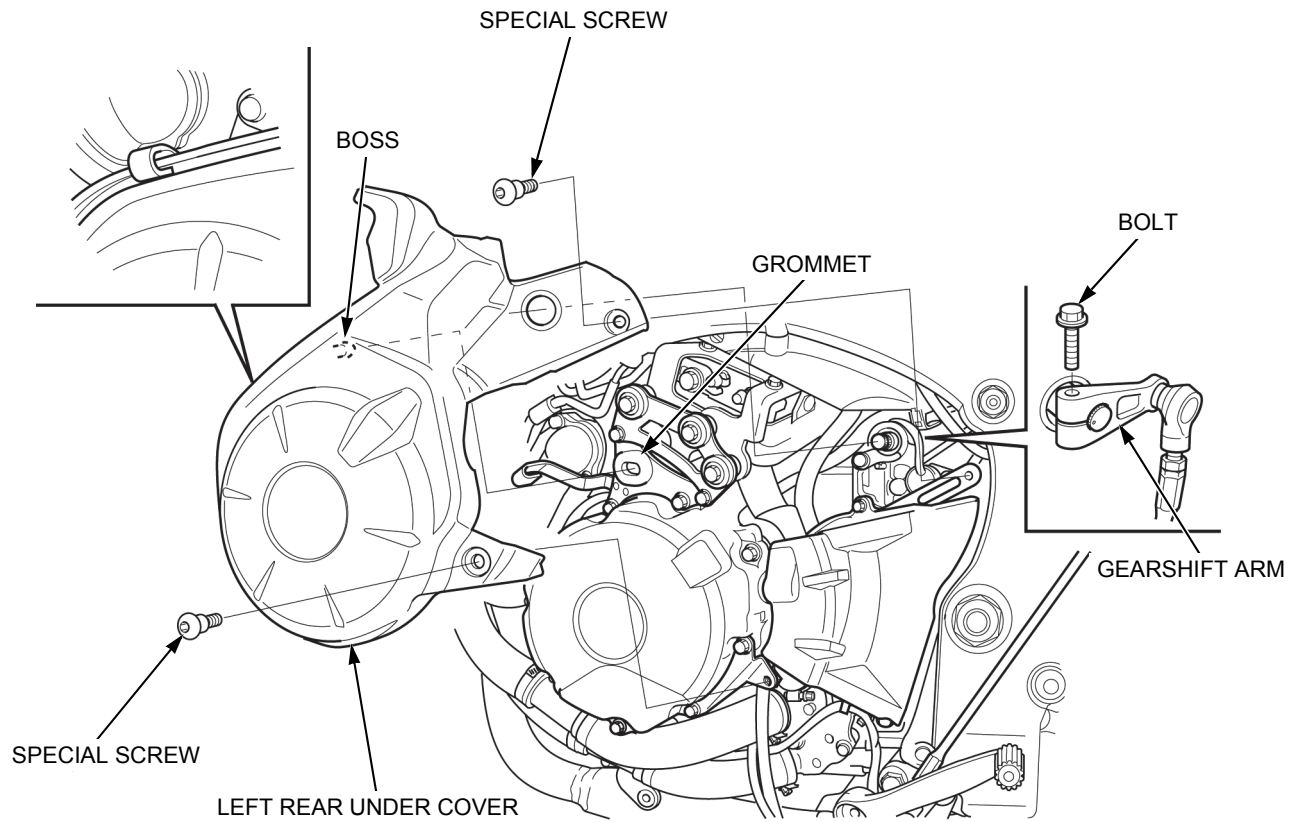

6. Release the wire clip on the O₂ sensor wire from the frame and the wire from the wire guides on the drive sprocket cover. Disconnect the O₂ sensor 4P (Black) connector and its wire out of the frame.

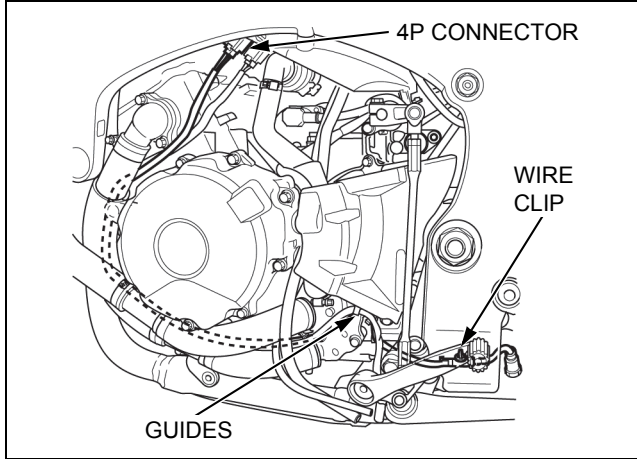

7. Remove the trim clips and EGCA cover.

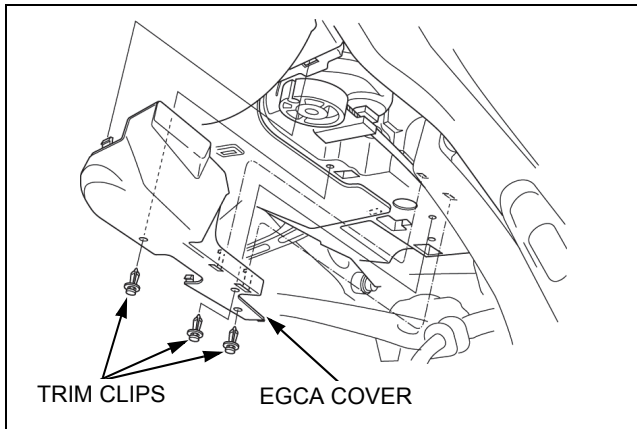

8. Turn the EGCA pulley clockwise and disconnect the EGCA cable from the EGCA pulley.

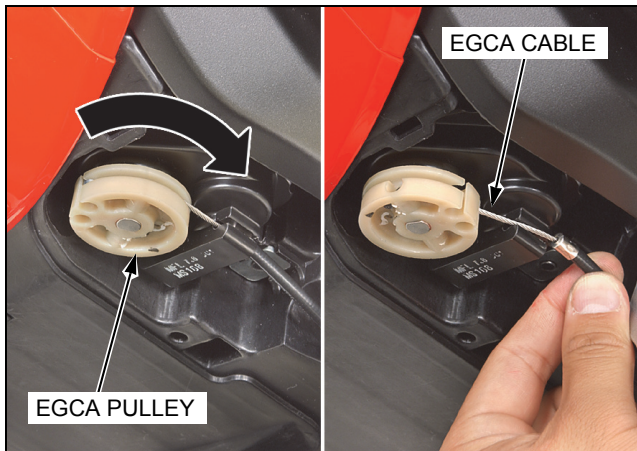

9. Loosen the muffler band bolt.

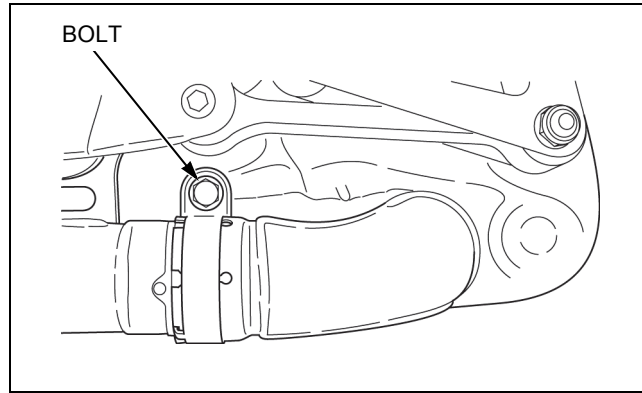

10. Remove the muffler mounting nut, bolt, and washer.

Release the EGCA cable from the cable guide.

Remove the right main step bracket assembly bolts and assembly.

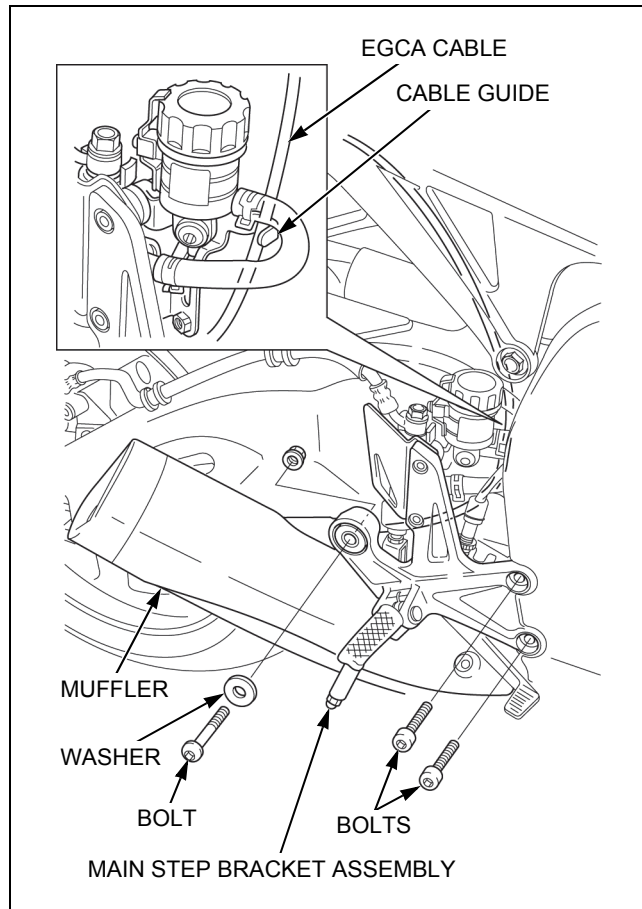

11. Remove the muffler and gasket.

- Support the motorcycle using a hoist or equivalent and raise the rear wheel off the ground.
- Remove the suspension linkage nuts and bolts, shock link, and shock arms.

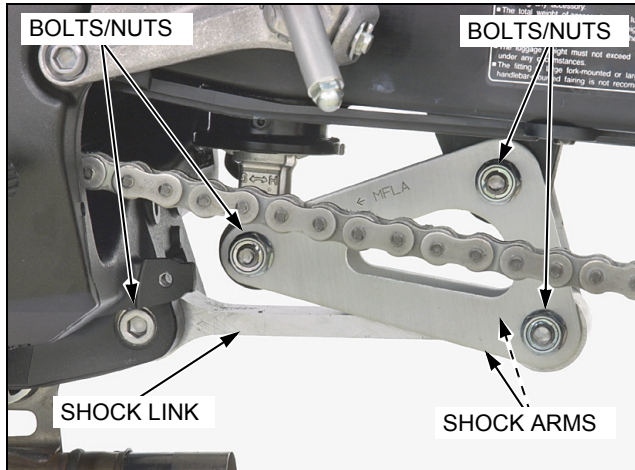

- Remove the shock absorber upper mounting nut and bolt, then remove the shock absorber downward.

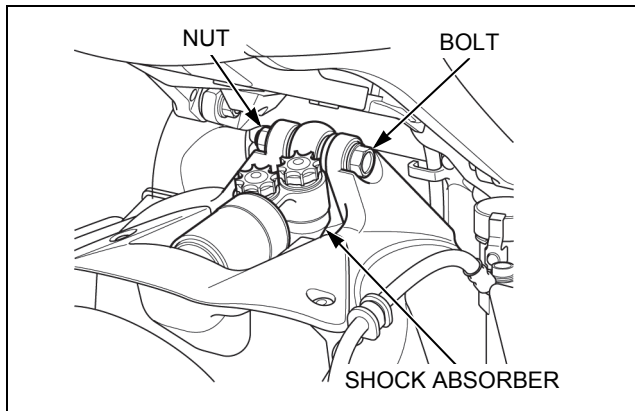

- If the vehicle needs to be removed from the hoist or lift while the shock is sent to Öhlins USA, install the support strut. Install the upper bolt and nut first.

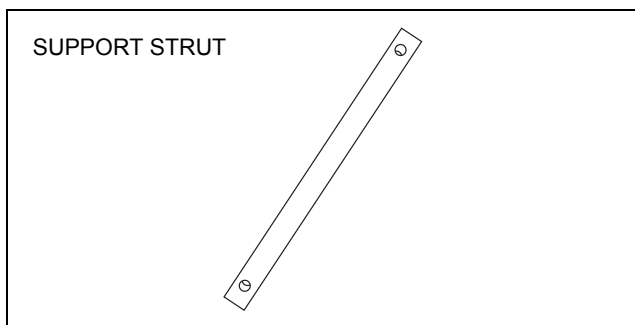

- Loosely install the shock link, shock arms and nuts and bolts. **DO NOT SIT ON OR RIDE THE MOTORCYCLE WITH THE SUPPORT STRUT IN PLACE.**

SHOCK ABSORBER SETTINGS

Each repaired shock will be shipped back to the dealer with the same settings that it was shipped with.

SHOCK ABSORBER SHIPPING

Each shock must be shipped with the completed [ÖHLINS WORK ORDER FORM](#), see page 15 of this bulletin.

Fill out the form completely and return it with the Overnight UPS label provided by Öhlins USA to:

Öhlins USA:
703 S. Grove St
Suite "C"
Hendersonville, N.C. 28792
1-800-336-9029, Ext. 309

SHOCK ABSORBER INSTALLATION

Check that the returned shock absorber has identifying punch mark from Öhlins.

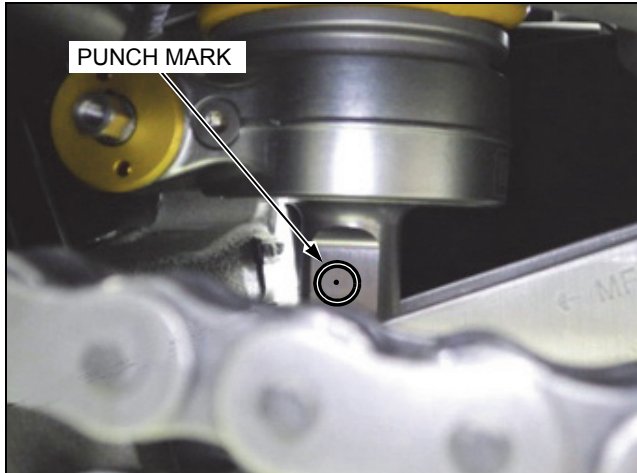

1. Support the motorcycle using a hoist or equivalent and raise the rear wheel off the ground. Remove the support strut by removing the bolts and nuts.
2. Install the shock absorber assembly with the reservoir facing the rear. Install the upper mounting bolt from the right side. Install the nut and tighten to the specified torque.

TORQUE: 44 N·m (4.5 kgf·m, 32 lbf·ft)

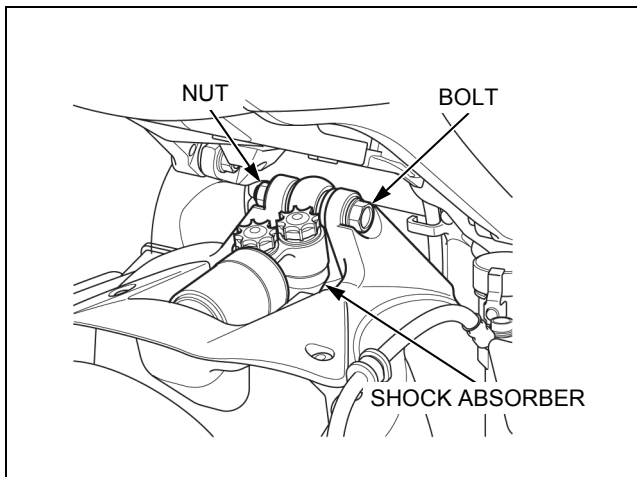

3. Loosely install the shock arms, shock link, and bolts and nuts. Tighten the nuts to the specified torque.

TORQUE: 44 N·m (4.5 kgf·m, 32 lbf·ft)

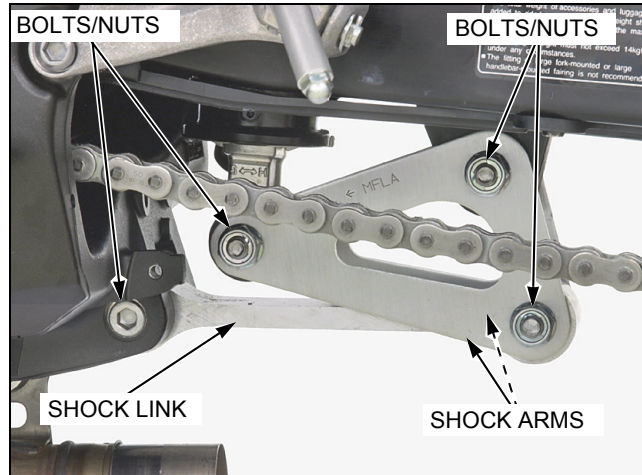

4. Install the muffler with a new exhaust gasket. Align the tab with the groove.

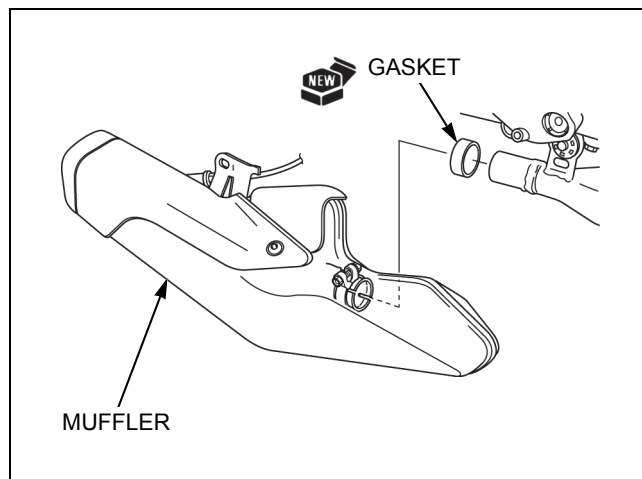

5. Raise the muffler into position while routing the EGCA cable to the cable guide.

Install the right main step bracket assembly and tighten the bolts to the specified torque.

TORQUE: 37 N·m (3.8 kgf·m, 27 lbf·ft)

Loosely install the muffler mounting bolt, washer, and nut.

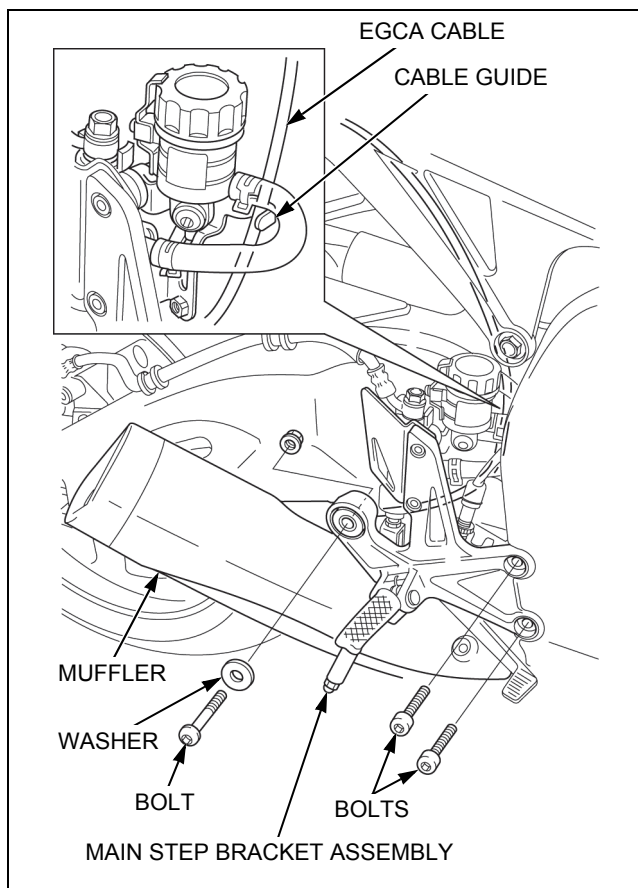

6. Tighten the muffler band bolt to the specified torque.

TORQUE: 17 N·m (1.7 kgf·m, 13 lbf·ft)

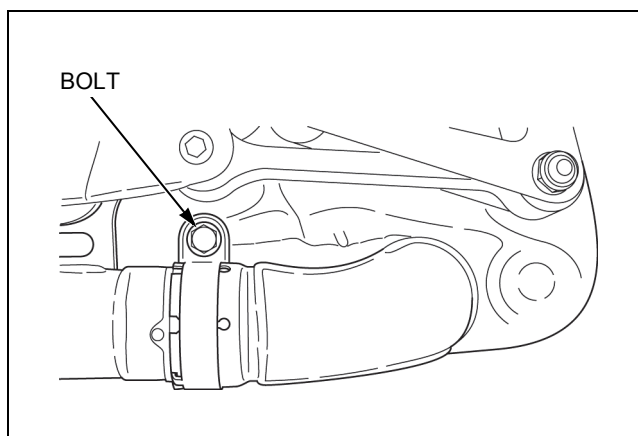

7. Tighten the muffler mounting nut securely while holding the bolt.

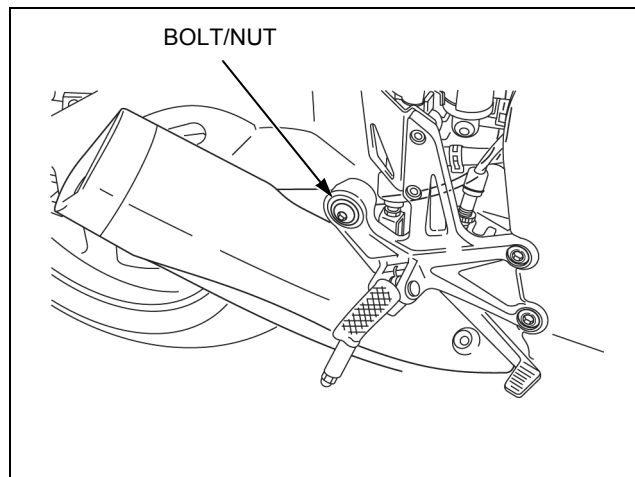

8. Connect the EGCA cable to the EGCA pulley.

Turn the EGCA pulley counterclockwise to the specified angle as shown.

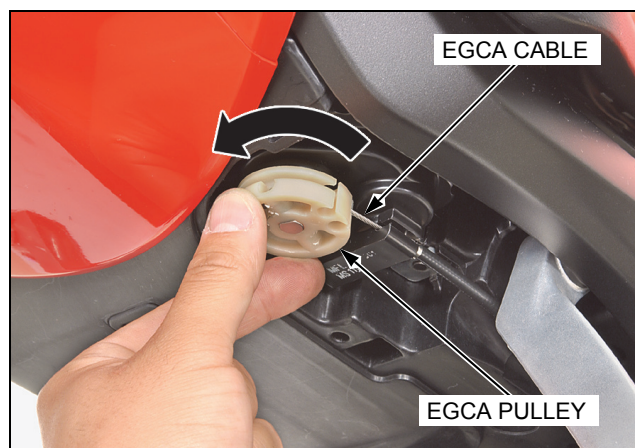

PULLEY ANGLE:

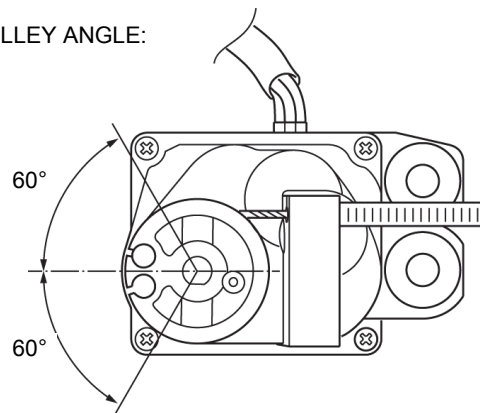

9. Route the O₂ sensor wire properly and connect the 4P (Black) connector.

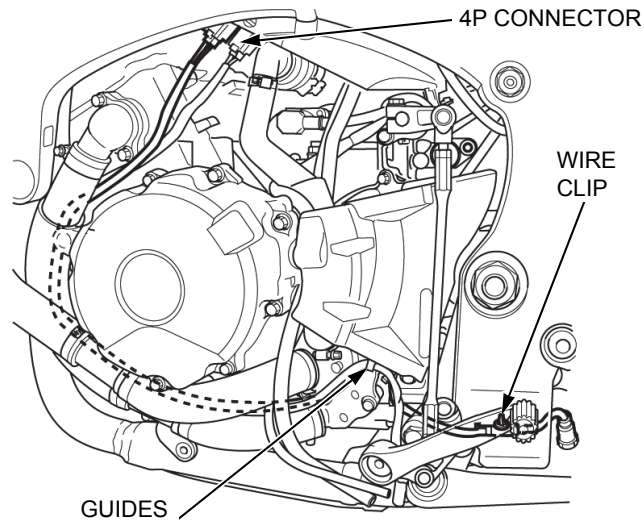

10. Check the EGCA and ECV operation.

Install the EGCA cover and trim clips securely.

Start the engine.

Stop the engine and check that the ECV is closed fully.

If the ECV is closed fully, it is normal.

If the ECV is not closed fully, refer to the Service Manual for EGCA cable adjustment.

11. Install the left rear under cover while aligning its boss with the grommet, then tighten the screws securely.

Install the gearshift arm to the gearshift spindle, aligning the arm slit with the punch mark on the gearshift spindle.

Tighten the gearshift spindle securely.

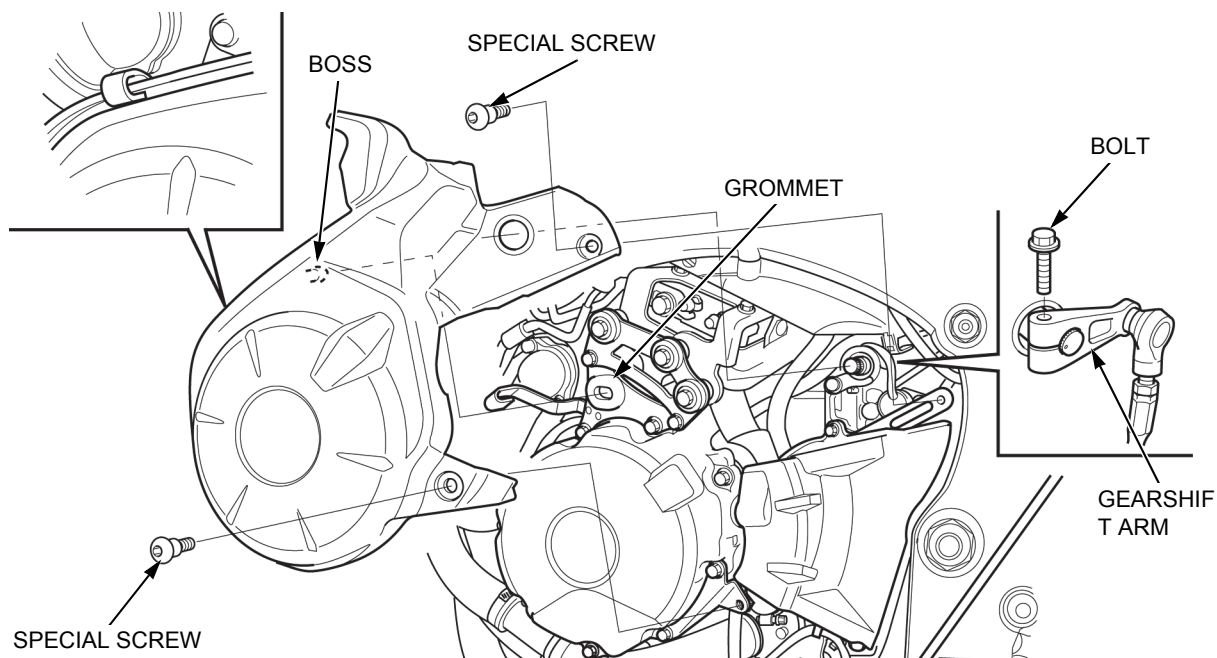

12. Install the left middle cowl.

1. Install the middle cowl over the intake air duct while spreading the inner side of the middle cowl slightly, then position the stay onto the headlight housing.
2. Raise the upper cowl end and place the upper tab A of the middle cowl under the upper cowl.
3. Align the slit in the inner middle cowl with the upper cowl tab B and set all the front side tabs C properly by sliding the middle cowl rearward.
4. Insert the three lower tabs D into the slits in the lower cowl in a straight line while supporting the bottom of the lower cowl, being careful not to damage the tabs.

Make sure the mating areas of the middle cowl are aligned with the air duct and upper cowl properly as shown, and install the trim clip.

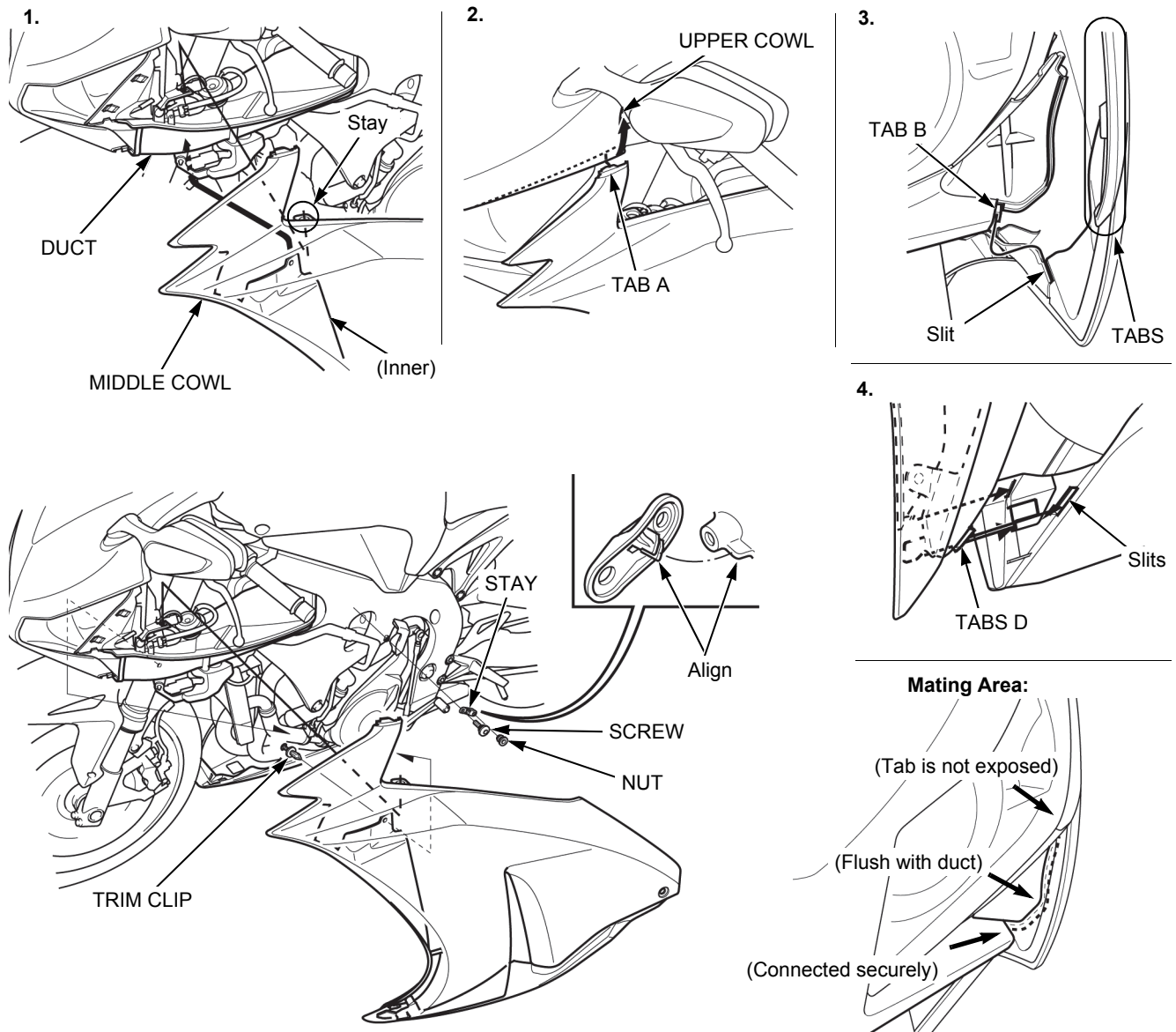

13. Install the lower cowl in the reverse order of removal.

14. Install the air duct cover in the reverse order of removal.

15. Install the air intake cover in the reverse order of removal.

INDENTIFICATION

After you have completed the [SHOCK ABSORBER INSTALLATION](#), apply a punch mark in front of the first character of the VIN located on the frame as shown.



CLAIM INFORMATION

This Safety Recall will be in effect until all affected units have been repaired according to this Service Bulletin, regardless of the date of purchase. Normal warranty claim submission requirements apply. After completing the Service Bulletin repair procedure, submit one warranty claim per unit with the following information:

Template: JQ3A

Flat Rate Time: 2.0 hours

PARTS INFORMATION

REQUIRED PARTS

Gasket, Muffler

P/N: 18391-MEL-000

TEXT OF CUSTOMER LETTER

April 2015

NHTSA Recall 15V-230

IMPORTANT SAFETY RECALL

This notice applies to your vehicle.

Dear CBR1000S (Special Edition) Owner:

This notice is sent to you in accordance with the National Traffic and Motor Vehicle Safety Act.

What is the reason for this notice?

Honda has decided that a defect which relates to motor vehicle safety exists in certain 2014 and 2015 model year Honda CBR1000S (Special Edition) motorcycles. During assembly of the rear shock, the piston nut may not have been correctly torqued. An improperly torqued piston nut could affect the performance of the rear shock, which may cause the rider to lose control of the motorcycle, increasing the risk of a crash.

What should you do?

Call any authorized Honda motorcycle dealer and make an appointment to have your motorcycle's rear shock repaired at **no cost to you**.

Be advised that your motorcycle's rear shock assembly will be removed by the dealer and shipped to the supplier's repair center. Your motorcycle may have to be at the dealer for the duration of the repair; however, please ask your dealer for the specific time your vehicle will need to be at the dealership.

For assistance with locating a Honda motorcycle dealer, you may call Honda Motorcycle Customer Support at 1-866-784-1870 or use the "find a dealer" option on www.powersports.honda.com

Who to contact if you experience problems?

If you are not satisfied with the service you receive from your Honda dealer, you may write to or call:

American Honda Motor Co., Inc.
Motorcycle Customer Service
Mail Stop 100-4C-7B
1919 Torrance Blvd.
Torrance, CA 90501-2746.
1-866-784-1870

If you believe that American Honda or the dealer has failed or is unable to remedy the safety defect in your vehicle, without charge, within a reasonable period of time (60 days from the date you first contact the dealer for a repair appointment), you may submit a complaint to:

Administrator
National Highway Traffic Safety Administration
1200 New Jersey Ave., SE
Washington, DC 20590

Or call the toll-free Vehicle Safety Hotline at 1-888-327-4236 (TTY 1-800-424-9153), or go to <http://www.safercar.gov>.

What to do if you feel this notice is in error.

Registration records indicate that you are the current owner of a 2014-2015 CBR1000S (Special Edition) involved in this campaign. If this is not the case, or the name/address information is not correct, please fill out and return the enclosed, postage-paid *Information Change Card*. We will then update our records.

Lessor Information:

Federal law requires that any vehicle lessor receiving this recall notice must forward a copy of this notice to the lessee within 10 days.

We apologize for any inconvenience this campaign may cause you.

Sincerely,

American Honda Motor Co., Inc.
Motorcycle Division

Campaign JQ3 / Service Bulletin:CBR1000S #1

**THIS PAGE
INTENTIONALLY
LEFT BLANK**

ÖHLINS WORK ORDER FORM



ADVANCED SUSPENSION TECHNOLOGY

Work Order Form

www.ohlinsusa.com

Honda CBR1000RR-SP Öhlins HO1140
TTX36 Shock Recall Form

Business Name/ Name: _____ Date: _____
Street: _____
City / State / Zip: _____
Phone# Day: _____ Eve: _____
Fax: _____ E-mail: _____

Return Shipping

If Return Address is same as above Add alternate shipping address below:

Business Name/ Name: _____
Street: _____
City / State / Zip: _____

Shock Application:

Make: _____ Model: _____ Year: _____
Production Code (if known): _____
VIN #: _____
Part Number: _____

Service Department Notes (Internal Use Only)

Checked in by: _____ **Date:** _____
Work Performed by: _____ Completed Date: _____ Macola order #: _____

Work Performed Notes: _____

Send Products to:

Öhlins USA, Inc. 703 S. Grove St. Suite C Hendersonville, NC 28792