

TECHNICAL INSTRUCTIONS
FOR
SAFETY RECALL F0D
PREMIUM AUDIO SYSTEM - REAR SUB-WOOFER
INTERIM PROCEDURE
CERTAIN 2011-2012 AVALON

All dealership associates involved in the recall process are required to successfully complete E-Learning course SC13A. To ensure that all vehicles have the repair performed correctly; technicians performing this recall repair are required to currently hold at least one of the following certifications levels:

- Toyota Certified (any classifications)
- Toyota Expert (any classifications)
- Master
- Master Diagnostic Technicians

I. OPERATION FLOW CHART

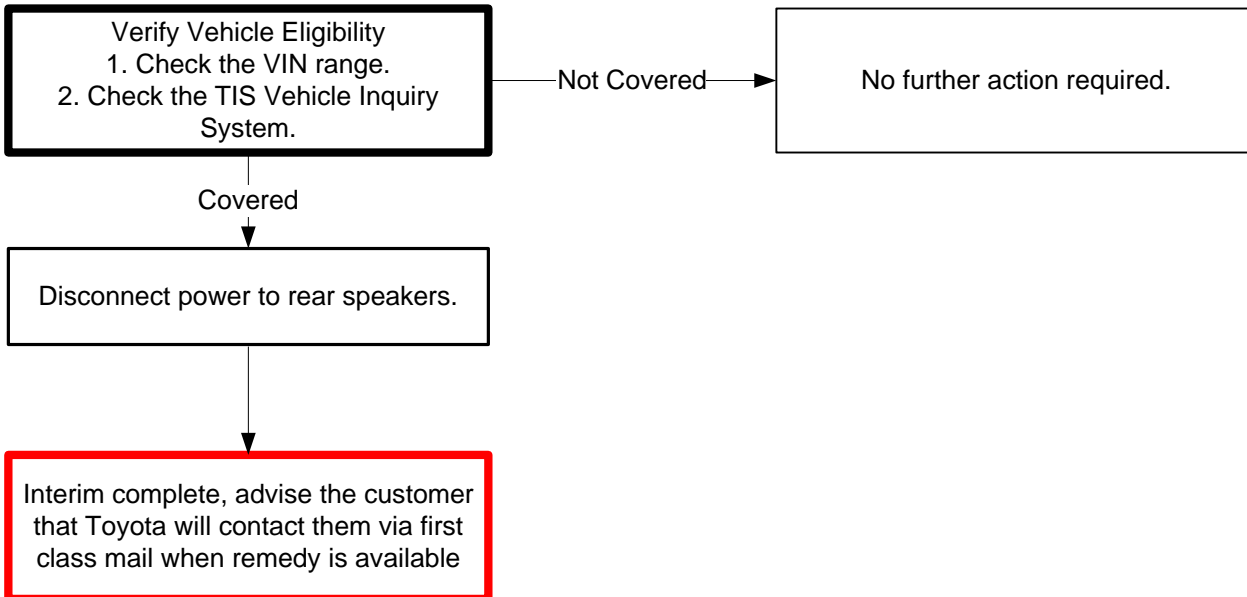

II. IDENTIFICATION OF AFFECTED VEHICLES

A. COVERED VIN RANGE

- Check the TIS Vehicle Inquiry System to confirm the VIN is involved in this Safety Recall, and that the campaign has not already been completed prior to dealer shipment or by another dealer.
- TMS warranty will not reimburse dealers for repairs conducted on vehicles that are not affected or were completed by another dealer.

III. PREPARATION

A. PARTS

There are no parts required for this interim procedure.

B. TOOLS & EQUIPMENT

Electrical Tape

IV. BACKGROUND

The subject vehicles are equipped with a 12-speaker, premium audio system package which includes a sub-woofer mounted inside the trunk. Large or loose cargo located in the trunk could contact one of the sub-woofer wires, and move it out of its normal position. If this wire contacts the metal frame of the sub-woofer, it may result in an intermittent short circuit. If this occurs, the sub-woofer could overheat, increasing the risk of a fire.

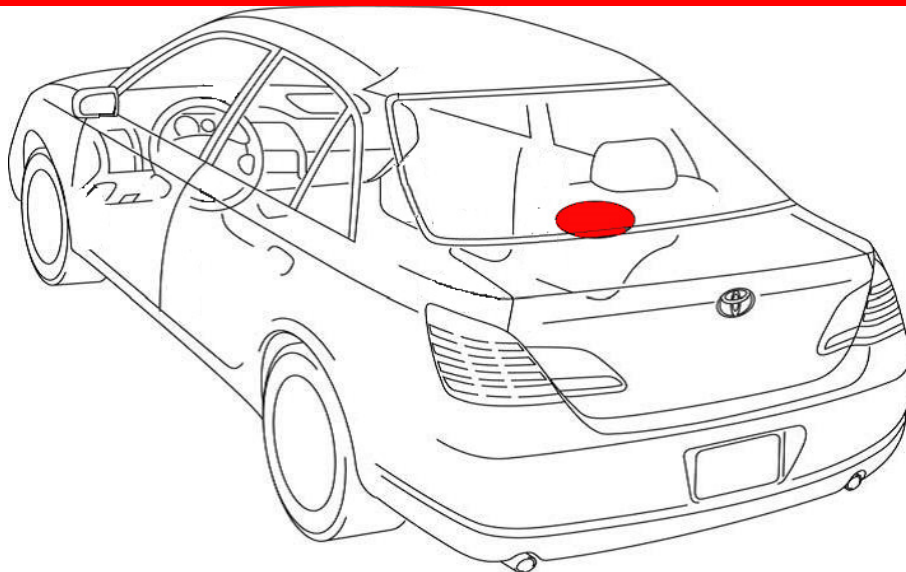

V. REAR SPEAKER AND SUBWOOFER DISCONNECT PROCEDURE

COMPONENTS

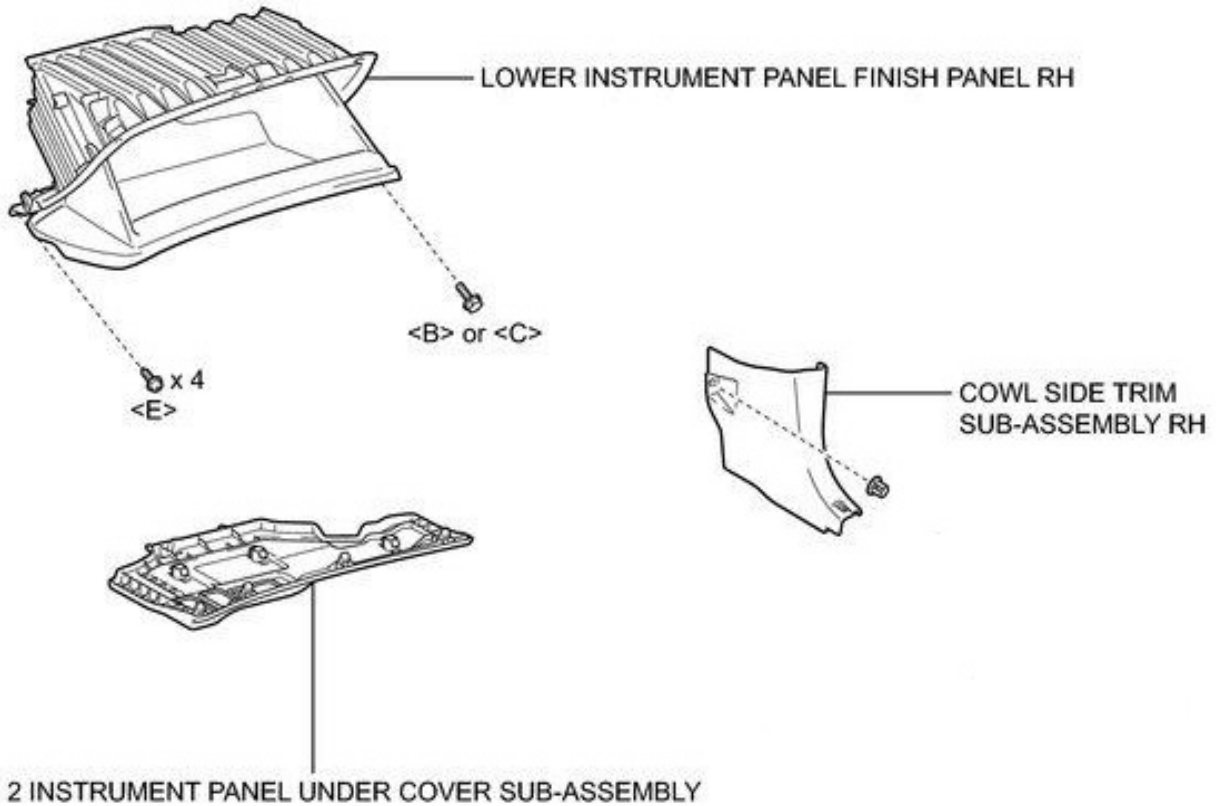

1. REMOVE THE RH COWL SIDE TRIM SUB-ASSEMBLY

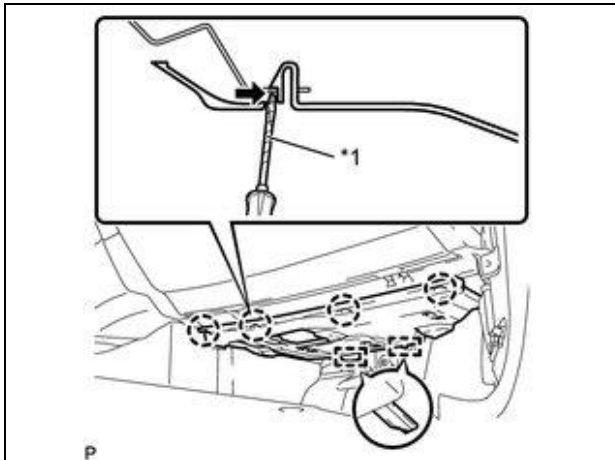

2. REMOVE THE NO. 2 INSTRUMENT PANEL UNDER COVER

- Disengage the 4 claws and 2 guides as shown in the illustration.
- Disconnect each electrical connector and remove the panel.

Note: Wrap a screwdriver in tape to protect the plastic.

3. REMOVE THE LOWER INSTRUMENT PANEL FINISH PANEL

- Remove the 4 screws and bolt.
- Disengage the 3 claws and clip to remove the finish panel.

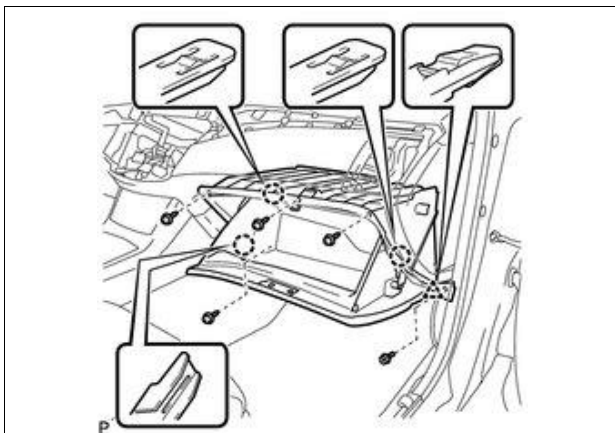

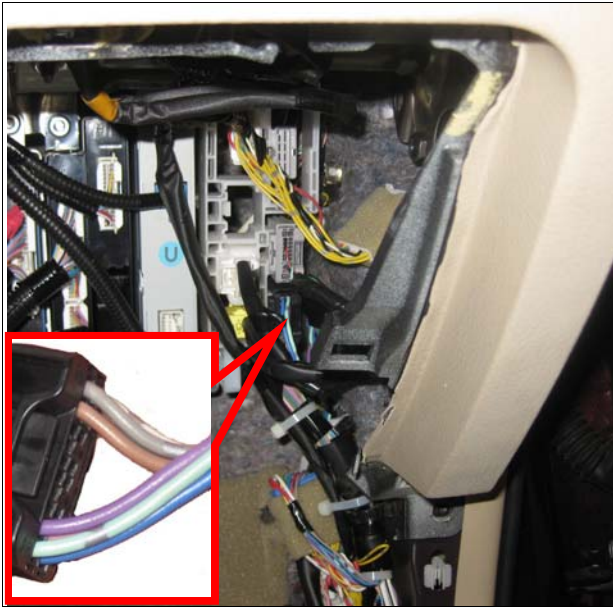

4. LOCATE THE REAR SPEAKER CONNECTOR

- a) Locate the black connector in the lower right hand corner of the junction block.

NOTE: The connector is the only black connector in the junction block.

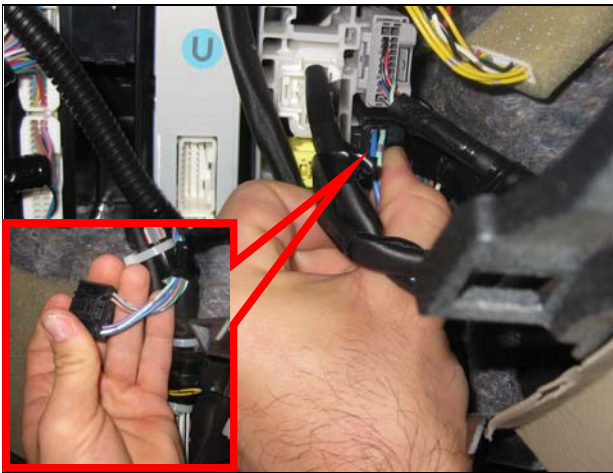

5. DISCONNECT THE CONNECTOR

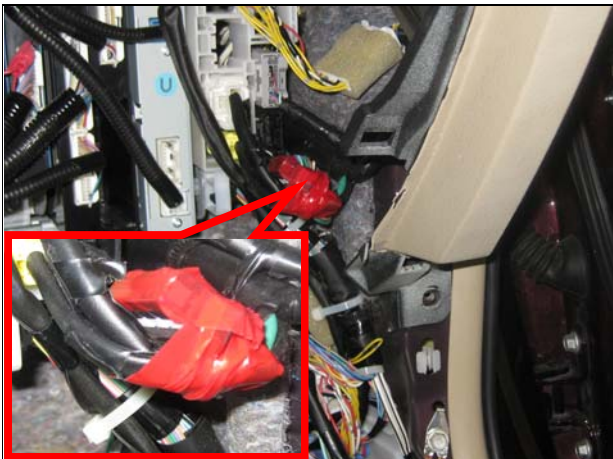

6. SECURE THE CONNECTOR

- a) Using electrical tape, seal and secure the connector to the adjacent wireharness as shown.

NOTE: Red electrical tape was only used for photo purposes, normal black electrical tape is okay to be used.

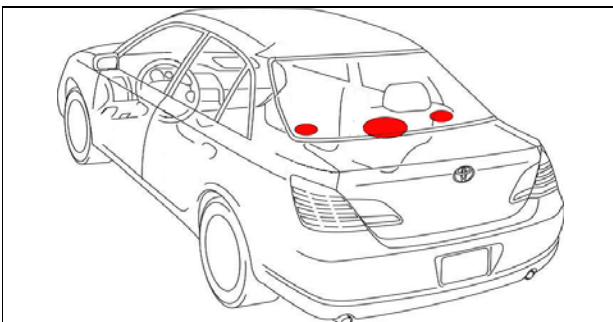

7. CONFIRM THE CORRECT CONNECTOR WAS DISCONNECTED BY CONFIRMING NO SOUND COMES FROM THE REAR SPEAKERS AND SUBWOOFER.

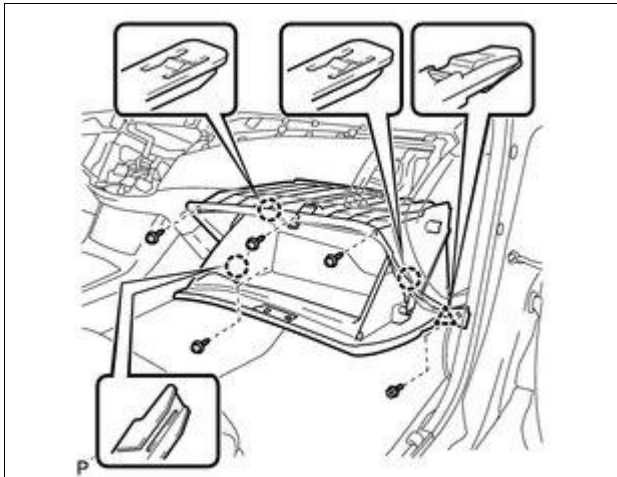

8. REINSTALL THE LOWER INSTRUMENT PANEL FINISH PANEL

- a) Engage the 3 claws and clip.
- b) Reinstall the 4 screws and bolts.

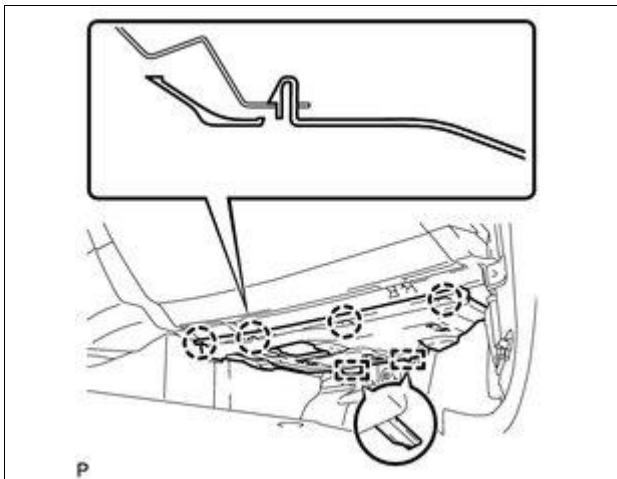

9. REINSTALL NO.2 INSTRUMENT PANEL UNDER COVER SUB-ASSEMBLY

- a) Connect each connector.
- b) Engage the 4 claws and 2 guides.

10. REINSTALL THE RH COWL SIDE TRIM SUB-ASSEMBLY

◀ VERIFY REPAIR QUALITY ▶

- Confirm that the correct connector is disconnected.
- Confirm that the connector is sealed and secured to the adjacent wire harness.

If you have any questions regarding this **Safety Recall**, please contact your regional representative.

VI. APPENDIX

A. CAMPAIGN PARTS DISPOSAL

Make sure all campaign parts (original parts) removed from the vehicle are disposed of in a manner in which they will not be reused, ***unless requested for parts recovery return.***

B. CAMPAIGN DESIGNATION DECODER

