



STRICK TRAILERS, LLC

225 Lincoln Highway
Fairless Hills
Pennsylvania, USA
19030.0009
215.949.3600



IMPORTANT SAFETY RECALL

**This notice applies to your vehicles
identified on the enclosed spreadsheet**

NHTSA Recall No. 15V-825

February 2, 2016

CERTIFIED MAIL – R.R.R.

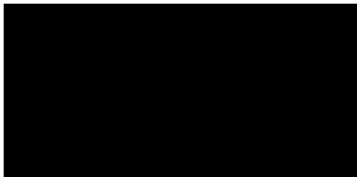

Dear Mr. [REDACTED]

This notice is sent in accordance with the requirements of the National Traffic and Motor Vehicle Safety Act.

Strick Trailers, LLC ("Strick Trailers") has decided that certain dry freight van trailers, model numbers S4280E99NFOV and S4280E99NFOPW, as identified on the enclosed spreadsheet, fail to conform to Federal Motor Vehicle Safety Standard No. 223 "Rear Impact Guards".

The noncompliance is in regards to the curbside and roadside rear impact guard gussets. Strick Trailers identifies the gussets with the numbers 59653 and 59654. These gussets do not meet the requirements of Federal Motor Vehicle Safety Standard 223 pertaining to rear impact guards. This could increase the risk of injury in the event of a rear impact crash.

In order to remedy the noncompliance, it will be necessary to reinforce the curbside and roadside rear impact guard gussets in accordance with the instructions (Drawing 703072) attached to this letter. We will supply the new reinforcement parts without cost and will ship them to multiple locations at your request. The parts necessary to reinforce the gussets are expected to be available for delivery beginning on March 7, 2016. We will also reimburse you for the reasonable direct labor costs involved in effecting the repair or will have the repair facilities bill us directly. The work to reinforce the rear impact guard gussets will take approximately two and one half hours to perform.

We will make ourselves available to answer any questions that arise during the course of this modification program, and, if requested, assist you in locating qualified repair facilities. We will also provide training or any



R & L Transfer
February 2, 2016
Page 2

other support you need. If you need any assistance, please contact me, Jerry Clontz, at jclontz@diamatrix.net or 1-704-436-2590.

Invoices for completed work should be submitted with authorization number M2015030 and a list of vehicle identification numbers for the serviced equipment to:

Strick Trailers, LLC
301 N. Polk Street
Monroe, IN 46772

If you have had your vehicle repaired prior to receipt of this notice, you may be entitled to reimbursement if you incurred any out-of-pocket cost due to this matter. For further information, please contact us at 1-704-436-2590.

Federal law requires any lessor who receives a notification of a determination of a safety-related defect or noncompliance pertaining to any leased motor vehicle to send the notice to the lessee within 10 days.

We regret any inconvenience this action may cause you. However, we are concerned about your safety, and we have notified the National Highway Traffic Safety Administration of this program. If you are unable to have these defects remedied without charge, you may submit a complaint to:

Administrator, U.S. Department of Transportation
National Highway Traffic Safety Administration
Office of Defects Investigation
1200 New Jersey Avenue, SE
Washington, D.C. 20590

Alternatively, you may call the toll-free Vehicle Safety Hotline at 1-888-327-4236 (TTY: 1-800-424-9153) or go to <http://www.safercar.gov>.

Thank you for your attention to this important matter.

Very truly yours,

Jerry Clontz

GENERAL INSTRUCTIONS FOR UPGRADE OF RIG ASSEMBLY:

- CONTACT STRICK ENGINEERING WITH QUESTIONS AND CONCERNS.
- WELDING WILL BE PERFORMED IN THIS RIG UPGRADE. PROTECT ALL ITEMS THAT MAY BE DAMAGED FROM THE RESULTING HEAT.
- PERSONNEL PERFORMING WELD PROCEDURES **MUST** USE PROPER PERSONAL PROTECTION EQUIPMENT.
- WELDING MUST BE PERFORMED BY A QUALIFIED WELDER.
- WELDING RODS AND/OR WIRE MUST BE E70 OR ER70S, OR EQUAL.
- PROPERLY PREPARE ALL SURFACES FOR WELDING.
- ALL NEW REINFORCEMENT PARTS MUST BE SEATED AGAINST (2) INSIDE FACES OF THE EXISTING GUSSET.
- LOCATE, TACK, AND WELD *SINGLE* BEND REINFORCEMENTS **BEFORE** *DOUBLE* BEND REINFORCEMENTS.
- CLOSEOUT PLATES MUST BE WELDED LAST.

WELDING INSTRUCTIONS FOR UPGRADE OF RIG ASSEMBLY:

1. PREPARE THE EXISTING SURFACES FOR WELDING IN THE AREAS NEEDED. PREPARE SURFACES OF REINFORCEMENTS FOR WELDING.
2. POSITION SINGLE BEND REINFORCEMENT ITEMS ②, ③ & TACK IN PLACE, AS SHOWN IN THE FOLLOWING FIGURES.
3. VERIFY FIT & WELD ITEMS ②, ③ AS SPECIFIED ON SHEET 2.
4. POSITION DOUBLE BEND REINFORCEMENT ITEMS ④, ⑤ & TACK IN PLACE, AS SHOWN IN THE FOLLOWING FIGURES.
5. VERIFY FIT & WELD ITEMS ④, ⑤ AS SPECIFIED ON SHEET 2.
6. POSITION REINFORCEMENT ITEM ① & TACK IN PLACE, AS SHOWN IN THE FOLLOWING FIGURES.
7. VERIFY FIT & WELD ITEMS ① AS SPECIFIED ON SHEET 2.
8. ALLOW THE NEW WELDS TO COOL. THOROUGHLY CLEAN SURFACES AND APPLY FINISH MATERIALS AS NEEDED, I.E. COLD GALVANIZE SPRAY, PRIMER, PAINT.

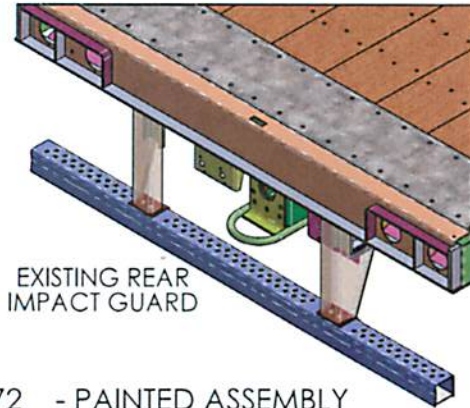

EXISTING REAR IMPACT GUARD

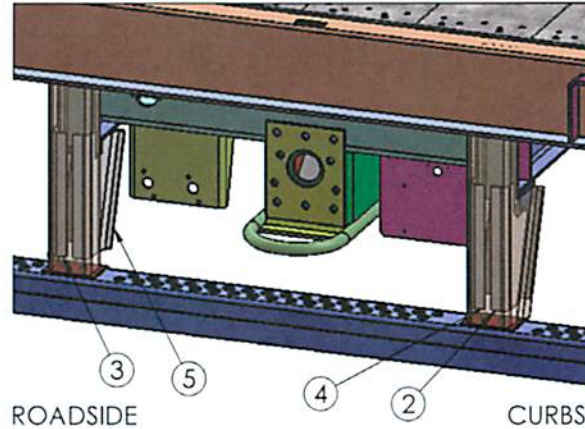

ROADSIDE ③ ⑤ ④ ② CURBSIDE

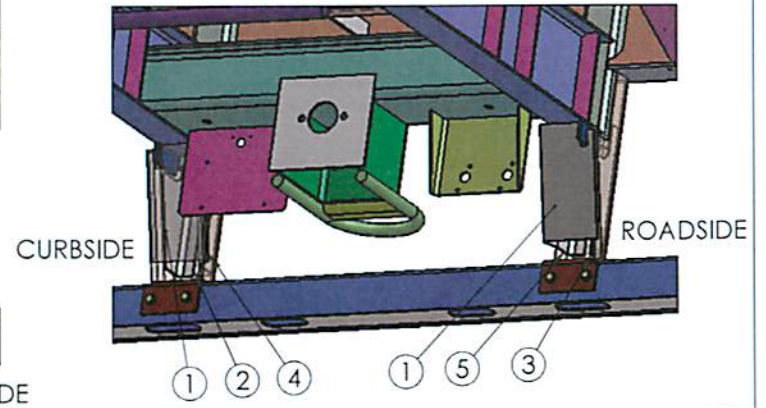

CURBSIDE ① ② ④ ① ⑤ ③ ROADSIDE

703072 - PAINTED ASSEMBLY
703072G - GALVANIZED ASSEMBLY

ITEM NO.	QTY.	PAINTED PART#	GALVANIZED PART#	DESCRIPTION
1	2	702939	702939G	BMPR,GUS,IBM,FIXED,REINF,CAN,CLOSEOUT
2	1	702932	702932G	BMPR,GUS,FIXED,IBM,REINF,1B,CB,20IN
3	1	702933	702933G	BMPR,GUS,FIXED,IBM,REINF,1B,CB,20IN
4	1	702934	702934G	BMPR,GUS,FIXED,IBM,REINF,2B,CB,20IN
5	1	702935	702935G	BMPR,GUS,IBM,FIXED,REINF,2B,CB,20IN

703072/703072G

701753.SLDDRW

THIS DRAWING IS LOANED FOR PURPOSE OF ENGINEERING STUDY ONLY WITH THE UNDERSTANDING THAT IT SHALL BE HELD IN CONFIDENCE AND FOR THE PURPOSES OF STRICK TRAILERS, LLC. IT IS NOT TO BE REPRODUCED, COPIED, USED, DISCLOSED OR DISPOSED OF DIRECTLY OR INDIRECTLY AND IS NOT TO BE USED IN WHOLE OR IN PART TO ASSIST IN MAKING OR TO FURNISH ANY INFORMATION FOR MAKING OF DRAWINGS PRINTS APPARATUS EQUIPMENT MATERIALS OR PARTS THEREOF EXCEPT IN ACCORDANCE WITH THE EXPRESS WRITTEN CONSENT OF STRICK TRAILERS, LLC.

TOLERANCES UNLESS OTHERWISE SPECIFIED
FABRICATED PARTS DECIMAL = ±.005"
ASSEMBLY'S DECIMAL = ±.031"
ANGULAR ±1°

DRAWN: RNH DATE: 08/19/14
CHECKED: DATE:

Sheet 1 of 2

MATERIAL: x

STRICK STRICK TRAILERS, LLC MONROE, IN 48772 SW

FIELD,INST,RIG,UPG,59653/54,RA,PH

703072/703072G

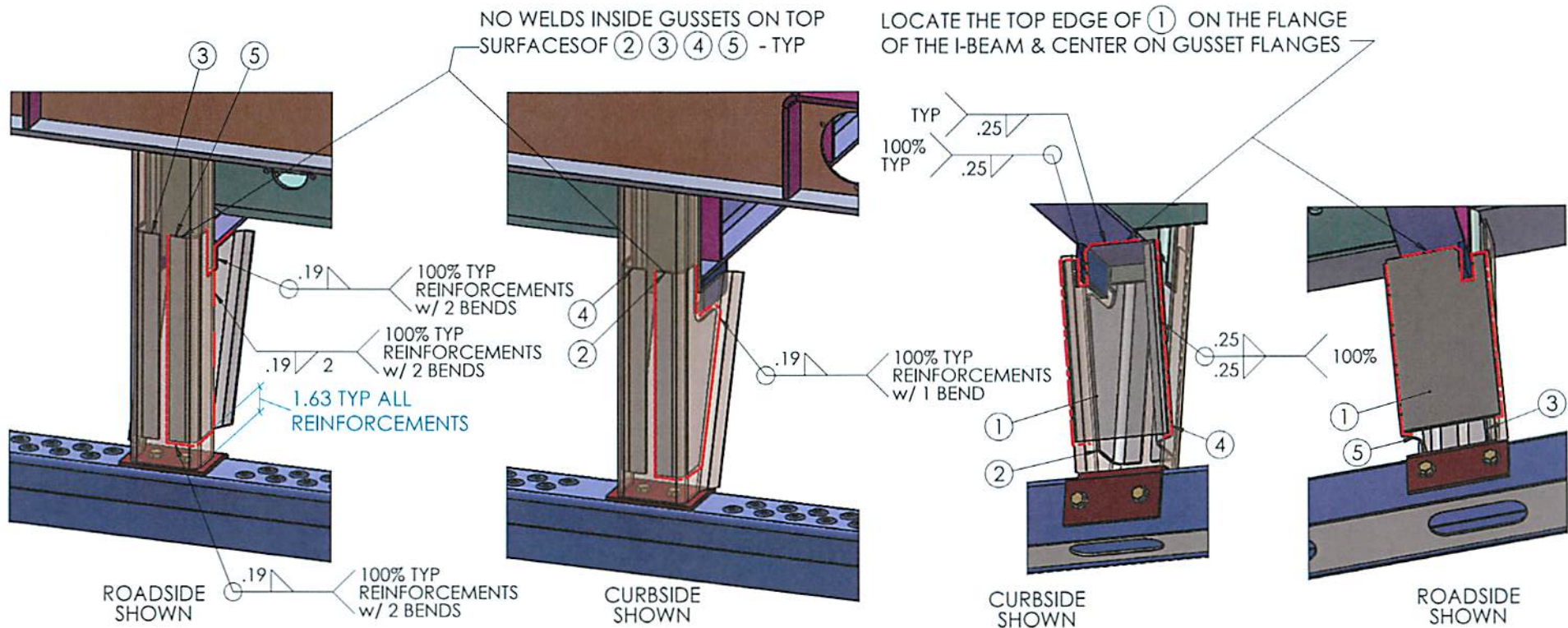

TYP WELDING DETAILS
DOUBLE BEND
GUSSET REINFORCEMENT

TYP WELDING DETAILS
SINGLE BEND
GUSSET REINFORCEMENT

TYP WELDING DETAILS
NOTCHED GUSSET
CLOSEOUT PLATE

703072 - PAINTED ASSEMBLY
703072G - GALVANIZED ASSEMBLY

TOLERANCES UNLESS OTHERWISE SPECIFIED FABRICATED PARTS DECIMAL = ± .001"		DRAWN RNH	DATE 08/19/14	MATERIAL: x	
ASSEMBLY'S DECIMAL = ± .031"		CHECKED	DATE	STRICK STRICK TRAILERS, LLC MONROE, IN 46772 SW	
ANGULAR ± 1°				FIELD, INST, RIG, UPG, 59653/54, RA, PH	
THIS DRAWING IS LOANED FOR PURPOSE OF ENGINEERING STUDY ONLY WITH THE UNDERSTANDING THAT IT SHALL BE HELD IN CONFIDENCE AND FOR THE PURPOSES OF STRICK TRAILERS, LLC. IT IS NOT TO BE REPRODUCED, COPIED, USED, DISCLOSED OR DISPOSED OF DIRECTLY OR INDIRECTLY AND IS NOT TO BE USED IN WHOLE OR IN PART TO ASSIST IN MAKING OR TO FURNISH ANY INFORMATION FOR MAKING OF DRAWINGS PRINTS APPARATUS EQUIPMENT MATERIALS OR PARTS THEREOF EXCEPT IN ACCORDANCE WITH THE EXPRESS WRITTEN CONSENT OF STRICK TRAILERS, LLC.				PART NUMBER 703072/703072G	
703072/703072G				Sheet 2 of 2	