

June 16, 2015

00407-01886 Version 5

Safety Recall: Front Passenger's Airbag Inflator May Produce Excessive Pressure After Long-Term Exposure To High Absolute Humidity

Supersedes 14-070, dated April 24, 2015; see Revision Summary

Supersedes 14-046, *Recall: Front Passenger's Airbag Inflator May Produce Excessive Pressure After Long-Term Exposure To High Absolute Humidity*

Supersedes 14-040, *Safety Recall: Front Passenger's Airbag Inflator Can Be Over-Pressurized*

Supersedes 13-034, *Safety Recall: Front Passenger's Airbag Inflator Can Be Over-Pressurized*

AFFECTED VEHICLES

| Year | Model | Trim | VIN Range |
|---------|-----------|------|---|
| 2002–05 | CR-V | ALL | Check the iN VIN status for eligibility |
| 2003–04 | Element | ALL | Check the iN VIN status for eligibility |
| 2002–04 | Odyssey | ALL | Check the iN VIN status for eligibility |
| 2003–05 | Pilot | ALL | Check the iN VIN status for eligibility |
| 2006 | Ridgeline | ALL | Check the iN VIN status for eligibility |

REVISION SUMMARY

As the result of Takata defect determinations and NHTSA directives, American Honda has moved the 2003-05 Accord, 2001–05 Civic, 2001–04 Civic GX, and 2003–05 Civic Hybrid from this airbag inflator campaign into SB 15-041, *Safety Recall: Front Passenger's Airbag Inflator Can Be Over-Pressurized*. **If an RO was opened on June 14, 2015 or earlier for these vehicles, use the included warranty information to file a claim. Any applicable vehicles with an RO date on June 15, 2015 or later, refer to SB 15-041.**

BACKGROUND

Certain Honda vehicles operated in areas known for high absolute humidity may contain a front passenger's airbag that, over time, may be affected by exposure to the humidity, which could produce excessive internal pressure upon deployment. If an affected airbag deploys, the increased internal pressure may cause the inflator casing to rupture. Metal fragments could be propelled upward toward the windshield, or downward toward the front passenger's foot well, possibly causing an injury to vehicle occupants.

CUSTOMER INFORMATION: The information in this bulletin is intended for use only by skilled technicians who have the proper tools, equipment, and training to correctly and safely maintain your vehicle. These procedures should not be attempted by "do-it-yourselfers," and you should not assume this bulletin applies to your vehicle, or that your vehicle has the condition described. To determine whether this information applies, contact an authorized Honda automobile dealer.

Affected Honda vehicles were sold and/or registered in the following geographic locations: Alabama, Florida, Georgia, Hawaii, Louisiana, Mississippi, South Carolina, Texas, Puerto Rico, Guam, Saipan, American Samoa, and the U.S. Virgin Islands.

NOTE: If the VIN status inquiry indicates that the vehicle is subject to any open safety recalls, including a driver's airbag inflator campaign/recall, make sure to also complete those recall repairs before returning the vehicle to the customer. If you are unable to complete any open recall, advise the customer of the recall status and when the recall could be completed.

CUSTOMER NOTIFICATION

Owners of affected vehicles will be sent a notification of this campaign.

Do an iN VIN status inquiry to make sure the vehicle is shown as eligible.

Some vehicles affected by this campaign may be in your used vehicle inventory. These vehicles must be repaired before they are sold.

Should your dealership sell an unrepaired vehicle that subsequently causes injury or damage because of the recalled item, the dealership will be solely responsible to the damaged party, and will be required to defend and indemnify American Honda for any resulting claims. To see if a vehicle in inventory is affected by this recall, do a VIN status inquiry before selling it.

CORRECTIVE ACTION

Replace the passenger's airbag inflator, then return the original, undeployed inflator as directed.

PARTS INFORMATION

| Part Name | Part Number Ordered | You may receive any of the following | Quantity |
|---|---------------------|--------------------------------------|----------|
| 2002–04 CR-V Front Passenger's Airbag Inflator Kit | 04785-S9A-307 | 04785-S9A-307 04790-S9A-308 | 1 |
| 2005 CR-V Front Passenger's Airbag Inflator Kit | 04785-S9A-306 | N/A | 1 |
| 2003–04 Element Front Passenger's Airbag Inflator Kit | 04785-SCV-307 | N/A | 1 |
| 2002 Odyssey Front Passenger's Airbag Inflator Kit | 04785-S0X-307 | N/A | 1 |
| 2003–04 Odyssey Front Passenger's Airbag Inflator Kit | 04785-S0X-306 | N/A | 1 |
| 2003–04 Pilot Front Passenger's Airbag Inflator Kit | 04785-S9V-307 | N/A | 1 |
| 2005 Pilot Front Passenger's Airbag Inflator Kit | 04785-S9V-306 | N/A | 1 |
| 2006 Ridgeline Front Passenger's Airbag Inflator Kit | 04785-SJC-307 | N/A | 1 |

NOTE:

- The inflator kit box must be used to return the recalled inflator to its supplier, ideally within 48 hours of the repair. Be careful not to damage the inflator kit box.
- If the recalled, undeployed inflator is not returned, the warranty claim for that vehicle will be charged back to your dealership.
- Follow the shipping instructions supplied with the inflator kit. If you have any questions about shipping, call Warranty Parts Inspection (WPI) at **937-642-2737**.
- If you are a dealer in Alaska, Hawaii, Puerto Rico, Guam, Saipan, American Samoa, or the U.S. Virgin Islands call the WPI administrative office at **937-642-2737** for special instructions; do not use the documentation included in the airbag inflator kit.

WARRANTY CLAIM INFORMATION

NOTE:

- Process claims as quickly as possible so that resources can be properly allocated.
- Enter the part number of the inflator that you received into the warranty claim, **not the part number that you ordered**. For more information, refer to step 1 of REPAIR PROCEDURE.
- To avoid non-payment of warranty claims, the serial number on the box of the new airbag inflator must be entered in the Diagnostic Trouble Codes field on each warranty claim. For more information, refer to step 1 of REPAIR PROCEDURE.
- To avoid a warranty claim being charged back to your dealership, you must return the recalled, undeployed inflator to its supplier. Follow the shipping instructions supplied with the inflator kit. If you have any questions about shipping, call Warranty Parts Inspection (WPI) at **937-642-2737**.
- **The Accord and Civic warranty information is included in case you opened an RO on or before June 14, 2015.** Refer to S/B 15-041 for any repairs made after that date.

Replacing the front passenger's airbag inflator

| Year/ Model | Operation Number | Replacement Part number | Flat Rate Time | Defect Code | Symptom Code | Template ID | Failed Part Number |
|---|---------------------|----------------------------|-------------------|----------------|-----------------|-------------|--------------------|
| 2003 Accord | 7541B0 | 04785-SDA-307 | 0.7 hr | 5KN00 | JL800 | 14-070Z | 06780-SDN-A90ZA |
| | | 04790-SDA-308 | 0.7 hr | 5KN00 | JL800 | 14-070Y | 06780-SDN-A90ZA |
| 2004–05 Accord | 7541B0 | 04785-SDA-306 | 0.7 hr | 5KN00 | JL800 | 14-070X | 06780-SDN-A90ZA |
| 2001–05 Civic 2001–04 Civic GX 2003–05 Civic Hybrid | 7541B0 | 04785-S5A-307 | 0.7 hr | 5KN00 | JL900 | 14-070W | 06780-S5A-A80ZA |
| | | 04790-S5A-308 | 0.7 hr | 5KN00 | JL900 | 14-070V | 06780-S5A-A80ZA |
| 2002–04 CR-V | 7541B0 | 04785-S9A-307 | 0.7 hr | 5KN00 | JM000 | 14-070U | 06780-S9A-A80ZA |
| | | 04790-S9A-308 | 0.7 hr | 5KN00 | JM000 | 14-070T | 06780-S9A-A80ZA |
| 2005 CR-V | 7541B0 | 04785-S9A-306 | 0.7 hr | 5KN00 | JM000 | 14-070S | 06780-S9A-A80ZA |
| 2003–04 Element | 7541B0 | 04785-SCV-307 | 0.8 hr | 5KN00 | JM100 | 14-070R | 06780-SCV-A80ZA |
| 2002 Odyssey | 7541B1 | 04785-S0X-307 | 0.7 hr | 5WX00 | JM200 | 14-070Q | 06780-S0X-A70ZA |
| 2003–04 Odyssey | 7541B1 | 04785-S0X-306 | 0.7 hr | 5WX00 | JM200 | 14-070P | 06780-S0X-A70ZA |
| 2003–04 Pilot | 7541B1 | 04785-S9V-307 | 0.8 hr | 5WX00 | JM300 | 14-070O | 06780-S9V-A81ZC |
| 2005 Pilot | 7541B1 | 04785-S9V-306 | 0.8 hr | 5WX00 | JM300 | 14-070N | 06780-S9V-A81ZC |
| 2006 Ridgeline | 7541B1 | 04785-SJC-307 | 0.7 hr | 5WX00 | JM400 | 14-070M | 77820-SJC-A00ZA |

Skill Level: Repair Technician

REPAIR PROCEDURE

NOTE:

- If the VIN status inquiry indicates that the vehicle is subject to any open safety recalls, including a driver's airbag inflator campaign/recall, make sure to also complete those recall repairs before returning the vehicle to the customer. If you are unable to complete any open recall, advise the customer of the recall status and when the recall could be completed.
 - Be careful not to damage any parts when replacing the inflator, and **follow the procedure exactly**.
 - If, before removing the airbag, you suspect that it may be the incorrect airbag for the vehicle or a counterfeit, **do not remove the airbag**. Contact your DPSM for assistance.
1. Peel the label located inside the inflator box from its backing and attach it to the RO. For the warranty claim to be paid, the **replacement inflator part number that you received** must be on the warranty claim and your warranty clerk must enter the serial number in the Diagnostic Trouble Codes field.

NOTE:

- The replacement part number is printed on the top part of the label and the serial number is printed on the bottom. **Make sure you attach the label to the RO and give it to the warranty clerk.**
- There may also be a colored sticker located in the kit, ignore it because it is not used.
- Not all inflator kits have a label included. In those cases, write the serial number and part number from the side of the inflator box on the RO. The part number always starts with 047.

PASSENGER INFLATOR PARTS BOX

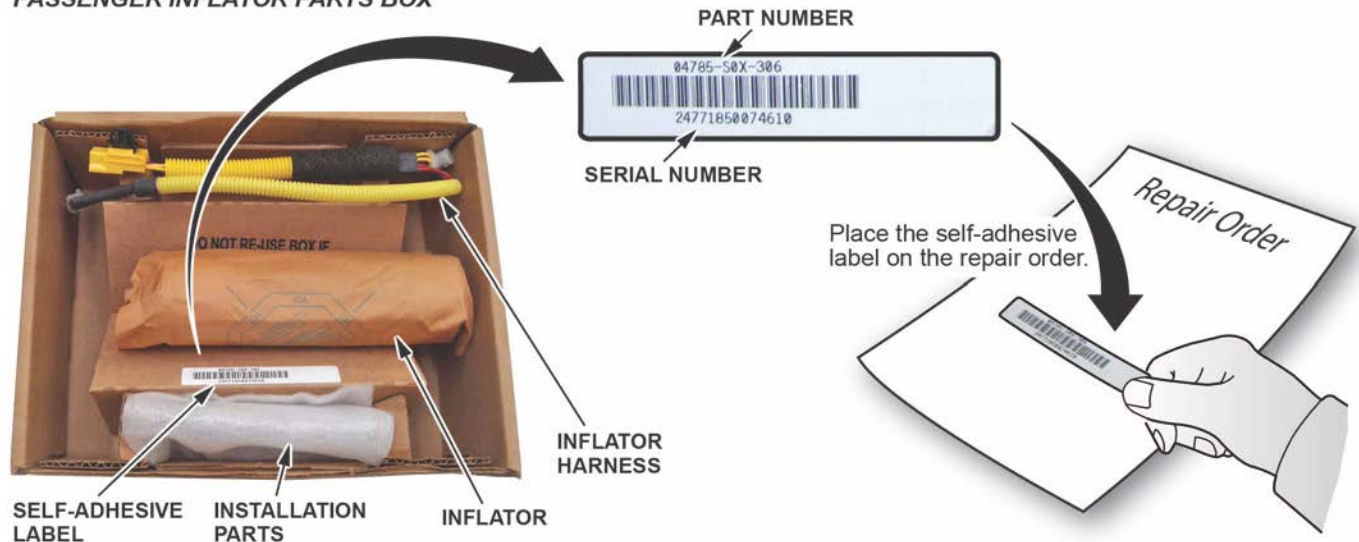

2. Remove the front passenger's airbag.
3. Place the airbag, face-down, on a clean shop towel.

NOTE:

- The orientation of the airbag is critical because if the inflator is installed incorrectly, the harness will be too short when you reinstall the airbag.
- The brackets between the various models are similar but may differ from the example shown.



4. Visually inspect the airbag and the inflator for any unusual writing or markings.

- If there is nothing unusual about the airbag or the inflator, go to step 5.
- If there are any unusual markings, like an incorrect label or a model year written in marker, the airbag and inflator may not be the correct airbag and/or inflator for the vehicle or it may be a counterfeit part. For more information about counterfeit airbags, you can refer to safercar.gov, enter keywords **MANAGING COUNTERFEIT**, and select **Recommended Dealer Guidance for Managing Counterfeit Air Bags** from the list. **If you suspect that the airbag or inflator is counterfeit, do not continue this procedure.** Contact your DPSM for assistance.

NON-STANDARD SAFETY LABEL

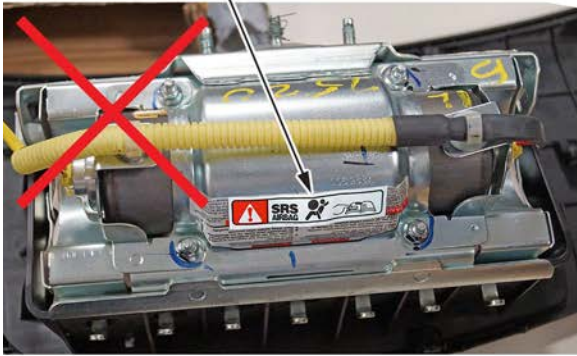

GREASE PENCIL OR PAINT MARKINGS

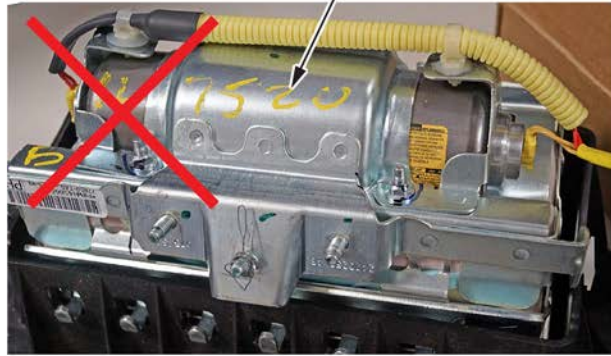

HAND ENGRAVING



NO LABELS ON INFLATOR



5. Remove the harness from both ends of the inflator bracket.

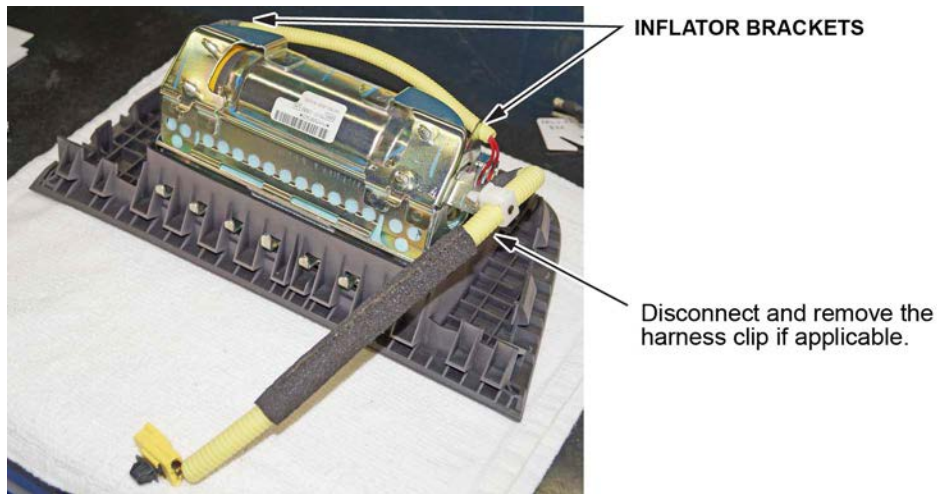

6. Short the red wires.

NOTE: You must cut and short the wires as indicated to prevent accidental deployment.

- Cut the red wires as shown.

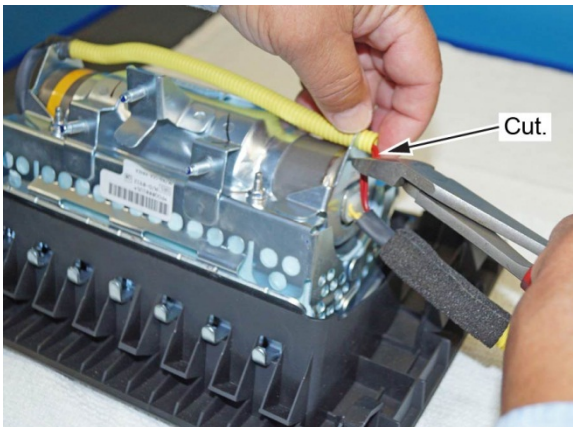

- Cut about 2 inches of the corrugated tube, then pull out the two red wires.

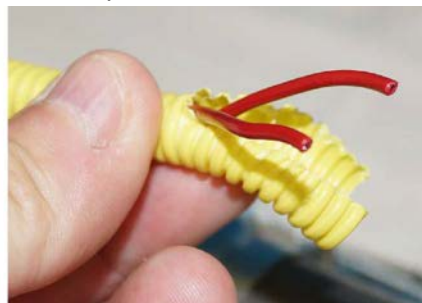
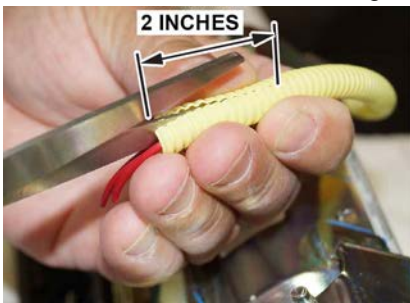

- Strip away about 1 inch of the wire insulation, then twist the wires together.

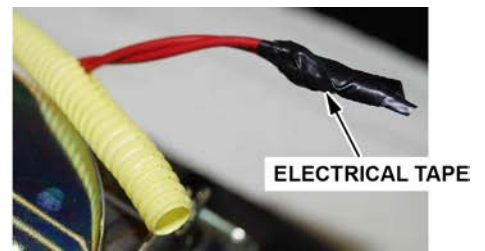
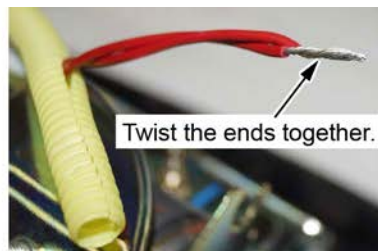
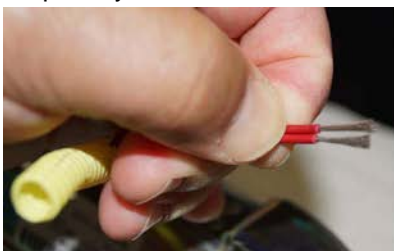

- Tape the twisted ends with electrical tape.

7. Cut off the connector and short the yellow wires.

You must cut and short the wires as indicated to prevent accidental deployment.

- Cut all four wires to remove the connector.

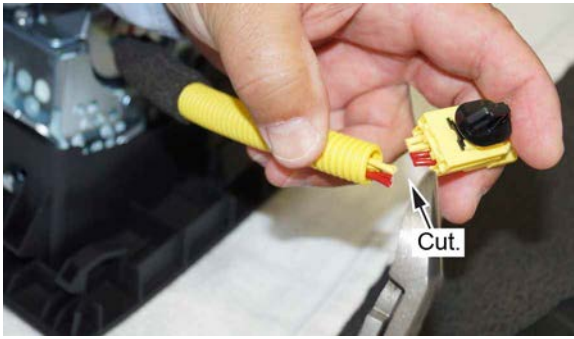

- Cut about 2 inches of the corrugated tube, then pull out the yellow wires.

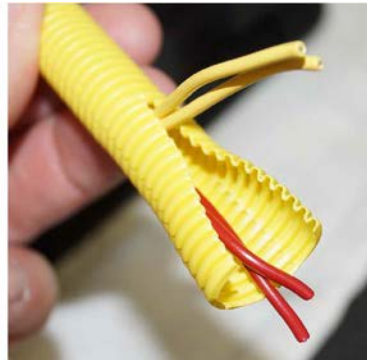
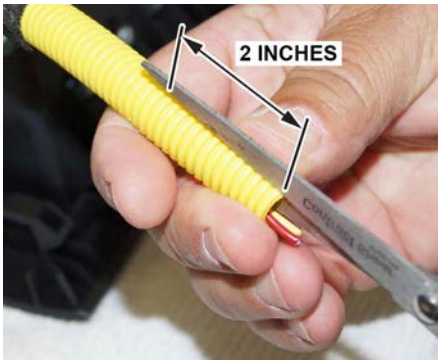

- Strip away about an inch of the wire insulation, then twist the wire ends together.

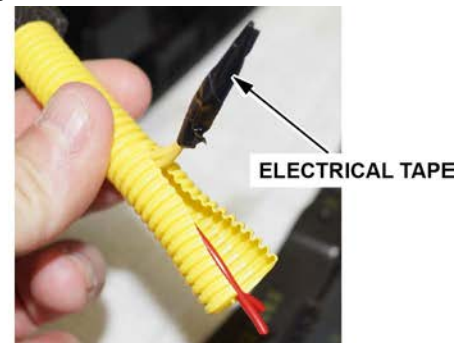
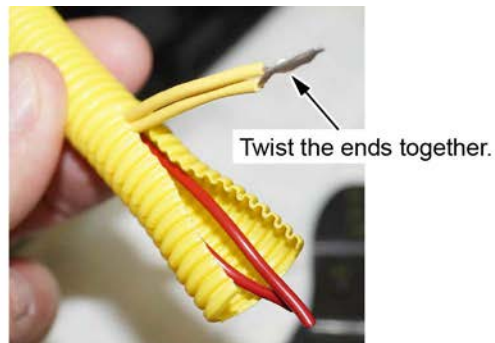
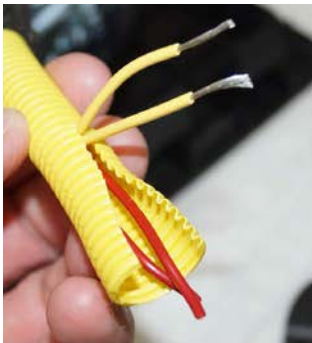

- Tape the twisted ends with electrical tape.

8. Remove the four inflator nuts.

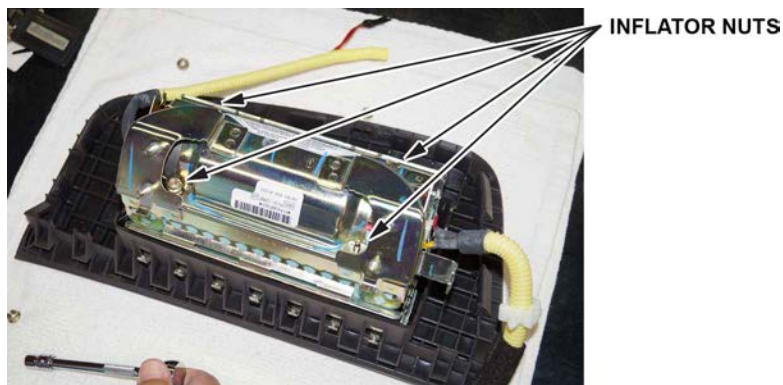

9. Remove the inflator bracket.

NOTE: You can only remove one of the brackets, as the other is welded to the airbag housing.

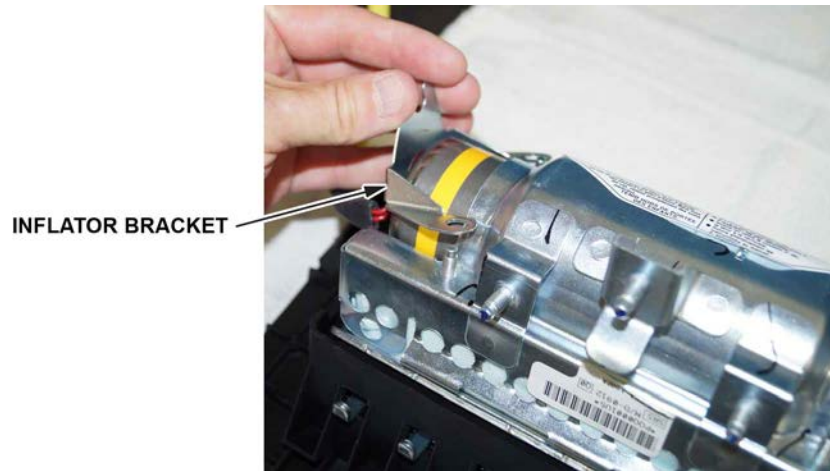

10. Remove the inflator by pushing it out.

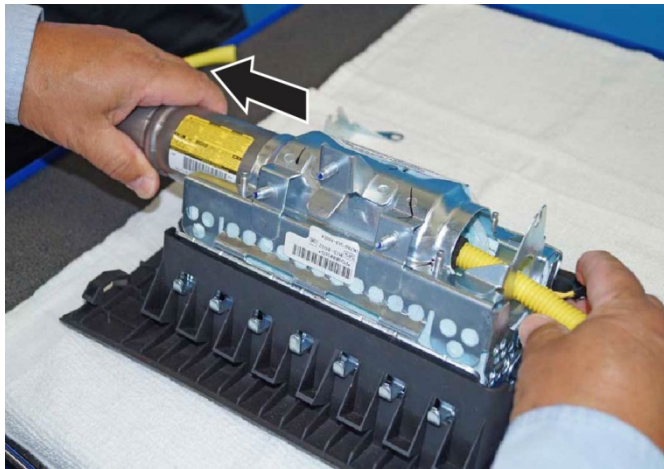

11. Install the new inflator.

Click on the image below for a short video about the different variations of the driver's and front passenger's replacement inflators involved with the recalls related to inflators. While both the driver's and front passenger's inflators are shown in the video, this is informational only. Replace inflators only as directed by the iN VIN status inquiry.



Check your part number against the ones listed for each installation procedure. Use the correct installation procedure for the part you received.

Part Number

04785-S9A-307
04785-S9A-306
04785-SCV-307
04785-S0X-307
04785-S0X-306
04785-S9V-307
04785-S9V-306
04785-SJC-307

- One connector looks like a “D” whereas the other connector is a circle. Make sure you insert the “D” shaped terminal into the airbag first.

NOTE: There is a yellow band marking on the circle side.

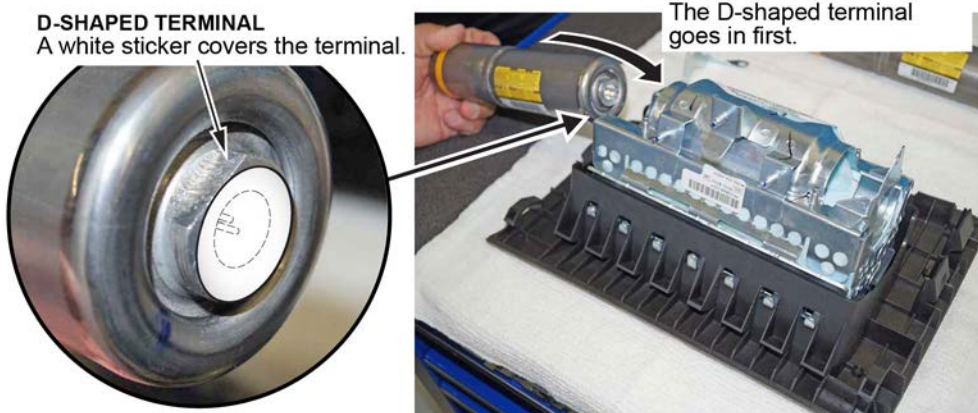

- Slide the inflator in until the “D” aligns with the tab on the inflator bracket. There should be no space or gap between the inflator and bracket.



No gap.

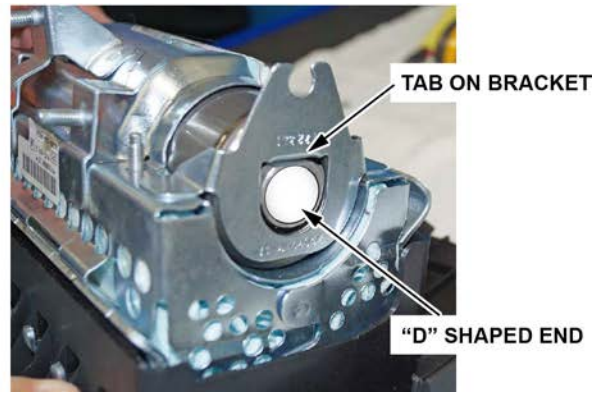

- Reinstall the inflator bracket. There should be no space or gap between the bracket and inflator.

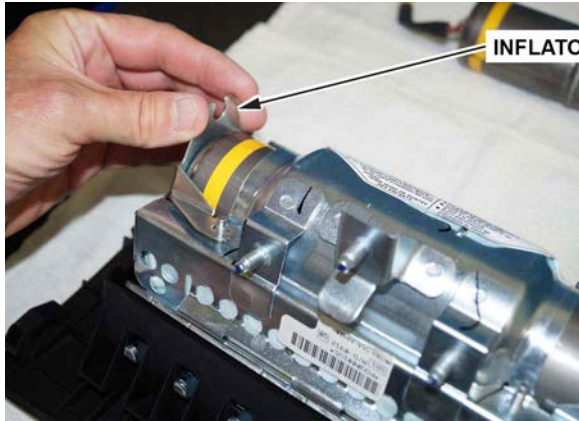

Check your part number against the ones listed for each installation procedure. Use the correct installation procedure for the part you received.

Part Number

04790-S9A-308

- One side of the inflator has a longer collar, a longer tab, a plastic cutout, and a small flat spot on the connector. The other side of the inflator has a shorter collar, a shorter tab, and a red dot. Make sure you insert the end with the longer collar into the airbag first.

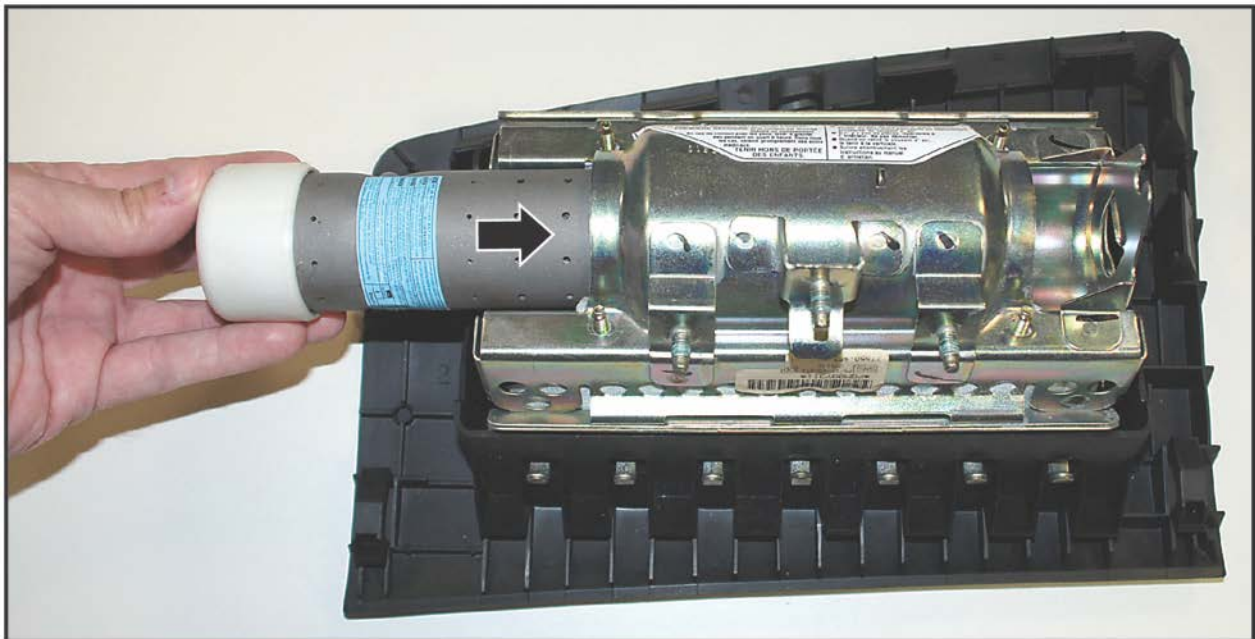
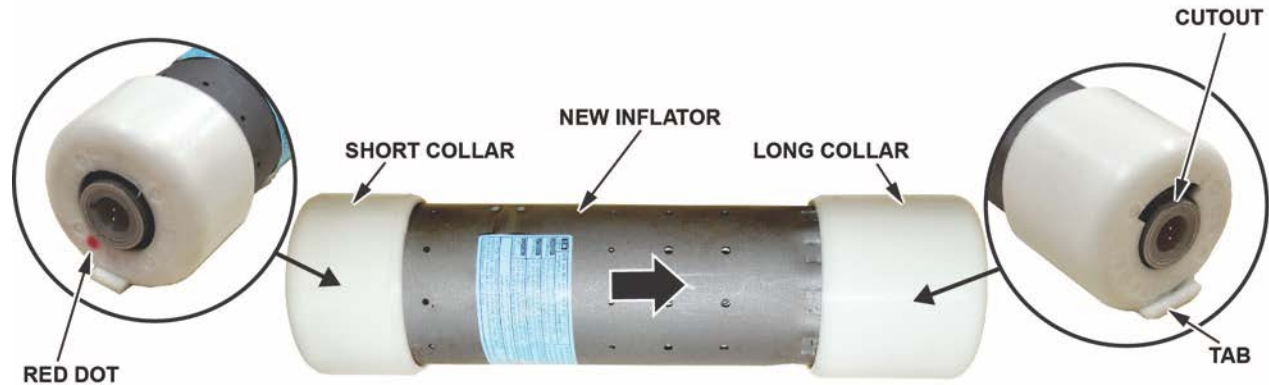

- Slide the inflator in until the plastic cutout and the small flat spot align with the tab on the bracket. There should be no space or gap between the inflator and bracket.

FIXED BRACKET END

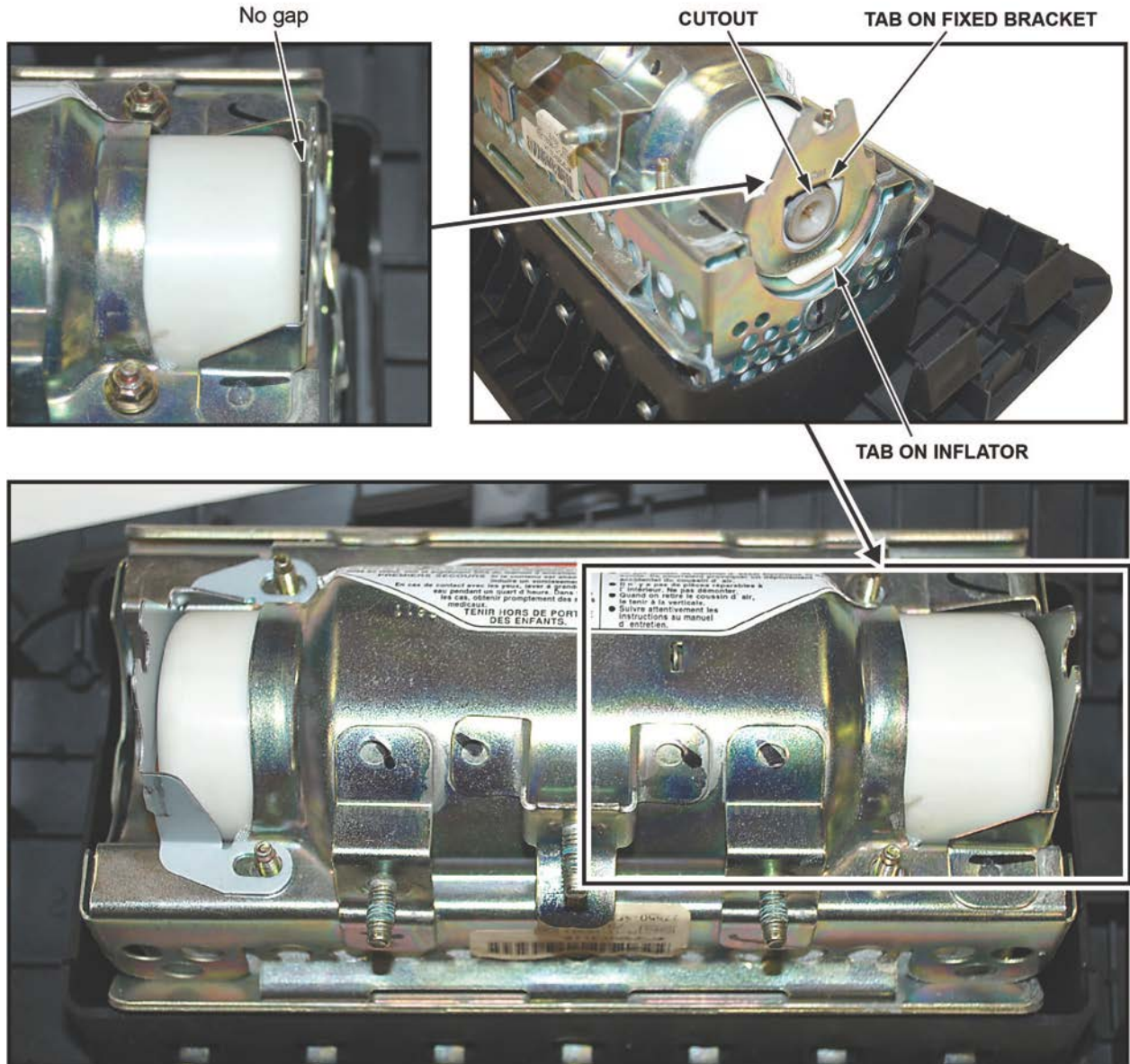

- Install the bracket included in the kit onto the airbag module. There should be a red dot visible on the end of the plastic connector. There should be no space or gap between the inflator and bracket.

ADJUSTABLE BRACKET END

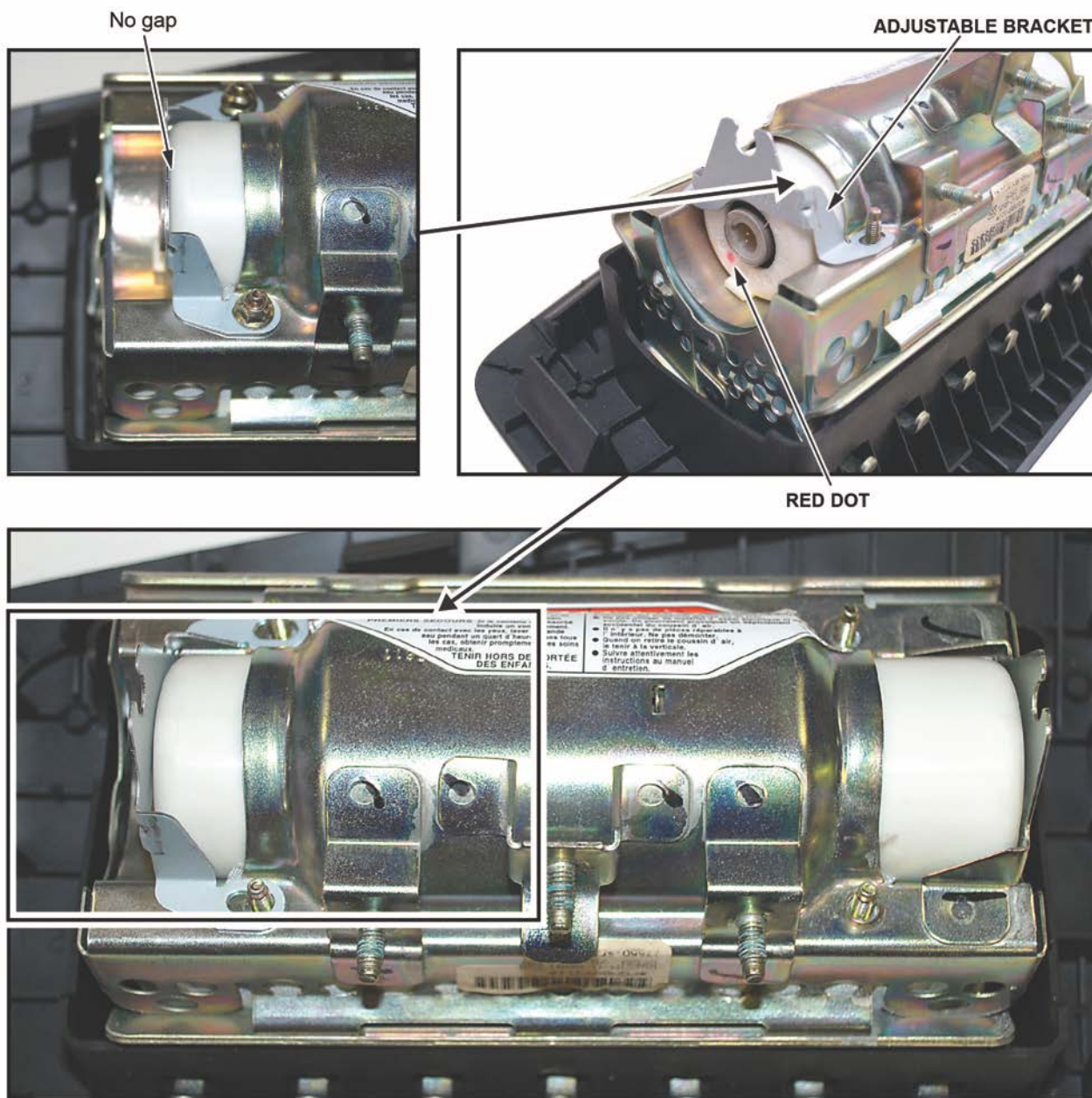

12. Install the new 5 mm locknuts and torque them in sequence to **3.9 N•m (34 lb-in)**.

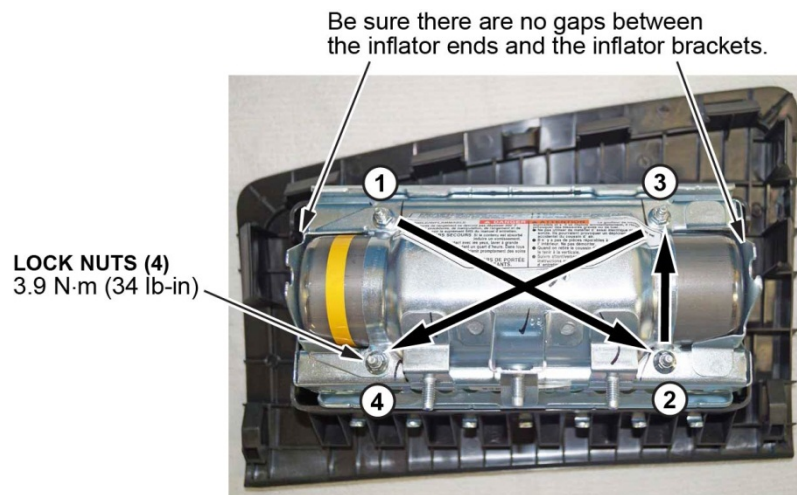

13. Remove the stickers covering the terminals on both sides of the new inflator.



14. Install the new inflator harness.

- Make sure the airbag and harness are aligned as shown.

NOTE:

- **Make sure you have the orientation correct as shown below.** If you connect the harness incorrectly, the harness cannot be removed, and you will not be able to reinstall the airbag because the harness will be too short.
- On the replacement inflators with plastic collars, connect the red wire connector to the connector with the red dot.
- On the replacement inflators without plastic collars, connect the red wire connector to the connector nearest the yellow band.

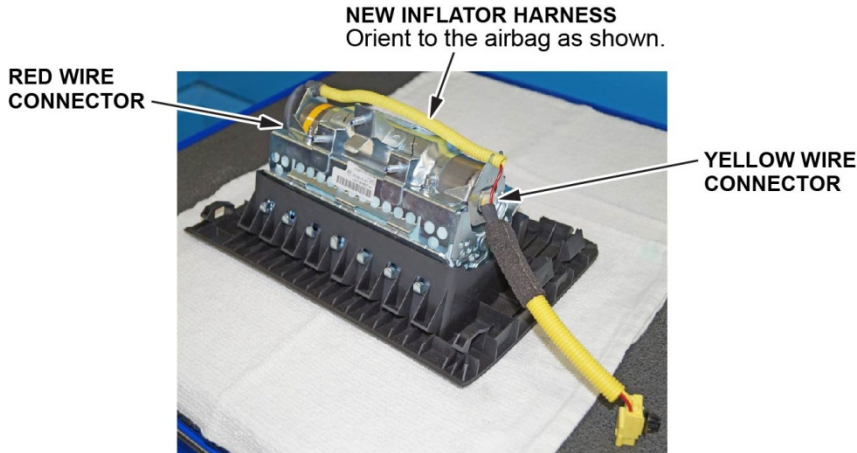

- Connect the two connectors. Align the "T" shape in the inflator harness connector with the T-shaped inflator connector, then press the connector into place.

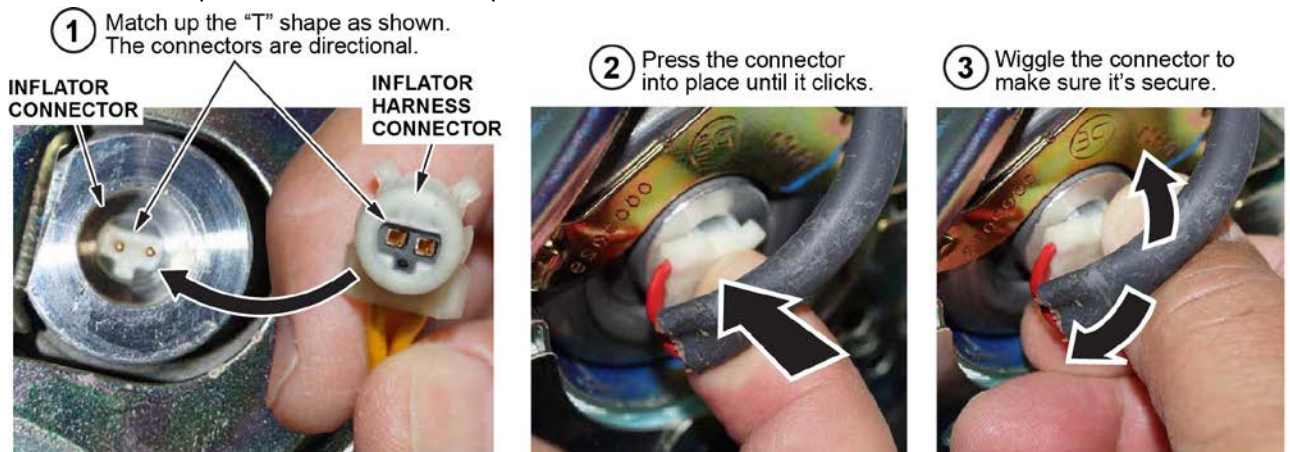

- After you hear each connector click, wiggle it to make sure it is secure.

NOTE: If the connector is not properly aligned, it will come out.

15. Connect the harness to the inflator brackets.

- Insert the side without the shrink-wrap tubing first. Insert the harness at the third “valley” in the corrugated tube.
- Insert the side of the harness with the shrink-wrap tubing into the inflator bracket. Make sure the harness is securely inserted and that it does not sag.

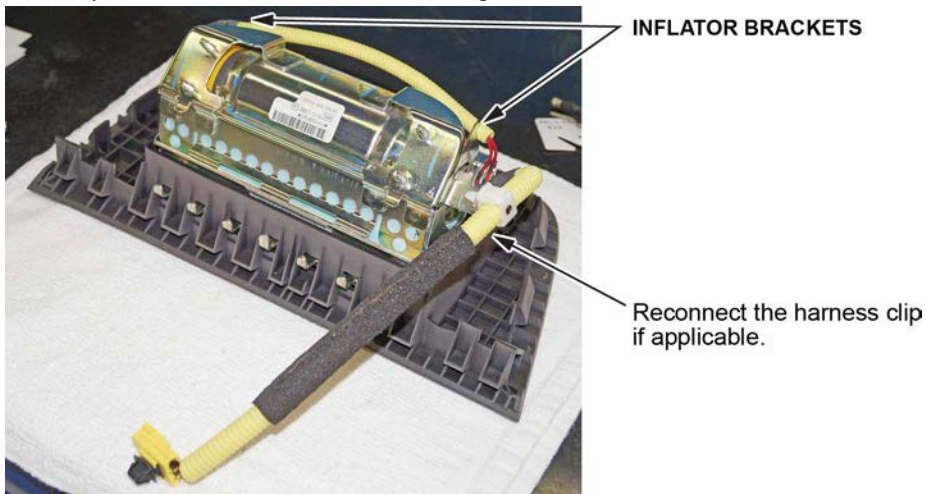

16. Reinstall the passenger's airbag into the vehicle and torque the new locknuts to **9.8 N•m (7.2 lb-ft)**.

17. Do the idle learn procedure (2003-04 CR-V, 2002-04 Odyssey, 2003-04 Pilot).

- Make sure all electrical items (A/C, audio unit, defogger, lights, etc.) are turned off, then start the engine.
- Let the engine reach its normal operating temperature (the cooling fans cycle twice; the coolant temperature is about 194° F).
- Let the engine idle for at least 5 minutes with the throttle fully closed and with all electrical items turned off.
- If the cooling fans cycle on while doing an idle learn, add the time the cooling fans are on to the 5 minute idle learn time.

18. Put the original inflator into the box the new one came in. Make sure there is no other hardware in the box because if the package rattles, it will not be accepted by the courier.

19. Follow the shipping instructions supplied with the inflator kit to return the undeployed inflator. If you have any questions about shipping, call Warranty Parts Inspection (WPI) at **937-642-2737**.

20. Give your warranty clerk the RO that includes the inflator serial number and replacement part number. For the warranty claim to be paid, the **replacement inflator part number** must be on the warranty claim and your warranty clerk must enter the serial number in the Diagnostic Trouble Codes field.

END