

Author: J. Juse	<b>Field Modification Instruction</b> <b>Elastomeric Bumper Bracket Installation</b>	<b>FMI 751-064</b> <b>08/05/14</b> <b>Rev: A</b>
--------------------	---	--

**Field Modification Instructions for Project:**

Elastomeric Bumper Bracket Mitigation

Mitigation for Recall Number 14E-041

J. Juse

08/05/2013

---

**Author**

**Date**

D. DeLeo

08/05/2014

---

**Director of Engineering**

**Date**

Author: J. Juse	<b>Field Modification Instruction</b> <b>Elastomeric Bumper Bracket Installation</b>	<b>FMI 751-064</b> <b>08/05/14</b> <b>Rev: A</b>
--------------------	---	--

**Subject:** Recall Number 14E-041 – Occurance of Fatigue Cracks in certain S-Series Wheelchair Lifts

**Reason:** Under certain conditions present in some applications, the platforms included on the potentially affected, S-Series model wheelchair lifts can exhibit cracking of the platform pivot plate while in the stowed position which, if left unchecked, can propagate to the point where separation of the rear portion of the pivot plate occurs rendering the lift potentially inoperable and possibly unsafe for the operator.

These instructions and the material herein referenced are intended to mitigate the circumstances that can potentially precipitate the referenced cracking that is the subject of Ricon Recall number 14E-041.

**Affected Units:**

Ricon DOT Public Use, "S" 2000 and 5500 Series lifts manufactured after January 1, 2006 equipped with platforms measuring 32"x51" and 34"x54". The affected population is comprised of six (6) primary model numbers:

S2005-XXXXXXXX S2010-XXXXXXXX S5005-XXXXXXXX	S5010-XXXXXXXX S5505-XXXXXXXX S5510-XXXXXXXX
--	--

**Approximate completion time:** 20 min

**Parts required:**

**Description**

Kit 57113 Kit, Bracket Elastomeric Mount, S55XX & S50XX  
 Kit 57114 Kit, Bracket Elastomeric Mount, S20XX

**Tools required:**

- (1) 7/16 Inch Open Wrench**
- (1) Marker**
- 1/8-Inch Drill Bit**
- 9/32-Inch Drill Bit**
- 3/8-Inch Drill Motor**
- 7/16-Inch Socket**
- 1/2-Inch Socket**
- Deburring tool**
- Spring Loaded Center Punch or equivalent tool for marking**
- Tape Measure**



## Field Modification Instruction Elastomeric Bumper Bracket Installation

3. Deploy wheelchair lift platform to ground level then remove both LH and RH inboard pinch point shields. Inboard pinch point shields will be replaced by new pinch point shields included in kit.
4. Refer to **Figure 1**. Measure 16 inches from inboard end (near baseplate) of upper parallel arm.

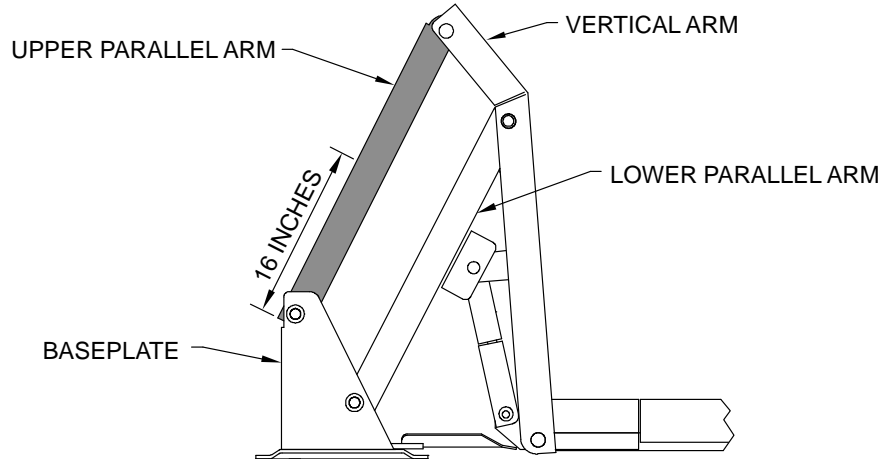

RSM0061600

**FIGURE 1: 16 INCH MEASUREMENT**

5. Refer to **Figure 2**. Align folded edge of paper template (P/N 55429) to bottom edge of upper parallel arm and align with 16 inch mark.

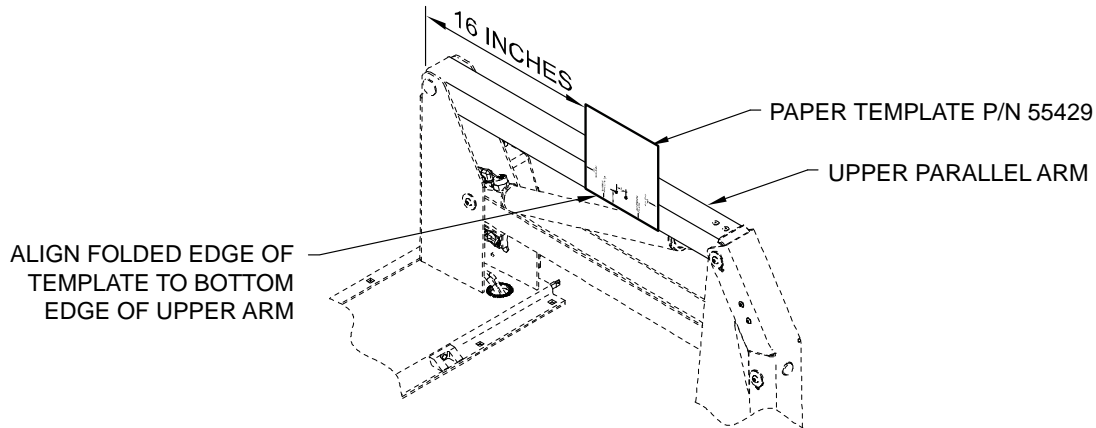

NOTE: PLATFORM AT GROUND LEVEL

RSM0061701

**FIGURE 2: PAPER TEMPLATE ALIGNMENT**

6. Square spring loaded center punch with centers located on paper template and mark both holes as shown for each parallel arm.



**FIGURE 3: Center Punch**

## Field Modification Instruction Elastomeric Bumper Bracket Installation

7. Retain paper template for use on opposite side upper parallel arm.
8. Refer to **Figure 4**. Drill a 1/8" pilot hole in each mark.

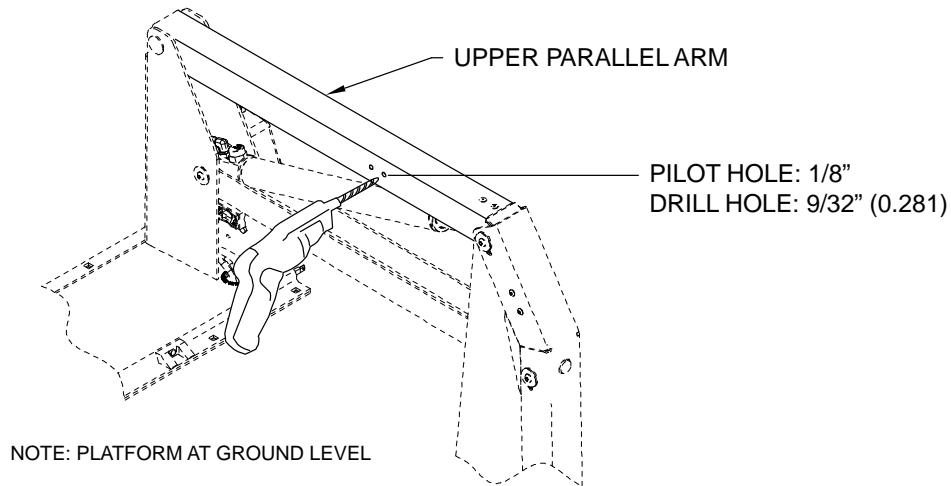

RSM0061900

**FIGURE 4: DRILL HOLES**

9. Refer to **Figure 4**. Then drill a 9/32" hole in each 1/8" pilot hole.
10. Deburr holes and clean any leftover debris from drilled holes.  
Note: Ensure metal chips are removed from inside lower arm.
11. Repeat procedures to mark and drill holes for opposite parallel arm.
12. Refer to **Figure 5**. Install Elastomeric Bumper Bracket Assemblies on both sides with hardware from applicable kit.  
Note: Ensure applicable kit is used for S20XX and S50XX size lifts.

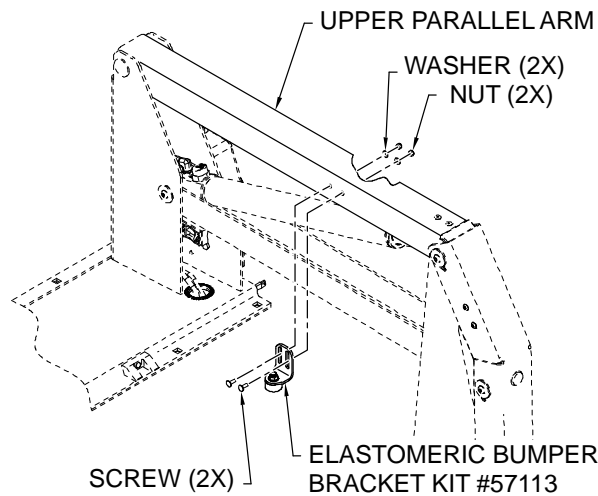

RSM0062000

**FIGURE 5: ELASTOMERIC BUMPER BRACKET INSTALLATION**

13. Refer to **Figure 6**. Tighten fasteners only to the point where they are snug enough to hold the bracket in its upper/outer most position so that it will be furthest point away from the platform when the lift is folded back up to its fully stowed position.



**FIGURE 6: HOLD BRACKET IN UPPER/OUTER MOST POSITION**

14. Refer to **Figure 7**. Return the lift to its fully stowed position. Use the hand pump to ensure that the platform is fully stowed.



**FIGURE 7: FULLY STOWED POSITION**

15. Refer to **Figure 8**. From inside the vehicle, slide each elastomeric bumper bracket assembly outboard to the point where it contacts the top of the platform side plate.



**FIGURE 8: Bracket Adjustment**

16. Deploy the lift to vehicle floor level and tighten the fasteners (75 in-lb).
17. Install the new inboard pinch shields that include the cut-out for the elastomeric bumper bracket as shown.

FOLD HERE SECOND

Align to 16 inch  
mark

Align to bottom edge  
of Upper Arm

1.125

FOLD HERE LAST  
FOLD AGAINST HARD EDGE

0.750

Align to bottom edge  
of Upper Arm

Align to 16 inch  
mark

FOLD HERE FIRST

PRINTING:

- Print PDF copy to "Actual" size to maintain 1:1 ratio. DO NOT print to "fit".
- Print DWG file to 1:1, Extents, Center. DO NOT print to "fit".