

**TECHNICAL INSTRUCTIONS**  
**FOR**  
**SAFETY RECALL E0L**  
**PHASE 2**  
**DRIVER SIDE AND PASSENGER SIDE SEAT TRACKS REPLACEMENT**  
**CERTAIN 2006-2010 YARIS 3 DOOR HATCHBACK**

All dealership associates involved in the recall process are required to successfully complete E-Learning course SC13A. To ensure that all vehicles have the repair performed correctly; technicians performing this recall repair are required to currently hold at least one of the following certifications levels:

- Toyota Certified (any classification)
- Toyota Expert (any classifications)
- Master
- Master Diagnostic Technicians

## I. OPERATION FLOW CHART

The flow chart is for reference only. **DO NOT** use it in place of the full technical instructions. Follow **ALL** steps as outlined in the full technical instructions to confirm the campaign is completed correctly.

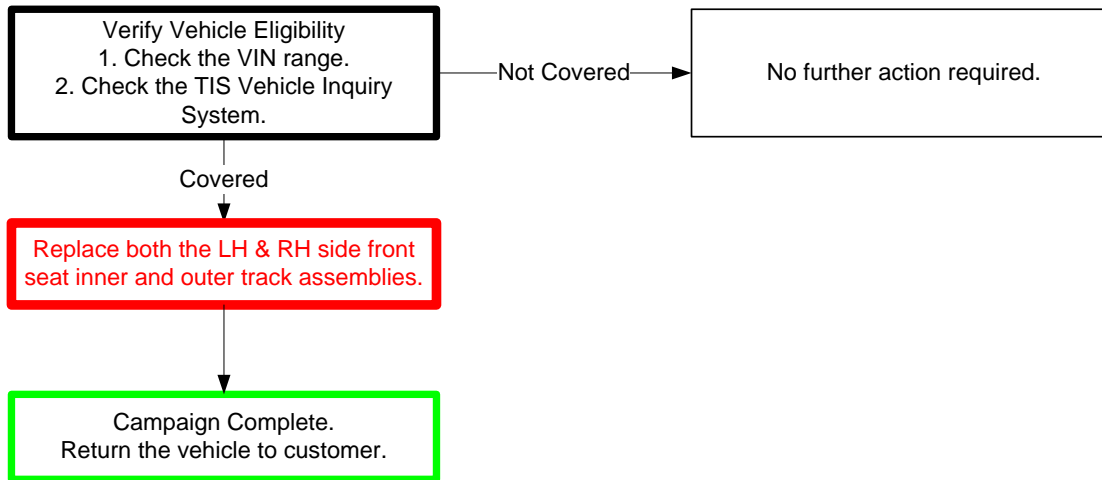

## II. BACKGROUND

In the seat rail of the driver and front passenger seats of the subject vehicles, the springs used for the mechanism which locks the seat rail in its adjusting positions could break. This can happen if the seat is adjusted forward and/or rearward with high frequency. If a seat rail spring breaks, the seat may not lock into the adjusted position. If the vehicle is operated with a broken seat rail spring, the seat could move in the event of a crash, increasing the risk of injury to the occupant.

### III. PREPARATION

#### A. PARTS

**Both parts kits are required to perform the campaign.**

##### Yaris 3 Door Hatchback Driver Seat Track

Part Number	Part Description	Quantity
04002-19252	Track Assy, FR Seat, LH	1
*The kit above contains the following parts		
72120 - 52051	TRACK ASSY, FR SEAT, OUTER LH	1
72118 - 52030	RAIL, FR INNER SEAT TRACK, LWR LH	1
72443 - 52010	NUT (INNER, Black)	4
90178 - 08012	NUT (OUTER, with thread locker)	4

##### Yaris 3 Door Hatchback Passenger Seat Track

Part Number	Part Description	Quantity
04004-36752	Track Assy, FR Seat, RH	1
*The kit above contains the following parts		
72110 - 52091	TRACK ASSY, FR SEAT, OUTER RH	1
72117 - 52060	RAIL, FR INNER SEAT TRACK, LWR RH	1
72443 - 52010	NUT (INNER, Black)	4
90178 - 08012	NUT (OUTER, with thread locker)	4
96160-00600	RING, E	1

#### B. TOOLS & EQUIPMENT

- Techstream
- Protective gloves
- T40 "Torx" socket
- Standard hand tools
- Seat cover
- Feeler gauge
- Torque wrench
- Round file

**SST-** These are essential special service tools that your dealership should have.

Part Number	Part Name	Quantity
00002-09090-01	Occupant Classification Seat Weight Set	1

#### CAMPAIGN TOOLS

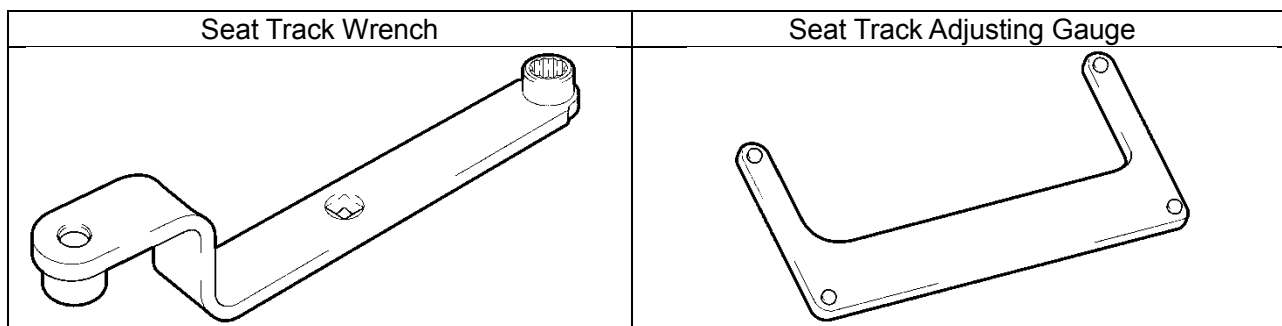

#### C. MATERIALS

- Protective Tape
- Protective Blanket
- Rope/Tie Down
- Packing Tape
- Adhesive 1324 medium strength thread locking compound (local source)

## IV. IDENTIFICATION OF AFFECTED VEHICLES

Check the TIS Vehicle Inquiry System to confirm the VIN is involved in this Safety Recall, and that the campaign has not already been completed prior to dealer shipment or by another dealer.

**TMS warranty will not reimburse dealers for repairs conducted on vehicles that are not affected or were completed by another dealer.**

## V. COMPONENTS

### A. DRIVER'S SEAT COMPONENTS

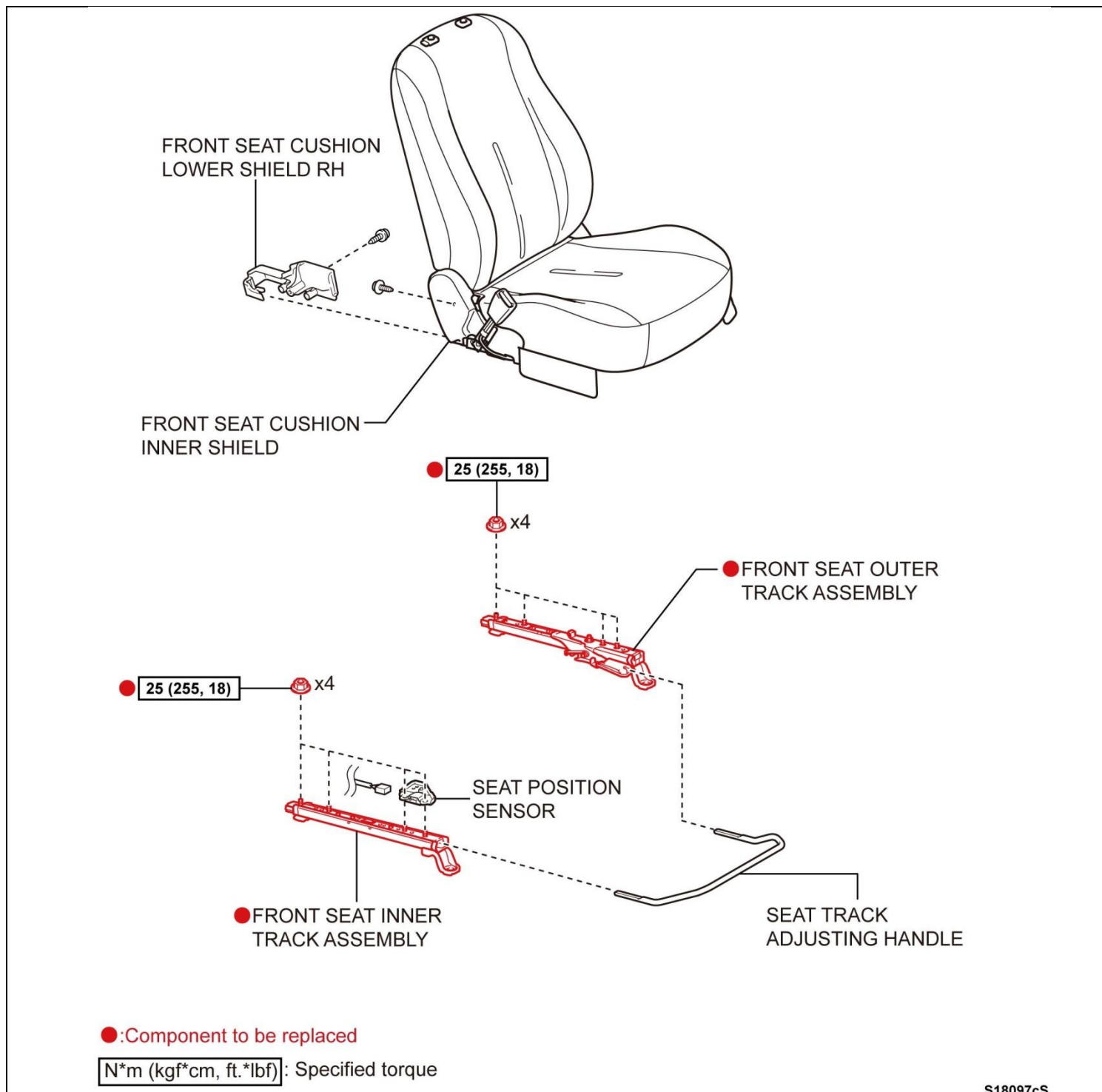

S18097cS

## B. PASSENGER SEAT COMPONENTS

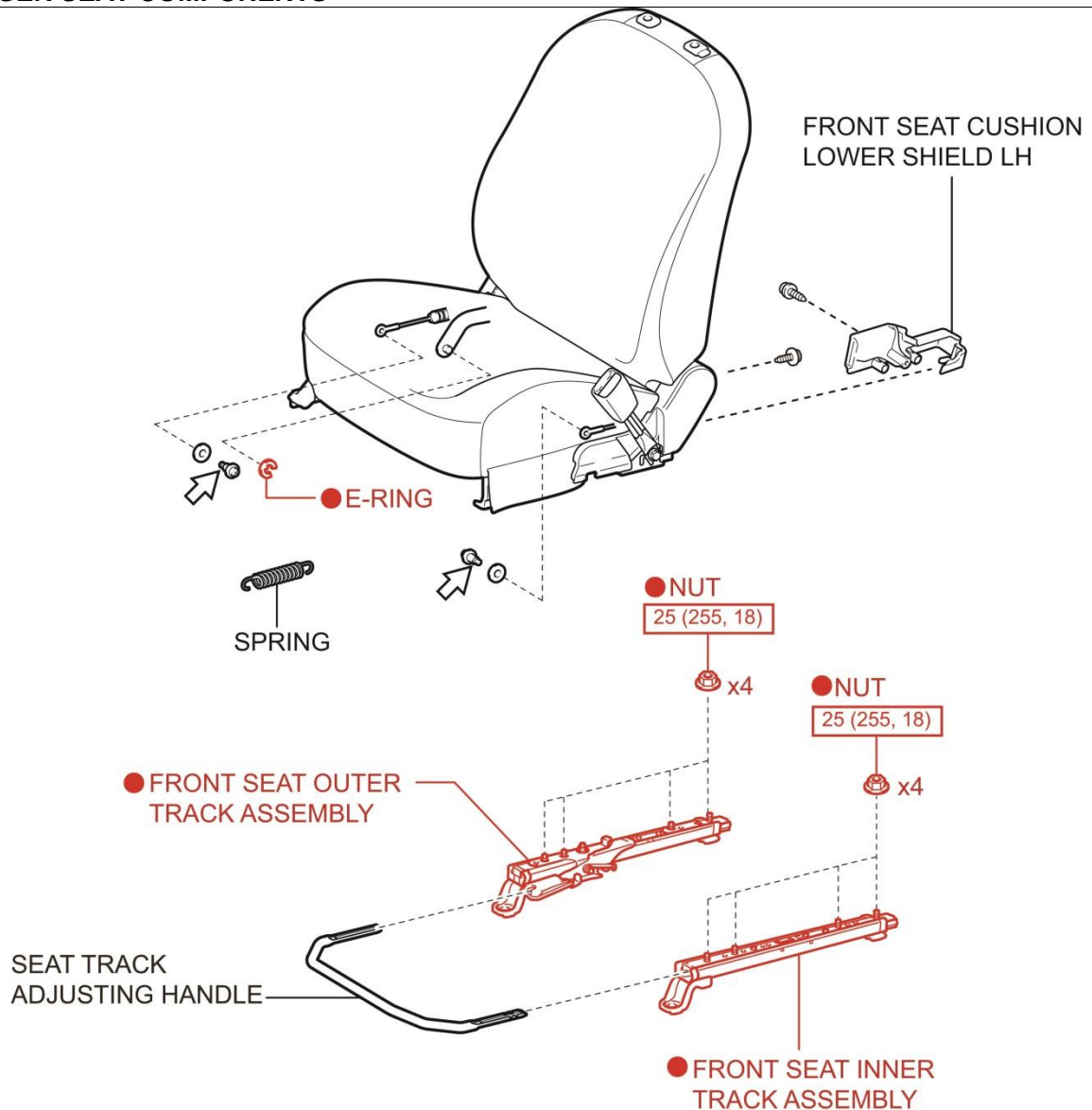

↩ Adhesive 1324

●:Component to be replaced

$\boxed{\text{N*m (kgf*cm, ft.*lbf)}}$  : Specified torque

S47100bS

## VI. DRIVER'S SEAT WORK PROCEDURE

### A. DRIVER'S SEAT ASSEMBLY REMOVAL

#### 1. ADJUST THE POSITION OF THE SEAT

- Move the seat to the center position.
- Move the seatback to the upright position.

#### 2. CHECK FOR DTCS FOR VEHICLES EQUIPPED WITH SIDE AIRBAGS

#### 3. RECORD SYSTEM SETTINGS (RADIO PRESETS, A/C SETTINGS, ETC)

#### 4. DISCONNECT THE NEGATIVE BATTERY TERMINAL (FOR VEHICLES EQUIPPED WITH SIDE AIRBAGS)



- Wait at least 90 seconds after disconnecting the cable from the negative battery terminal to prevent airbag and seat belt pretensioner deployment.
- Follow all precautions as outlined on TIS before servicing the SRS system.

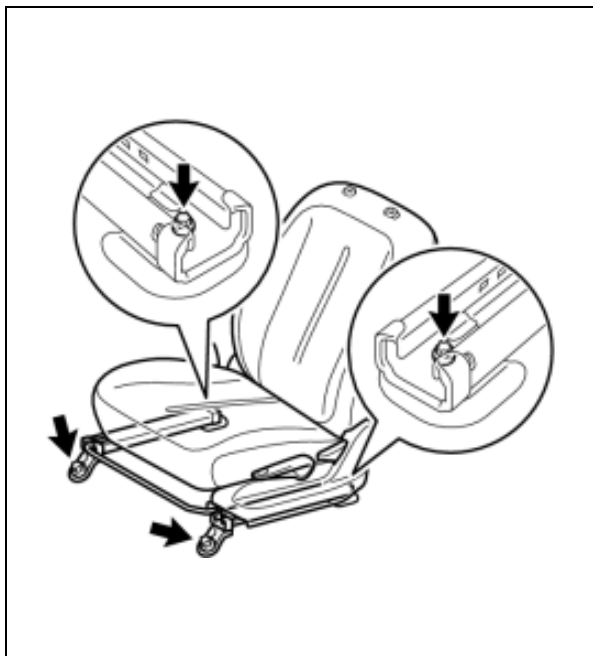

## 5. REMOVE THE HEADREST ASSEMBLY

## 6. REMOVE THE SEAT ASSEMBLY BOLTS

- Cover expose areas of interior trim with protective tape and place a soft blanket over the door panel to protect it while removing the seat.
- Remove the 4 bolts.

## 7. REMOVE THE SEAT ASSEMBLY

- Tip the seat back and disconnect the connectors on the bottom of the seat.
- Using 2 people, carefully remove the seat from the vehicle and place it on a clean bench.



- Use care when removing the seat, if the vehicle is experiencing the recall condition the seat track rail may suddenly move while removing the seat.
- To prevent damaging and/or soiling of the seat, place the seat on a clean bench that has been covered with a clean blanket.

## B. FRONT SEAT TRACK ASSEMBLY REMOVAL

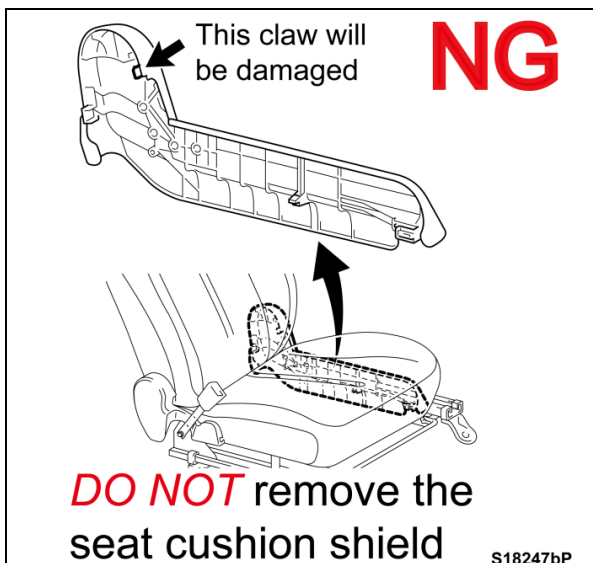

**DO NOT** remove the outer seat cushion shield because the shield locking claw will be damaged.

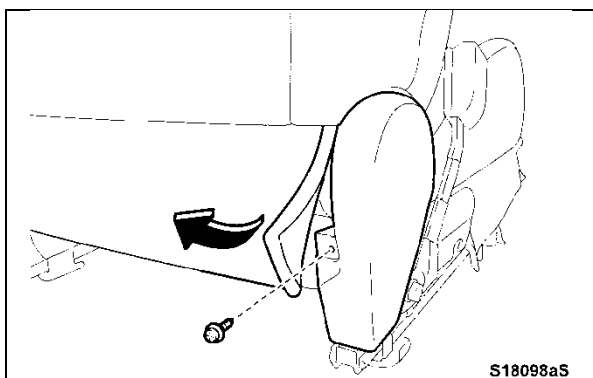

## 1. SEAT CUSHION INNER SHIELD ADJUSTMENT

- Pull the seat cover flap to the side and remove screw securing the inner cushion shield.
- Removing the screw will allow some play in the cushion shield to access the lower cushion shield.



**DO NOT** remove the seat cushion shield because the shield locking claw will be damaged.

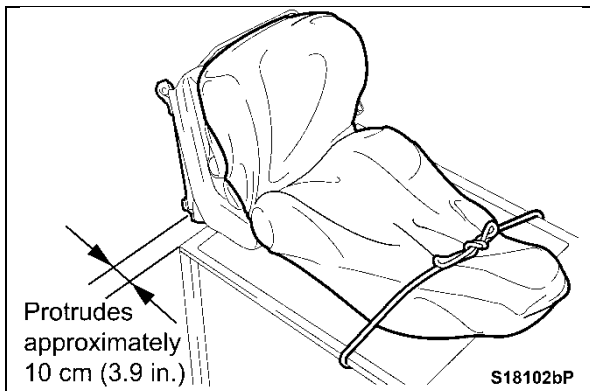

## 2. SECURE THE SEAT TO THE WORK BENCH

- Install the head rest and put a seat cover over the seat.
- Place the seat on its back and position the seat so that approximately 10 cm (4 in.) protrudes over the edge of the workbench.
- Secure the seat to the work bench with a rope or tie down.

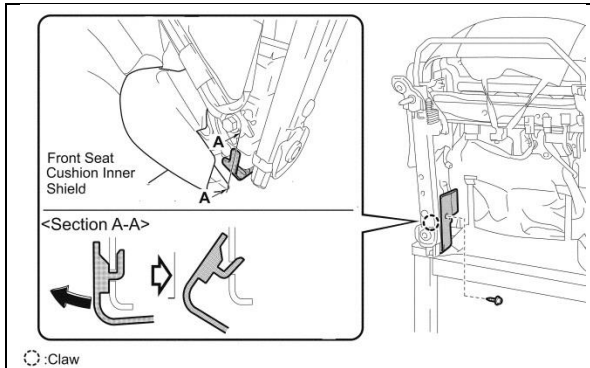

## 3. REMOVE THE SEAT CUSHION LOWER INNER SHIELD

- Remove the screw securing the seat cushion lower cover to inside of the seat track.
- Gently angle the cover to release the claw.



**Ensure you DO NOT remove the seat cushion shield (should only be pulled to the side) which is covering the seat cushion lower inner shield.**

## 4. REMOVE THE FRONT SEAT INNER AND OUTER TRACKS

- Disconnect the seat position sensor connector.

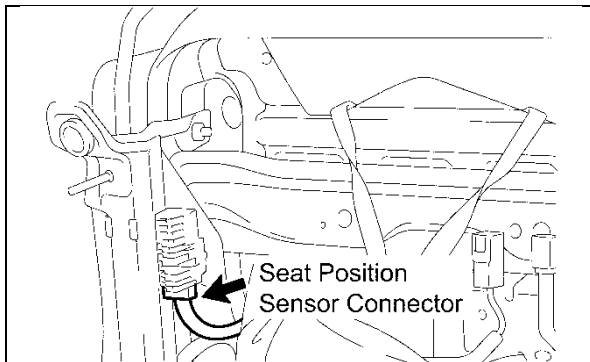

- Attach protective tape to the edge of the outer cushion shield and seat track wrench as shown.

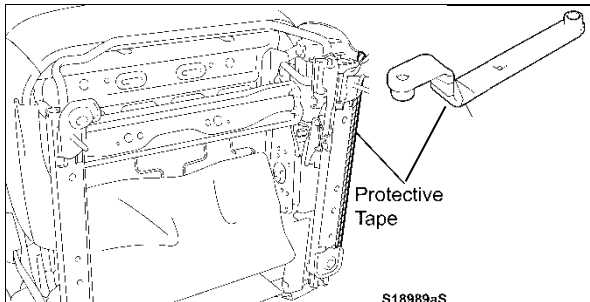

- Disengage the clip located in the center seat cushion shield.
- Place a clean cloth in between the seat cushion shield and outer track to keep the clip disengaged.

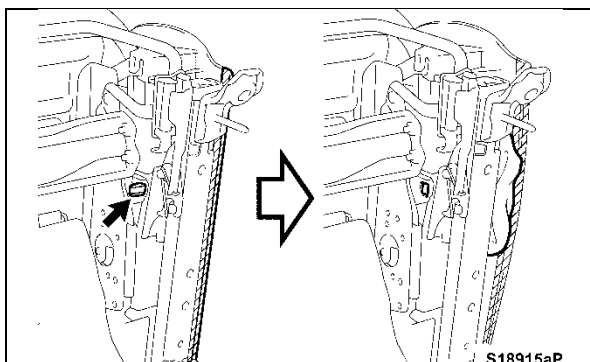



- e) Remove the 2 nuts securing the seat position sensor and front part of the seat track assembly.
- f) Place the seat position sensor in a safe location where it cannot be damaged.
- g) Remove the 2 remaining nuts securing the inner seat track.
- h) Using the seat track wrench, remove the 4 nuts from the outer track.
- i) Carefully remove both seat tracks from the seat assembly.



- Remove the seat position sensor first to ensure it is not dropped or damaged.
- **DO NOT** remove the nut identified below.

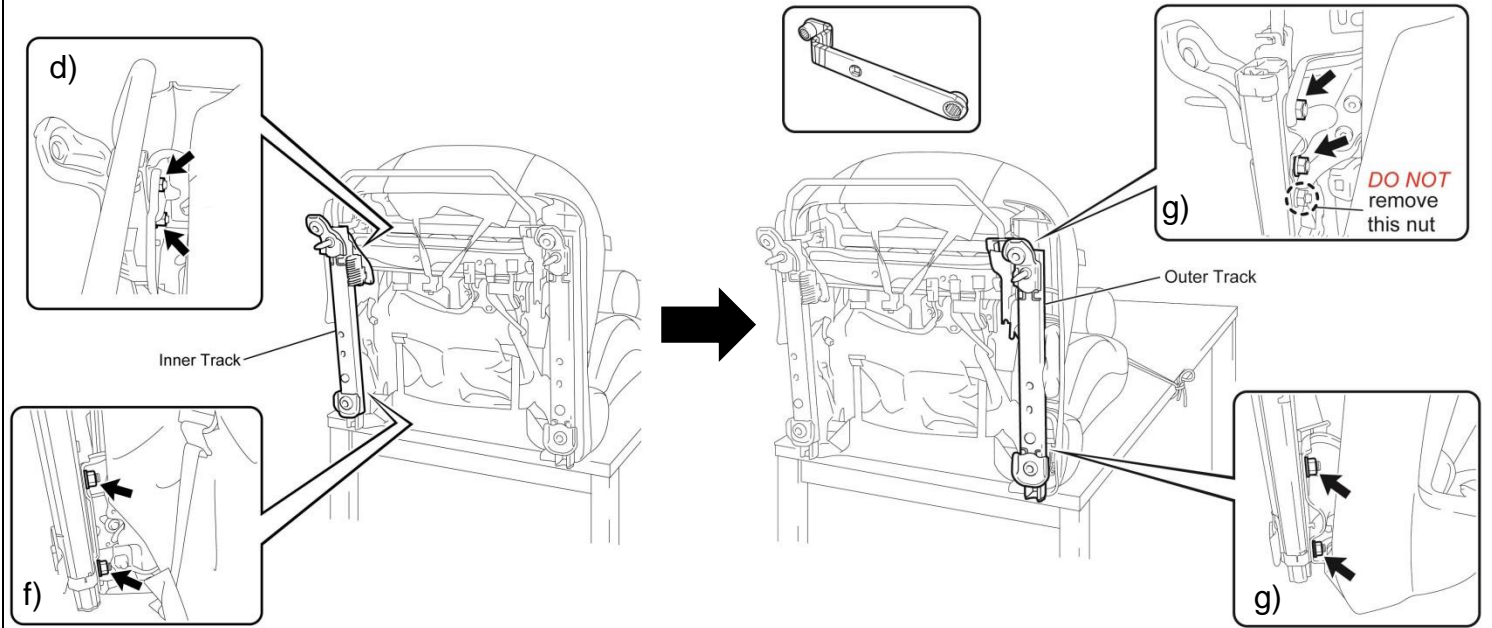

- j) Discard the old nuts to ensure that they are not reused.

## 5. REMOVE THE SEAT TRACK ADJUSTMENT HANDLE

- a) Using a flat tip screw driver, disengage the spring by lifting the spring upward and pull out the adjusting handle from the seat track assembly.

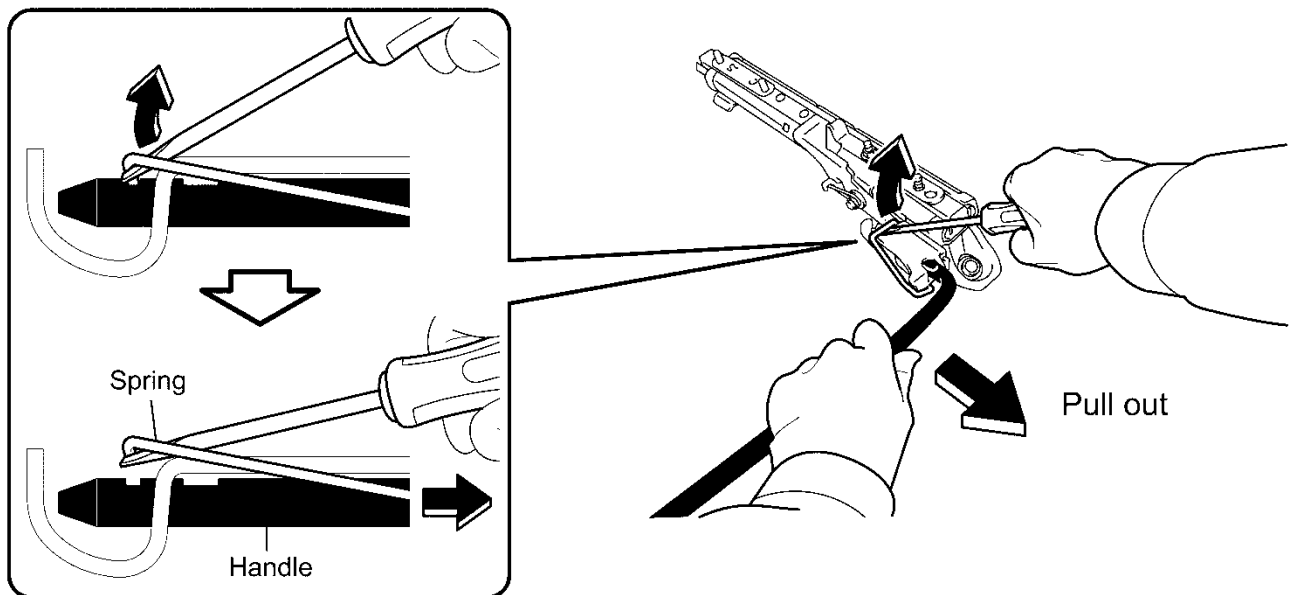



- b) Lift the seat adjustment handle to release the lock and pull out the upper rail to access the adjustment handle lock plate.

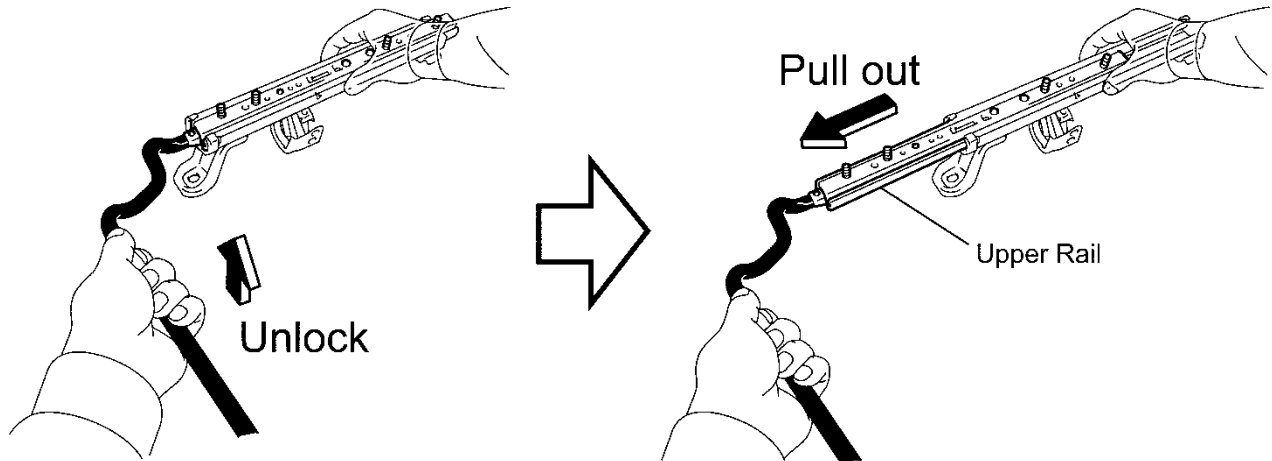

- c) Using a flat tip screw driver, press the lock plate down and lightly turn the adjustment handle back and forth to remove it from the seat track.

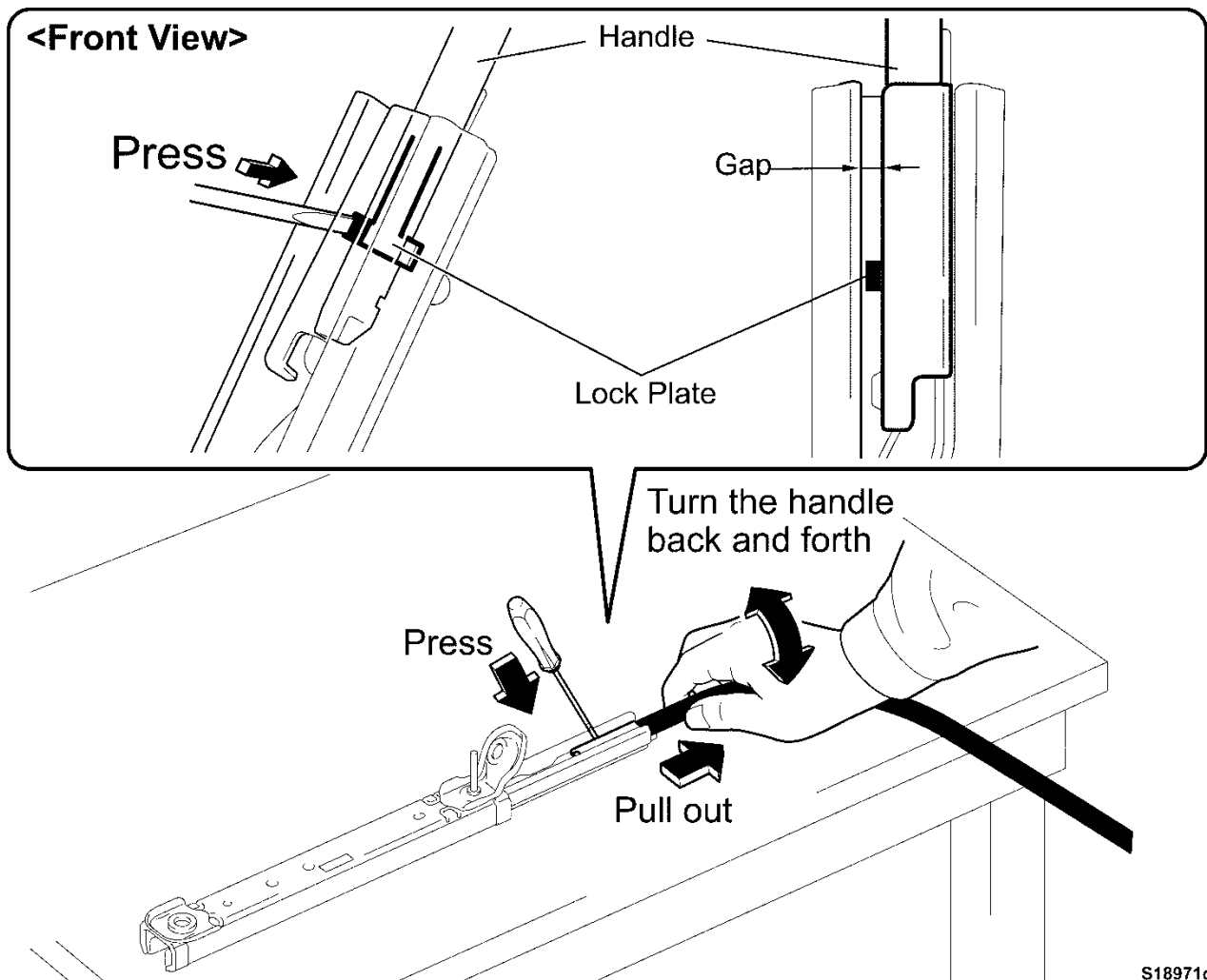

S18971cS

- d) Mark the original seat tracks and place them in a location to prevent them from being reused.

## C. **NEW** SEAT TRACK INSTALLATION

# NG

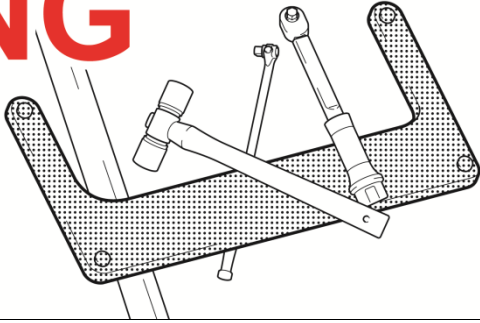

**STOP**

Be careful not to deform the seat track adjusting gauge while it is being stored.

### 1. CHECK ADJUSTING GAUGE PIN HOLES IN THE NEW SEAT TRACKS

- a) Check that the pins of the adjusting gauge can be smoothly inserted into the holes of the NEW seat tracks.

**STOP**

In extremely rare cases the gauge pins may not be able to be inserted due to the thickness of the seat track coating. If the gauge pins cannot be inserted refer to the appendix (Section VIII) for repair instructions.

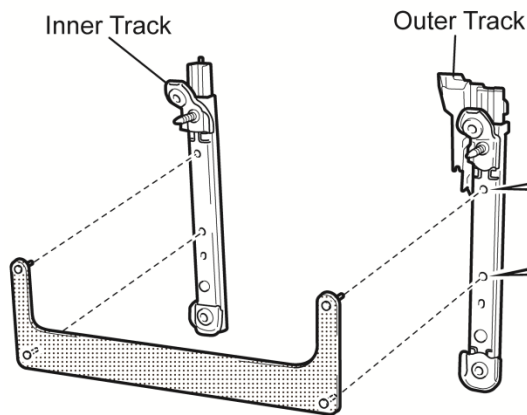

# OK

Pin can be inserted smoothly



# NG

Pin cannot be inserted smoothly



S18909bS

### 2. CONFIRM THE INNER AND OUTER SEAT TRACK POSITIONS

- a) Confirm that the upper rail is positioned one notch (approx. 10mm, 0.39 in.) from the rear of the lower rail for both tracks.

One notch  
Approx. 10 mm (0.39 in.)

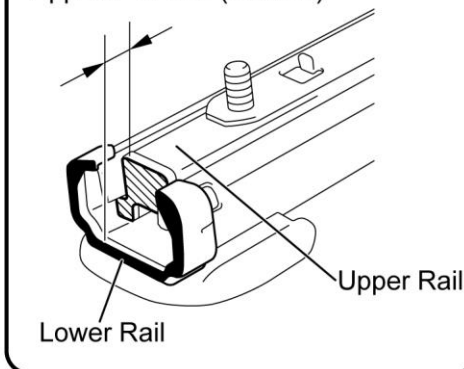

**NEW** Outer Track

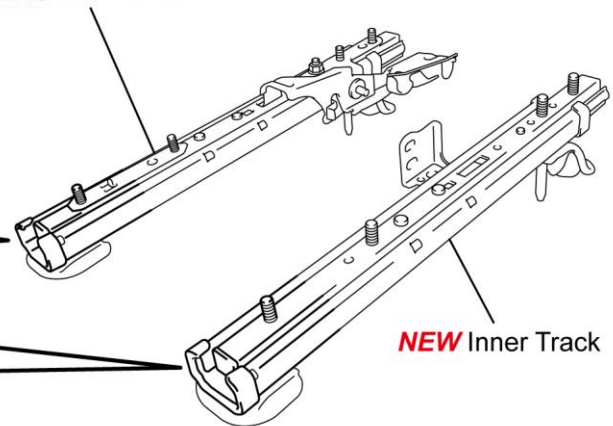

**NEW** Inner Track

- b) If the upper rails are not in the correct position, pull the seat levers to adjust the upper rail position.

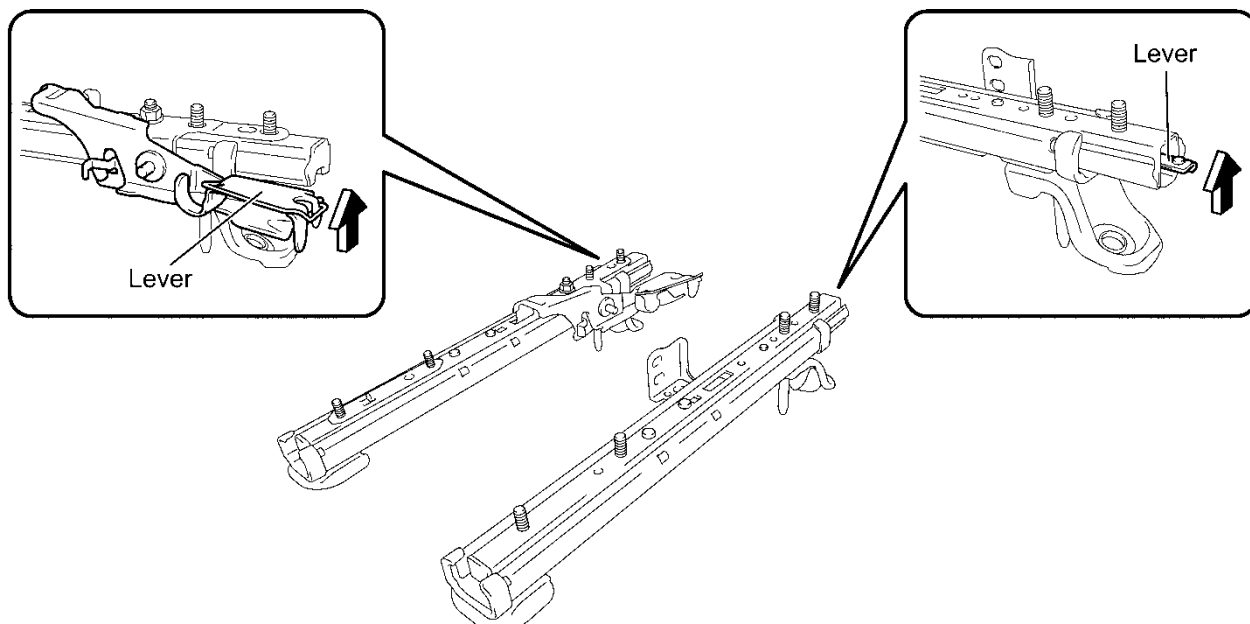

### 3. TEMPORARILY INSTALL **NEW** INNER AND OUTER SEAT TRACKS TO DRIVER SEAT

- a) Attach the new inner track and seat position sensor with the 4 **NEW** nuts (black), by hand tightening the nuts.  
b) Attach the outer track with the 4 **NEW** nuts (silver), by hand tightening the nuts.



- **NEW nuts must be used.**
- **The nuts for the seat tracks are not interchangeable; attach the seat tracks with the correct nuts.**

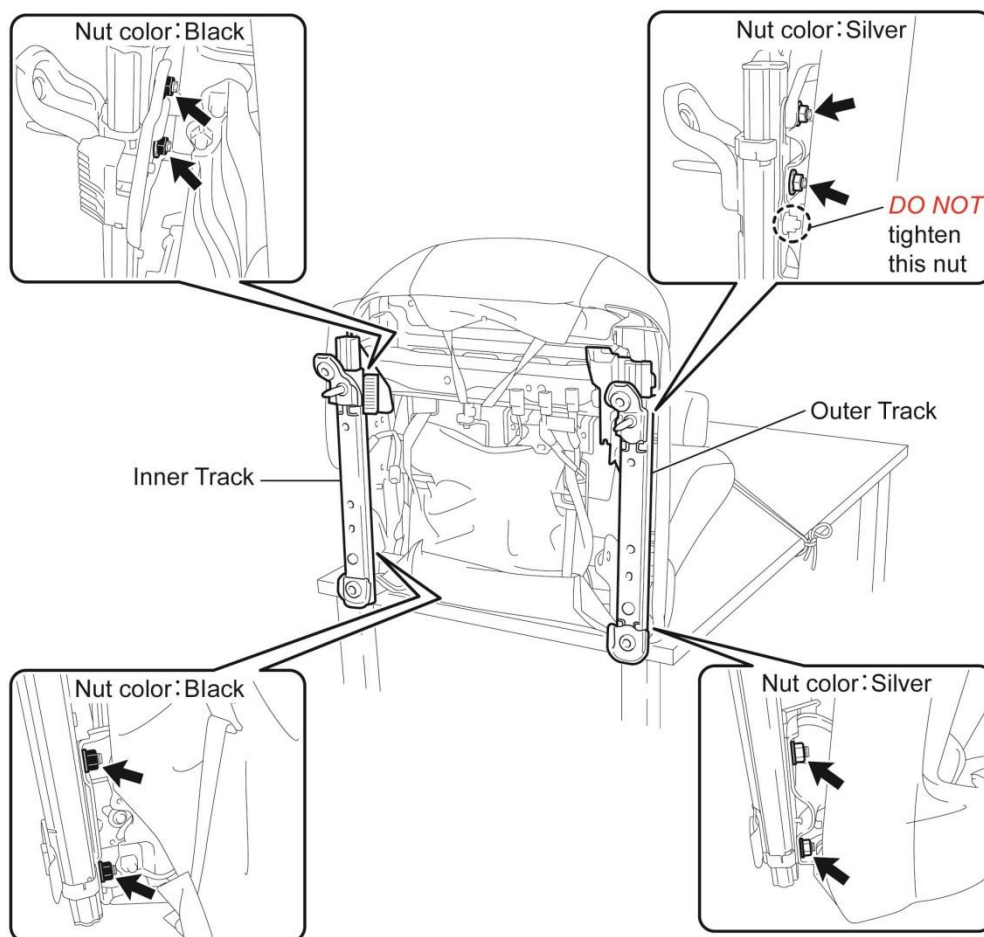

S18109cS

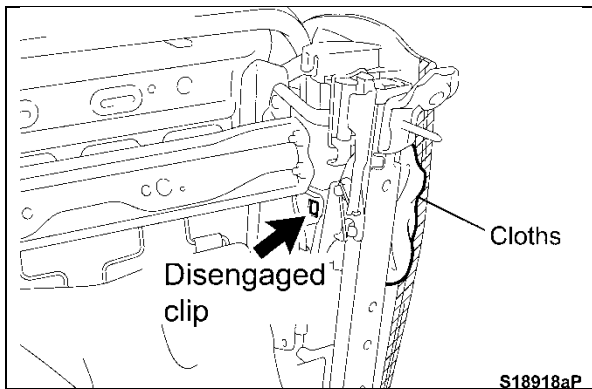

- c) Check that the center clip of the outer shield is still disengaged.
- d) In order to maintain the clip disengaged place a new clean cloth between the outer seat track and outer shield.

- e) Install the seat track adjustment gauge to the seat track holes and ensure that all 4 pins are properly installed and flush.



- Always use the gauge when installing the seat tracks to prevent the tracks from being misaligned.
- Do not press hard on the gauge, otherwise the gauge may become deformed.
- Ensure all 4 pins are properly installed.

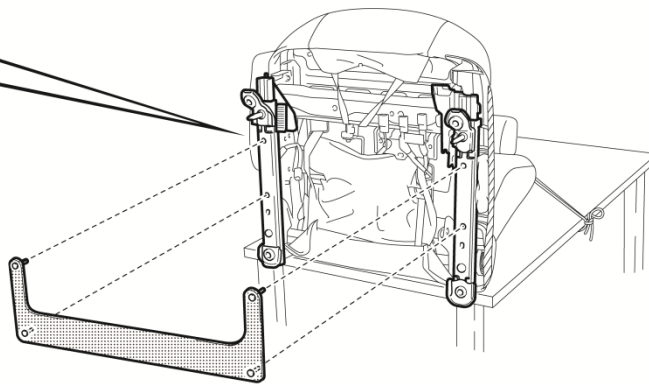
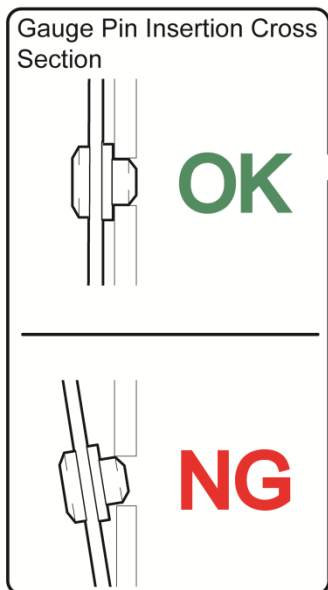

S18110bP

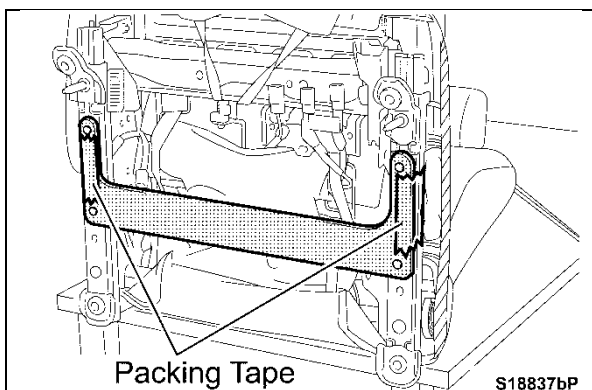

- f) Check that gauge pins are properly seated and secure the gauge to the seat assembly using packing tape.

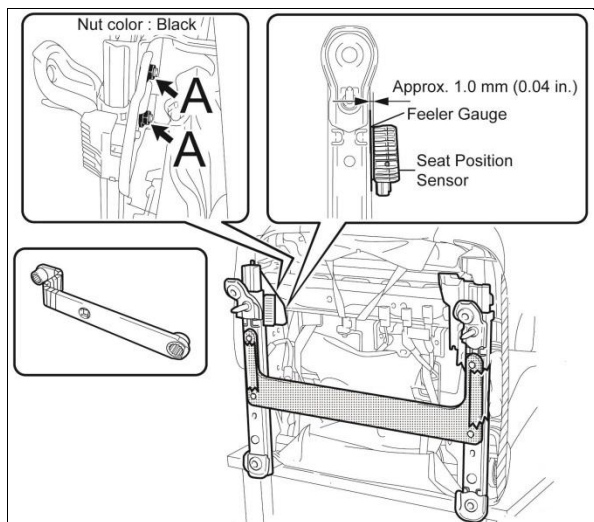

- g) Using a feeler gauge, adjust the clearance between the inner track and seat position sensor so that it is approximately 1.0 mm (0.04 in)
- h) Using the seat track wrench, tighten the 2 nuts to spec.

**Standard Torque: 25 Nm (255 kgf cm, 18 ft lbf)**

**Torque table is used when using seat track wrench.**

Torque Wrench Length (in.)	Calculated Torque (ft·lbf)
10" to 11"	13
12" to 15"	14
16" to 20"	15

**NOTE: The seat track wrench provided *MUST* be used when using the values in the table.**

- i) Remove the feeler gauge.

- j) Using the seat track wrench, tighten the remaining 6 nuts to spec.
- k) Ensure that the track adjustment gauge pins are still flush with the seat track and that the track orientation did not move while torquing the nuts.

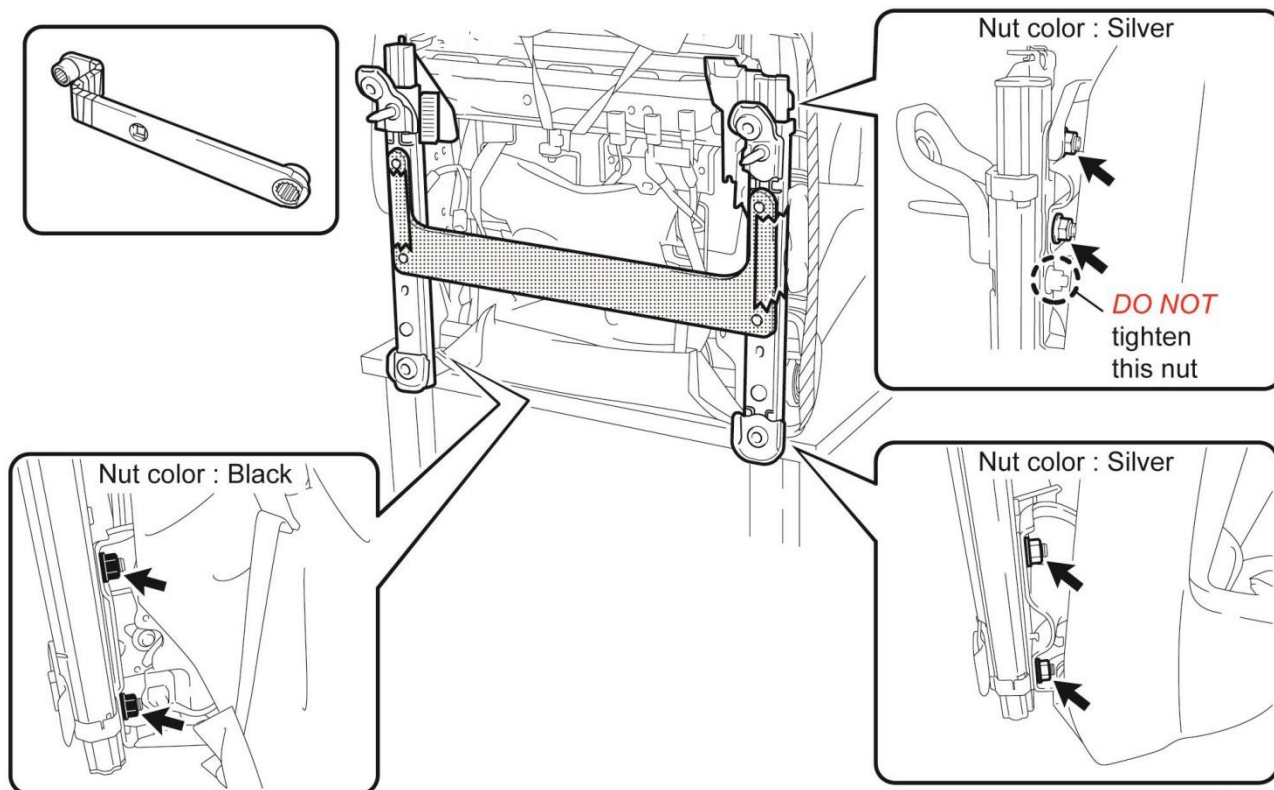

- Always use the gauge when installing the seat tracks to prevent the tracks from being misaligned.
- Do not press hard on the gauge; otherwise the gauge may become deformed.
- Ensure all 4 pins are properly installed before and after torquing the nuts.

## Remove the gauge

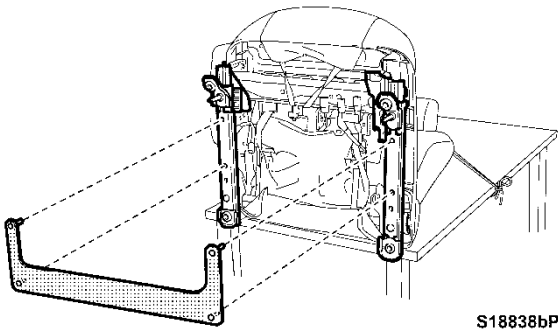

S18838bP

l) Remove the adjustment gauge.

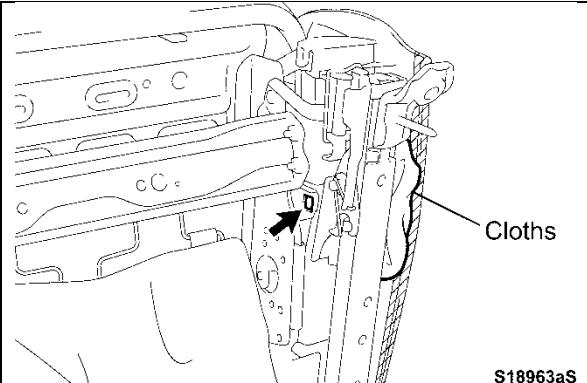

S18963aS

m) Remove the cloth and protective tape.

n) Engage the center clip of the seat cushion outer shield.

## 4. REINSTALL SEAT TRACK ADJUSTMENT BAR

a) Insert the both sides of the adjustment bar at the same time into the seat tracks and engage the locking plate and spring.

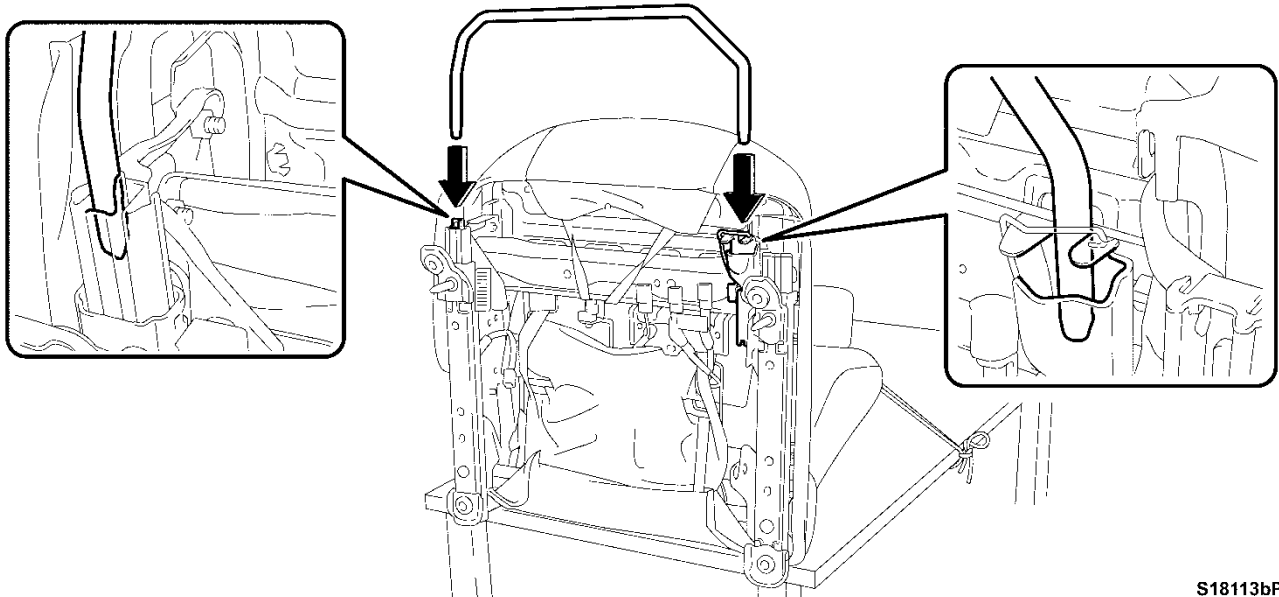

S18113bP

Confirm the adjusting handle is reinstalled

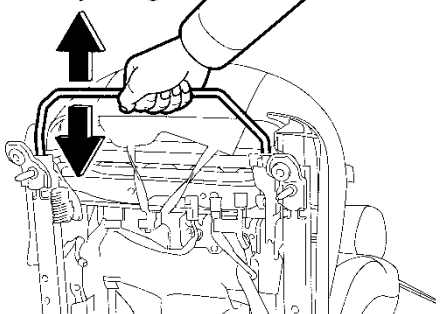

b) Confirm that the seat adjustment handle is fully seated and secured by the locking plate and spring.

## 5. ADJUST SEAT RAIL POSITION

- a) Adjust the seat rail position so that the upper and lower seat rail are flush in the front: this will make it easier to install the seat in the car.

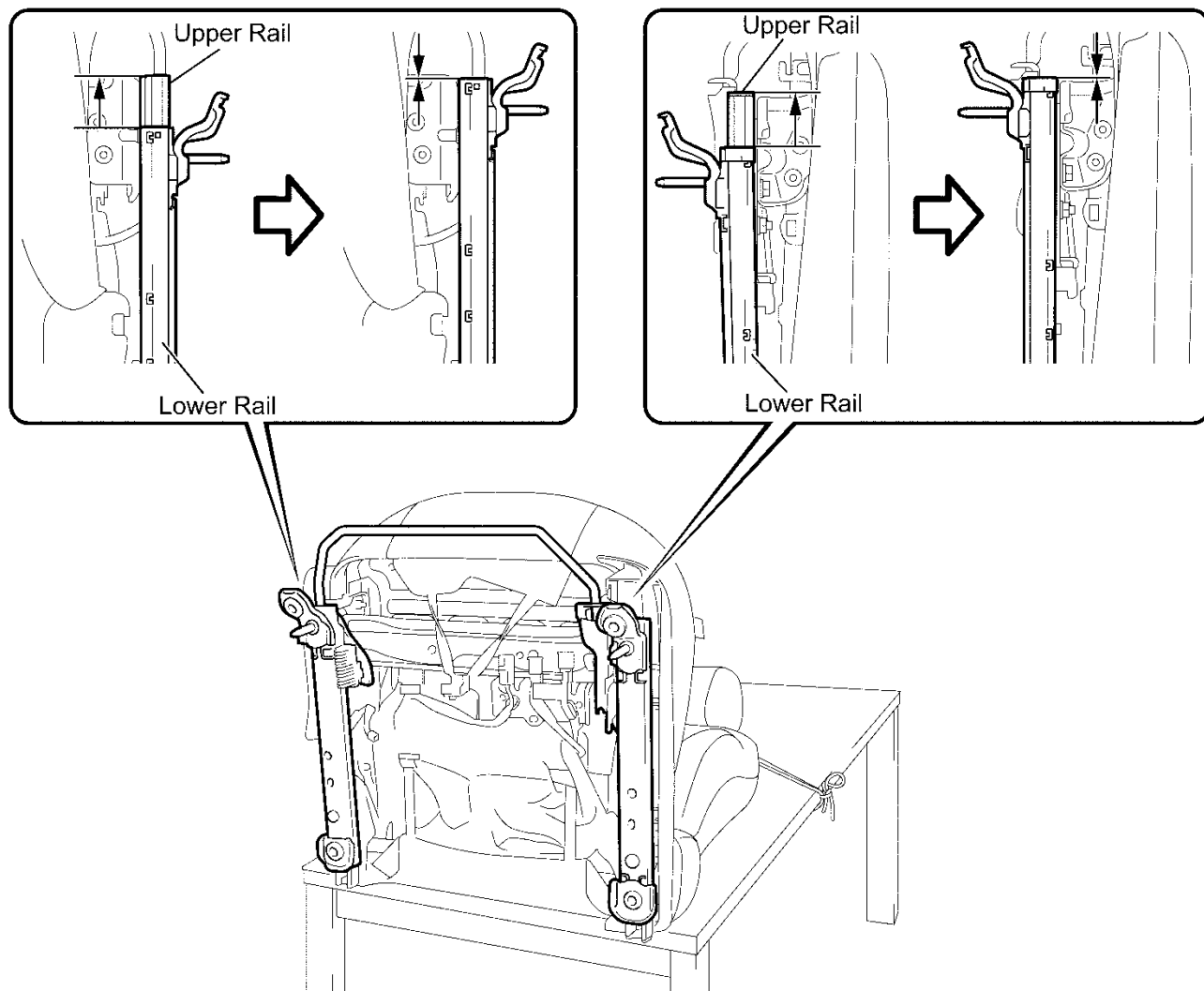

## 6. REINSTALL FRONT SEAT CUSHION LOWER SHIELD

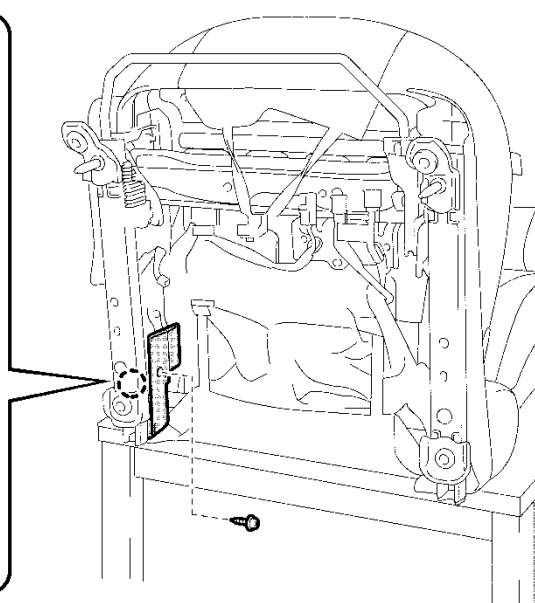
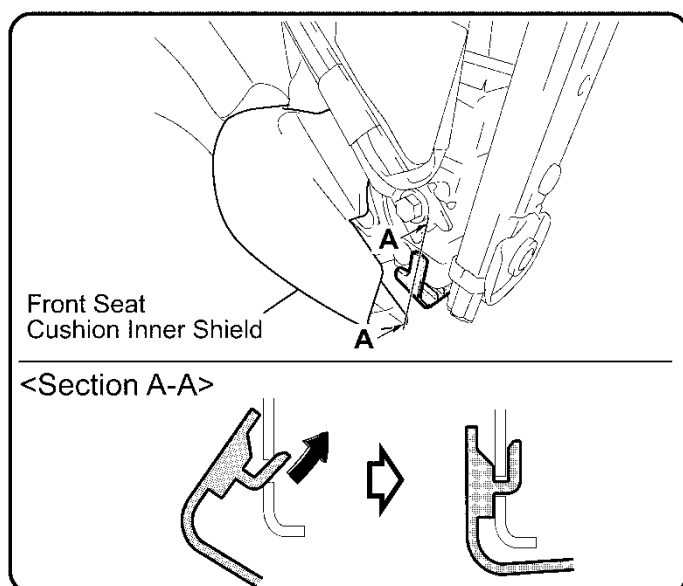

○:Claw

S19005aS



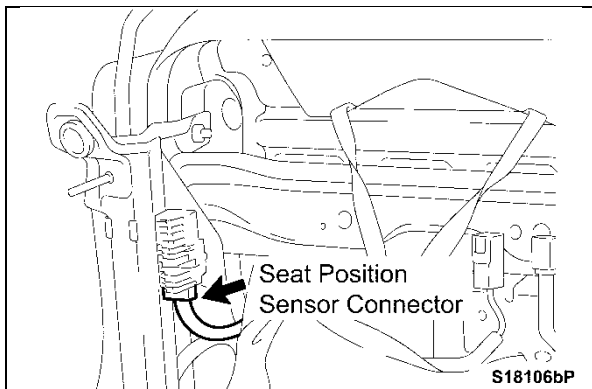

#### 7. RECONNECT THE SEAT POSITION SENSOR CONNECTOR

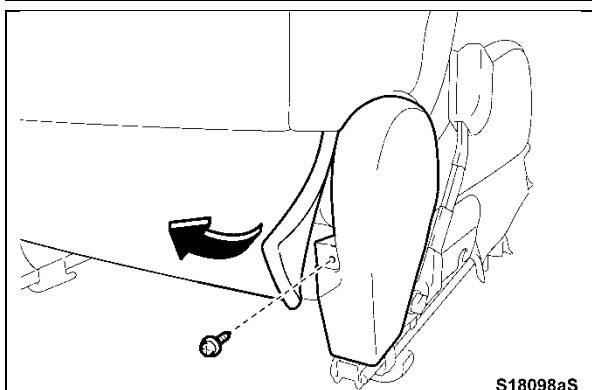

#### 8. REINSTALL SEAT CUSHION INNER SHIELD SCREW

- a) Remove the rope/tie down securing the seat to the table.
- b) Remove the seat cover.
- c) Reinstall the seat cushion inner shield.

### D. FRONT DRIVER'S SEAT REINSTALLATION

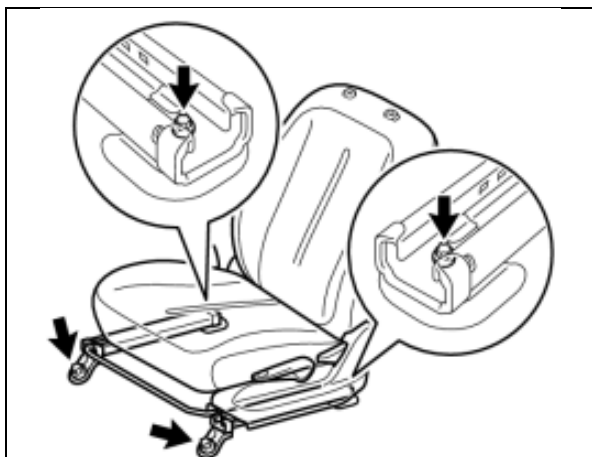

#### 1. REINSTALL THE SEAT INTO THE VEHICLE

- a) Using 2 people carefully place the seat into the vehicle.
- b) Align the alignment pins on the front of the seat tracks with alignment holes in the floor pan.
- c) Tilt the seat back and reconnect the connectors.
- d) Reinstall the 4 seat bolts and torque to spec.

**Torque: 37 Nm (375 kgf cm, 27ft lbf)**

- e) Reinstall headrest.
- f) Remove protective tape and protective blanket.

## VII. PASSENGER SEAT WORK PROCEDURE

### A. PASSENGER SEAT REMOVAL

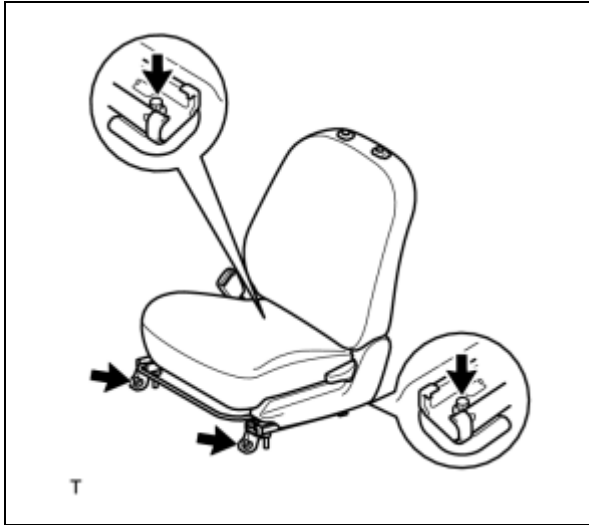

#### 1. ADJUST THE POSITION OF THE SEAT

- Move the seat to the center position.
- Move the seatback to the upright position.

#### 2. REMOVE SEAT FROM VEHICLE

- Tip the seat back and disconnect the connectors on the bottom of the seat.
- Using 2 people carefully remove the seat from the vehicle and place it on a clean bench.



- Use care when removing the seat, if the vehicle is experiencing the recall condition the seat track rail may suddenly move while removing the seat.
- To prevent damaging and/or soiling of the seat, place the seat on a clean bench that has been covered with a clean blanket.

### B. FRONT PASSENGER SEAT TRACK ASSEMBLY REMOVAL



**DO NOT** remove the outer seat cushion shield because the shield locking claw will be damaged.

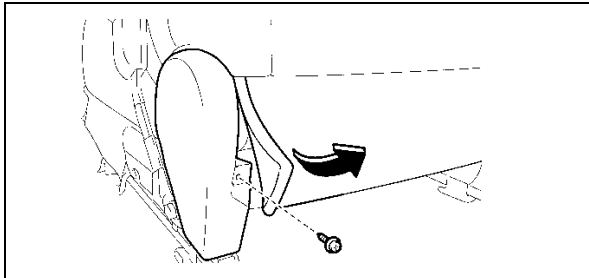

#### 1. SEAT CUSHION INNER SHIELD ADJUSTMENT

- Pull the seat cover flap to the side and remove screw securing the inner cushion shield.
- Removing the screw will allow some play in the cushion shield to access the lower cushion shield.



**DO NOT** remove the seat cushion shield because the shield locking claw will be damaged.

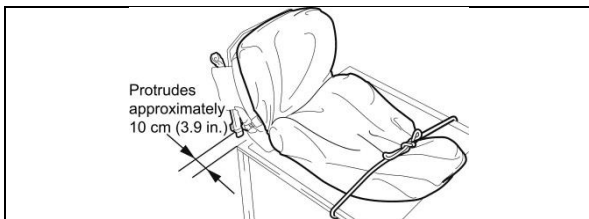

#### 2. SECURE THE SEAT TO THE WORK BENCH

- Install the head rest and put a seat cover over the seat.
- Place the seat on its back and position the seat so that approximately 10 cm (4 in.) protrudes over the edge of the workbench.
- Secure the seat to the work bench with a rope or tie down.

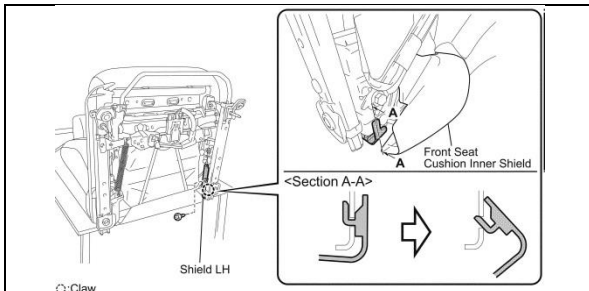

#### 3. REMOVE THE SEAT CUSHION LOWER INNER SHIELD

- Remove the screw securing the seat cushion lower cover to inside of the seat track.
- Gently angle the cover to release the claw.



**Ensure you DO NOT** remove the seat cushion shield (should only be pulled to the side) which is covering the seat cushion lower inner shield.

#### 4. REMOVE THE FRONT SEAT INNER AND OUTER TRACKS

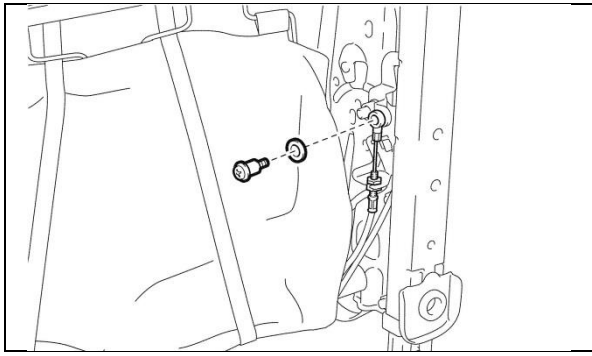

- a) Remove the screw and washer securing the cable end as shown.

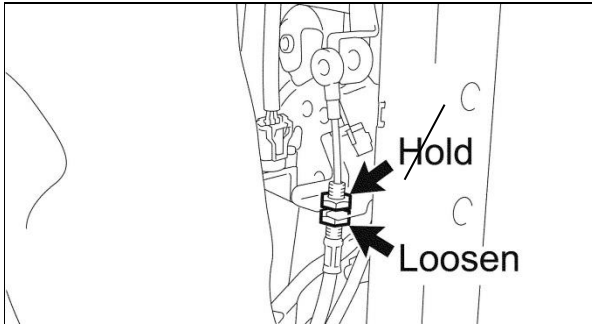

- b) Loosen the lower nut while holding the upper nut in place and disconnect the cable.



**DO NOT loosen the upper nut because it is fixed in place with thread locking agent.**

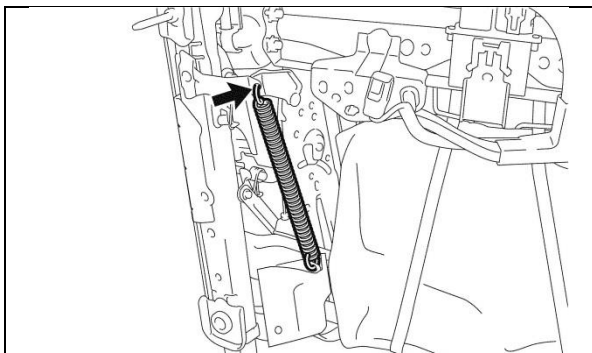

- c) Remove the spring from the outer seat track.

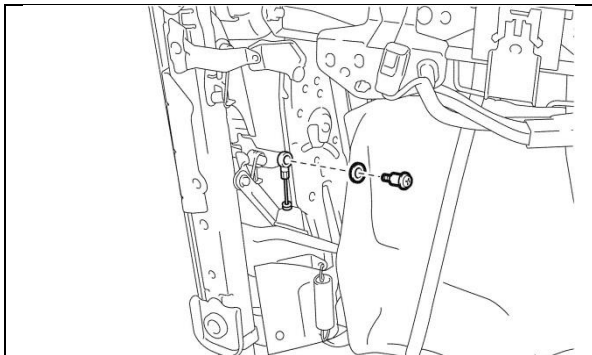

- d) Remove the screw and washer securing the cable as shown.



- e) Remove the E-ring, and then detach the lever as shown in the illustration.  
f) Discard the E-ring so that it cannot be reused.

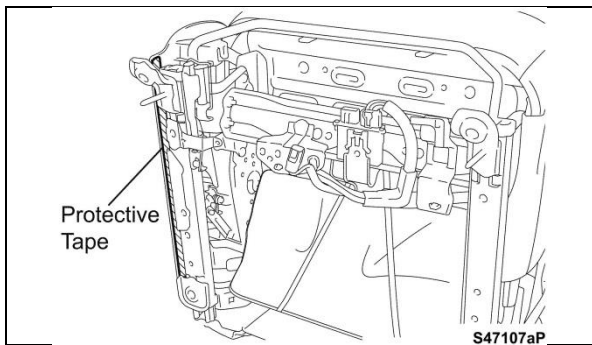

- g) Apply protective tape to the edge of the seat cushion shield to prevent scratching.

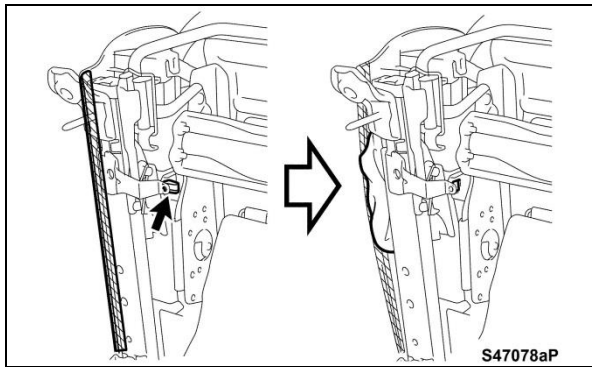

- h) Disengage the clip located in the center seat cushion shield.  
i) Place a clean cloth in between the seat cushion shield and outer track to keep the clip disengaged.

- j) Using the seat track wrench remove the 4 outer seat track nuts.  
k) Using the seat track wrench remove the 4 nuts on inner seat track ensuring you remove nut "L" last.



**DO NOT remove nut "L" until all the other nuts have been removed. Otherwise the seat tracks may come off during disassembly and could cause injury.**

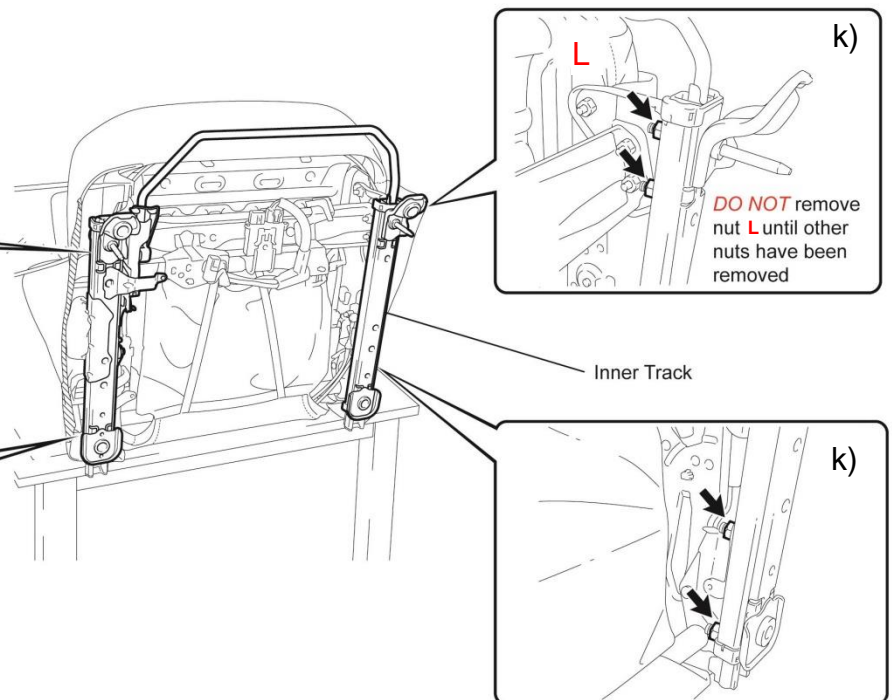
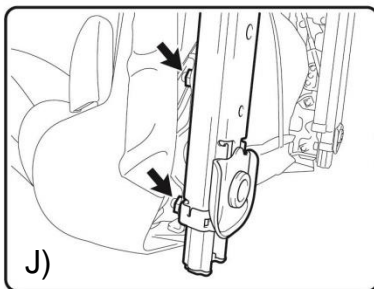
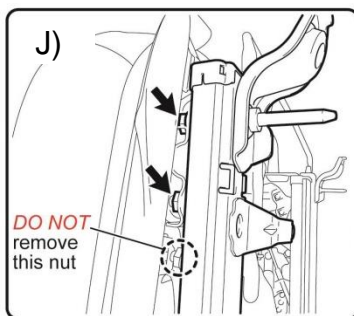

- a) Discard the old nuts to ensure that they are not reused.

## 6. REMOVE THE SEAT TRACK ADJUSTMENT HANDLE

- e) Using a flat tip screw driver, disengage the spring by lifting the spring upward and pull out the adjusting handle from the seat track assembly.

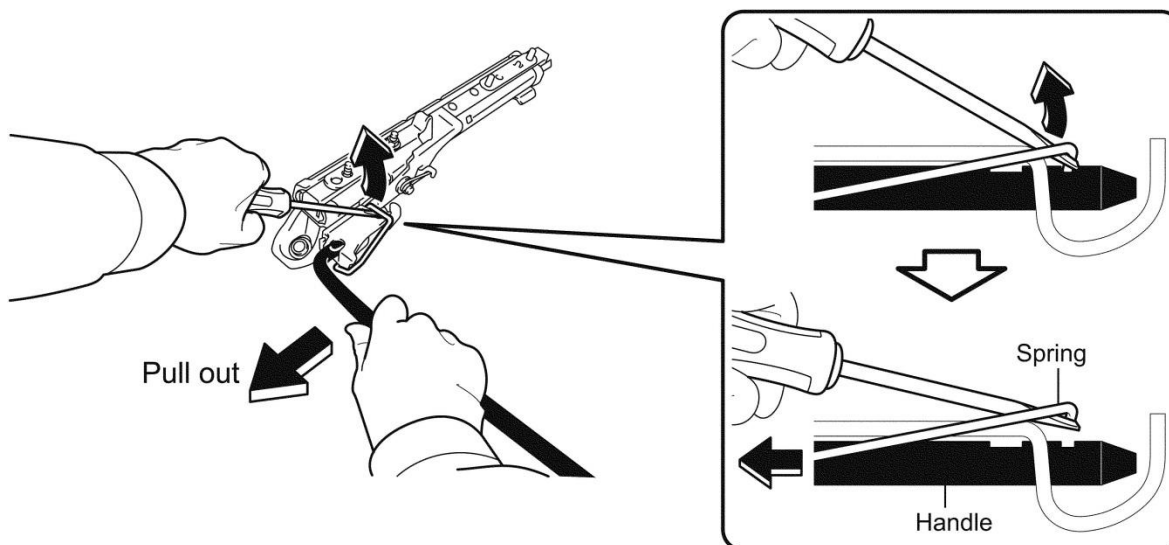

- f) Lift the seat adjustment handle to release the lock and pull out the upper rail to access the adjustment handle lock plate.

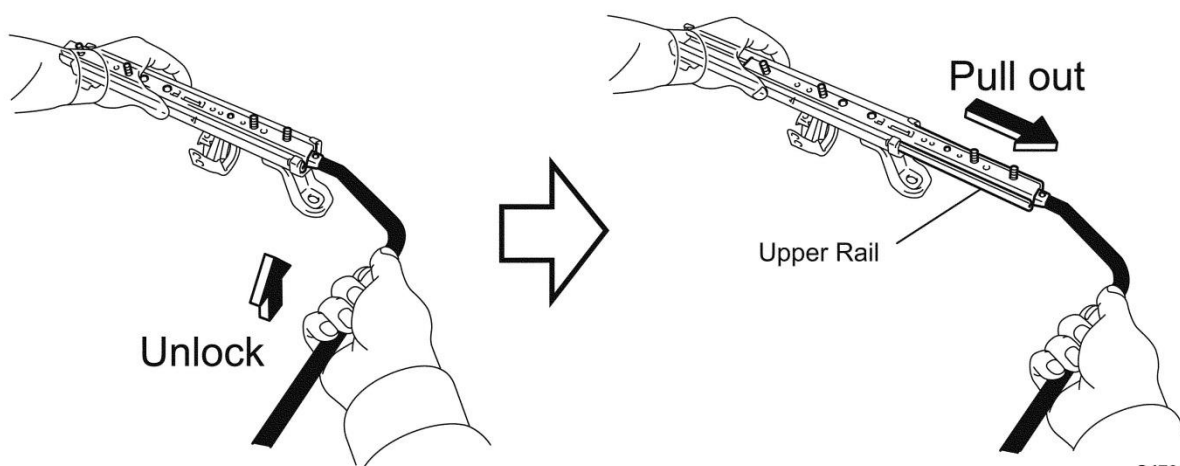

S47030aS

- g) Using a flat tip screw driver, press the lock plate down and lightly turn the adjustment handle back and forth to remove it from the seat track.

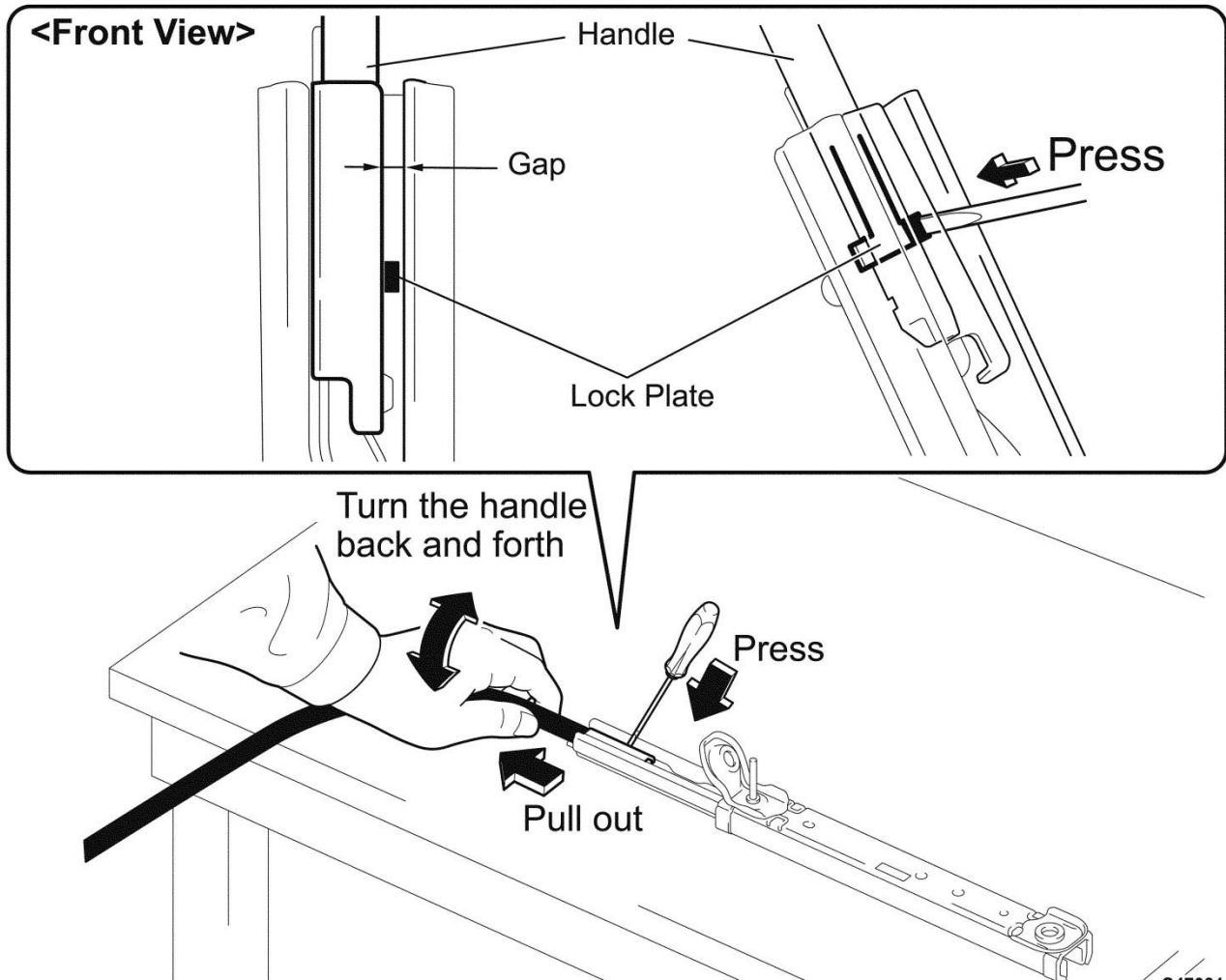

- h) Mark the original seat tracks and place them in a location to prevent them from being reused.



## C. **NEW** PASSENGER SEAT TRACK INSTALLATION

### 1. CHECK ADJUSTING GAUGE PIN HOLES IN THE NEW SEAT TRACKS

- b) Check that the pins of the adjusting gauge can be smoothly inserted into the holes of the NEW seat tracks.



**In extremely rare cases the gauge pins may not be able to be inserted due to the thickness of the seat track coating. If the gauge pins cannot be inserted refer to the appendix (Section VIII) for repair instructions.**

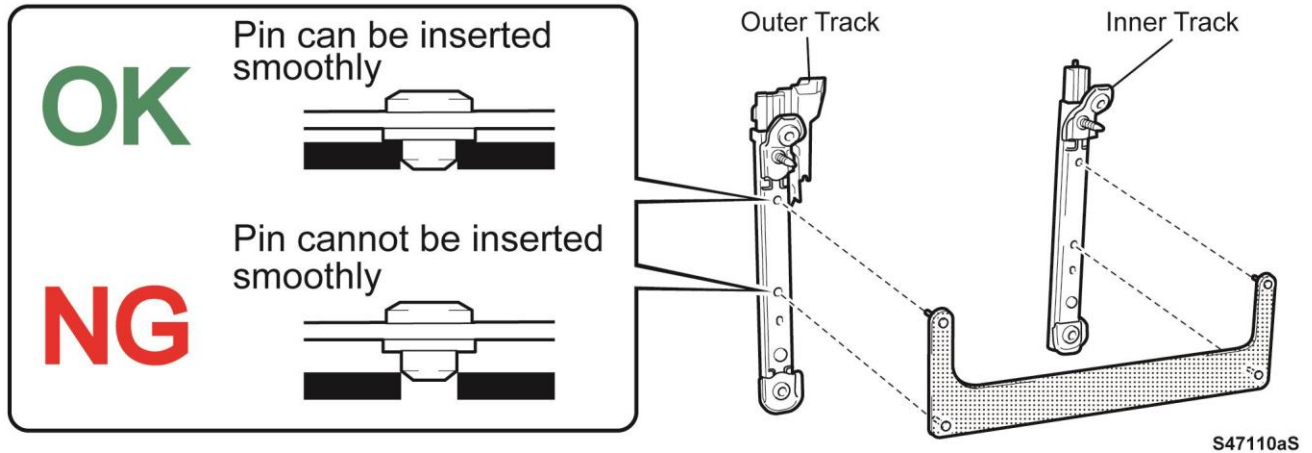

### 2. CONFIRM THE INNER AND OUTER SEAT TRACK POSITIONS

- c) Confirm that the upper rail is positioned one notch (approx. 10mm, 0.39 in.) from the rear of the lower rail for both tracks.

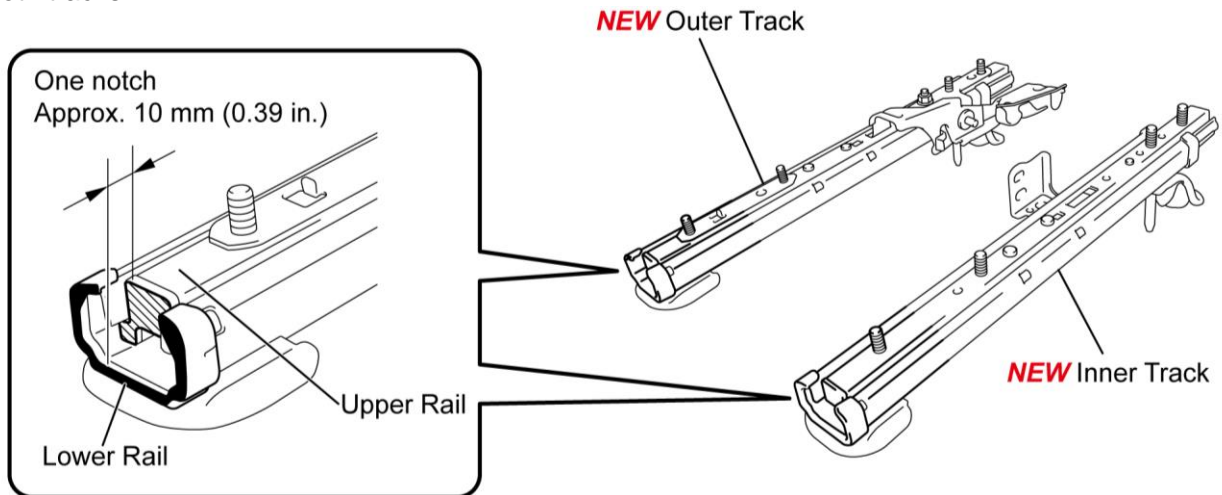



- d) If the upper rails are not in the correct position, pull the seat levers to adjust the upper rail position.

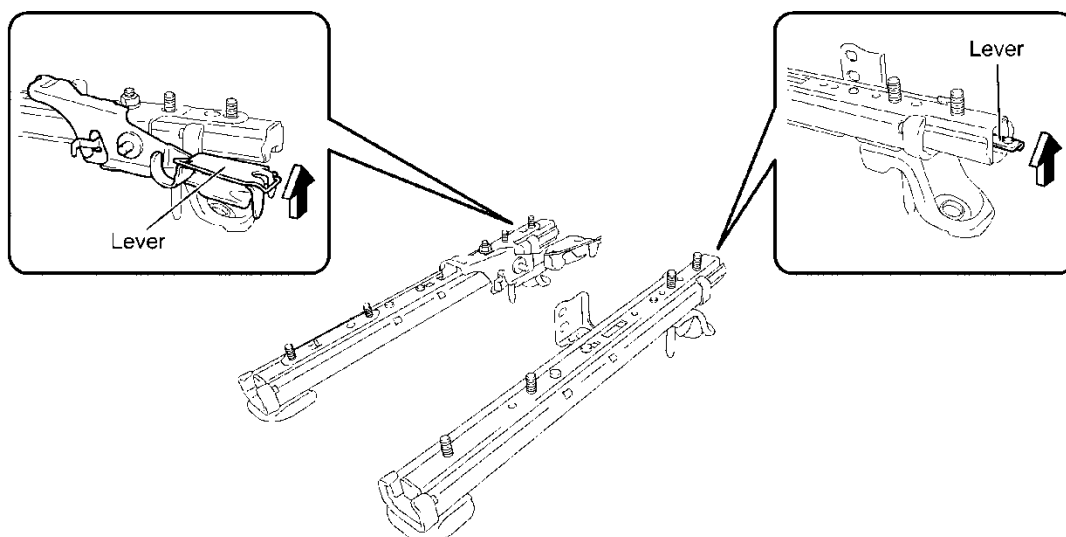

### 3. TEMPORARILY INSTALL **NEW** INNER AND OUTER PASSENGER SEAT TRACKS TO DRIVER SEAT

- Attach the new outer seat track with the 4 NEW nuts (silver), by hand tightening the nuts.
- Attach the new inner seat track with the 4 NEW nuts (black), by hand tightening the nuts.

**STOP**

- **NEW nuts must be used.**
- **The nuts for the seat tracks are not interchangeable; attach the seat tracks with the correct nuts.**

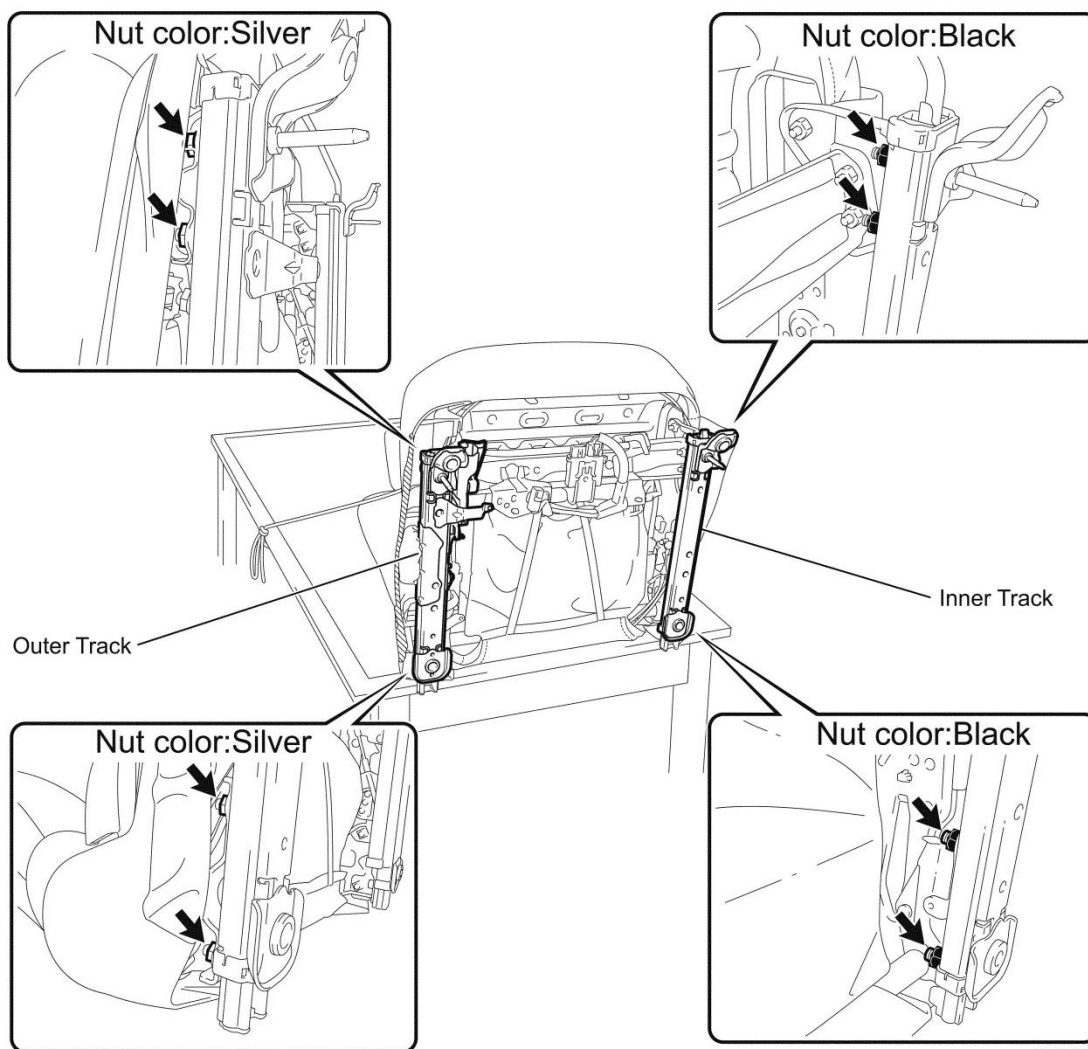

S47111bS

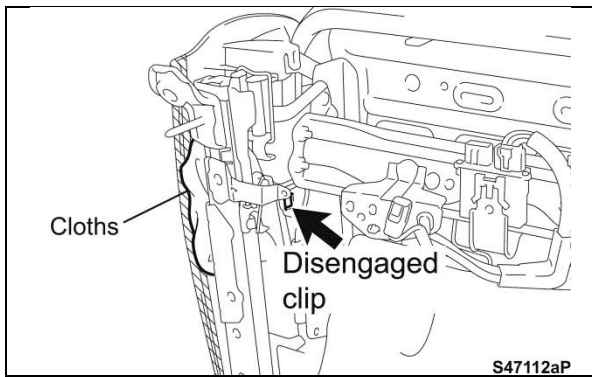

- c) Check that the center clip of the outer shield is still disengaged.
- d) In order to maintain the clip disengaged place a new clean cloth between the outer seat track and outer shield.

- e) Install the seat track adjustment gauge to the seat track holes and ensure that all 4 pins are properly installed and flush.



- Always use the gauge when installing the seat tracks to prevent the tracks from being misaligned.
- Do not press hard on the gauge; otherwise the gauge may become deformed.
- Ensure all 4 pins are properly installed.

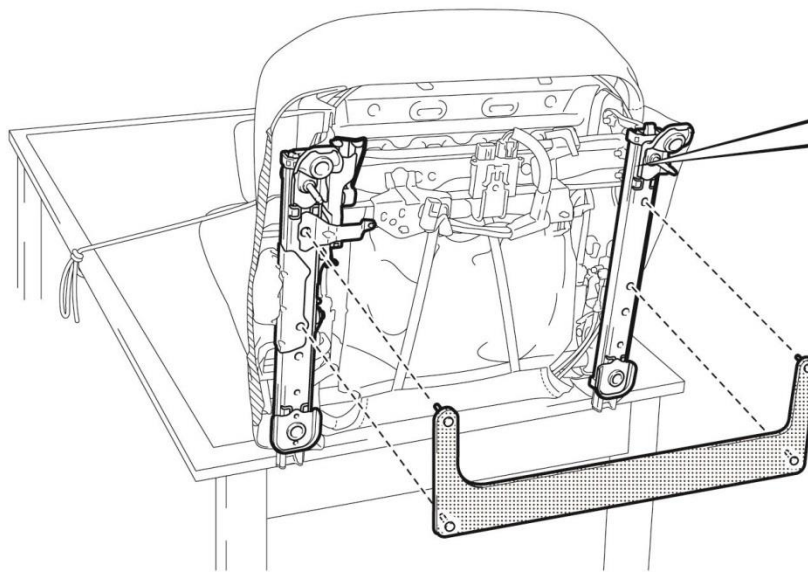

Gauge Pin Insertion Cross Section

OK



NG

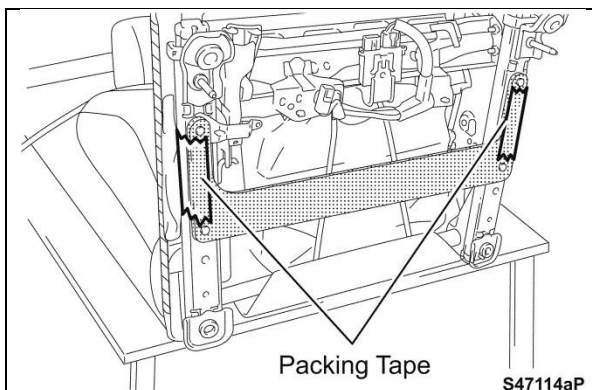

- f) Check that gauge pins are properly seated and secure the gauge to the seat assembly using packing tape.

- g) Using the seat track wrench, tighten the 8 nuts to spec.

**Standard Torque: 25 Nm (255 kgf cm, 18 ft lbf)**

**Torque table is used when using seat track wrench.**

Torque Wrench Length (in.)	Calculated Torque (ft-lbf)
10 " to 11"	13
12" to 15"	14
16" to 20"	15

**NOTE: The seat track wrench provided *MUST* be used when using the values in the table.**

- h) Ensure that the track adjustment gauge pins are still flush with the seat track and that the track orientation did not move while torquing the nuts.

### Tighten the nuts to fasten the seat tracks

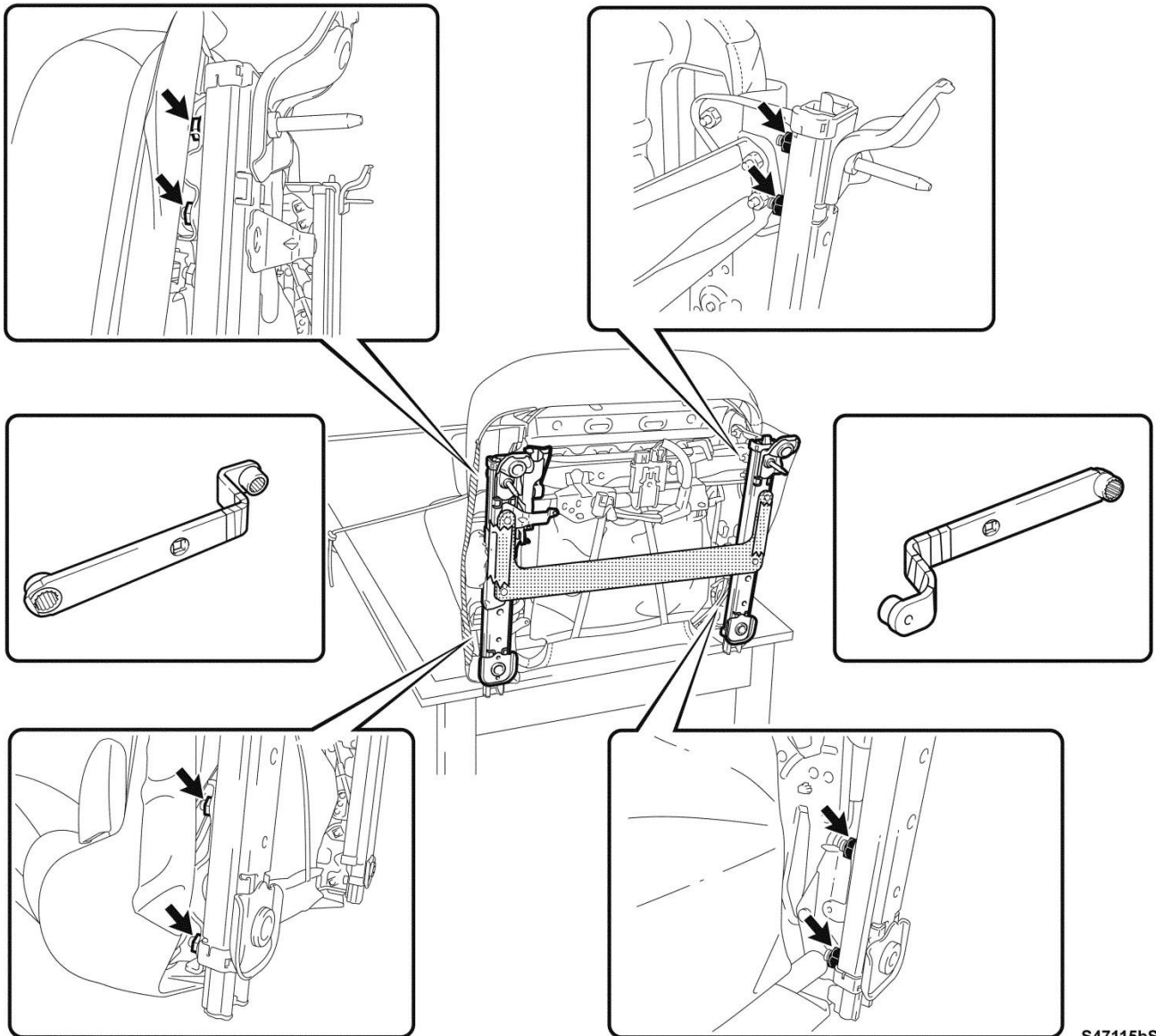

S47115bS



- Always use the gauge when installing the seat tracks to prevent the tracks from being misaligned.
- Do not press hard on the gauge; otherwise the gauge may become deformed.
- Ensure all 4 pins are properly installed before and after torquing the nuts.

## Remove the gauge

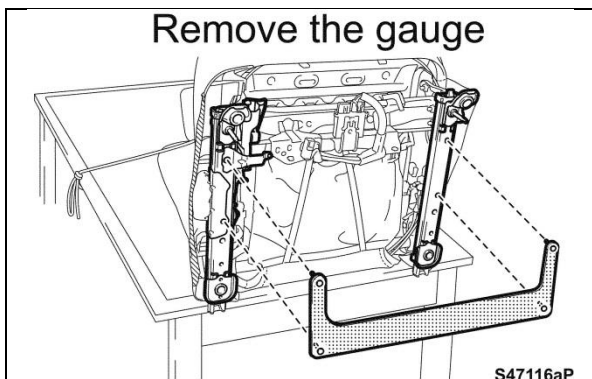

i) Remove the adjustment gauge.

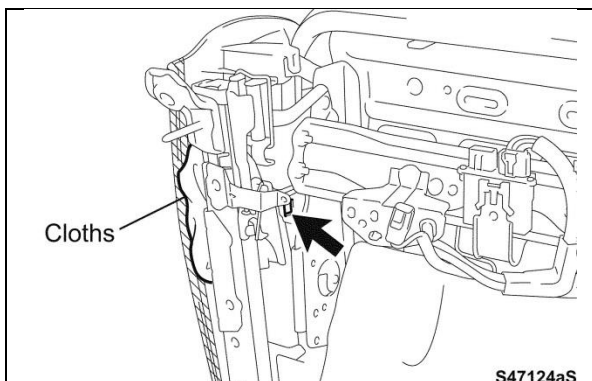

j) Remove the cloth and protective tape.

k) Engage the center clip of the seat cushion outer shield.

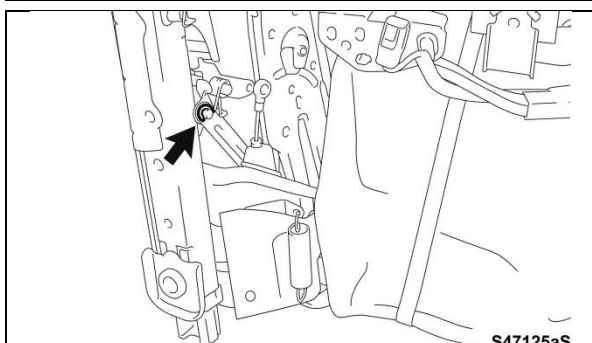

l) Fasten the lever with the **NEW** E-ring

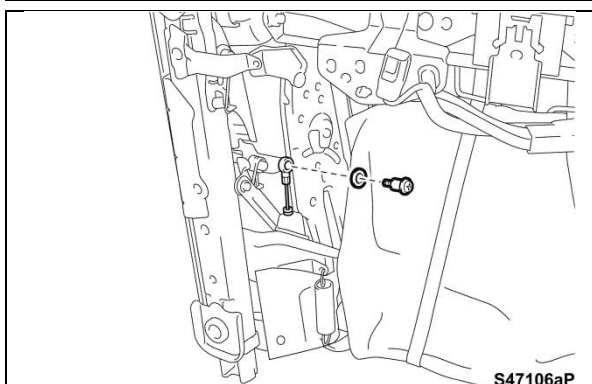

m) Clean and degrease the screw.

n) Apply an adhesive to the screw thread

### Adhesive:

**Toyota Genuine Adhesive 1324, Three Bond 1324 or equivalent medium strength thread locking compound**

o) Fasten the cable with the screw and washer.

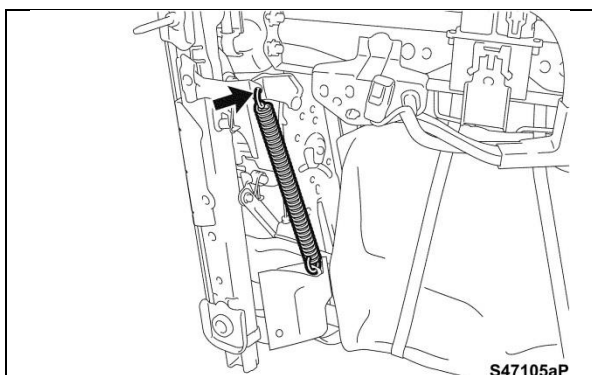

p) Install the spring.



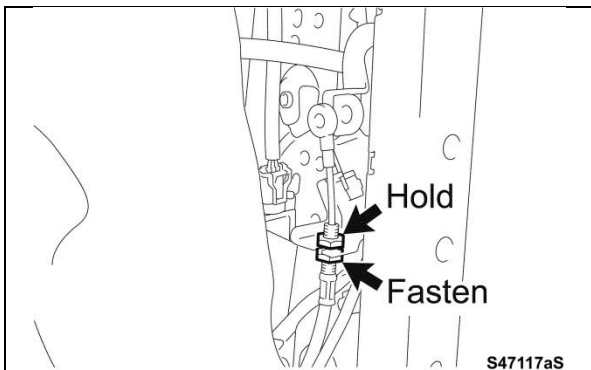

q) Tighten the lower nut while holding the upper nut.

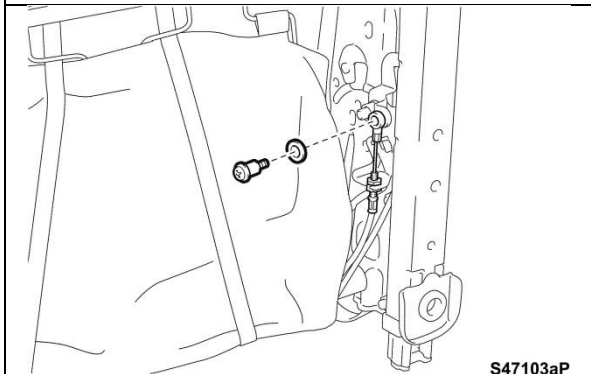

r) Clean and degrease the screw.

s) Apply an adhesive to the screw thread

**Adhesive:**

**Toyota Genuine Adhesive 1324, Three Bond 1324 or equivalent medium strength thread locking compound**

t) Fasten the cable with the screw and washer.

#### 4. REINSTALL PASSENGER SEAT TRACK ADJUSTMENT BAR

c) Insert the both sides of the adjustment bar at the same time into the seat tracks and engage the locking plate and spring.

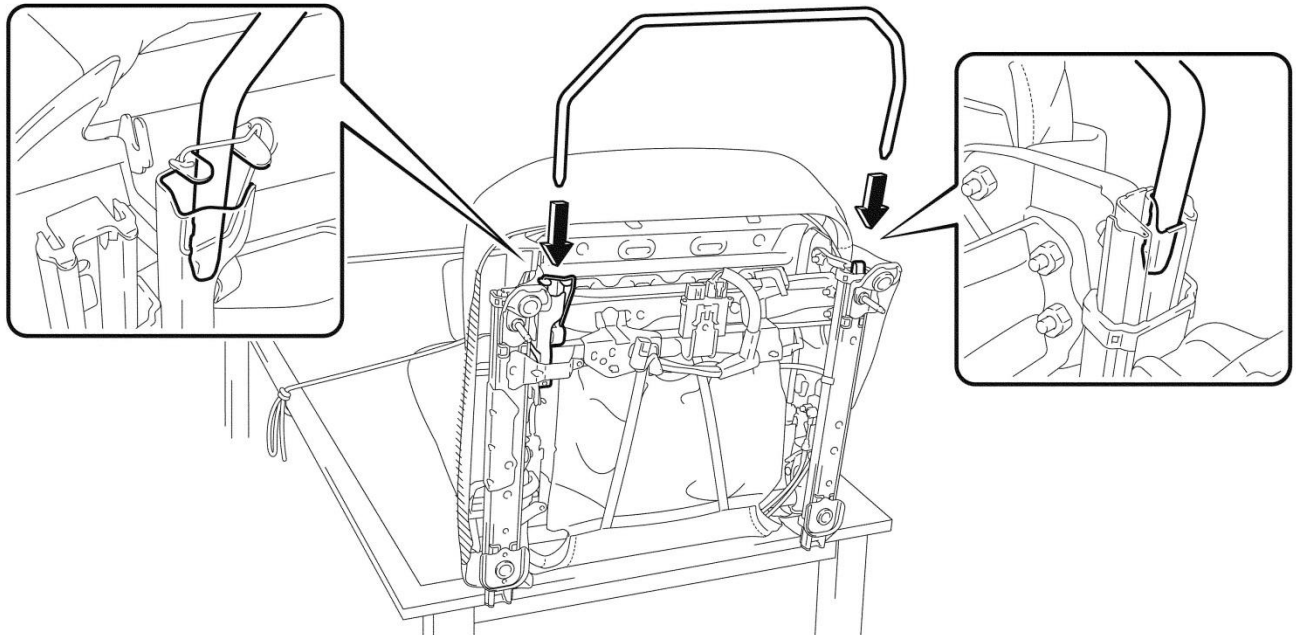

Confirm the adjusting handle is reinstalled

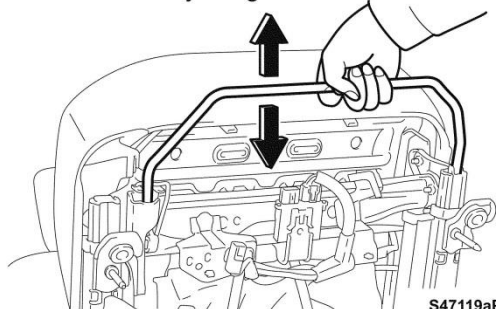

S47119aP

- d) Confirm that the seat adjustment handle is fully seated and secured by the locking plate and spring.

## 5. ADJUST SEAT RAIL POSITION

- b) Adjust the seat rail position so that the upper and lower seat rail are flush in the front: this will make it easier to install the seat in the car.

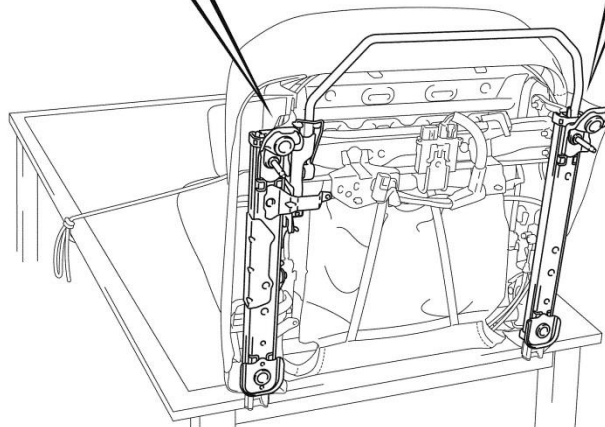
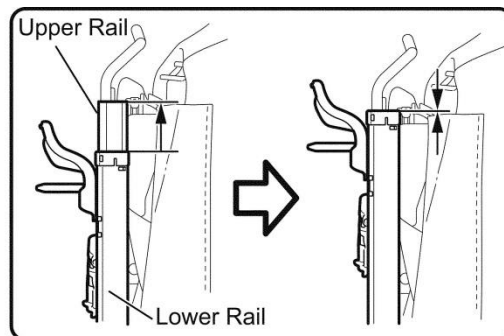
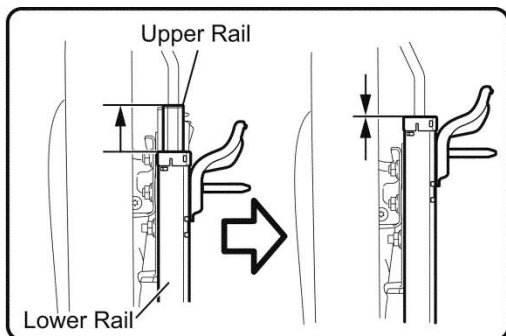

S47120aP

## 6. REINSTALL FRONT SEAT CUSHION LOWER SHIELD

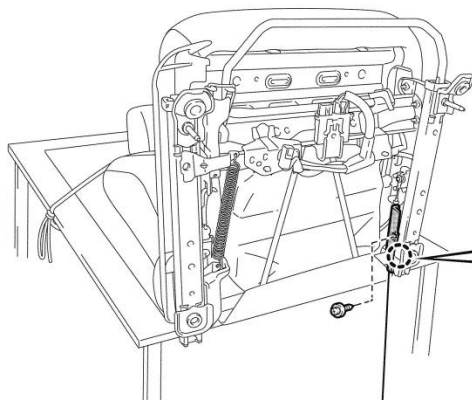

Shield LH

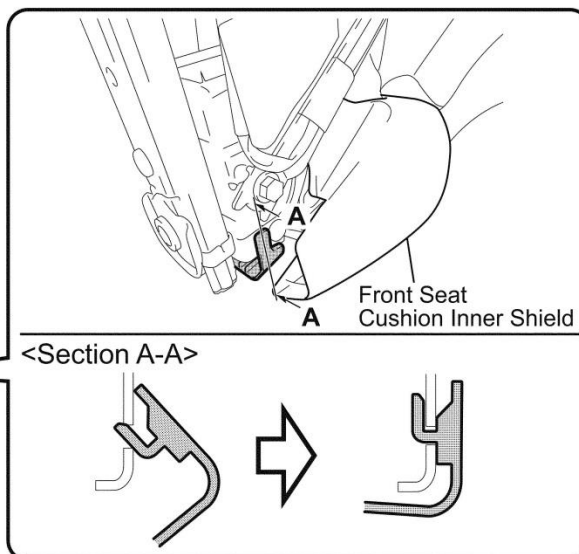

Claw

S47121aS

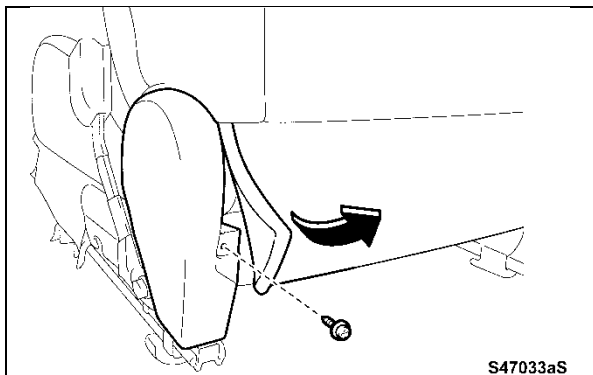

#### 7. REINSTALL SEAT CUSHION INNER SHIELD SCREW

- d) Remove the rope/tie down securing the seat to the table.
- e) Remove the seat cover.
- f) Reinstall the seat cushion inner shield screw.

### D. FRONT PASSENGER SEAT REINSTALLATION

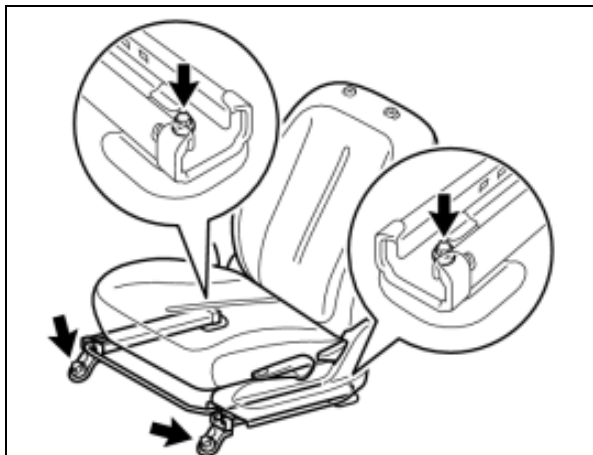

#### 1. REINSTALL THE SEAT INTO THE VEHICLE

- a) Using 2 people carefully place the seat into the vehicle.
- b) Align the alignment pins on the front of the seat tracks with alignment holes in the floor pan.
- c) Tilt the seat back and reconnect the connectors.
- d) Reinstall the 4 seat bolts and torque to spec.

**Torque: 37 Nm (375 kgf cm, 27ft lbf)**

- e) Reinstall headrest.
- f) Remove protective tape and protective blanket.

#### 2. RECONNECT BATTERY (FOR VEHICLES EQUIPPED WITH SIDE AIRBAGS)

- a) Reconnect battery ground cable.
- b) Reset radio and car presets.

#### 3. PERFORM THE ZERO POINT CALIBRATION FOR THE OCCUPANT CLASSIFICATION SYSTEM

#### 4. CHECK FOR DTCs.

### ◀ VERIFY REPAIR QUALITY ▶

- Confirm that the correct nuts are used for each seat track
- Confirm that the seat tracks are aligned properly both before and after torquing the seat track nuts
- Confirm that the seat track nuts are torque to spec
- Confirm that the seat position sensor gap is correctly set
- Confirm that the seat is clean and free of dirt and grease.

If you have any questions regarding this **recall**, please contact your regional representative.



## VIII. APPENDIX

### A. SEAT TRACK ALIGNMENT HOLE COATING REMOVAL



- Only remove coating from the holes that do not allow the gauge pins to seat flush.
- DO NOT file the coating too much, only remove the coating as necessary.

#### 1. DETERMINE WHICH HOLES PREVENT THE TOOL FROM SITTING FLUSH

#### 2. ELONGATED ALIGNMENT PIN HOLE COATING REMOVAL

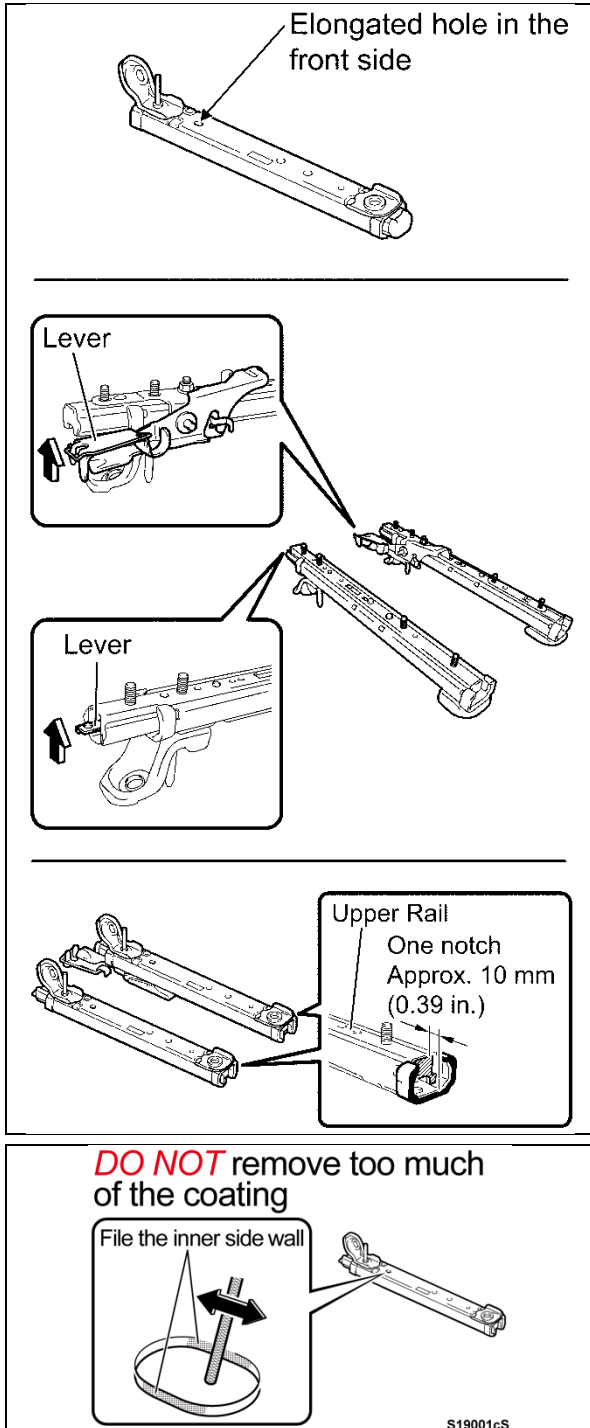

- Confirm that the upper rail is positioned one notch (approx. 10mm, 0.39 in.) from the rear of the lower rail for both tracks.
- If the upper rail is not in the correct position, pull the seat levers to adjust the upper rail positions.



If the upper rail is not in the specified position, damage to the seat track can occur from the filings.

- Using a round file, remove a little bit of the coating on the inner side wall.
- Check to see if the gauge alignment pin will fit properly.
- If not repeat steps c) and d) until it fits properly.



**DO NOT** remove too much of the coating. Otherwise the alignment gauge pin can easily move or come out during seat track installation.

### 3. ROUND ALIGNMENT PIN HOLE COATING REMOVAL

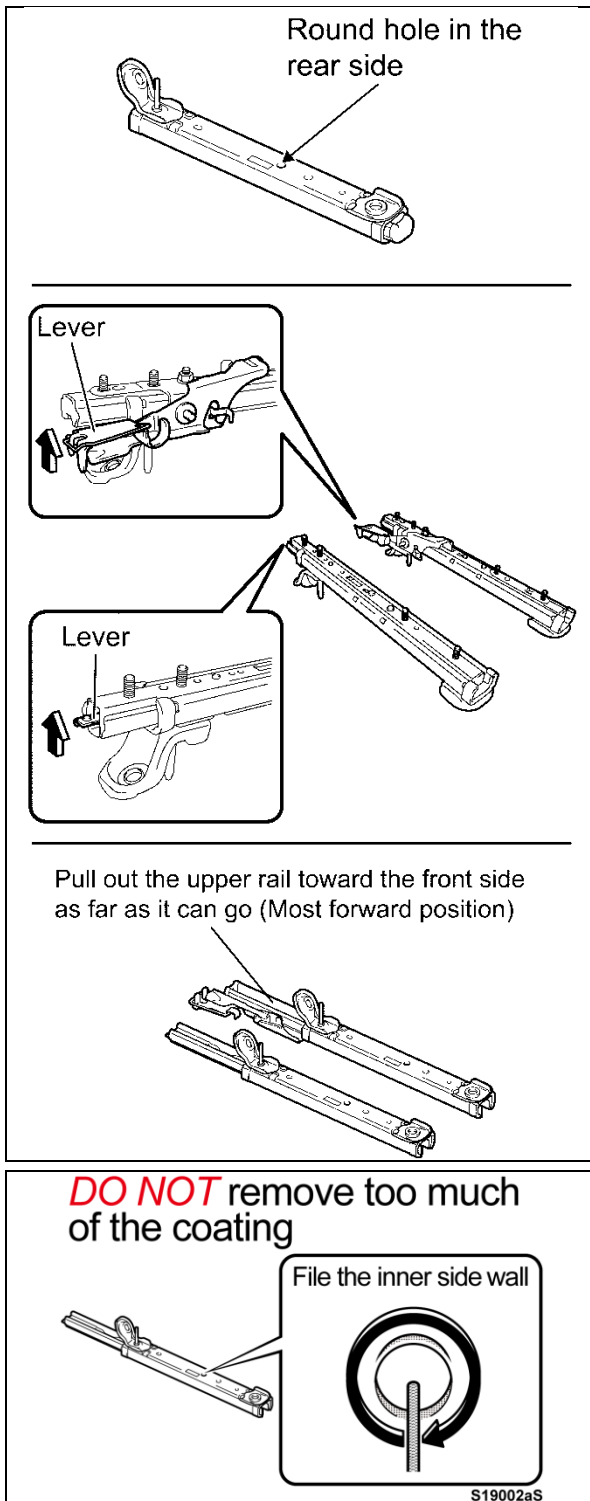

- a) Pull the seat adjustment lever and adjust the upper rail so that it is in the forward most position.



If the upper rail is not in the specified position, damage to the seat track can occur from the filings.

- b) Using a round file, remove a little bit of the coating on the inner side wall.  
c) Check to see if the gauge alignment pin will fit properly.  
d) If not repeat steps c) and d) until it fits properly.



**DO NOT** remove too much of the coating. Otherwise the alignment gauge pin can easily move or come out during seat track installation.

## A. CAMPAIGN DESIGNATION DECODER

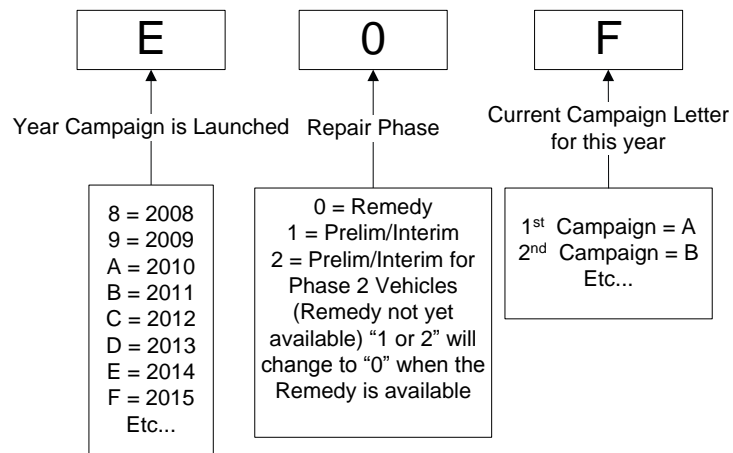

## B. CAMPAIGN PARTS DISPOSAL

Make sure all campaign parts (original parts) removed from the vehicle are disposed of in a manner in which they will not be reused, ***unless requested for parts recovery return.***