



STRICK TRAILERS, LLC

225 Lincoln Highway
Fairless Hills
Pennsylvania, USA
19030.0009
215.949.3600



IMPORTANT SAFETY RECALL

**This notice applies to your vehicles
identified on the enclosed spreadsheet**

December 5, 2014

CERTIFIED MAIL – R.R.R.

Bridgestone Americas, Inc.
Attn: Kirk Rutherford
535 Marriott Drive
Nashville, TN 37214

Dear Mr. Rutherford,

This notice is sent in accordance with the requirements of the National Traffic and Motor Vehicle Safety Act.

Strick Trailers, LLC (“Strick Trailers”) has decided that certain single axle fixed suspension dry freight van trailers manufactured April 2008 to June 2014 fail to comply with the Federal Motor Vehicles Safety Standards No. 223 and 224, “Rear Impact Guards.” Your affected trailers are identified on the enclosed spreadsheet.

The noncompliance is in regards to the curbside and roadside rear impact guard gussets. Strick Trailers identifies the gussets with the numbers 40033 and 40034. These gussets do not meet the requirements of Federal Motor Vehicle Safety Standards 223 and 224 pertaining to rear impact guards. This could increase the risk of injury in the event of a rear impact crash.

In order to remedy the noncompliance, it will be necessary to reinforce the curbside and roadside rear impact guard gussets in accordance with the instructions (Drawing 703527) attached to this letter. The design of the reinforcements, in turn, will lower the impact guard horizontal. We will supply the new reinforcement parts without cost and will ship them to multiple locations at your request. The parts necessary to reinforce the gussets are expected to be available for delivery beginning on January 26, 2015. We will also reimburse you for the reasonable direct labor costs involved in effecting the repair or will have the repair facilities bill us directly. The work to reinforce the rear impact guard gussets will take approximately two and one half hours to perform.

We will make ourselves available to answer any questions that arise during the course of this modification program, and, if requested, assist you in locating qualified repair facilities. We will also provide training or any other support you need. If you need any assistance, please contact me, Jerry Clontz, at jclontz@diamatrix.net or 1-704-436-2590.



Bridgestone Americas, Inc.

December 5, 2014

Page 2

Invoices for completed work should be submitted with authorization number M2014036 and a list of vehicle identification numbers for the serviced equipment to:

Strick Trailers, LLC
301 N. Polk Street
Monroe, IN 46772

If you have had your vehicle repaired prior to receipt of this notice, you may be entitled to reimbursement if you incurred any out-of-pocket cost due to this matter. For further information, please contact us at 1-704-436-2590.

Federal law requires any lessor who receives a notification of a determination of a safety-related defect or noncompliance pertaining to any leased motor vehicle to send the notice to the lessee within 10 days.

We regret any inconvenience this action may cause you. However, we are concerned about your safety, and we have notified the National Highway Traffic Safety Administration of this program. If you are unable to have these defects remedied without charge, you may submit a complaint to:

Administrator, U.S. Department of Transportation
National Highway Traffic Safety Administration
Office of Defects Investigation
1200 New Jersey Avenue, SE
Washington, D.C. 20590

Alternatively, you may call the toll-free Vehicle Safety Hotline at 1-888-327-4236 (TTY: 1-800-424-9153) or go to <http://www.safercar.gov>.

Thank you for your attention to this important matter.

Very truly yours,

Jerry Clontz

Enc.

<u>Customer</u>	<u>VIN</u>	<u>Make</u>	<u>Model</u>	<u>Model Year</u>	<u>Date of Manufacture</u>	<u>Model Description</u>
Bridgestone	1S11E9320CE525889	Strick	S432OE99NFW	2012	10/25/11	Single axle 32 foot van trailer
Bridgestone	1S11E9327CE525890	Strick	S432OE99NFW	2012	10/25/11	Single axle 32 foot van trailer
Bridgestone	1S11E9329CE525891	Strick	S432OE99NFW	2012	10/18/11	Single axle 32 foot van trailer
Bridgestone	1S11E9320CE525892	Strick	S432OE99NFW	2012	10/24/11	Single axle 32 foot van trailer
Bridgestone	1S11E9322CE525893	Strick	S432OE99NFW	2012	10/17/11	Single axle 32 foot van trailer

STRICK TRAILERS, LLC #703527 REAR IMPACT GUARD FIELD RETROFIT INSTRUCTIONS:

NOTE: THE FOLLOWING INSTRUCTIONS AND DIAGRAMS HAVE BEEN PROVIDED FOR THE PURPOSE OF UPDATING THE EXISTING STRICK O.E.M. REAR IMPACT GUARD. THE PERSON(S) PERFORMING THE WORK SHOULD ADHERE STRICTLY TO THE INSTRUCTIONS SET FORTH HEREIN AND BE FAMILIAR WITH THE REQUIREMENTS OF ALL APPLICABLE REGULATIONS, INCLUDING BUT NOT LIMITED TO FEDERAL MOTOR CARRIER SAFETY ADMINISTRATION REGULATIONS PART 393.86 (REAR IMPACT GUARDS AND REAR IMPACT PROTECTION) AND/OR CANADA MOTOR VEHICLE SAFETY STANDARD 223 (REAR IMPACT GUARD). ALL WELDING IS TO BE PERFORMED BY A QUALIFIED PERSON(S) WITH SUITABLE EQUIPMENT TO PERFORM THE NECESSARY STEPS AS LAID OUT BELOW. WELDING RODS AND/OR WIRE TO BE ER309LSI, OR EQUAL.

SAFETY PRECAUTIONS:

STRICK REAR IMPACT GUARD (RIG) ASSEMBLIES OR COMPONENTS MUST NOT BE INSTALLED ON OTHER MANUFACTURERS' TRAILERS.

BEFORE BEGINNING THE WORK, MAKE CERTAIN THE TRAILER IS CHOCKED TO PREVENT MOVEMENT. USE A CONSPICUOUS SIGN, BARRIER OR OTHER METHOD TO PREVENT A TRACTOR FROM BACKING UNDER THE TRAILER DURING THE REPAIR PROCESS.

PROPER PROTECTIVE EQUIPMENT SHOULD BE WORN AT ALL TIMES DURING REAR IMPACT GUARD MODIFICATION.

STEPS:

1. PREPARE ALL SURFACES INCLUDING EXISTING AND NEW FOR WELDING.
2. POSITION DOUBLE BEND REINFORCEMENT ITEMS ① & ② AND TACK IN PLACE AS SPECIFIED ON SHEET 2.
3. VERIFY FIT AND WELD ITEMS ① & ② AS SPECIFIED ON SHEET 3.
4. POSITION TRIANGULAR GUSSETS ITEM ⑥ AND TACK IN PLACE AS SPECIFIED ON SHEET 2.
5. VERIFY FIT AND WELD ITEM ⑥ AS SPECIFIED ON SHEET 3.
6. POSITION REINFORCEMENTS ITEM ⑦ AND TACK IN PLACE AS SPECIFIED ON SHEET 2.
7. VERIFY FIT AND WELD ITEM ⑦ AS SPECIFIED ON SHEET 3.
8. POSITION REINFORCEMENT ITEM ③ AND TACK IN PLACE AS SPECIFIED ON SHEET 2.
9. VERIFY FIT AND WELD ITEM ③ AS SPECIFIED ON SHEET 3.
10. UNBOLT BUMPER TUBE FROM EXISTING MOUNTS.
11. CUT EXISTING ANGLE BRACKET VERTICAL FLANGES AND GRIND FLUSH WITH HORIZONTAL MATING SURFACE AS SPECIFIED ON SHEET 2.

12. ATTACH ITEM ④ & ⑤ TO BUMPER TUBE USING SUPPLIED NEW BOLTS, NUTS & WASHERS MAKING SURE TO POSITION WASHERS OVER ELONGATED HOLES AS SPECIFIED ON SHEET 2
13. ATTACH ASSEMBLED BUMPER TUBE AND EXTENSIONS TO BUMPER GUSSETS USING SUPPLIED NEW BOLTS & NUTS AS SPECIFIED ON SHEET 2. WELD EXTENSIONS TO BOTTOM FLANGE OF BUMPER GUSSETS AS SPECIFIED ON SHEET 3
14. ALLOW ALL NEW WELDS TO COOL BEFORE THOROUGHLY CLEANING AND APPLYING UNDERCOATING, PRIMER, PAINT, OR EQUIVALENT TO PREVENT CORROSION.
15. ANY QUESTIONS REGARDING THE INSTALLATION OF THE REAR IMPACT GUARD RETROFIT SHOULD BE DIRECTED TO STRICK TRAILERS LLC ENGINEERING AT 260-692-6121.

***DOUBLE BEND REINFORCEMENTS, TRIANGULAR GUSSETS AND INNER I-BEAM GUSSETS MUST BE FULLY INSTALLED PRIOR TO CLOSE OUT PLATES.

FASTENERS MUST BE TORQUED TO THE FOLLOWING VALUES:

5/8" GRADE 8 BOLTS WITH CLEAN DRY THREADS: 210FT-LBS TORQUE

1/2" GRADE 5 BOLTS WITH CLEAN DRY THREADS: 75FT-LBS TORQUE

703527/		702398.SLDRW		TOLERANCES UNLESS OTHERWISE SPECIFIED: FABRICATED PARTS DECIMAL = ± .005" ASSEMBLY'S DECIMAL = ± .001" ANGULAR ± 1°		DRAWN: RNH CHECKED:	DATE: 11/18/14 DATE:	MATERIAL: x STRICK STRICK TRAILERS, LLC MONROE, IN 48772 SW FIELD, INST, RIG, UPG, 40033/34, SF, SS, NOP, EXT	
THIS DRAWING IS LOANED FOR PURPOSE OF ENGINEERING STUDY ONLY WITH THE UNDERSTANDING THAT IT SHALL BE HELD IN CONFIDENCE AND FOR THE PURPOSES OF STRICK TRAILERS, LLC. IT IS NOT TO BE REPRODUCED, COPIED, USED, DISCLOSED OR DISPOSED OF DIRECTLY OR INDIRECTLY AND IS NOT TO BE USED IN WHOLE OR IN PART TO ASSIST IN MAKING OR TO FURNISH ANY INFORMATION FOR MAKING OF DRAWINGS PRINTS APPARATUS EQUIPMENT MATERIALS OR PARTS THEREOF EXCEPT IN ACCORDANCE WITH THE EXPRESS WRITTEN CONSENT OF STRICK TRAILERS, LLC.								PART NUMBER: 703527	
Sheet 1 of 3									

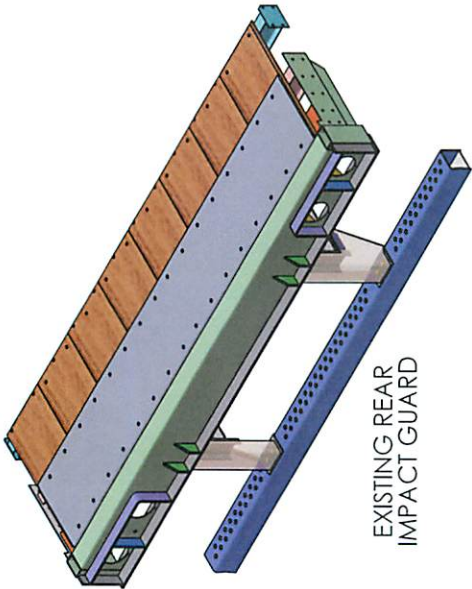
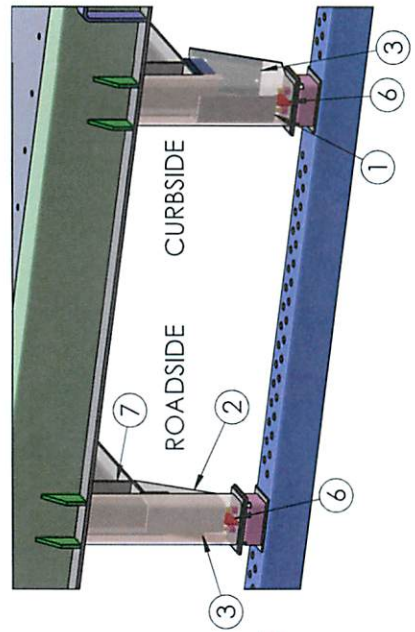
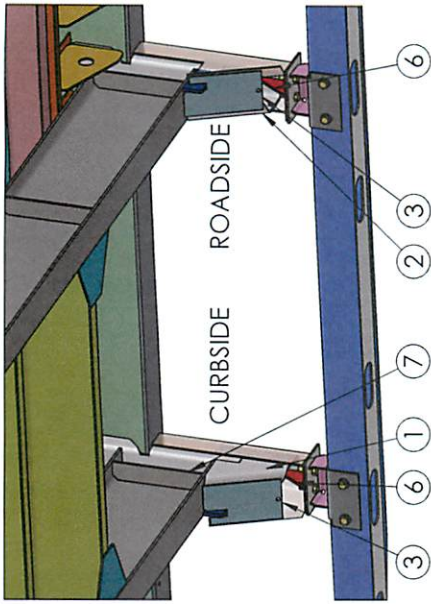

ITEM ① MUST BE FLAT AGAINST SIDE AND REAR SURFACES OF EXISTING BUMPER GUSSET AS SHOWN

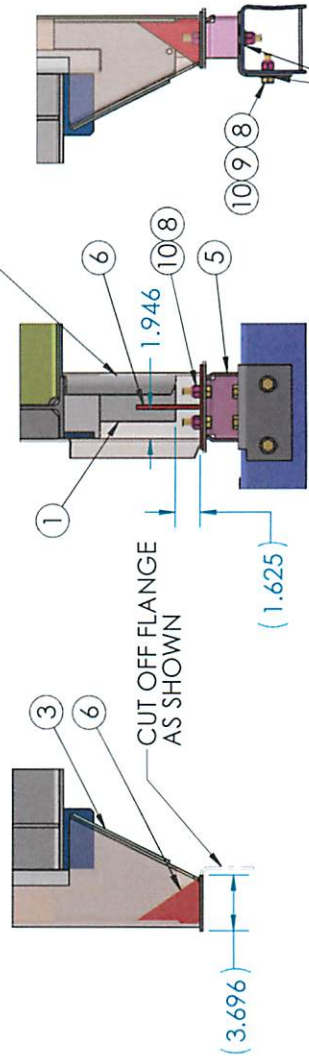

PLACE WASHERS AS SHOWN

MATERIAL: X		DATE		DATE		DATE	
DRAWN		RNH		11/18/14		11/18/14	
CHECKED		CHECKED		CHECKED		CHECKED	
TOLERANCES UNLESS SPECIFIED		ASSEMBLY'S		ANGULAR ±1°		DECIMAL ±.001	
FABRICATED PARTS		DECIMAL ±.005		DECIMAL ±.001		ANGULAR ±1°	
702398.SLDDRW		703527/		703527/		703527/	
THIS DRAWING IS LOANED FOR THE PURPOSE OF ENGINEERING STUDY ONLY WITH THE UNDERSTANDING THAT IT SHALL BE HELD IN CONFIDENCE AND FOR THE PURPOSES OF STRICK TRAILERS, LLC. IT IS NOT TO BE REPRODUCED, COPIED, USED DISCLOSED OR TRANSMITTED IN ANY MANNER WITHOUT THE EXPRESS WRITTEN CONSENT OF STRICK TRAILERS, LLC.		FIELD, INST, RIG, UPG, 40033/34, SF, SS, NOP, EXT		STRICK TRAILERS, LLC		MONROE, IN 46772	
PART NUMBER		703527		Sheet 2 of 3		REV	

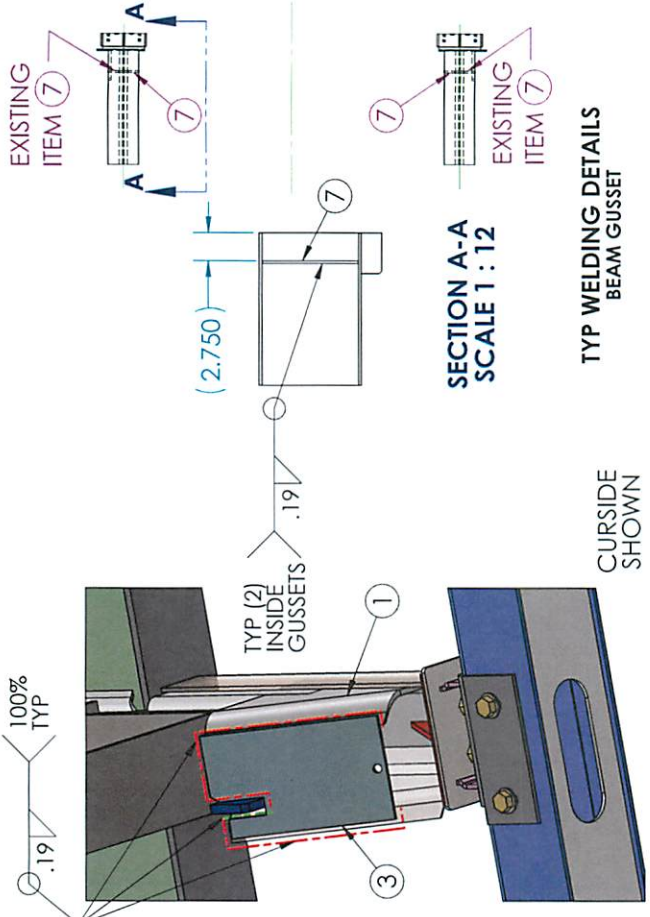

**SECTION A-A
SCALE 1 : 12**

**TYP WELDING DETAILS
BEAM GUSSET**

**TYP WELDING DETAILS
NOTCHED CLOSEOUT PLATE**

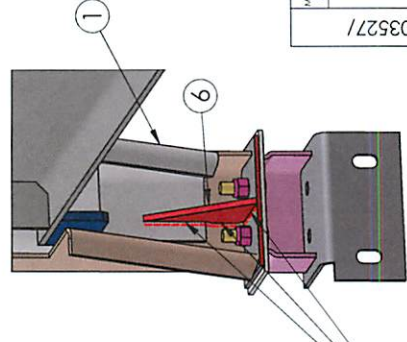

**TYP WELDING DETAILS
TRIANGULAR GUSSET PLATE**

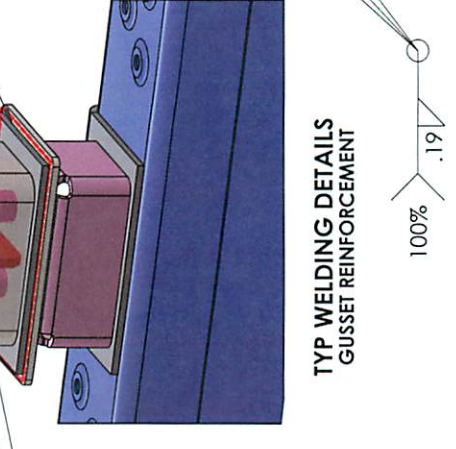

**TYP WELDING DETAILS
GUSSET REINFORCEMENT**

MATERIAL: X		DATE	DATE	DATE	DATE
STRICKS		11/18/14	11/18/14	11/18/14	11/18/14
STRICK TRAILERS, LLC		MONROE, IN 46772	MONROE, IN 46772	MONROE, IN 46772	MONROE, IN 46772
FIELD, INST, RIG, UPG, 40033/34, SF, SS, NOP, EXT					
702398.SLDDRW		ASSEMBLY'S DECIMAL = 4.001	ANGLULAR 21*	Sheet 3 of 3	
703527/		<p>THIS DRAWING IS LOANED FOR PURPOSE OF ENGINEERING STUDY ONLY WITH THE UNDERSTANDING THAT IT SHALL BE HELD IN CONFIDENCE AND FOR THE PURPOSES OF SIRICK TRAILERS, LLC. IT IS NOT TO BE REPRODUCED, COPIED, USED UNLESS SO INDICATED IN WRITING BY SIRICK TRAILERS, LLC. NO PART OF THIS INFORMATION FOR MAKING OF DRAWINGS, PRINTS, APPARATUS OR EQUIPMENT MATERIALS OF PARTS THEREOF EXCEPT IN WRITING WITH THE EXPRESS WRITTEN CONSENT OF SIRICK TRAILERS, LLC.</p>			

703527