

**JERR-DAN CORPORATION**

---

13224 FOUNTAINHEAD PLAZA  
HAGERSTOWN, MD 21742  
1-800-926-9666  
www.jerr-dan.com

# *SAFETY RECALL NOTICE*

**Attention:** Jerr-Dan Dealer  
**Subject:** Replacement of Underlift Tilt Counterbalance Valve  
**Models Affected:** Standard Duty Wrecker, MPL-NGS, MPL-NG and MPL40  
**Date:** July 7, 2014  
**Reference Number:** 14V-248

**Purpose:**

Jerr-Dan Corporation has decided that a defect which relates to motor vehicle safety exists in certain model year 2007-2014 Standard Duty Wrecker vehicles manufactured November 1, 2007 through March 3, 2014. The defect could exist in the counterbalance valve for the underlift tilt cylinder. Jerr-Dan has determined that over time, the internal components of the counterbalance valve can become damaged, allowing the underlift tilt cylinder to drift down from its initial position during towing of a disabled vehicle, allowing the towed vehicle to make contact with the road surface and increasing the risk of a vehicle crash. This Recall must be completed on all affected units.

**Required Action:**

1. Owners of the affected Standard Duty Wreckers manufactured November 1, 2007 through March 3, 2014 have received a Safety Recall Notice, NHTSA Campaign Number – 14V-248 (example enclosed). Owners of the affected trucks have been instructed to contact their local Jerr-Dan dealer to have this Recall performed.
2. Attached is a copy of the master serial number list of the affected Standard Duty Wreckers. Please verify the serial number is listed prior to performing any updates. Once the serial number has been verified as an affected Standard Duty Wrecker, please schedule with the owner of the truck an agreed upon time for completion of the update.
3. Discard any of Jerr-Dan Part number 7935000354 in your stock to prevent any further use.
4. A Counterbalance Replacement Kit, # 2890257 must be ordered for each affected unit. When ordering a Kit, you will be required to provide the serial number of the affected unit and will be charged (debited) for the cost of each Kit.

5. Upon receipt of the Kit, replace the underlift tilt circuit counterbalance valve on each affected unit as per the enclosed Underlift Tilt Circuit Counterbalance Valve Replacement Procedure. The time to complete the Procedure may vary due to a number of factors; however the estimated time for the Underlift Tilt Circuit Counterbalance Valve Replacement procedure is approximately half (1/2) an hour under normal circumstances.
6. Promptly notify Jerr-Dan of the completion of this Bulletin by sending the enclosed Campaign Completion Form to Jerr-Dan in accordance with the instructions on the form.
7. Please be reminded that it is a violation of Federal law for you to sell or lease an affected Standard Duty Wrecker covered by this notification until this recall has been performed on the Standard Duty Wrecker. Substantial civil penalties apply to violations of this law.

**Reimbursement of Costs:**

To receive reimbursement, the entity must file a warranty claim through the standard warranty process. When filing this claim, please reference "Notice # **14V-248**" so that proper credit may be issued.

Once Jerr-Dan is notified of the completion of the Underlift Tilt Circuit Counterbalance Valve Replacement Procedure, the responsible account will be reimbursed for the initial cost of the Counterbalance Replacement Kit that was ordered, # 2890257, and up to half (1/2) an hour of labor.

**Contacts:**

If you have any questions or need further information, please contact the Product Safety and Reliability Department by email ([productsafety@jerrdan.com](mailto:productsafety@jerrdan.com)) or telephone (800-926-9666).

**Enclosures:**

*Underlift Tilt Circuit Counterbalance Valve Replacement Procedure*

*Master Serial Number List*

*Example – Safety Recall Notice (Product Owner Notification)*

*Owner Update Form*

*Campaign Completion Form*

**PROCEDURE:** Underlift Tilt Circuit Counterbalance Valve Replacement Procedure  
**MODELS:** Jerr-Dan Standard Duty Wrecker, Models MPL-NGS, MPL-NG and MPL40

**Tools and Equipment Required:**

- Standard mechanic tools
- Hydraulic fluid drip pan
- Shop towels

**Personnel Required:**

- Qualified equipment mechanic

**Parts/Material Required:**

- Counterbalance Valve Replacement Kit, #2890257. One kit per affected machine, containing the following components:
  - Counterbalance valve assembly, P/N 1001173683, qty 1

***CAUTION: USE ALL APPLICABLE SAFETY PRECAUTIONS WHILE WORKING ON, UNDER OR AROUND ANY MACHINERY.***

**Procedure:**

1. Position truck on a firm and level surface.
2. Properly chock the wheels of the truck.
3. Lower the underlift so that it sits on the ground surface.
4. Tag the truck out of service to prevent further use during the course of this procedure.
5. Ensure that the engine has been shut off and the hydraulic fluid has cooled.
6. Thoroughly clean the area around the hydraulic valve assembly area of the underlift tilt cylinder.
7. Remove necessary items and components in order to gain access to the underlift tilt cylinder. Reference Illustration #1.

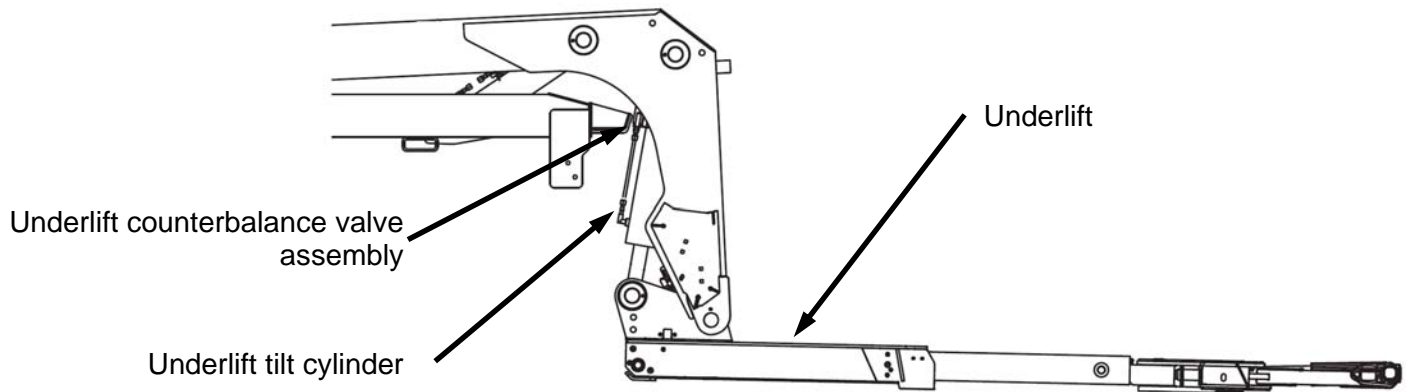

Illustration #1

8. Position a hydraulic fluid drip pan, if possible, under the fittings attached to the valve assembly area of the underlift tilt cylinder.

**Reference Illustration #2 for steps 9 through 15**

9. Mark all hydraulic connects as to their location on the counterbalance valve assembly.
10. Using a wrench, slowly loosen the hydraulic fittings to allow any excess pressure to escape.
11. Disconnect all hydraulic fittings that are attached to the counterbalance valve assembly. Use shop towels to absorb any residual hydraulic fluid.
12. Unbolt the two bolts that attach the valve assembly to the cylinder. Discard the valve assembly to prevent further use.
13. Properly attach the new valve assembly provided in the kit with the hardware from step #12. Properly torque the hardware.
14. Properly reinstall the removed hydraulic fittings from step # 11 into the new valve assembly at the proper location. Properly tighten all hydraulic fittings.
15. Clean any residual hydraulic fluid with a shop towel. Remove the hydraulic fluid drip pan and properly dispose of any oil.
16. Reassemble the unit and prepare for operation.
17. The unit may be returned to service once proper operation is confirmed.

Should any further discrepancies be discovered during the completion of this procedure, contact Jerr-Dan immediately for further evaluation.



Mark hydraulic lines to their positions and remove from the counterbalance valve assembly

Underlift tilt cylinder counterbalance valve assembly

Illustration #2

**Safety Recall Notice #14V-248**  
**Master Serial Number Listing**

0230000101	0230000184	0230000284	0230000347	0230000411	0230000485	0230000552
0230000103	0230000185	0230000285	0230000349	0230000412	0230000486	0230000553
0230000105	0230000187	0230000286	0230000350	0230000413	0230000488	0230000554
0230000107	0230000191	0230000287	0230000351	0230000415	0230000489	0230000555
0230000108	0230000192	0230000288	0230000352	0230000416	0230000490	0230000556
0230000109	0230000194	0230000289	0230000353	0230000419	0230000491	0230000557
0230000110	0230000196	0230000290	0230000355	0230000420	0230000492	0230000558
0230000111	0230000197	0230000291	0230000356	0230000423	0230000493	0230000563
0230000112	0230000198	0230000292	0230000357	0230000424	0230000495	0230000569
0230000113	0230000199	0230000293	0230000358	0230000428	0230000496	0230000570
0230000114	0230000200	0230000294	0230000359	0230000429	0230000497	0230000571
0230000115	0230000201	0230000298	0230000360	0230000430	0230000498	0230000572
0230000116	0230000202	0230000299	0230000361	0230000431	0230000499	0230000573
0230000117	0230000204	0230000300	0230000362	0230000433	0230000501	0230000581
0230000118	0230000205	0230000301	0230000363	0230000437	0230000502	0230000582
0230000119	0230000208	0230000302	0230000364	0230000439	0230000503	0230000583
0230000127	0230000209	0230000303	0230000368	0230000440	0230000504	0230000584
0230000128	0230000213	0230000304	0230000369	0230000441	0230000505	0230000588
0230000129	0230000220	0230000305	0230000370	0230000443	0230000506	0230000589
0230000130	0230000221	0230000306	0230000371	0230000444	0230000507	0230000590
0230000132	0230000222	0230000311	0230000372	0230000445	0230000509	0230000591
0230000135	0230000223	0230000312	0230000373	0230000446	0230000510	0230000592
0230000136	0230000224	0230000313	0230000374	0230000447	0230000511	0230000593
0230000139	0230000225	0230000314	0230000376	0230000448	0230000512	0230000594
0230000140	0230000226	0230000315	0230000377	0230000449	0230000513	0230000595
0230000142	0230000229	0230000316	0230000378	0230000450	0230000521	0230000598
0230000143	0230000230	0230000317	0230000379	0230000451	0230000522	0230000599
0230000144	0230000231	0230000318	0230000380	0230000453	0230000523	0230000600
0230000145	0230000234	0230000319	0230000381	0230000454	0230000525	0230000601
0230000146	0230000235	0230000320	0230000382	0230000456	0230000526	0230000602
0230000147	0230000236	0230000321	0230000383	0230000457	0230000527	0230000603
0230000150	0230000239	0230000322	0230000384	0230000458	0230000530	0230000604
0230000157	0230000240	0230000323	0230000385	0230000459	0230000531	0230000605
0230000161	0230000248	0230000324	0230000386	0230000460	0230000532	0230000606
0230000164	0230000249	0230000325	0230000387	0230000461	0230000533	0230000607
0230000165	0230000250	0230000326	0230000388	0230000462	0230000534	0230000609
0230000166	0230000251	0230000327	0230000390	0230000464	0230000535	0230000617
0230000168	0230000252	0230000328	0230000391	0230000465	0230000536	0230000618
0230000169	0230000253	0230000329	0230000396	0230000467	0230000537	0230000619
0230000170	0230000254	0230000331	0230000397	0230000468	0230000538	0230000620
0230000171	0230000255	0230000333	0230000399	0230000469	0230000539	0230000621
0230000172	0230000256	0230000334	0230000400	0230000473	0230000540	0230000622
0230000174	0230000257	0230000335	0230000401	0230000476	0230000541	0230000623
0230000177	0230000258	0230000336	0230000402	0230000477	0230000542	0230000624
0230000178	0230000260	0230000337	0230000403	0230000478	0230000543	0230000625
0230000179	0230000277	0230000338	0230000405	0230000479	0230000544	0230000626
0230000180	0230000278	0230000339	0230000406	0230000480	0230000545	0230000627
0230000181	0230000281	0230000340	0230000407	0230000481	0230000546	0230000628
0230000182	0230000282	0230000344	0230000409	0230000483	0230000547	0230000629
0230000183	0230000283	0230000346	0230000410	0230000484	0230000551	0230000630

**Safety Recall Notice #14V-248**  
**Master Serial Number Listing**

0230000631	0230000695	0230000779	0230000860	0230000950	0230001042	0230001134
0230000633	0230000696	0230000781	0230000861	0230000951	0230001044	0230001135
0230000634	0230000697	0230000782	0230000866	0230000953	0230001045	0230001137
0230000635	0230000698	0230000783	0230000867	0230000954	0230001046	0230001138
0230000636	0230000699	0230000785	0230000869	0230000956	0230001050	0230001141
0230000637	0230000700	0230000788	0230000870	0230000958	0230001051	0230001142
0230000638	0230000701	0230000789	0230000877	0230000959	0230001052	0230001143
0230000639	0230000702	0230000790	0230000878	0230000963	0230001053	0230001145
0230000640	0230000709	0230000791	0230000879	0230000964	0230001054	0230001148
0230000641	0230000710	0230000792	0230000880	0230000965	0230001055	0230001153
0230000642	0230000711	0230000793	0230000881	0230000966	0230001056	0230001155
0230000647	0230000712	0230000794	0230000882	0230000967	0230001057	0230001157
0230000648	0230000713	0230000795	0230000883	0230000974	0230001058	0230001159
0230000649	0230000714	0230000796	0230000885	0230000976	0230001059	0230001160
0230000650	0230000715	0230000797	0230000888	0230000977	0230001062	0230001162
0230000651	0230000716	0230000798	0230000890	0230000979	0230001063	0230001163
0230000652	0230000717	0230000804	0230000891	0230000980	0230001064	0230001164
0230000653	0230000718	0230000805	0230000892	0230000981	0230001065	0230001165
0230000654	0230000719	0230000808	0230000893	0230000982	0230001066	0230001166
0230000655	0230000720	0230000809	0230000894	0230000986	0230001067	0230001167
0230000656	0230000721	0230000810	0230000895	0230000987	0230001068	0230001169
0230000657	0230000722	0230000812	0230000896	0230000998	0230001069	0230001170
0230000660	0230000723	0230000813	0230000898	0230001000	0230001072	0230001171
0230000661	0230000724	0230000814	0230000899	0230001001	0230001073	0230001172
0230000662	0230000725	0230000819	0230000900	0230001003	0230001074	0230001173
0230000663	0230000726	0230000821	0230000903	0230001004	0230001075	0230001176
0230000664	0230000727	0230000822	0230000904	0230001005	0230001076	0230001179
0230000665	0230000731	0230000823	0230000905	0230001009	0230001077	0230001180
0230000666	0230000732	0230000824	0230000906	0230001010	0230001078	0230001181
0230000667	0230000733	0230000825	0230000907	0230001011	0230001080	0230001183
0230000668	0230000734	0230000826	0230000908	0230001012	0230001081	0230001185
0230000669	0230000735	0230000827	0230000909	0230001013	0230001085	0230001193
0230000670	0230000736	0230000828	0230000912	0230001014	0230001086	0230001194
0230000671	0230000737	0230000836	0230000913	0230001015	0230001087	0230001195
0230000672	0230000738	0230000837	0230000918	0230001016	0230001093	0230001201
0230000673	0230000739	0230000838	0230000919	0230001020	0230001094	0230001203
0230000674	0230000740	0230000839	0230000920	0230001021	0230001095	0230001205
0230000675	0230000741	0230000840	0230000922	0230001022	0230001096	0230001206
0230000676	0230000742	0230000841	0230000923	0230001023	0230001099	0230001210
0230000683	0230000743	0230000842	0230000924	0230001026	0230001121	0230001212
0230000684	0230000744	0230000850	0230000925	0230001027	0230001122	0230001213
0230000685	0230000745	0230000851	0230000926	0230001029	0230001123	0230001214
0230000686	0230000746	0230000852	0230000927	0230001030	0230001125	0230001218
0230000687	0230000751	0230000853	0230000928	0230001031	0230001126	0230001219
0230000689	0230000768	0230000854	0230000937	0230001032	0230001127	0230001220
0230000690	0230000769	0230000855	0230000938	0230001033	0230001128	0230001222
0230000691	0230000770	0230000856	0230000939	0230001035	0230001129	0230001223
0230000692	0230000776	0230000857	0230000940	0230001038	0230001130	0230001226
0230000693	0230000777	0230000858	0230000948	0230001040	0230001131	0230001227
0230000694	0230000778	0230000859	0230000949	0230001041	0230001132	0230001228

**Safety Recall Notice #14V-248**  
**Master Serial Number Listing**

0230001229	0230001298	0230001359	0230001421	0230001484	0230001572	0230001693
0230001230	0230001299	0230001360	0230001422	0230001485	0230001574	0230001694
0230001231	0230001300	0230001361	0230001423	0230001486	0230001575	0230001695
0230001234	0230001301	0230001362	0230001424	0230001487	0230001580	0230001696
0230001235	0230001302	0230001363	0230001425	0230001488	0230001583	0230001697
0230001236	0230001303	0230001364	0230001426	0230001489	0230001585	0230001698
0230001237	0230001305	0230001365	0230001427	0230001490	0230001586	0230001699
0230001238	0230001307	0230001366	0230001428	0230001496	0230001590	0230001703
0230001239	0230001308	0230001367	0230001429	0230001499	0230001591	0230001704
0230001242	0230001311	0230001368	0230001430	0230001501	0230001624	0230001705
0230001243	0230001312	0230001369	0230001431	0230001504	0230001626	0230001706
0230001245	0230001313	0230001370	0230001432	0230001505	0230001627	0230001708
0230001247	0230001314	0230001371	0230001434	0230001506	0230001628	0230001709
0230001248	0230001315	0230001372	0230001435	0230001510	0230001629	0230001710
0230001249	0230001316	0230001373	0230001436	0230001511	0230001630	0230001711
0230001252	0230001317	0230001374	0230001437	0230001512	0230001631	0230001712
0230001253	0230001318	0230001375	0230001439	0230001513	0230001632	0230001713
0230001254	0230001319	0230001376	0230001440	0230001514	0230001633	0230001714
0230001255	0230001320	0230001377	0230001441	0230001515	0230001634	0230001715
0230001256	0230001321	0230001378	0230001442	0230001516	0230001635	0230001718
0230001257	0230001322	0230001379	0230001443	0230001517	0230001636	0230001719
0230001258	0230001323	0230001381	0230001445	0230001518	0230001637	0230001720
0230001259	0230001324	0230001382	0230001446	0230001519	0230001638	0230001721
0230001260	0230001325	0230001385	0230001447	0230001522	0230001639	0230001722
0230001264	0230001326	0230001388	0230001448	0230001527	0230001640	0230001723
0230001265	0230001328	0230001389	0230001449	0230001528	0230001641	0230001724
0230001266	0230001330	0230001391	0230001450	0230001529	0230001642	0230001725
0230001267	0230001331	0230001392	0230001451	0230001532	0230001643	0230001726
0230001269	0230001332	0230001393	0230001452	0230001533	0230001644	0230001733
0230001271	0230001333	0230001394	0230001453	0230001534	0230001646	0230001734
0230001276	0230001334	0230001395	0230001454	0230001535	0230001648	0230001735
0230001277	0230001336	0230001396	0230001455	0230001536	0230001650	0230001736
0230001278	0230001337	0230001397	0230001456	0230001537	0230001651	0230001737
0230001279	0230001338	0230001398	0230001457	0230001540	0230001652	0230001738
0230001280	0230001339	0230001399	0230001458	0230001541	0230001653	0230001739
0230001281	0230001340	0230001400	0230001459	0230001543	0230001654	0230001740
0230001282	0230001341	0230001401	0230001460	0230001544	0230001655	0230001741
0230001283	0230001342	0230001402	0230001461	0230001545	0230001657	0230001742
0230001284	0230001345	0230001403	0230001462	0230001546	0230001662	0230001743
0230001285	0230001346	0230001404	0230001463	0230001550	0230001663	0230001744
0230001286	0230001347	0230001405	0230001464	0230001551	0230001664	0230001745
0230001287	0230001348	0230001410	0230001468	0230001559	0230001666	0230001746
0230001288	0230001349	0230001411	0230001469	0230001561	0230001679	0230001747
0230001289	0230001350	0230001412	0230001470	0230001562	0230001680	0230001748
0230001290	0230001351	0230001413	0230001475	0230001564	0230001683	0230001749
0230001293	0230001352	0230001414	0230001476	0230001565	0230001684	0230001750
0230001294	0230001353	0230001416	0230001477	0230001566	0230001685	0230001751
0230001295	0230001354	0230001417	0230001481	0230001567	0230001687	0230001753
0230001296	0230001355	0230001418	0230001482	0230001570	0230001688	0230001754
0230001297	0230001358	0230001419	0230001483	0230001571	0230001689	0230001755

**Safety Recall Notice #14V-248**  
**Master Serial Number Listing**

0230001756	0230001824	0230001904	2007103710	2007123829	2008013919	2008024052
0230001758	0230001826	0230001907	2007103711	2007123830	2008013923	2008024053
0230001759	0230001827	0230001913	2007103714	2007123831	2008013924	2008024057
0230001760	0230001828	0230001915	2007103715	2007123832	2008013925	2008024059
0230001761	0230001829	0230001916	2007103716	2007123834	2008013926	2008024060
0230001762	0230001830	0230001917	2007103717	2007123835	2008013927	2008024061
0230001764	0230001831	0230001919	2007103718	2007123838	2008013940	2008024062
0230001765	0230001832	0230001924	2007103719	2007123845	2008013945	2008024064
0230001766	0230001833	0230001927	2007103720	2007123846	2008013946	2008024065
0230001767	0230001835	0230001928	2007103724	2007123848	2008013947	2008024076
0230001768	0230001836	0230001929	2007103726	2007123849	2008013948	2008024078
0230001770	0230001838	0230001931	2007103727	2007123850	2008013949	2008024079
0230001771	0230001841	0230001933	2007103728	2007123851	2008013951	2008024084
0230001772	0230001844	0230001934	2007103733	2007123852	2008013957	2008024085
0230001773	0230001845	0230001935	2007103735	2007123853	2008013958	2008024086
0230001774	0230001846	0230001937	2007103736	2007123854	2008013959	2008024087
0230001775	0230001847	0230001939	2007103741	2007123856	2008013960	2008034095
0230001776	0230001848	0230001940	2007103742	2007123857	2008013961	2008034096
0230001778	0230001849	0230001942	2007103743	2007123858	2008013962	2008034097
0230001779	0230001850	0230001945	2007113746	2007123859	2008013971	2008034098
0230001780	0230001851	0230001946	2007113747	2007123860	2008013973	2008034099
0230001781	0230001852	0230001947	2007113749	2007123862	2008013975	2008034100
0230001784	0230001853	0230001950	2007113754	2007123863	2008013976	2008034105
0230001785	0230001855	0230001960	2007113758	2007123866	2008013977	2008034106
0230001787	0230001856	2007093620	2007113759	2007123871	2008013983	2008034108
0230001788	0230001858	2007093621	2007113785	2008013876	2008013985	2008034109
0230001789	0230001859	2007103651	2007113786	2008013877	2008024002	2008034114
0230001790	0230001860	2007103666	2007113791	2008013879	2008024003	2008034115
0230001791	0230001861	2007103671	2007113792	2008013880	2008024004	2008034116
0230001794	0230001862	2007103672	2007113793	2008013884	2008024005	2008034119
0230001795	0230001868	2007103673	2007113794	2008013885	2008024006	2008034120
0230001796	0230001869	2007103674	2007113798	2008013887	2008024012	2008034121
0230001797	0230001870	2007103675	2007113799	2008013888	2008024013	2008034122
0230001798	0230001871	2007103677	2007113800	2008013890	2008024014	2008034123
0230001799	0230001873	2007103678	2007123801	2008013891	2008024015	2008034124
0230001801	0230001874	2007103684	2007123802	2008013892	2008024016	2008034125
0230001803	0230001875	2007103687	2007123803	2008013893	2008024019	2008034126
0230001804	0230001877	2007103688	2007123804	2008013894	2008024020	2008034130
0230001805	0230001878	2007103689	2007123806	2008013896	2008024021	2008034139
0230001806	0230001879	2007103690	2007123808	2008013897	2008024022	2008034142
0230001807	0230001881	2007103691	2007123809	2008013898	2008024023	2008034144
0230001810	0230001882	2007103692	2007123810	2008013905	2008024024	2008034145
0230001811	0230001883	2007103697	2007123811	2008013907	2008024025	2008034146
0230001812	0230001884	2007103698	2007123816	2008013910	2008024027	2008034147
0230001813	0230001885	2007103699	2007123817	2008013911	2008024028	2008034148
0230001816	0230001888	2007103704	2007123821	2008013912	2008024029	2008034149
0230001817	0230001889	2007103705	2007123822	2008013915	2008024030	2008034152
0230001818	0230001893	2007103707	2007123825	2008013916	2008024032	2008034153
0230001820	0230001897	2007103708	2007123826	2008013917	2008024045	2008034154
0230001822	0230001901	2007103709	2007123827	2008013918	2008024051	2008034155

**Safety Recall Notice #14V-248**  
**Master Serial Number Listing**

2008034157	2008044193	2008071288	2008081375	2008101500	2008111604	2009011725
2008034159	2008044198	2008071289	2008081377	2008101501	2008111607	2009011726
2008034160	2008051093	2008071290	2008081392	2008101503	2008111608	2009011727
2008034161	2008051094	2008071291	2008081393	2008101506	2008111609	2009011728
2008034162	2008051095	2008071292	2008081394	2008101507	2008111612	2009011729
2008034163	2008051096	2008071293	2008081397	2008101508	2008111616	2009011730
2008034169	2008051098	2008071294	2008081401	2008101509	2008111621	2009011733
2008034174	2008051099	2008071295	2008081416	2008101510	2008111622	2009011735
2008041003	2008051100	2008071304	2008081417	2008101513	2008111624	2009011736
2008041017	2008051101	2008071309	2008081418	2008101514	2008111636	2009011737
2008041018	2008051103	2008071310	2008081419	2008101515	2008111638	2009011738
2008041027	2008051104	2008071311	2008081422	2008101516	2008121642	2009011739
2008041028	2008051105	2008071312	2008091435	2008101523	2008121646	2009011740
2008041029	2008051106	2008071313	2008091436	2008101525	2008121647	2009011741
2008041032	2008051107	2008071314	2008091437	2008101526	2008121648	2009011742
2008041033	2008051108	2008071315	2008091438	2008101527	2008121649	2009011744
2008041034	2008051119	2008071316	2008091440	2008101528	2008121652	2009011745
2008041035	2008051120	2008071317	2008091441	2008101529	2008121653	2009011747
2008041036	2008051124	2008071318	2008091442	2008101530	2008121654	2009021749
2008041050	2008051125	2008071319	2008091443	2008101531	2008121656	2009021752
2008041051	2008051151	2008071320	2008091445	2008101532	2008121657	2009021753
2008041052	2008051158	2008071325	2008091446	2008101533	2008121659	2009021756
2008041053	2008051159	2008071326	2008091447	2008101534	2008121664	2009021757
2008041054	2008051160	2008071327	2008091448	2008101535	2008121666	2009021758
2008041055	2008051161	2008071328	2008091450	2008101536	2009011674	2009021759
2008041056	2008051162	2008071329	2008091451	2008101537	2009011675	2009021760
2008041059	2008051168	2008071330	2008091452	2008101540	2009011676	2009021761
2008041060	2008051169	2008071331	2008091453	2008101541	2009011677	2009021762
2008041065	2008051173	2008071332	2008091458	2008101542	2009011678	2009021764
2008041068	2008051174	2008071333	2008091461	2008101543	2009011679	2009021765
2008041069	2008051179	2008071334	2008091462	2008101544	2009011680	2009021766
2008041070	2008051182	2008071335	2008091467	2008101545	2009011681	2009021767
2008041071	2008051184	2008071336	2008091468	2008101547	2009011682	2009021768
2008041072	2008051185	2008071337	2008091479	2008101548	2009011684	2009021769
2008041087	2008061188	2008071338	2008091480	2008101549	2009011685	2009021770
2008041088	2008061197	2008071354	2008091481	2008101554	2009011709	2009021771
2008044178	2008061206	2008071357	2008091482	2008101560	2009011710	2009021772
2008044179	2008061207	2008071358	2008091483	2008101561	2009011711	2009021773
2008044180	2008061211	2008071359	2008091485	2008101563	2009011712	2009021776
2008044181	2008061235	2008071360	2008091486	2008101564	2009011714	2009021777
2008044182	2008071275	2008071361	2008101490	2008101565	2009011715	2009021778
2008044183	2008071276	2008071362	2008101491	2008101578	2009011716	2009021779
2008044185	2008071277	2008071363	2008101492	2008101592	2009011717	2009021780
2008044186	2008071279	2008071364	2008101493	2008101593	2009011718	2009021781
2008044187	2008071280	2008081367	2008101494	2008111595	2009011719	2009021783
2008044188	2008071281	2008081369	2008101495	2008111597	2009011720	2009021787
2008044189	2008071283	2008081370	2008101496	2008111600	2009011721	2009021788
2008044190	2008071284	2008081371	2008101497	2008111601	2009011722	2009021789
2008044191	2008071286	2008081372	2008101498	2008111602	2009011723	2009021792
2008044192	2008071287	2008081373	2008101499	2008111603	2009011724	2009021794

**Safety Recall Notice #14V-248**  
**Master Serial Number Listing**

2009021795	2009031874	2009051992	2009072082	2009102194	2009122280	2010012355
2009021796	2009031875	2009051993	2009072084	2009102195	2009122281	2010012356
2009021797	2009041879	2009051994	2009072085	2009102196	2009122282	2010012359
2009021798	2009041880	2009051995	2009072087	2009102198	2009122289	2010012362
2009021799	2009041881	2009051996	2009072088	2009102199	2009122290	2010012363
2009021800	2009041884	2009051997	2009072092	2009102200	2009122291	2010012366
2009021801	2009041885	2009052000	2009072093	2009102201	2009122292	2010012368
2009021804	2009041886	2009052001	2009072094	2009102202	2009122293	2010012369
2009031814	2009041887	2009052002	2009072097	2009102203	2009122294	2010012374
2009031816	2009041888	2009052003	2009072098	2009102204	2009122295	2010012375
2009031817	2009041896	2009052007	2009082099	2009102205	2009122296	2010012378
2009031818	2009041897	2009062011	2009082100	2009102208	2009122297	2010012379
2009031819	2009041898	2009062012	2009082101	2009102210	2009122298	2010012380
2009031820	2009041899	2009062013	2009082103	2009102211	2009122299	2010012381
2009031821	2009041900	2009062014	2009082104	2009102212	2009122300	2010012382
2009031824	2009041903	2009062017	2009082105	2009102213	2009122301	2010012383
2009031825	2009041905	2009062030	2009082106	2009102214	2009122302	2010012384
2009031826	2009041906	2009062031	2009082118	2009102215	2009122303	2010012386
2009031827	2009041907	2009062032	2009082120	2009102216	2009122304	2010012408
2009031828	2009041908	2009062033	2009082121	2009102219	2009122305	2010022389
2009031829	2009041909	2009062034	2009082132	2009102220	2009122306	2010022390
2009031830	2009041910	2009062043	2009082133	2009102223	2009122307	2010022391
2009031831	2009041911	2009062045	2009082134	2009102225	2009122308	2010022392
2009031833	2009041913	2009062046	2009082135	2009102228	2009122309	2010022393
2009031834	2009041915	2009062047	2009082140	2009102229	2009122310	2010022395
2009031835	2009041916	2009062048	2009092146	2009102233	2009122311	2010022396
2009031836	2009041917	2009062049	2009092152	2009102238	2009122312	2010022397
2009031837	2009041918	2009062050	2009092153	2009102239	2009122313	2010022398
2009031838	2009041919	2009062052	2009092154	2009102240	2009122314	2010022399
2009031841	2009041920	2009062053	2009092155	2009102244	2009122315	2010022400
2009031848	2009041921	2009062054	2009092156	2009112247	2009122316	2010022404
2009031849	2009041922	2009062056	2009092159	2009112248	2009122317	2010022406
2009031850	2009041924	2009062057	2009092160	2009112249	2009122320	2010022407
2009031851	2009041925	2009062058	2009092162	2009112256	2009122321	2010022409
2009031852	2009041926	2009062059	2009092163	2009112257	2009122322	2010022412
2009031853	2009041927	2009062060	2009092164	2009112259	2009122323	2010022414
2009031854	2009041928	2009062061	2009092165	2009112260	2009122326	2010022415
2009031855	2009041929	2009062062	2009092167	2009112262	2010012328	2010022416
2009031856	2009051931	2009062065	2009092168	2009112263	2010012330	2010022417
2009031857	2009051933	2009062066	2009092169	2009112264	2010012331	2010022418
2009031858	2009051934	2009062067	2009092170	2009112265	2010012335	2010022419
2009031859	2009051935	2009062068	2009092171	2009112268	2010012336	2010022420
2009031860	2009051936	2009062069	2009092172	2009112269	2010012340	2010022421
2009031861	2009051939	2009072075	2009092173	2009112270	2010012341	2010022423
2009031862	2009051940	2009072076	2009092178	2009112271	2010012348	2010022424
2009031867	2009051948	2009072077	2009092181	2009112272	2010012349	B100017
2009031869	2009051950	2009072078	2009092182	2009112273	2010012350	B100018
2009031871	2009051969	2009072079	2009092183	2009112274	2010012351	B100019
2009031872	2009051973	2009072080	2009092185	2009112275	2010012352	B100021
2009031873	2009051975	2009072081	2009102193	2009122279	2010012354	B100022

**Safety Recall Notice #14V-248**  
**Master Serial Number Listing**

B100030	W040276	W040821
B100031	W040285	W040822
B100032	W040286	W040848
B100033	W040294	W040873
B100034	W040325	W040973
B100036	W040328	W041013
B100037	W040337	W041063
B100038	W040338	
B100054	W040340	
B100055	W040341	
B106144	W040348	
B106145	W040349	
B106146	W040353	
B106147	W040372	
B106183	W040373	
B106184	W040374	
B106189	W040379	
B106190	W040380	
B106224	W040385	
B106237	W040406	
B106240	W040413	
B106241	W040414	
B106243	W040429	
B106264	W040442	
B106268	W040473	
B106269	W040474	
B106272	W040475	
B106289	W040476	
B106303	W040485	
B106305	W040495	
B106307	W040514	
B106309	W040515	
B106325	W040519	
B106341	W040520	
B106382	W040533	
B106384	W040551	
B106390	W040555	
B106427	W040586	
W039439	W040609	
W039899	W040699	
W039920	W040753	
W040100	W040772	
W040102	W040773	
W040115	W040778	
W040167	W040779	
W040194	W040780	
W040195	W040790	
W040196	W040791	
W040205	W040807	
W040267	W040820	

## **JERR-DAN CORPORATION**

---

13224 FOUNTAINHEAD PLAZA  
HAGERSTOWN, MD 21742  
1-800-926-9666  
www.jerr-dan.com

# *SAFETY RECALL NOTICE*

**Attn: Product Owner**  
**Owner Name**  
**Address**  
**City, State, Postal Code**

**Date: July 7, 2014**  
**Reference Number: 14V-248**

**Certified Mail/Return Receipt #**

**Re: Standard Duty Wrecker Underlift**  
**Subject: Underlift Counterbalance Valve Replacement**

This notice is sent to you in accordance with the requirements of the National Traffic and Motor Vehicle Safety Act.

### **REASON FOR THIS RECALL**

Jerr-Dan Corporation has decided that a defect which relates to motor vehicle safety exists in certain model year 2007-2014 Standard Duty Wrecker vehicles manufactured November 1, 2007 through March 3, 2014. The defect could exist with the counterbalance valve for the underlift tilt cylinder. Jerr-Dan has determined that over time, the internal components of the counterbalance valve become damaged, allowing the underlift tilt cylinder to drift down from its initial position during towing of a disabled vehicle and allowing the towed vehicle to make contact with the road surface and increasing the risk of a vehicle crash. This Recall must be completed on all affected units.

### **WHAT SHOULD YOU DO?**

1. Please contact your Jerr-Dan Dealer as soon as possible to arrange a service date and so the dealer may order the necessary parts for the repair. Instructions for making this correction have been sent to your dealer and the parts are available. The labor time necessary to perform this service correction is approximately half (1/2) an hour. However, you should contact your dealer for information on the amount of time that will be needed to schedule and process your vehicle.

2. Discard any of Jerr-Dan Part number 7935000354 in your stock to prevent any further use.

Your Jerr-Dan dealer is best equipped to obtain parts and provide service to ensure that this condition is corrected as promptly as possible on your vehicle. If, however, you take your vehicle to your dealer on the agreed service date, and they do not remedy this condition on that date or within three (3) days, we recommend you contact the Jerr-Dan Product Safety and Reliability Department by:

Email: [productsafety@jerrdan.com](mailto:productsafety@jerrdan.com)

Telephone: 1-800-926-9666

After contacting your dealer and Jerr-Dan Product Safety and Reliability Department, if you are still not able to have the safety defect remedied without charge and within a reasonable time, you may wish to write the Administrator, National Highway Traffic Safety Administration, 1200 New Jersey Avenue, S.E., Washington, DC 20590 or call 1-888-327-4236 (TTY: 1-800-424-9153); or go to <http://www.safercar.gov>

If you had this repair performed before you received this letter, you may be eligible to receive reimbursement for the cost of obtaining a pre-notification remedy of the problem associated with this recall. For more information please contact Jerr-Dan at:

Email: [productsafety@jerrdan.com](mailto:productsafety@jerrdan.com)

Telephone: 1-800-926-9666

**Owner Verification:**

An Individual Serial Number List is enclosed, indicating Standard Duty Wreckers that you own according to Jerr-Dan records. Please review and verify your ownership of the units on the enclosed Individual Serial Number List. If the information specified on the Individual Serial Number List is incorrect, immediately complete the enclosed Owner Update Form for each incorrect unit and send the updated information to Jerr-Dan in accordance with the instructions on the form. Jerr-Dan will then contact the new owner of the wrecker.

Federal law requires any lessor who receives a notification of a determination of a safety-related defect or noncompliance pertaining to any leased motor vehicle shall send the notice to the lessee within 10 days.

We are sorry for any this inconvenience. However, we have taken this action in the interest of your safety and continued satisfaction with our products.

Jerr-Dan Corporation  
Product Safety and Reliability Dept.

Enclosures:  
*Owner Update Form*  
*Individual Serial Number List*



**Product Owner Update Form**

- Complete ALL Sections of this form and mail or fax to the appropriate location specified below.
- It is very important to keep Jerr-Dan updated with current product ownership information. By registering the products you own, you can ensure that Jerr-Dan will be better prepared to serve you and provide support.
- DO NOT include Lessees/Renters of Leased/Rented Products on this form.
- To report a *Scrapped, Stolen, Missing, or Recovered product*, use the "Jerr-Dan Product Status Verification Form No. PSR015-JDC."

**Product Information**

Make: \_\_\_\_\_ Model: \_\_\_\_\_

Serial Number or VIN/PIN: \_\_\_\_\_

Make: \_\_\_\_\_ Model: \_\_\_\_\_

Serial Number or VIN/PIN: \_\_\_\_\_

Make: \_\_\_\_\_ Model: \_\_\_\_\_

Serial Number or VIN/PIN: \_\_\_\_\_

Make: \_\_\_\_\_ Model: \_\_\_\_\_

Serial Number or VIN/PIN: \_\_\_\_\_

**Contact Information**

Company Name: \_\_\_\_\_

Street Address: \_\_\_\_\_

Address1: \_\_\_\_\_

City: \_\_\_\_\_ State/Province: \_\_\_\_\_ Zip/Postal Code: \_\_\_\_\_ Country: \_\_\_\_\_

Telephone: \_\_\_\_\_ Facsimile: \_\_\_\_\_ E-Mail Address: \_\_\_\_\_

Contact Name: \_\_\_\_\_ Signature: \_\_\_\_\_ Date: \_\_\_\_\_

**\*Product Owner Information**  (Same as Contact)

Company Name: \_\_\_\_\_

Street Address: \_\_\_\_\_

Address1: \_\_\_\_\_

City: \_\_\_\_\_ State/Province: \_\_\_\_\_ Zip/Postal Code: \_\_\_\_\_ Country: \_\_\_\_\_

Telephone: \_\_\_\_\_ Facsimile: \_\_\_\_\_ E-Mail/Website Address: \_\_\_\_\_

**Mail or Fax Completed Form to:**

**Jerr-Dan Corporation  
Product Safety & Reliability Department  
13224 Fountainhead Plaza  
Hagerstown, MD 21742**

**Facsimile: 301/745-3713  
Email: productsafety@jerr-dan.com**



Product Safety & Reliability Department  
13224 Fountainhead Plaza  
Hagerstown, MD 21742  
Telephone: (800) 926-9666  
Facsimile: (301) 745-3713  
E-Mail Address: ProductSafety@Jerr-Dan.com

<b>Campaign Completion Form</b>	➤ Complete <u>ALL</u> Sections of this form and mail or fax to the location specified above.
---------------------------------	--

**Product Information**

Make: _____	Model: _____	Hour Meter Reading: _____
Serial Number or VIN/PIN: _____		

**Completion Information**

Bulletin Number: _____	Completion Date: _____
------------------------	------------------------

**Completed By Contact Information**

Company Name: _____			
Street Address: _____		Address1: _____	
City: _____	State/Province: _____	Zip/Postal Code: _____	Country: _____
Telephone: _____	Facsimile: _____	E-Mail Address: _____	
Contact Name: _____	Signature: _____	Date: _____	

\* ***If you would like to update the current ownership information that we have on file for the above referenced unit, please complete and return an Owner Update Form (PSR008-JDC).***