



Applies To: **2007–08 Odyssey** – Check the iN VIN status for eligibility

**November 27, 2013**

## Safety Recall: 2007–08 Odyssey VSA System Unexpectedly Activates (Supersedes 13-098, dated November 6, 2013; see REVISION SUMMARY)

### REVISION SUMMARY

This bulletin has been extensively revised to include a repair procedure. American Honda recommends that you read this entire bulletin thoroughly.

### BACKGROUND

Because of a combination of installed VSA system components and software, it is possible for the VSA system to unexpectedly apply the brakes. Each time the vehicle is started, the VSA system calibrates the yaw rate sensor. If the vehicle is driven in a specific manner, the VSA system will not properly complete the calibration.

Owners of affected vehicles will receive a notification and instructions about how to properly calibrate the VSA system before driving to prevent unintended braking. These instructions are available at [www.recalls.honda.com](http://www.recalls.honda.com). Owners will receive a second notification when parts are available to repair their vehicle.

### CLIENT NOTIFICATION

Owners of affected vehicles will be sent a notification of this campaign.

Do an **iN VIN status inquiry** to make sure the vehicle is shown as eligible.

Some vehicles affected by this campaign may be in your used vehicle inventory. These vehicles **must** be repaired before they are sold, and there are a limited number of yaw rate sensors being allocated to repair those vehicles in dealer stock. More parts will be available in the first quarter of 2014.

Should your dealership sell an unrepaired vehicle that subsequently causes injury or damage because of the recalled item, the dealership will be solely responsible to the damaged party, and will be required to defend and indemnify American Honda for any resulting claims. To see if a vehicle in inventory is affected by this recall, do a VIN status inquiry before selling it.

### CORRECTIVE ACTION

Install a new yaw rate sensor (sensor cluster).

### PARTS INFORMATION

Sensor Cluster Kit (includes Sensor Cluster Assembly, Spacer, and two Washer Bolts):  
P/N 06390-SHJ-A00

### WARRANTY CLAIM INFORMATION

Operation Number: 2191W3

Flat Rate Time: 0.4 hour

Template ID: 13-098A

Failed Part: P/N 39960-SHJ-A01

Defect Code: 5VT00

Symptom Code: JC500

Skill Level: Repair Technician

### REPAIR PROCEDURE

1. Turn the ignition switch to LOCK (0), and open the driver's side power sliding door.

**NOTE:** If you open a sliding door when the battery is disconnected, you will have to reset the power sliding door control unit and rehome the power sliding doors.

2. Adjust the steering column so that it is tilted all the way up and to the full telescopic position. Adjust the driver's seat-back to recline to the middle position.
3. Remove the rear riser cover by detaching the clips and releasing the middle hooks.

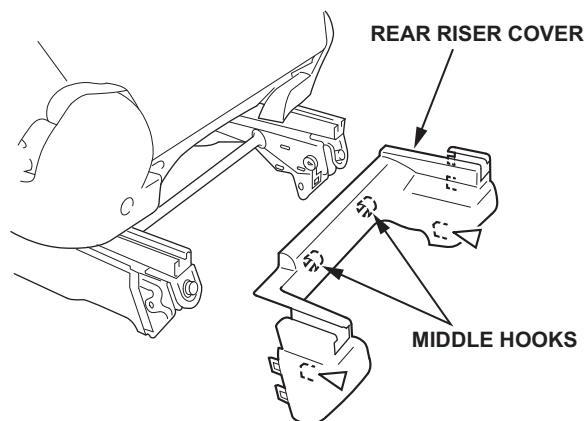

4. Slide the seat all the way back to access the front riser covers.
5. Remove the front riser cover from both sides by releasing the hook and detaching the clip.

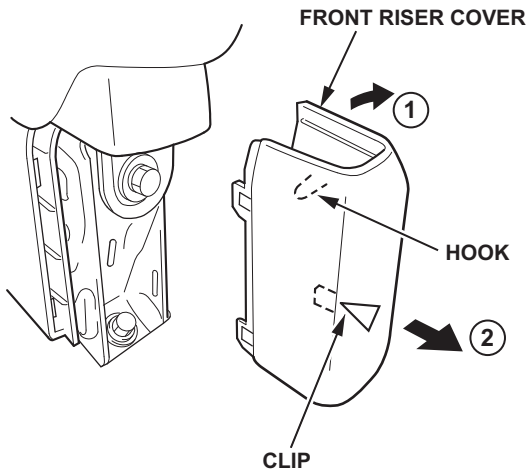

6. Remove the front seat mounting bolts.

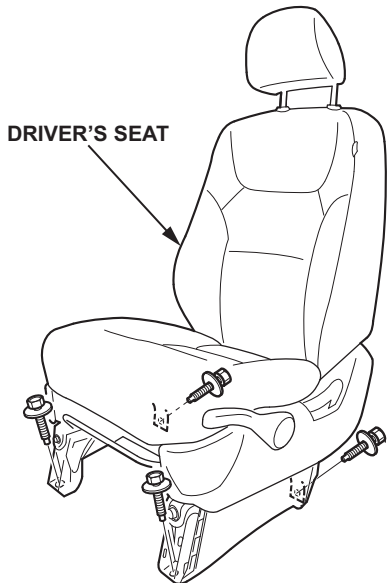

7. Make sure you have the audio and navigation (if equipped) anti-theft codes. Disconnect the negative battery cable, and wait at least three minutes before beginning work.

8. Tilt back the driver's seat, then disconnect the connectors.
  - Manual Height Adjustable Seat: Disconnect the side airbag, the seat belt switch, and the seat position subharness connectors.

**MANUAL HEIGHT AJUSTABLE SEAT ('07 Model)**

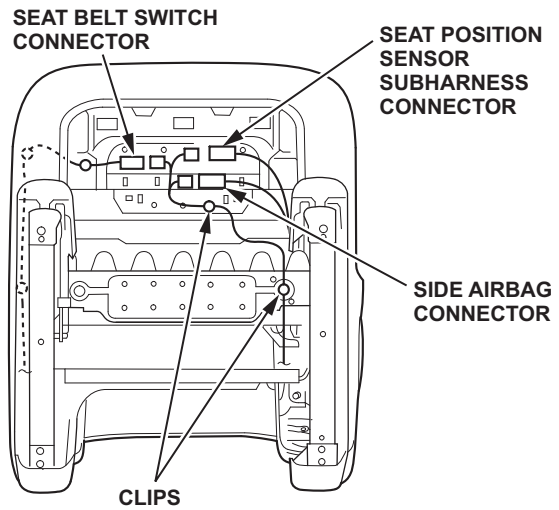

**MANUAL HEIGHT AJUSTABLE SEAT ('08 Model)**

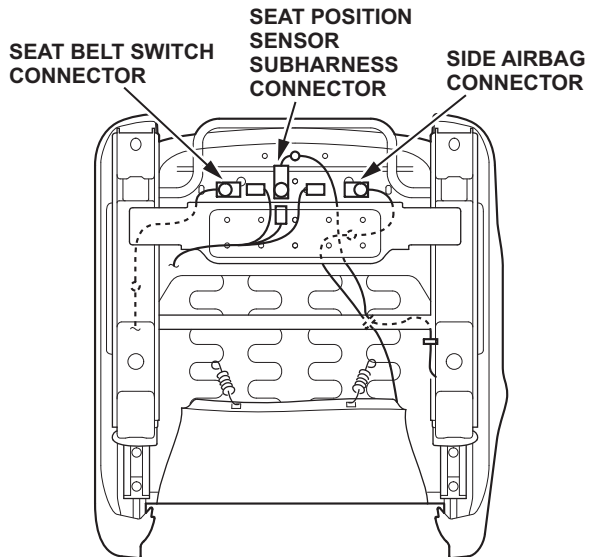

- 8-Way Power Seat: Disconnect the side airbag, the power seat harness, the navigation unit (if equipped), and the GPS antenna harness (if equipped) connectors.

**8-WAY POWER SEAT**

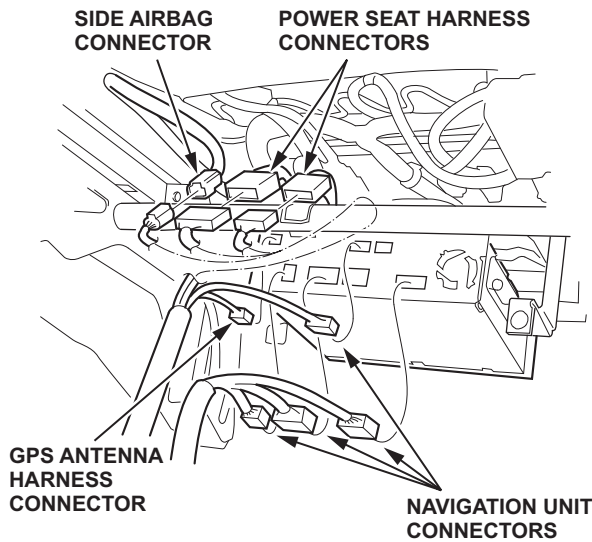

9. Remove the driver's door sill trim by releasing the hook, the tabs, and the pin from the kick panel and the B-pillar lower trim panel. Pull up the front door sill trim by hand to detach the clips, and release the pin, then remove the trim.

**NOTE:**

- Put on gloves to protect your hands.
- Take care not to bend or scratch the trim or the panels.
- Use the appropriate tool from the KTC trim tool set to avoid damage when removing components.

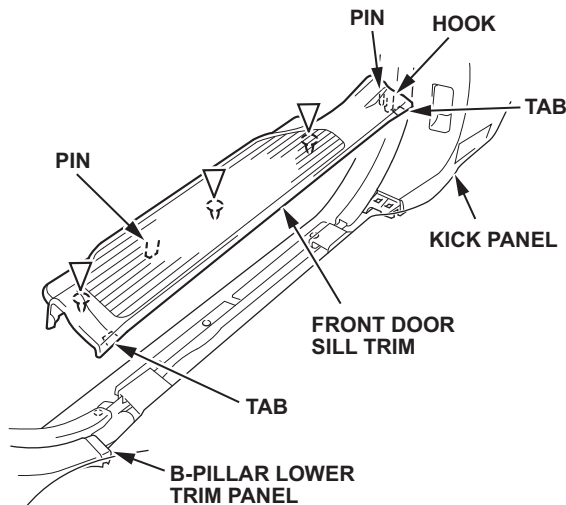

10. With the help of an assistant, lift the seat out of the vehicle, taking care not to damage or scratch any of the plastic door trim.

11. Pull the carpet back to access the sensor cluster.

**NOTE:** Fold the carpet gently so that you do not crease or wrinkle it.

12. Disconnect the sensor cluster connector and remove the sensor cluster.

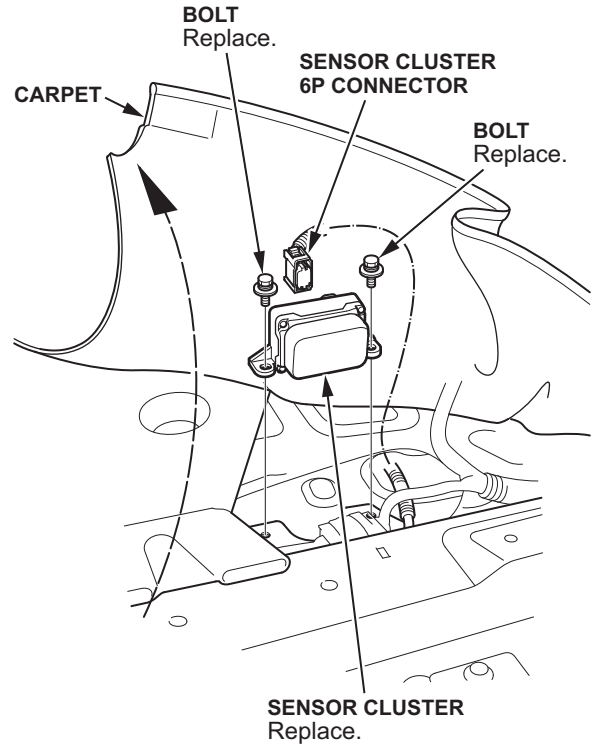

13. Install the new sensor cluster and the new spacer with new bolts. Torque the bolts to **9.8 N·m (7.2 lb-ft)**. Reconnect the connector.

**NOTE:**

- Make sure to install the spacer. There is an interference point on the floor that can damage the new sensor cluster if the spacer is missing.
- Make sure the sensor cluster is installed in the correct direction; the connector should be toward the front of the vehicle.
- Make sure no wires or other debris is pinched between the body, the spacer, and the sensor.

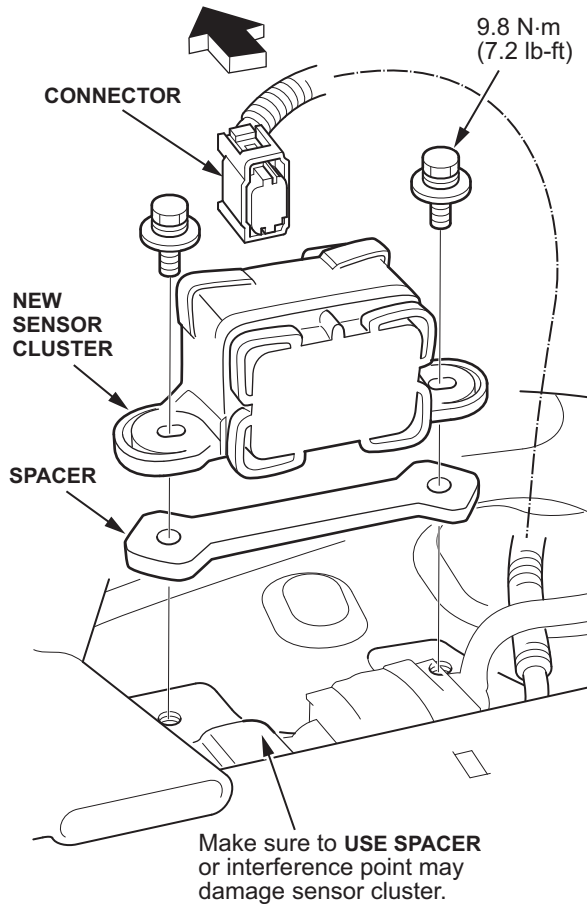

14. Reinstall the carpet and make sure it is properly tucked under the B-pillar trim, and make sure the duct is pulled through the carpet opening.

15. Install the seat and the riser covers in the reverse order of removal, noting these items:

- Apply medium strength liquid thread lock to the front seat mounting bolts, then install the bolts hand-tight.
- Make sure each connector is plugged in properly, then reconnect the negative battery cable.
- Tighten the seat mounting bolts to the specified torque in the sequence shown. Slide the seat all the way back and tighten 1 and 2, then slide it forward and tighten 3 and 4.

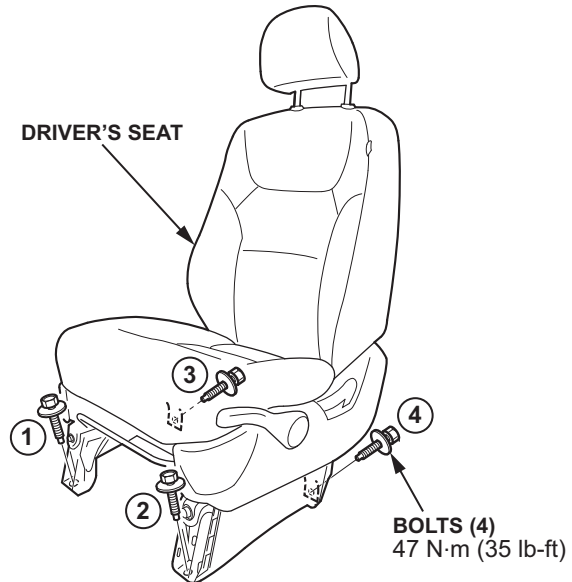

16. Reinstall the driver's door sill trim.

17. Do the VSA neutral position memorization.

- Park the vehicle on a flat and level surface, with the steering wheel in the straight ahead position.
- With the ignition switch in LOCK (0), connect the HDS to the data link connector (DLC) under the driver's side of the dashboard.
- Turn the ignition switch to ON (II).
- Select **ABS/TCS/VSA** with the HDS.



- Select **Neutral Test**.



- Select **All Sensors**, and follow the screen prompts.



18. Do the power window control unit reset procedure.

- Using the HDS, select **BODY ELECTRICAL** from the System Selection menu.
- From the BODY ELECTRICAL SYSTEM SELECT menu, select **Power Windows**.
- From the MODE menu, select **Adjustments**.
- From the ADJUSTMENT menu, select **WINDOW PRESET** for driver's side window.
- Follow the prompts on the screen.
- Confirm that the power window control unit is reset by using the driver's window AUTO UP and AUTO DOWN function.

19. Re-enter the audio and navigation (if equipped) anti-theft codes.