



6555 Katella Avenue • Cypress • California • 90630-5101 • (714) 761-7300 • Fax (714) 229-7944

March 11, 2013

US Mail and E-mail
Chief Administrator
National Highway Traffic Safety Administration
Associate Administrator for Safety Assurance (NVS-215)
1200 New Jersey Avenue SE, W46-421
Washington, DC 20590

Regarding: 13V-035

Dear Sir/Madam:

First, we thank the Agency for their review and approval of our proposed owner's notification. Enclosed please find hard copies of the Technical Bulletin issued to our dealers as well as the approved owner's letter. All Yamaha motorcycle and scooter dealers will receive a copy of this Technical Bulletin. To facilitate repairs, dealer's invoiced affected products under this recall receive an additional bulletin with a print-out of the affected VIN's for the units they have received. The mailing of both the dealer bulletin and owner's notification letter was completed approximately 02/27/13, so your assumption is correct as to the timing of our quarterly reports.

The determination date for this campaign was January 30, 2013. The starting production period for the affected vehicles (YW125) was July, 2008, ending April, 2009. As this campaign is international in scope we could only provide in our initial report an estimate of affected vehicles in the U.S. We are now obviously in a position to provide the accurate range. The Technical Bulletin provides the final VIN ranges by model with a total of 8,664 vehicles in the U.S. For TREAD purposes obviously it goes without saying similar campaigns are being conducted in other jurisdictions.

In the event I can provide further information or answer any questions, please do not hesitate to contact me. My direct telephone number is 714-761-7842. The fax number is 714-229-7944. My email is brad_franklin@yamaha-motor.com.

Sincerely,

A handwritten signature in black ink, appearing to read "Bradley Franklin", written over a white background.

Bradley Franklin
Manager, Government Relations

BRF/lf

cc: By Fed Ex and E-mail
Defects & Recall Information Analysis Division
Mrs. Kelly Schuler (via email)
Mr. Robert Young (via email)

Technicco BULLETIN

©2013 YAMAHA MOTOR CORPORATION, U.S.A.

SAFETY RECALL

This modification has top priority. This bulletin must be performed immediately to ensure customer safety.

NOTE: Bulletins that announce a recall will have an "R" at the end of the bulletin number.

2009 YW125Y (Zuma 125) MODELS FACTORY MODIFICATION CAMPAIGN – Fuel Pump



INTRODUCTION

Yamaha Motor Corporation, U.S.A. has decided that a defect which relates to motor vehicle safety exists on all 2009 YW125Y (Zuma 125) model scooters. In affected scooters, there may be improper clearance in internal fuel pump components that causes an inadequate supply of fuel. This limited fuel supply could cause performance problems and hard starting or, in the worst case, engine stalling, resulting in the possibility of a crash with injury or death.

To correct this problem, Yamaha is initiating a Factory Modification Campaign. Affected units must have a new improved fuel pump installed.

Yamaha is notifying all registered owners of affected scooters by mail. A copy of this letter is included in this bulletin. The customer should take this letter along with the affected scooter to an authorized Yamaha dealer for modification.

A computer report listing all affected scooters invoiced to your dealership is included with this bulletin. Use the list to help ensure all scooters are modified. All sold scooters that have been registered with Yamaha will show the customer's name and address. Your dealership must notify the owner of any affected scooter that was actually sold but listed as "unsold" in the report.

You must modify all affected scooters in your inventory as well as all customer-owned scooters brought to you for this service. Any affected scooter that you purchase from Yamaha in the future may also require modification. If you purchase a scooter from another dealer or Yamaha, check to see if the procedures in this bulletin have already been performed before you sell the scooter.

Scooters that are affected should not be operated until they are modified. It is a violation of Yamaha policy for your dealership to deliver any affected scooter to customers until the procedures in this bulletin are performed.

When the modification on each scooter is performed, follow the Warranty information section of this bulletin to receive reimbursement. Be sure to use the Factory Modification Campaign procedures in Chapter 7 of the

Warranty and Y.E.S. Handbook (LIT-11760-00-08).

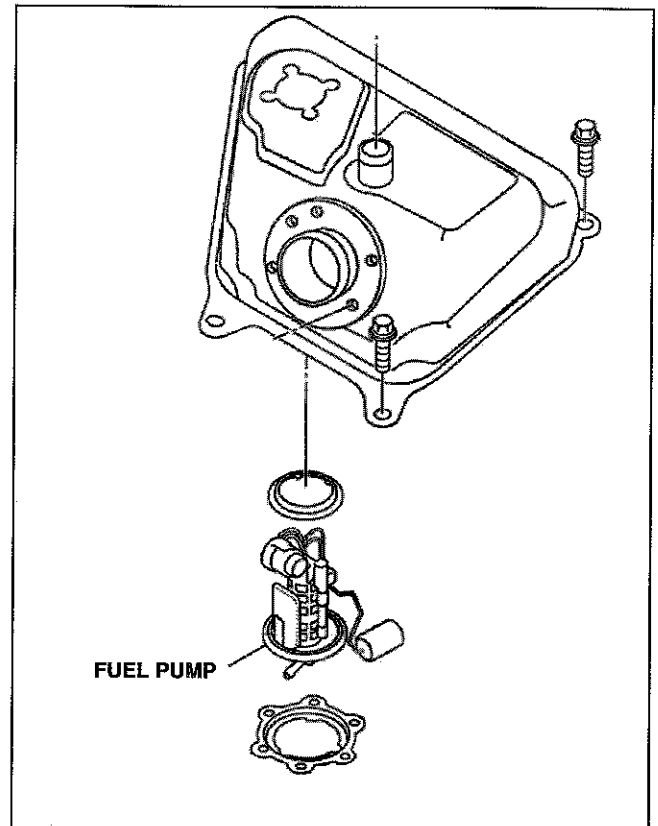



DEALER ACTION SUMMARY

Unsold

Units: Install the new fuel pump and sealing O-ring on all affected units during setup before adding fuel to the fuel tank.

Sold

Units: Install the new fuel pump and sealing O-ring on all affected units even if the fuel pump appears to be operating properly. Check first to be sure the modification has not already been performed (see Identification Procedure in this bulletin for more information).

Parts: Yes, order the appropriate new fuel pump kit for each affected unit.

Warranty: Factory Modification Campaign. See the Warranty Information section of this bulletin. This modification applies to all affected units regardless of ownership or warranty status.

Notify

Customers: Yes. You must immediately contact any customer whose scooter shows as unregistered on the enclosed report. Yamaha has sent letters to customers whose scooters were registered with state departments of motor vehicles as of 2/14/13



AFFECTED RANGE

All 2009 YW125Y
SE48Y-0000101~0008800



SERVICE PROCEDURES

⚠ WARNING

Gasoline is flammable. Use a rag to absorb any fuel leaks from the fuel pump or fuel tank during and after removal. Properly dispose of any fuel-soaked rag. Perform this procedure away from any sparks, flames, or other sources of ignition.

Refer to the YW125Y Service Manual LIT-11616-22-71 as needed for service procedures.

1. Disconnect the negative (-) battery terminal.
2. If the unit has been operated or had fuel added, drain the fuel from the tank through the filler neck using a suitable pump.
3. Remove "Cover Side 4" by lifting the seat and removing the top screw. Then close the seat and remove the lower screw (see adjacent photos).

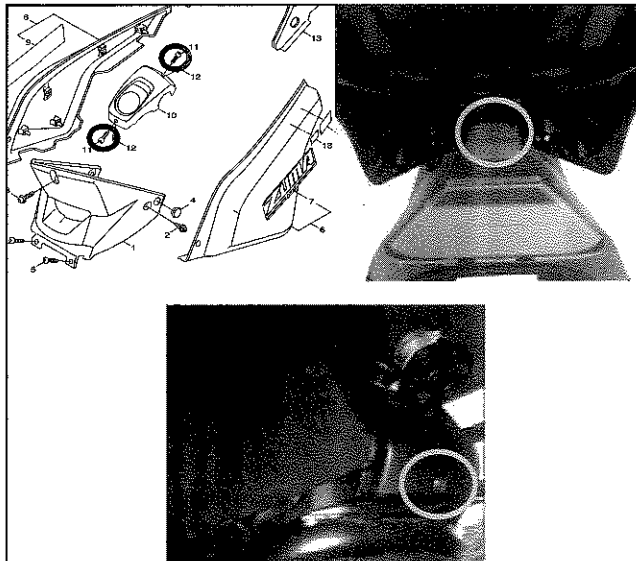

4. Remove the Filler Cap Assembly. Using a long 4mm Allen wrench, remove the three bolts that hold the filler cap assembly to the fuel tank. Remove the filler cap assembly and cover together.

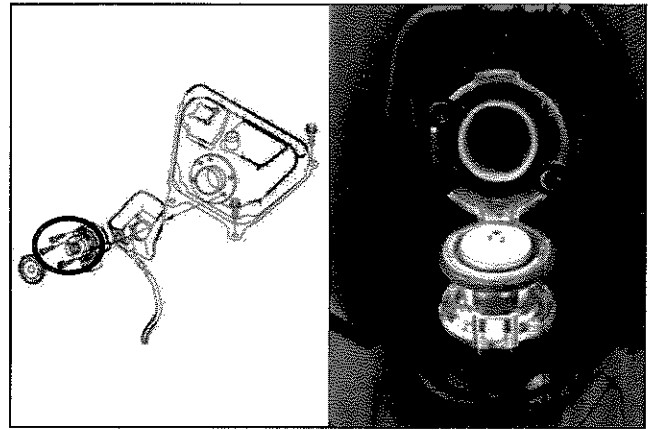

5. Remove the double seat, by lifting it and then removing the two mounting nuts that hold it to the hinge.

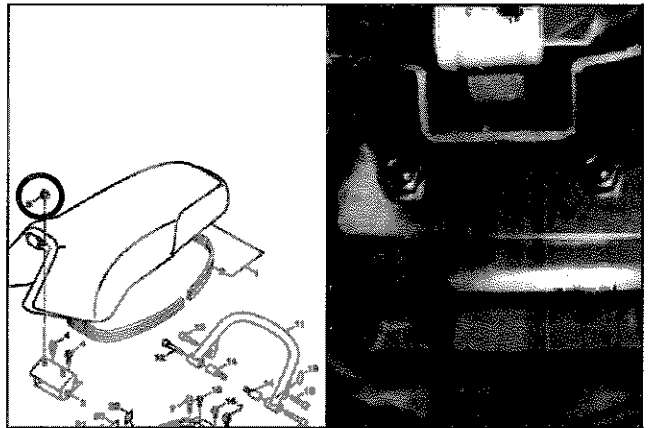

6. Remove the helmet box: The helmet box is fixed with four bolts, two plastic rivets and two self tapping screws.

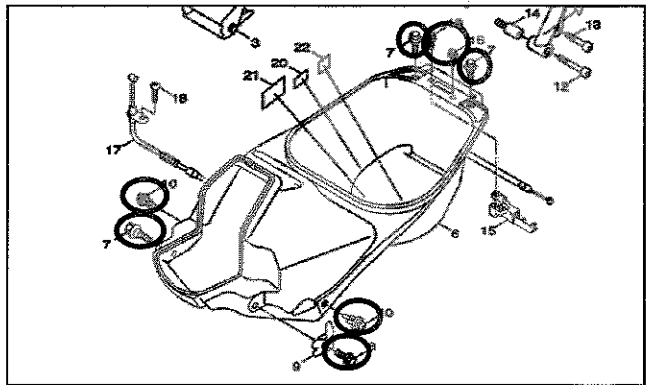

7. Remove (pull off) the left Side Cover held on with three grommets.

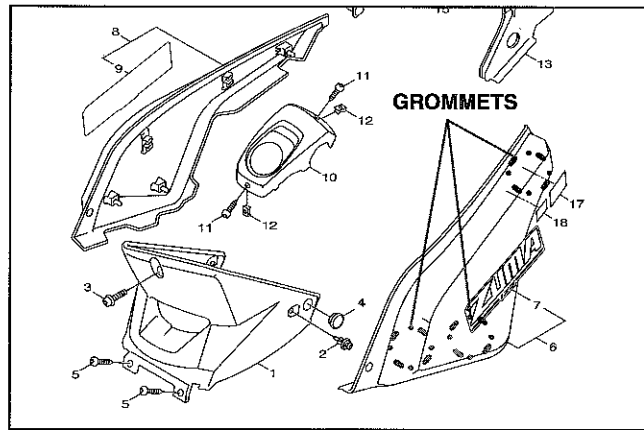

8. Remove the four bolts holding the fuel tank to the frame. Remove the breather hose with its clamp.

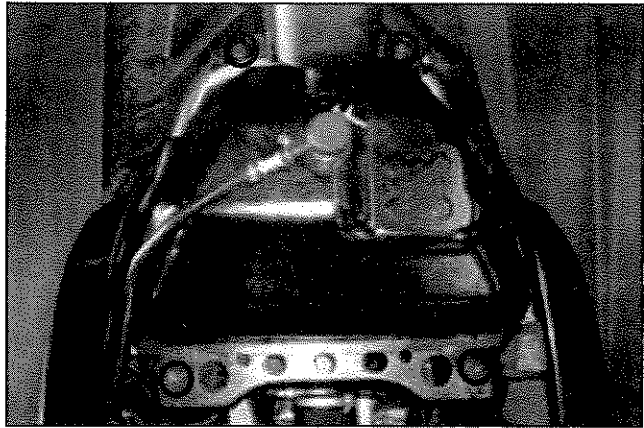

9. Disconnect the fuel hose and coupler from the fuel tank.

⚠ WARNING

Cover fuel hose connections with a cloth when disconnecting them. Residual pressure in the fuel lines could cause fuel to spurt out when removing the hose.

NOTICE:

- Be sure to disconnect the fuel hose by hand. Do not forcefully disconnect the hose with tools.
- Although the fuel has been removed from the fuel tank be careful when removing the fuel hose, since there may be fuel remaining in it.
- Do not disconnect the fuel hose from the fuel hose connector. Disconnect the connector from the fuel pump.

TIP:

- Before removing the hose, place a few rags in the area under where it will be removed.
- Slide the fuel hose connector cover (1) in the direction of the arrow shown [A], press the two buttons (2) on the sides of the connector, and then remove the hose by pulling back [B].

10. Remove the fuel tank assembly.

TIP:

Do not set the fuel tank down so that the installation surface of the fuel pump is directly under the tank. Be sure to lean the fuel tank in an upright position.

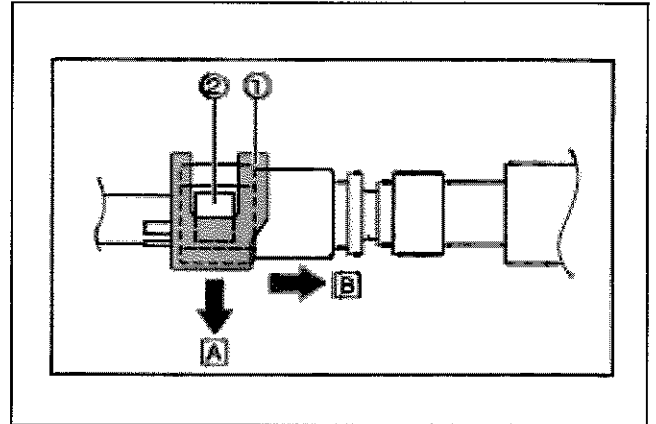

- 11. Remove the fuel pump assembly after removing the six bolts.
- 12. Install the new O-ring on the new fuel pump assembly with its flat surface facing towards the fuel tank. Engage the O-ring tabs into the fuel pump body recesses.

NOTICE:

Do not drop the fuel pump or give it a strong shock. Do not touch the base section of the fuel sender.

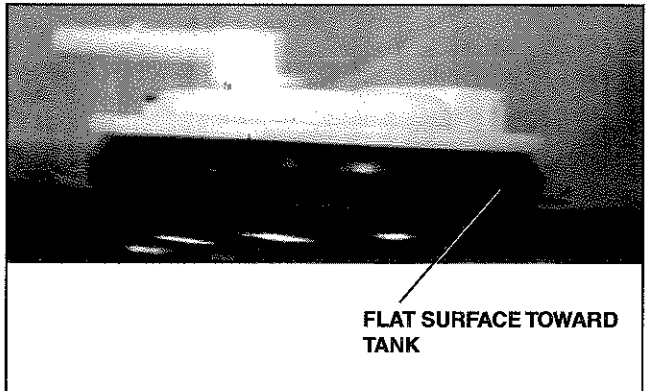
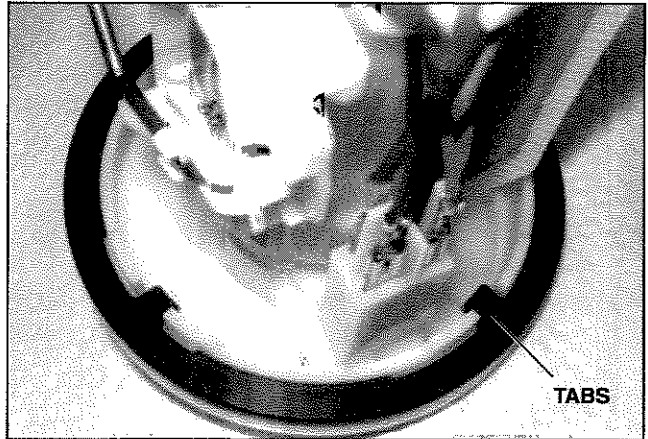
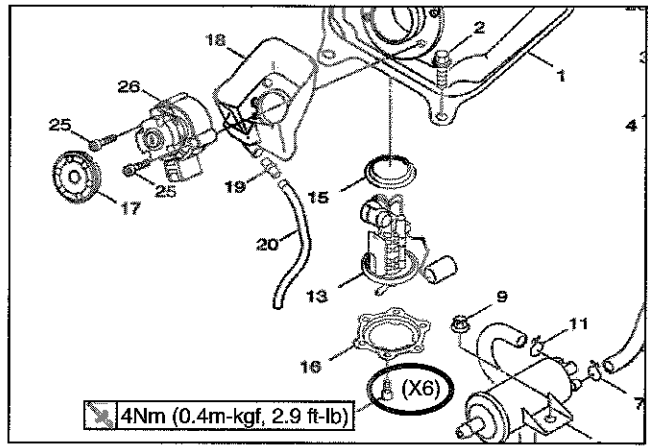

13. Install the new fuel pump assembly.

TIP:

- Do not damage the installation surface of the fuel tank when installing the fuel pump.
- Always use a new fuel pump gasket (O-ring).
- Align the projection (a) on the fuel pump with the alignment mark (b) on the fuel tank. [A] Forward
- Tighten the fuel pump bolts and torque them in two stages.

Fuel pump bolts:

4 Nm (0.4 m-kgf, 2.9 ft-lbf)

14. Reconnect the fuel hose and fuel pump coupler.

15. For installation of the fuel tank and covers, reverse the removal procedure.

16. When the service procedure is completed, put a punch mark above the VIN number as indicated in the Identification Procedure below.

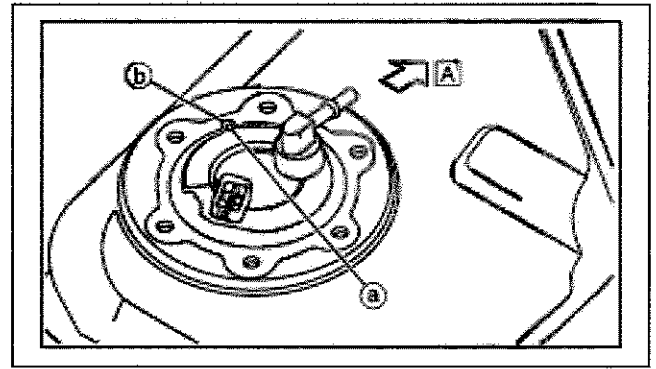

IDENTIFICATION PROCEDURE

After modifying a unit, make a punch mark above the Vehicle Identification Number (VIN) as shown in the adjacent illustration. Check for this punch mark if you encounter an unfamiliar unit. You can also check unit status on YDS or by contacting your Regional Technical Advisor.

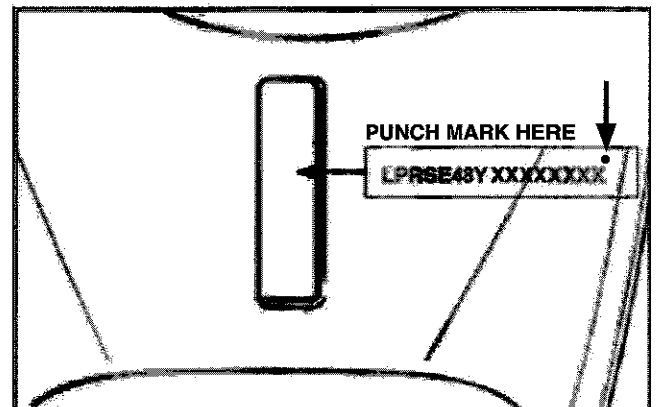

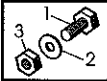

PARTS INFORMATION

For each affected unit, order a Fuel Pump Kit.

Part Number	Description	Qty.	Dealer Cost
90891-10235-00	YW125 Fuel Pump Kit (1) Fuel Pump Assy (2) O-Ring	1	\$85.35

TIP:

The Fuel Pump Assembly is superseded:

Old Part Number	New Part Number
5S9-E3907-00-00	5S9-E3907-10-00

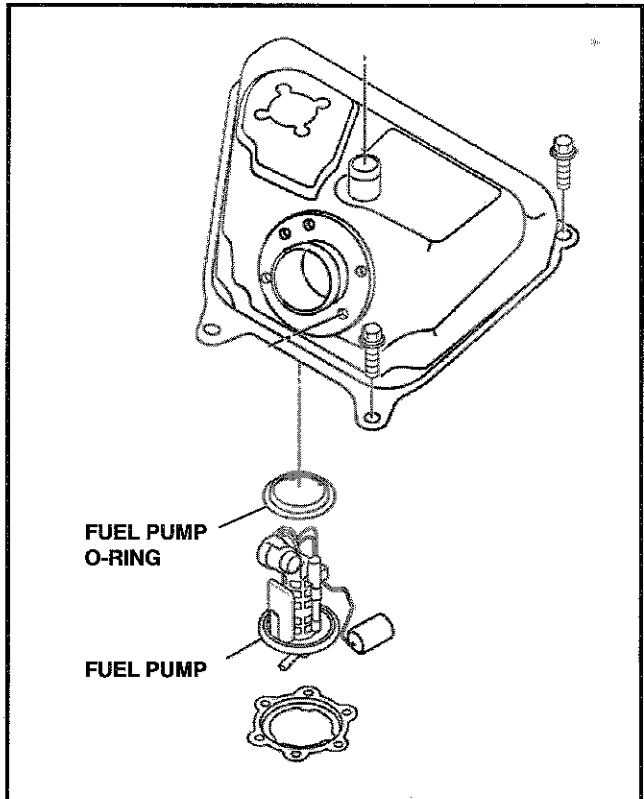

Part Identification:

1. New fuel pump has no paint on "<POM>."

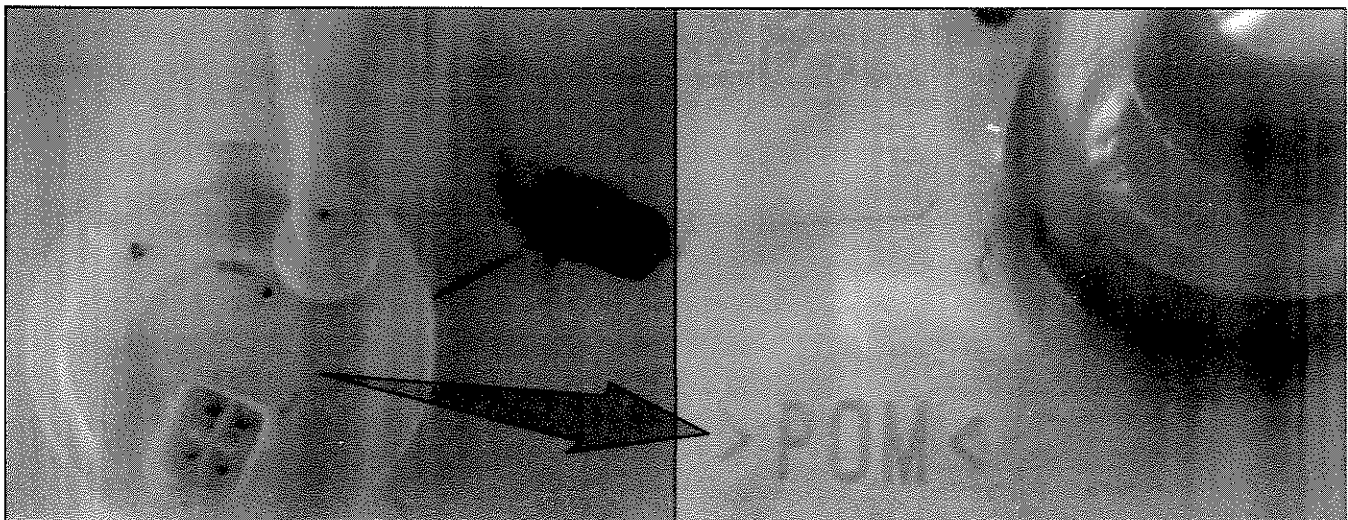

2. Fuel pump body color has been changed from black to brown.

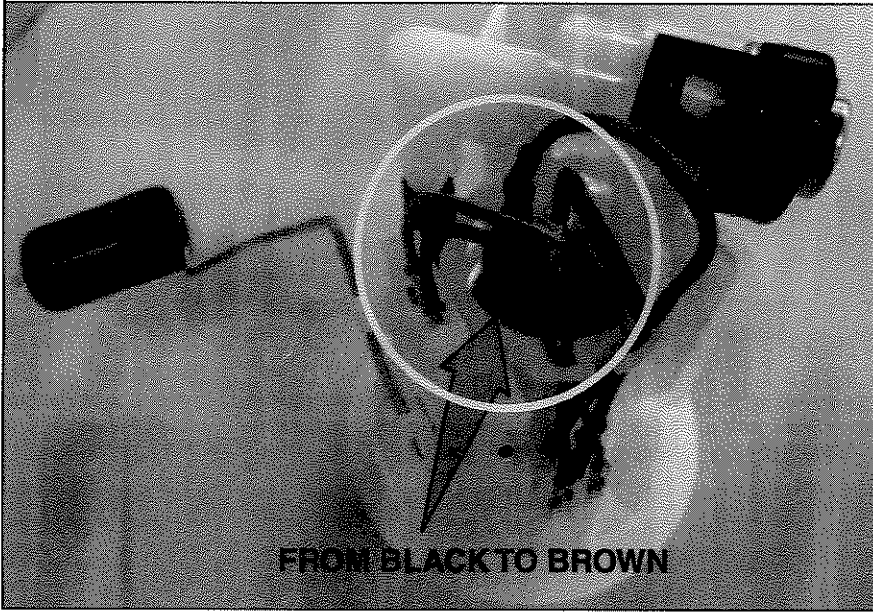

WARRANTY INFORMATION

The owner of each registered unit will receive a letter announcing this campaign. The customer's letter includes the Primary ID and Recall Number.

The modification is authorized for all scooters, both sold and unsold, regardless of ownership or warranty status. You do not need the customer's letter to perform the modification or to file for reimbursement.

Submit a Recall Request for the parts and labor as described below using Recall Number **990069**. The labor allowance is **1.0 hour**.

YDS:

When signed on to YDS, click on the Service Tab, and then "Recall Request-Add." This function will allow you to enter multiple Primary IDs for the same recall. Remember that YDS requires a 7-digit serial number, so use a "0" as the first digit. The system will check your submission instantly to make sure the Primary ID numbers you've entered are valid for the recall. You can check back the next day for your claim numbers to track your credit.

MAIL:

Complete a recall Reimbursement Request (LIT-11790-00-03) as shown below:

Dealer Number	<input style="width: 100%;" type="text"/>	Dealer Name	<input style="width: 100%;" type="text"/>
RECALL NUMBER	Primary I.D.	Date Completed	Status
9 9 0 0 6 9	S E 4 8 Y - 0 0 0 0 X X X	0 2 - 2 7 - 2 0 1 3	M I
<input style="width: 100%;" type="text"/>	<input style="width: 100%;" type="text"/>	<input style="width: 100%;" type="text"/>	<input style="width: 100%;" type="text"/>

If you have any questions about proper procedures for Factory Modification Campaigns, see Chapter 7 in your **Warranty and Y.E.S. Handbook** (LIT-11760-00-08).



YAMAHA MOTOR CORPORATION, U.S.A.
 6555 KATELLA AVENUE, CYPRESS, CALIFORNIA 90630-5101 800-962-7926

IMPORTANT SAFETY RECALL NOTICE

February 22, 2013

Dear Yamaha Owner:

This notice is sent to you in accordance with the requirements of the National Traffic and Motor Vehicle Safety Act. Yamaha Motor Corporation, U.S.A. has decided that a defect which relates to motor vehicle safety exists in all 2009 YW125 (Zuma 125) model scooters. Our records show that you own the affected scooter shown above.

The reason for this recall: In affected scooters, there may be improper clearance in internal fuel pump components that causes an inadequate supply of fuel. This limited fuel supply could cause performance problems and hard starting or, in the worst case, engine stalling, resulting in the possibility of a crash with injury or death.

What Yamaha and your dealer will do: To correct this defect, your authorized Yamaha dealer will install an improved fuel pump assembly. **There will be no charge to you for this procedure.** Installing the new parts takes about 1 hour, although your dealer may need to keep your scooter longer depending upon their schedule.

What you should do now: Please call your Yamaha dealer to make a service appointment to have this procedure performed. At that same time, you can find out how long they expect to keep your scooter for this service. Remember to take this letter with you when you take in your scooter. **You should not ride your scooter until this modification is performed.**

If you are unable to return to the Yamaha dealer who sold you the scooter, this service will be performed by any authorized Yamaha scooter dealer. For the name of a dealer near you, call 1-800-88-YAMAHA or visit the Yamaha web site at: www.yamaha-motor.com.

If you have had this repair performed before you received this letter, you may be entitled to receive reimbursement for the cost of obtaining a pre-notification remedy of the problem associated with this repair. For more information, contact Yamaha Customer Relations at 1-800-962-7926.

Federal regulations require that any vehicle lessor receiving this recall notice must forward a copy of this notice to the lessee within 10 days.

If you need help: If, after contacting your dealership, you have questions or concerns which the dealership is unable to answer, please write to:

Yamaha Motor Corporation, U.S.A.
 Customer Relations Department
 P.O. Box 6555
 Cypress CA 90630
 or call 1-800-962-7926.

If, after contacting Yamaha Customer Relations, you are still not satisfied that we have done our best to remedy the situation without charge and within a reasonable time, you may submit a written complaint to the Administrator, National Highway Traffic Safety Administration, 1200 New Jersey Avenue, SE., Washington, DC 20590; or call the Auto Safety Hotline at 1-888-327-4236 (TTY: 1-800-424-9153); or go to <http://www.safercar.gov>.

If you no longer own this Yamaha: If you have sold your scooter to another party, please call us toll-free at 1-800-962-7926 with the name and address of the new owner, along with the serial number shown to the right of your name and address above.

We're sorry to cause you any inconvenience, but we are sincerely concerned about your safety and continued satisfaction with our products. Thank you for giving your attention to this important matter.

Sincerely,
 Customer Support Group
 Yamaha Motor Corporation, U.S.A.