

TECHNICAL INSTRUCTIONS

FOR

13V-030

SAFETY RECALL DLA

FRONT WIPER ARM NUTS

CERTAIN

2006 – EARLY 2012 MODEL YEAR IS250, IS350

2008 – 2011 MODEL YEAR IS F

2010 – EARLY 2012 MODEL YEAR IS 250C, IS350C

Updated October 7, 2013

- The wiper arm serration removal procedure has been updated for the new SST.
(SECTION VI)

I. OPERATION FLOW CHART

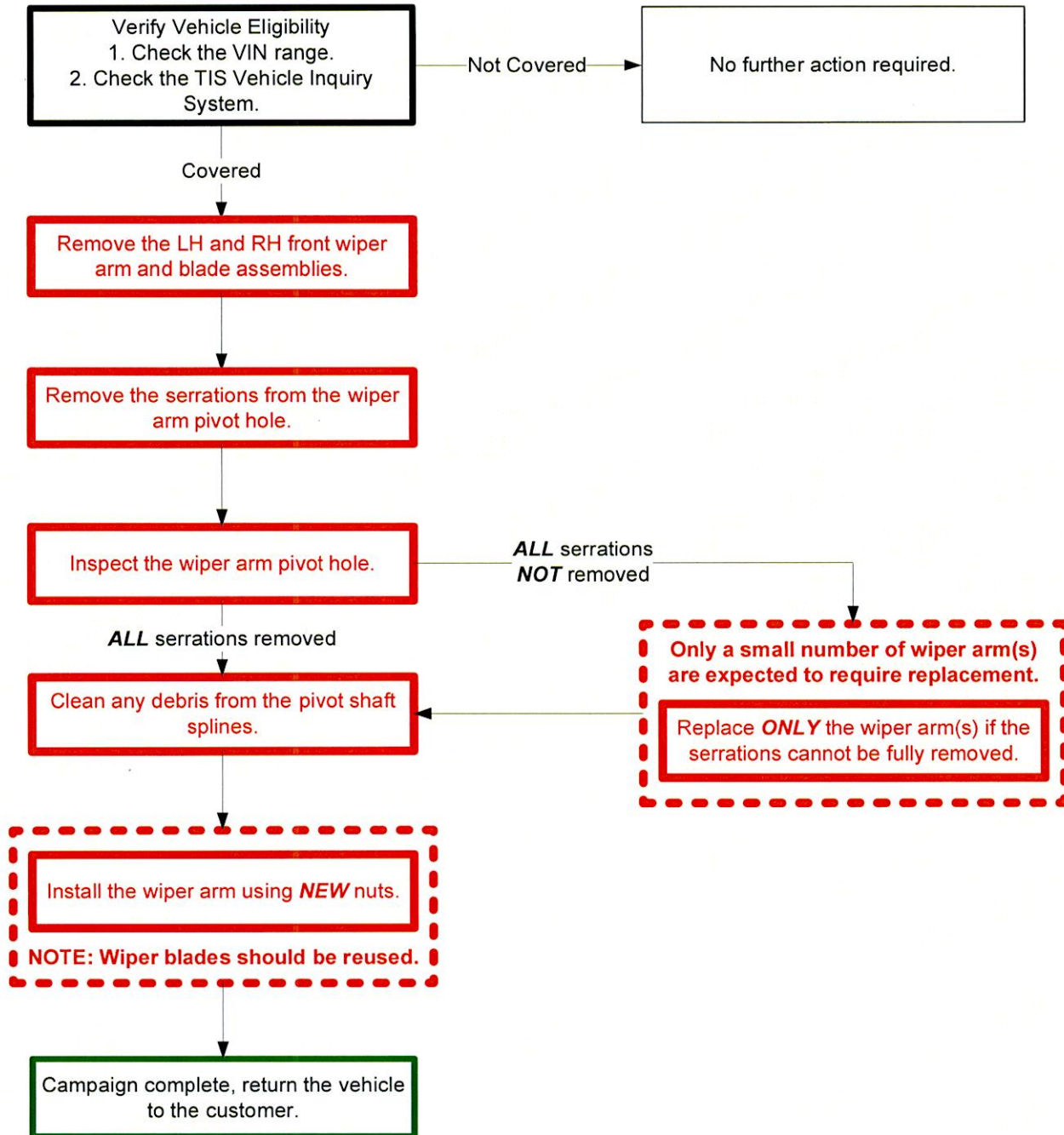

II. IDENTIFICATION OF AFFECTED VEHICLES

A. COVERED VIN RANGE

Model	WMI	Year	VIN Range		Model	WMI	Year	VIN Range	
			VDS	Range				VDS	Range
IS250	JTH	2006	BK262	2000010-2021611	IS250C	JTH	2010	FF2C2	2500062-2514637
				5000018-5025772			2011	FF2C2	2514638-2521290
		2007	BK262	2021159-2058542			2012	FF2C2	2520985-2522268
				5025773-5050845	IS350	JTH	2006	BE262	2000000-2007084
		2008	BK262	2057792-2082748					5000018-5011869
				5050849-5086447			2007	BE262	2006942-2013016
		2009	BK262	2081667-2094281					5011870-5017246
				5086449-5107246			2008	BE262	2011547-2016302
		2010	BF5C2	2094264-2100284					5017247-5021818
				5107249-5129060			2009	BE262	2016235-2017388
		2011	BF5C2	2100247-2101920					5021000-5023468
				5129064-5152530			2010	BE5C2	2017389-2017712
		2012	BF5C2	2101792-2102727					5023469-5025230
							2011	BE5C2	5024742-5027957
IS250 AWD	JTH	2006	CK262	2000003-2008675	IS350 AWD	JTH	2011	CE5C2	5000104-5001879
				5000013-5007908	IS350C	JTH	2010	FE2C2	2500025-2505028
		2007	CK262	2008542-2019897			2011	FE2C2	2504989-2507138
				5007909-5015612			2012	FE2C2	2507139-2507504
		2008	CK262	2019898-2027723	IS F	JTH	2008	BP262	5000156-5004828
				5015613-5027611			2009	BP262	5002981-5006738
		2009	CK262	2027724-2032532			2010	BP5C2	5006743-5008082
				5027613-5036006			2011	BP5C2	5008017-5009599
		2010	CF5C2	2032534-2034898					
				5036007-5044700					
		2011	CF5C2	2034395-2035500					
				5044623-5051264					
		2012	CF5C2	2035323-2035942					

NOTE:

- Check the TIS Vehicle Inquiry System to confirm the VIN is involved in this Safety Recall, and that the campaign has not already been completed prior to dealer shipment or by another dealer.
- TMS warranty will not reimburse dealers for repairs conducted on vehicles that are not affected or were completed by another dealer.

III. PREPARATION

A. PARTS

The large majority of vehicle will only require the nut kit.

Model	Part Number	Part Description	Quantity
All	04002-64153	Front Wiper Nut Kit*	1
*The kit above includes the following part.			
-	90182-10006	Nut (for front wiper arm)	2

Only a small number of vehicles will require the replacement of the wiper arm(s). Follow these instructions to determine if replacement is necessary. If it is identified that a wiper arm requires replacement, follow the MAC process outlined in the dealer letter for parts ordering. Parts will be placed on recovery and subject to claim debit for inappropriate replacement.

Model	Part Number	Part Description	Quantity
IS250, IS350	85211-53080	Arm, FR Wiper, RH	1
IS250C, IS350C	85221-53080	Arm, FR Wiper, LH	1
IS F	85211-53070	Arm, FR Wiper, RH	1
	85221-53070	Arm, FR Wiper, LH	1

B. TOOLS & EQUIPMENT

- Standard hand tools
- Torque wrench
- Wire brush
- Black marker

Safety Recall Tools – These tools are provided to the dealership.

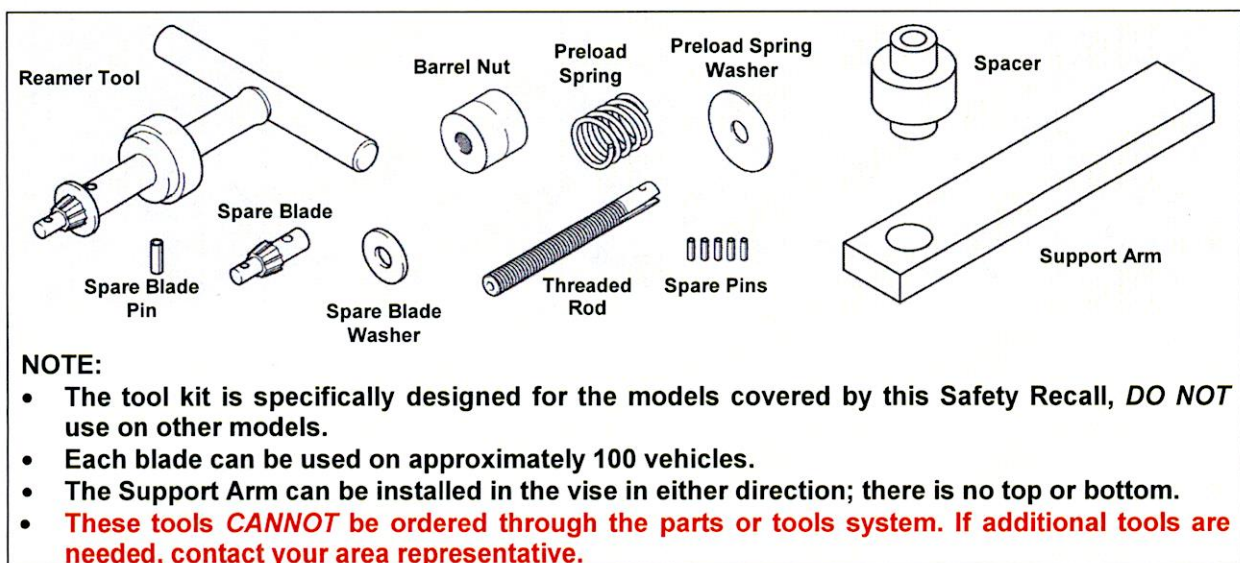

Tool Assembly

The tool will come partially assembled and will require you to install the threaded rod onto the tip of the reamer blade as shown below.

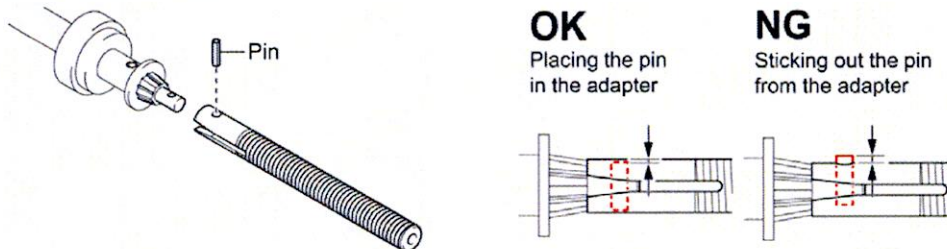

When installing the roll pin, ensure the pin is fully seated and is not protruding. If not fully seated, the pin will make contact with the wiper arm pivot hole and the reamer cannot be installed properly.

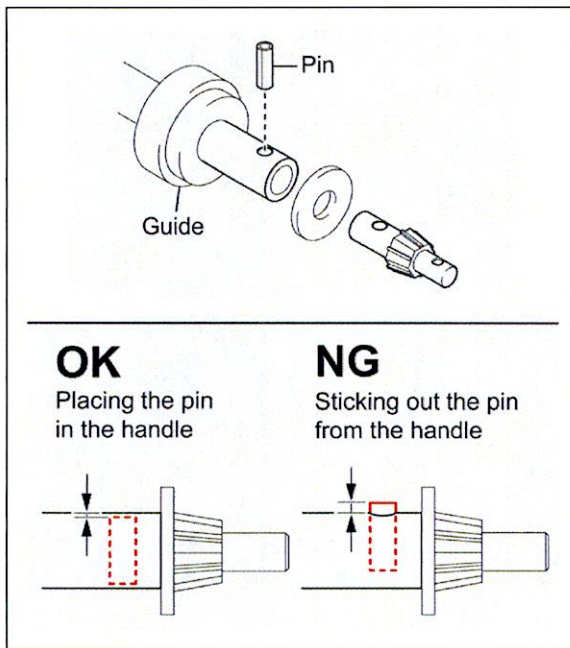

Reamer Blade Replacement

1. Using a 3mm punch remove the roll pin from both the threaded rod and blade (2 pins)
2. Remove the threaded rod from the blade and remove the old blade and washer from the T-handle.



DO NOT hold the blade with bare hands. Doing so may cause injury.

3. Install the washer and NEW blade by pressing the blade toward the T-handle and lining up the pin holes.
4. Using a 3mm punch install the NEW roll pin. Ensure that it is fully installed. The pin should be flush with the T-handle shaft.
5. Using a 3mm punch install the threaded rod onto the new blade. Ensure the pin is flush with the threaded rod as shown.

IV. BACKGROUND

Each wiper arm is installed onto a pivot shaft, which is linked to the wiper motor mechanism, by an installation nut (wiper arm nut). The wiper arm nut may not have been tightened sufficiently due to high friction between the nut and the wiper arm. Under certain usage conditions, such as a buildup of heavy snow on the windshield, one or both of the wipers could become inoperative. Inoperative wiper arms could reduce driver visibility and increase the risk of a crash.

V. COMPONENTS

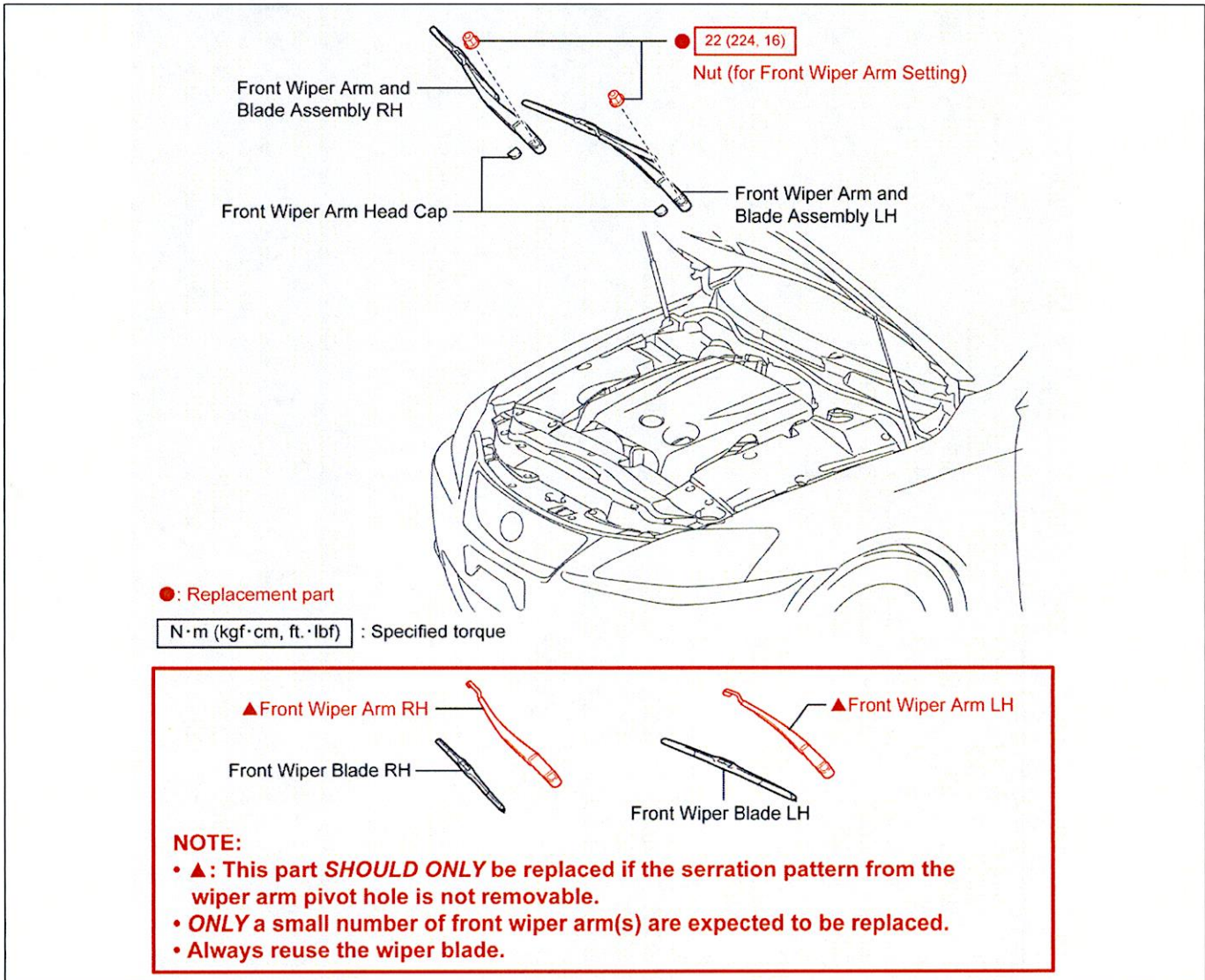

VI. WORK PROCEDURE

1. REMOVE BOTH FRONT WIPER ARM ASSEMBLIES AS OUTLINED IN THE REPAIR MANUAL ON TIS
[Wiper Arm Removal](#)



Store the removed nuts in a separate location as they are not to be reused. **NEW** nuts must be used.

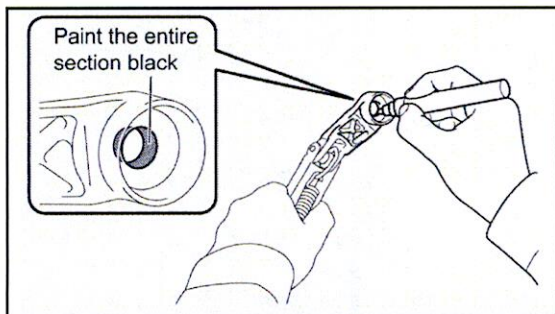

2. PAINT OUT THE SERRATION PATTERN

a) Use a black marker to color in the entire wiper arm pivot hole. Confirm there are no gaps before proceeding.

NOTE: The coloring is critical in the next steps when determining the condition of the wiper arms.

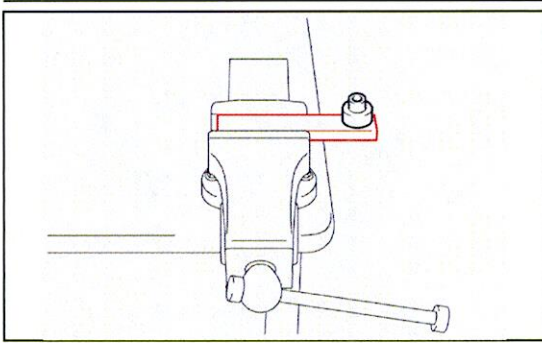

3. SECURE THE WIPER ARM SUPPORT STAND

- Secure the wiper support arm stand firmly in the vise as shown in the illustration.
- Place the spacer on top of the support arm as shown.

NOTE: Be sure to secure the stand firmly so that it does not move.

4. REMOVE THE SERRATION PATTERN FROM THE WIPER ARM PIVOT HOLE

- Set the wiper arm onto the spacer of the support arm.
- Insert the reamer into the wiper arm pivot hole and set the guide.

NOTE: Clean the attachment if it is dirty or contaminated with debris.

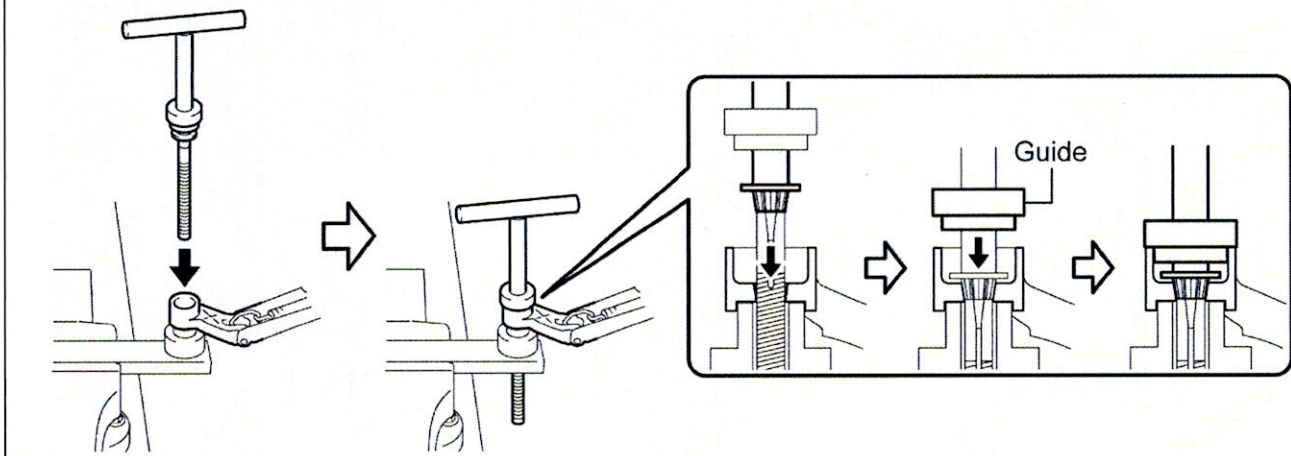

- Install the washer, preload spring and barrel nut onto the threaded shaft.
- Tighten the barrel nut by hand until it makes contact with the washer.
- Loosen the nut approximately 90°



DO NOT tighten the barrel nut any further after it has made contact with the washer. Excessive tightening of the barrel nut will apply a force more than necessary to the reamer and wiper arm, which could result in damage to the reamer tool or the wiper arm.

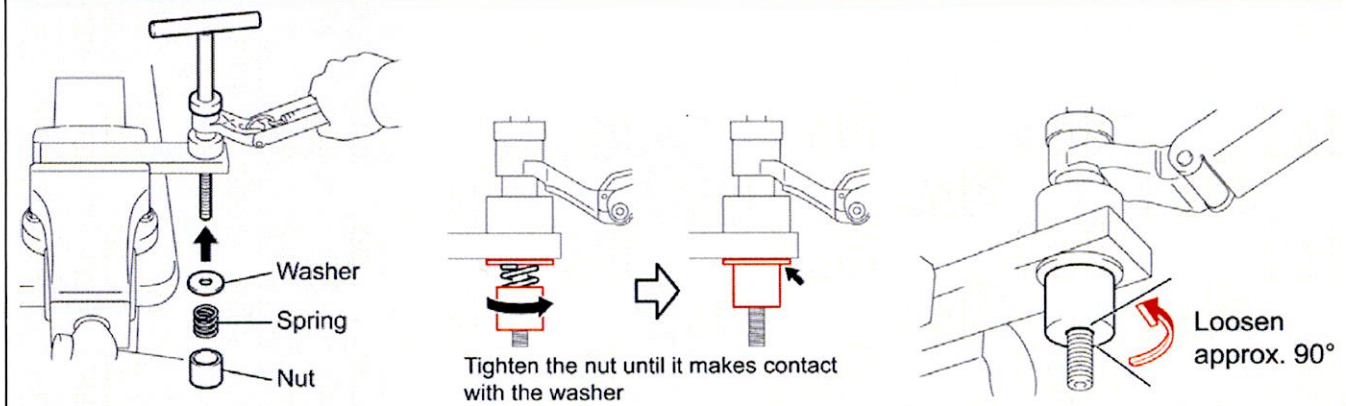

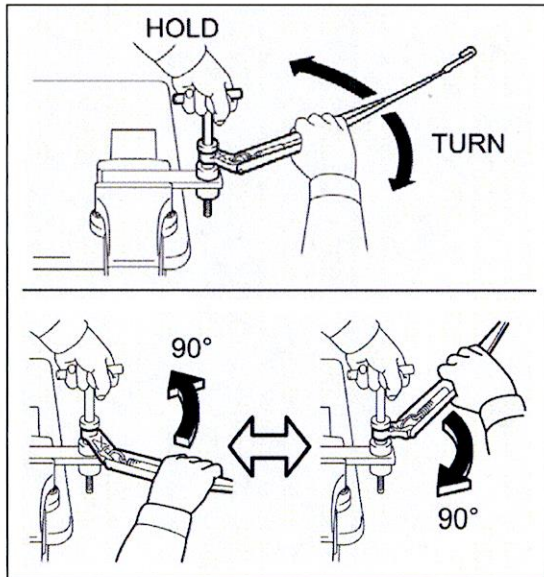

- f) While holding the reamer stationary, turn the wiper arm as shown approximately 20 times or until there is no more resistance.



NOTE:

- There is no need to apply a downward force to the reamer by hand, the reamer is already applying downward force by the spring. The wiper arm can be turned in either direction.
 - To remove the serration pattern effectively, turn the wiper arm 90° clockwise, followed by 90° counter clockwise. (this equals one time.)
- g) Tighten the nut again until it makes contact with the washer, and then loosen it 90°.
- h) Repeat steps f) and g) until it feels like no more metal can be removed from the pivot hole when twisting the wiper arm.



- **DO NOT** apply any kind of oil on the blade or the wiper arm. It may create difficulties in removing the serration pattern.
- **DO NOT** support the wiper arm by the wiper blade.
- The reamer guide **MUST** be in place to prevent excessive side-to-side movement of the reamer.
- The reamer has a stopper that controls the correct reaming correction limit.

- i) Remove the reamer.
- j) Check the wiper arm pivot hole and determine the condition using the table below.

		OK	NG
Condition Example	Action Required		
		ALL coloring and ALL serrations have been removed.	ALL coloring and ALL serrations HAVE NOT been removed.
OK		1. Proceed to step 4. CLEAN THE WIPER COMPONENTS	NG

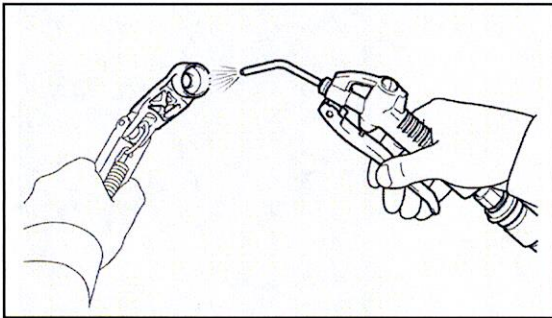

5. CLEAN THE WIPER COMPONENTS

- Use an air gun to remove any debris from the pivot hole and wiper arm.

NOTE: Wear protective goggles.

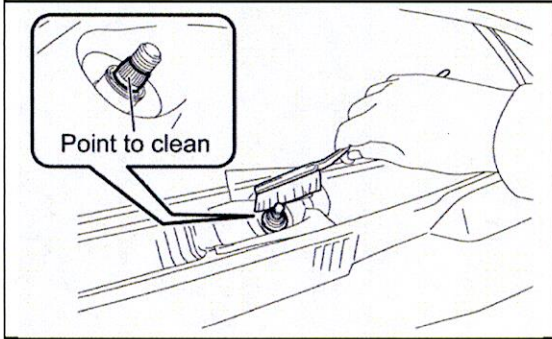

- Protect the cowl around the pivot shafts with tape or shop cloth.
- Using a wire brush, clean the splines of the pivot shafts to prevent wiper arm slippage.
- Use an air gun to remove any debris from the pivot shafts and surrounding area.

NOTE: Wear protective goggles.



The splines **MUST** be cleaned to prevent wiper arm slippage.

OK

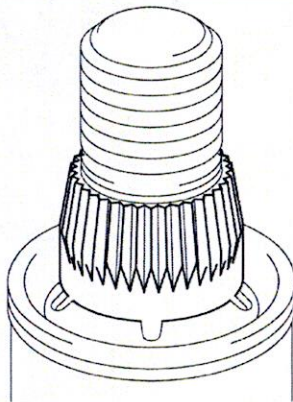

NG

Adhesion of
foreign
substances

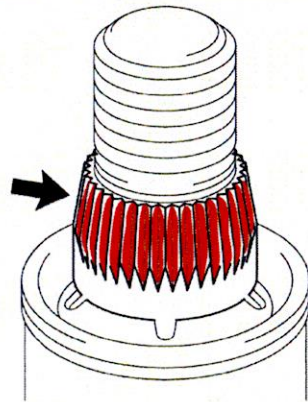

6. INSTALL THE WIPER ARM AND BLADE ASSEMBLY

- Install the wiper arm with a **NEW** wiper arm nut as outlined in the repair manual on TIS.

[Wiper Arm Installation](#)

Torque: 16ft. lbf (22N·m)



NEW wiper arm nuts **MUST** be used when installing the wiper arm and blade assembly.

◀ VERIFY REPAIR QUALITY ▶

- Confirm sufficient force is applied when using the reamer
- Confirm the reamer is used multiple times when confirming the condition
- Confirm the pivot shaft splines are cleaned before reinstalling the wiper arms
- Confirm **NEW** wiper arm nuts are used when reinstalling the wiper arms

If you have any questions regarding this update, please contact your area representative.

VII. APPENDIX

A. CAMPAIGN DESIGNATION DECODER

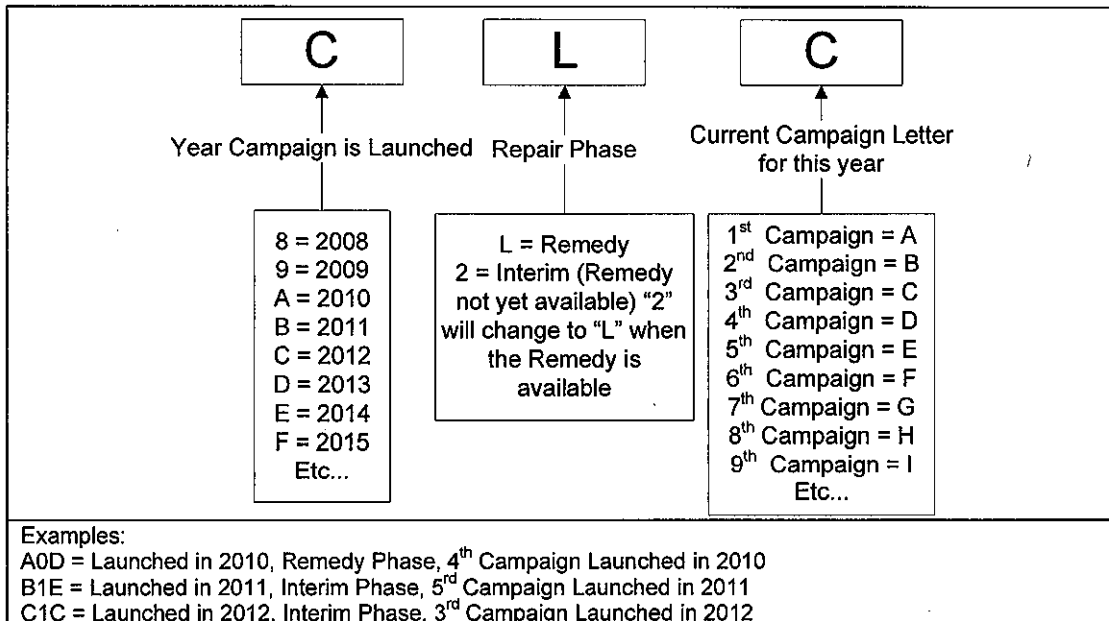

B. CAMPAIGN PARTS DISPOSAL

As required by Federal Regulations, please make sure all campaign parts (original parts) removed from the vehicle are disposed of in a manner in which they will not be reused, ***unless requested for parts recovery return.***