



# Recall Campaign

NHTSA#: 13V-028

TC#: 2013-026

Job Code: 9901109

Flat Rate: 0.25 hrs

**REQUIRES PARTS TO BE ORDERED FROM Entegra for every unit.**

**ACTION REQUIRED:**

Replace wiper arms

**MODELS / UNITS:**

**2011 Class A Motor Homes**

<u>Aspire</u>	40SKT	<b>B13C</b> 8075-8077
	42DL	<b>B13E</b> 8065-8067
<u>Anthem</u>	40DL	<b>B14E</b> 8063
	44SL	<b>B14X</b> 8058

**2012 Class A Motor Homes**

<u>Aspire</u>	40DLQ	<b>C13T</b> 8051-8073
	40DRQ	<b>C13A</b> 8051-8058
	40SKT	<b>C13C</b> 8051-8058
	42DEQ	<b>C13H</b> 8051-8070
	42DLQ	<b>C13L</b> 8051
	42RB	<b>C13G</b> 8051
	42RBQ	<b>C13N</b> 8051-8106

<u>Anthem</u>	42DLQ	<b>C14T</b> 8051-8059
	42RBQ	<b>C14N</b> 8051-8068
	44DLQ	<b>C14D</b> 8051-8052
	44SL	<b>C14X</b> 8051-8057

<u>Cornerstone</u>	45DLQ	<b>C16D</b> 8057-8059
	45RBQ	<b>C16F</b> 8051-8059

**2013 Class A Motor Homes**

<u>Aspire</u>	40DLQ	<b>D13T</b> 8051-8063; 8068
	42DEQ	<b>D13H</b> 8051-8078; 8081-8083; 8088
	42RBQ	<b>D13N</b> 8051-8099; 8102
	44U	<b>D13U</b> 8051

<u>Anthem</u>	42DEQ	<b>D14H</b> 8051-8052
	42DLQ	<b>D14T</b> 8051-8067
	42RBQ	<b>D14N</b> 8051-8094; 8098; 8103
	44DLQ	<b>D14D</b> 8051-8069
	44SL	<b>D14X</b> 8051-8057

<u>Cornerstone</u>	45J	<b>D16J</b> 8051-8060
	45K	<b>D16K</b> 8051-8070

**KIT CONTENTS**

13V-028E

**Note: Kit can only be ordered using the order form included with this bulletin.**

1- wiper kit  
Instruction sheet

**TOOLS/MATERIAL REQ.:**

Torque wrench with 10mm socket  
5mm Allen wrench  
Screwdriver or similar tool

## INSTRUCTIONS

- Using the 10mm socket, remove the nut from the inside wiper mechanism (accessed through the front access door). Remove the (spherical) washer and wiper connection from the end of the wiper link. Repeat on the other end of the link. The nut(s) should be set aside for re-use. Remove the link noting the correct stacking arrangement of the two links for re-assembly.

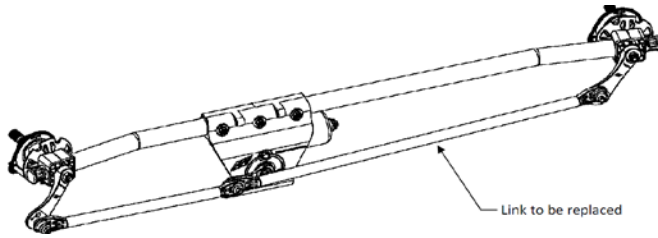

PARTS LIST			
ITEM	QTY	PART #	DESCRIPTION
1	2	416-1003	Spherical Bushing
2	1	307-3473	Link
3	1	414-2054	Spherical Washer
4	2	414-1159	Spherical Flange Nut

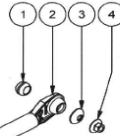

- Place the spherical ball over the lever stud and apply grease (grease packets are supplied with the kit) on top of the spherical ball on the passenger side lever. Grease should also be applied on the motor drive arm pin prior to installing the link back on the motor drive arm.



- Install the new link onto the drive arm pin and the pivot lever pin. Install the spherical washer(s) and the spherical nut(s). Tighten the spherical nut(s) on the center joint and the pivot lever pin to 5-7 foot pounds.



- Disconnect the fluid hose (Fig. 4a). Using a 5mm Allen wrench, loosen the wiper and pull it out away from the spline.



5. Adjust the wiper blade per diagram (Fig. 5a).

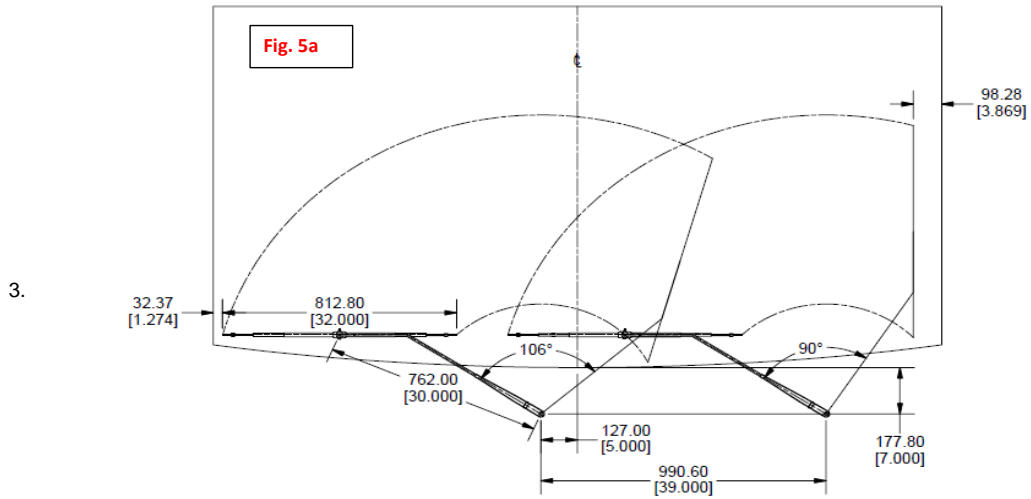

6. Put the wiper arm back into place and tighten to 12 foot-pounds with an Allen wrench. Reconnect the fluid hose bringing it clockwise around the wiper base (this allows for wiper movement).

