



Safety Recall: Steering Column

BACKGROUND

During vehicle assembly, the wrong tilt bracket was installed on the steering column on a small number of vehicles. If an affected vehicle is involved in a crash, the steering column may not absorb the force of the impact as designed.

CUSTOMER NOTIFICATION

Owners of affected vehicles will be sent a notification of this safety recall in December 2012.

Before doing work on a vehicle, verify its eligibility by doing an iN VIN status inquiry.

Some vehicles affected by this campaign may be in your new or used vehicle inventory. As a matter of federal law, these vehicles **must** be repaired before they are sold.

Should your dealership sell an unrepaired vehicle that subsequently causes injury or damage because of the recalled item, the dealership will be solely responsible to the damaged party, and will be required to defend and indemnify American Honda for any resulting claims. To see if a vehicle in inventory is affected by this recall, do a VIN status inquiry before selling it.

CORRECTIVE ACTION

Replace the steering column.

PARTS INFORMATION

Steering Column: P/N 53200-TR0-A02

Break-Away Bolt (two required): P/N 35102-TR0-003

TORX Bolts (two required): P/N 90134-S6A-A80

WARRANTY CLAIM INFORMATION

Operation Number: 510105

Flat Rate Time: 1.6 hours (includes alignment)

Failed Part: P/N 53200-TR0-A02

Defect Code: 5GY00

Symptom Code: S6900

Skill Level: Repair Technician

REPAIR PROCEDURE

1. Remove the steering column. Refer to the online service manual, enter keyword **COLUMN**, and select **Steering Column Removal and Installation**.

2. Remove the two break-away bolts and remove the ignition switch assembly from the original steering column.

Transfer the ignition switch assembly from the old column to the new column.

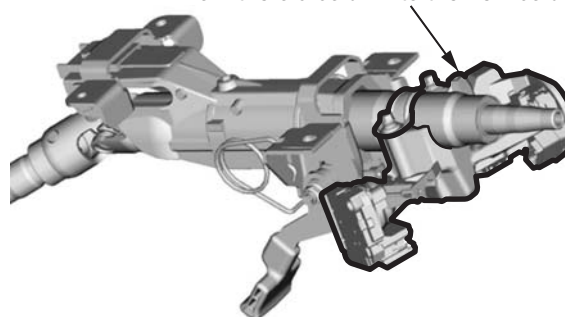

Remove:

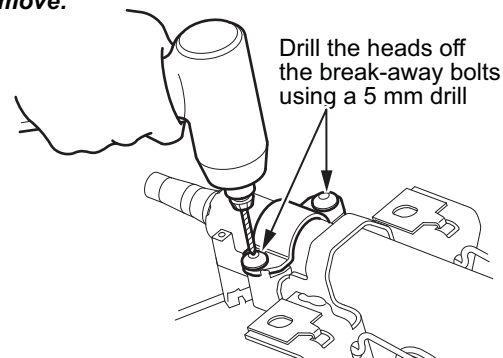

Drill the heads off the break-away bolts using a 5 mm drill

Reinstall:

Tighten the new break-away bolts until the hex heads twist

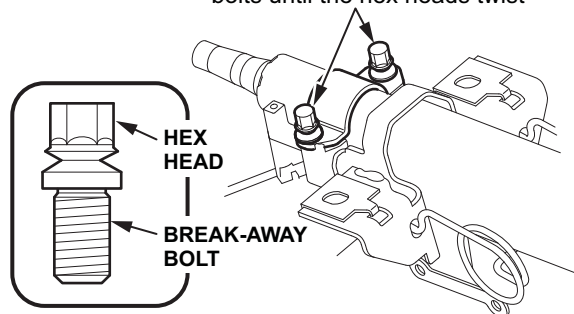

3. Transfer the ignition switch assembly to the new steering column using new break-away bolts.
4. Install the steering column. Refer to the online service manual.

