

CERTAIN 2011 AND 2012 MODEL YEAR FORD F-53 MOTORHOME AND F-59 STRIPPED CHASSIS VEHICLES — TRANSMISSION PRNDL INDICATOR/CABLE AND SHIFT LEVER ARM REPLACEMENT

OVERVIEW

Before demonstrating or delivering any of the vehicles involved in this recall, dealers are to remove and replace both the Transmission PRNDL Indicator/Cable Assembly and Shift Lever Arm.

SERVICE PROCEDURE

Removal

1. Remove the lower steering column trim/knee bolster panel as necessary to gain access to the lower steering column area. Refer to the Coach Builders repair manual for further information if necessary.
2. Detach the PRNDL cable from the shift lever arm. See Figure 1.

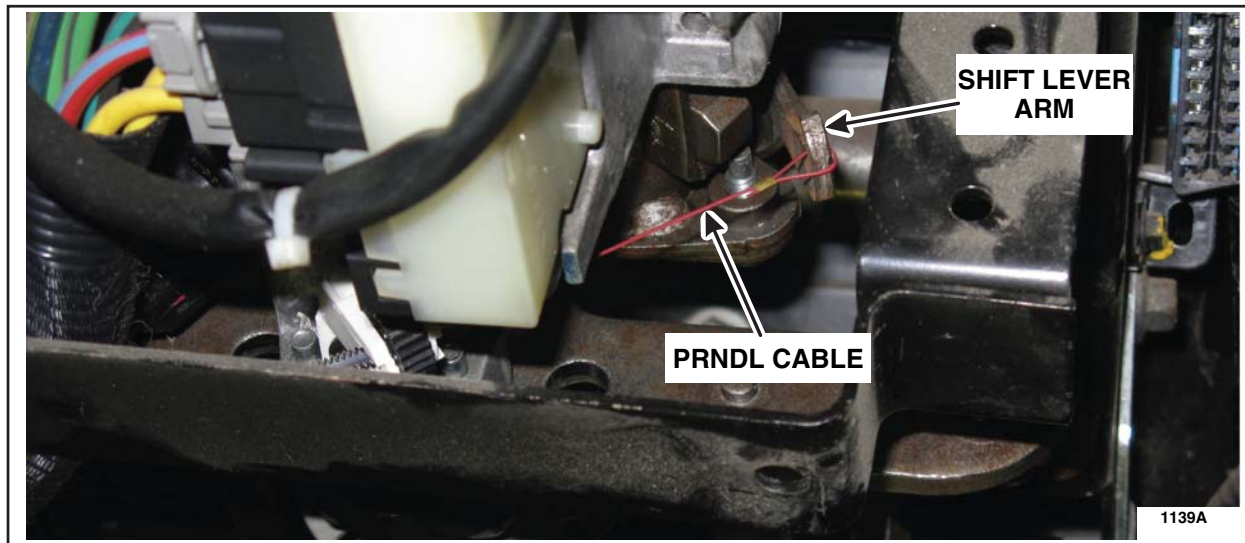

FIGURE 1



3. Remove the bolt and detach the PRNDL cable from the steering column. See Figure 2.

- Note the PRNDL cable routing for installation.

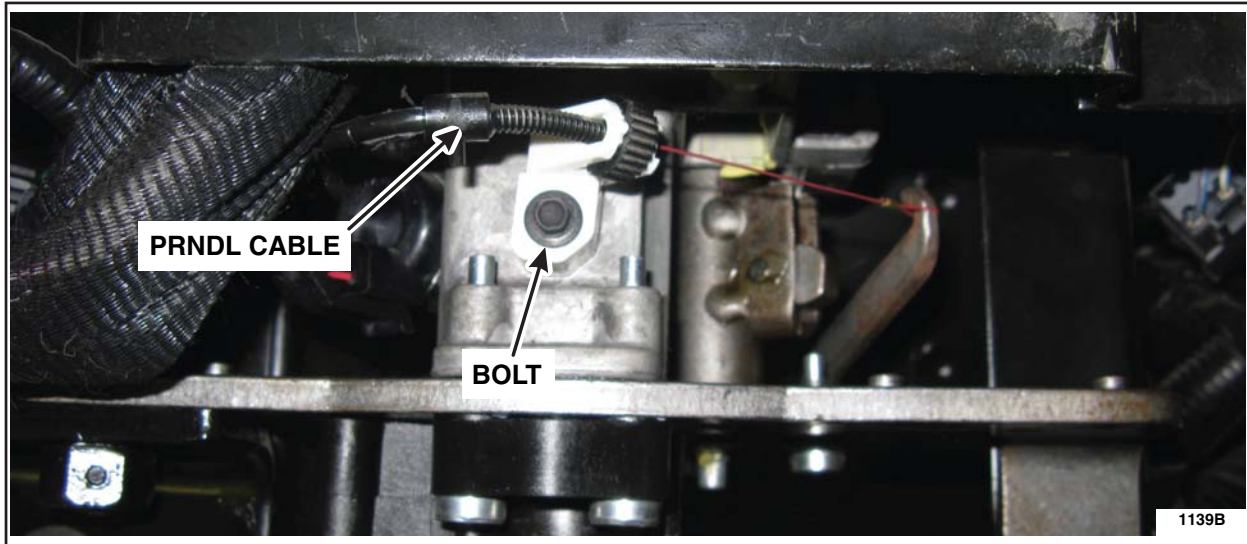

FIGURE 2

4. Detach the transmission shift cable from the shift lever arm. Remove the 2 bolts and the shift lever arm. See Figure 3.

- Discard the shift lever arm.

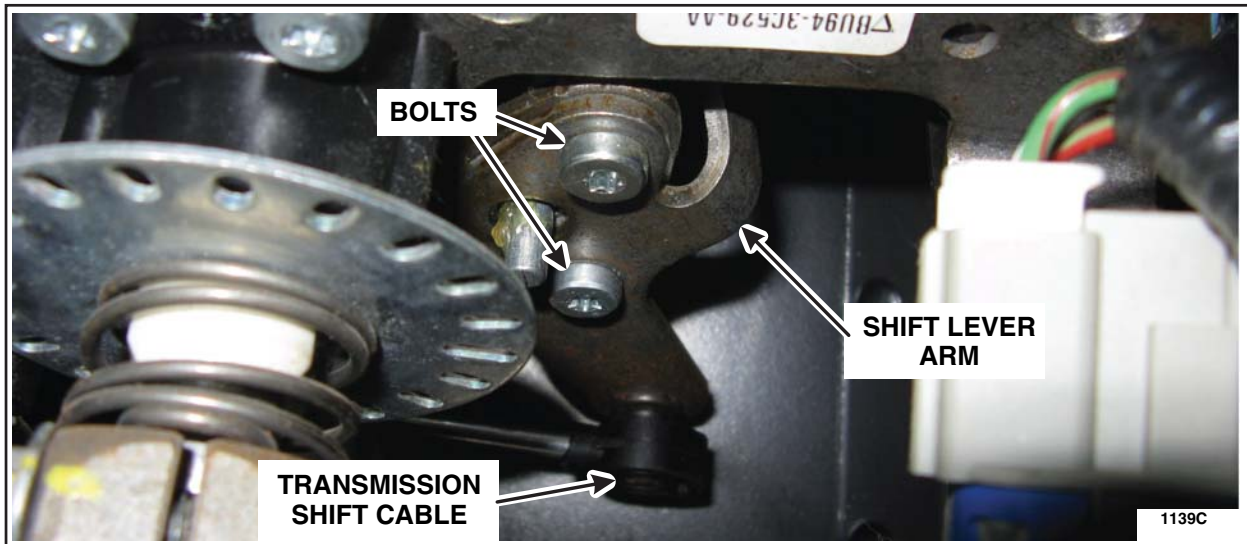

FIGURE 3



- Partially disassemble the instrument panel or remove the Instrument Cluster (IC) to gain access to the PRNDL indicator. Refer to the Coach Builders repair manual for further information if necessary. See Figure 4.

NOTE: Figures 4 and 5 show one example of access to the PRNDL indicator. Due to instrument panel design variations of the different coach builders, this example may not be representative, and access for other vehicles may be different.

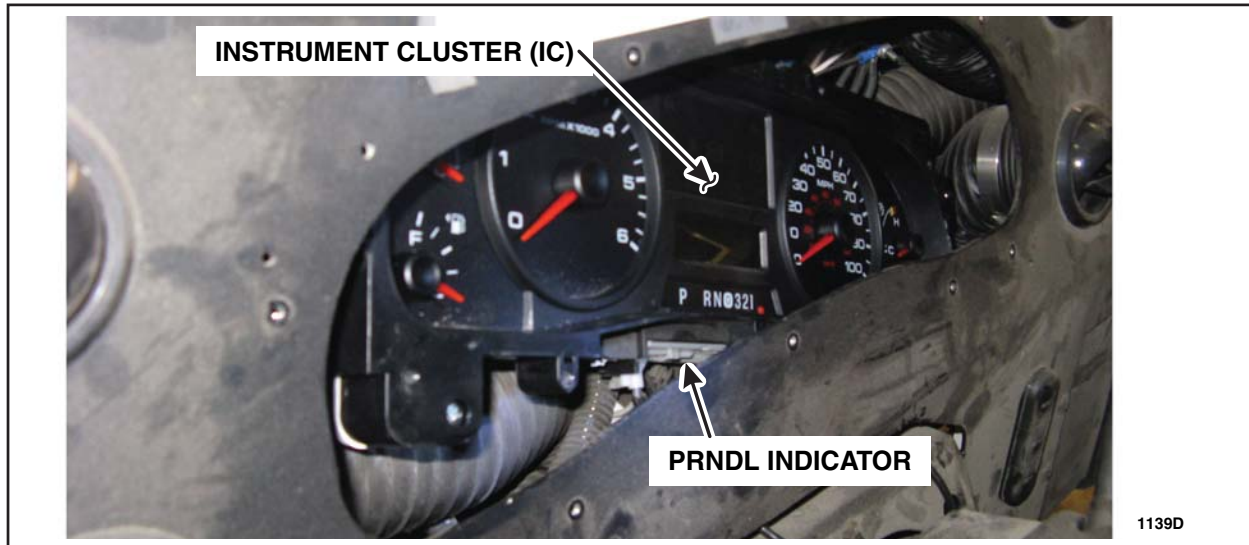

FIGURE 4

- Push in the tabs located on each end of the PRNDL indicator and remove the PRNDL cable/indicator assembly. See Figure 5.

- Discard the PRNDL cable/indicator assembly.

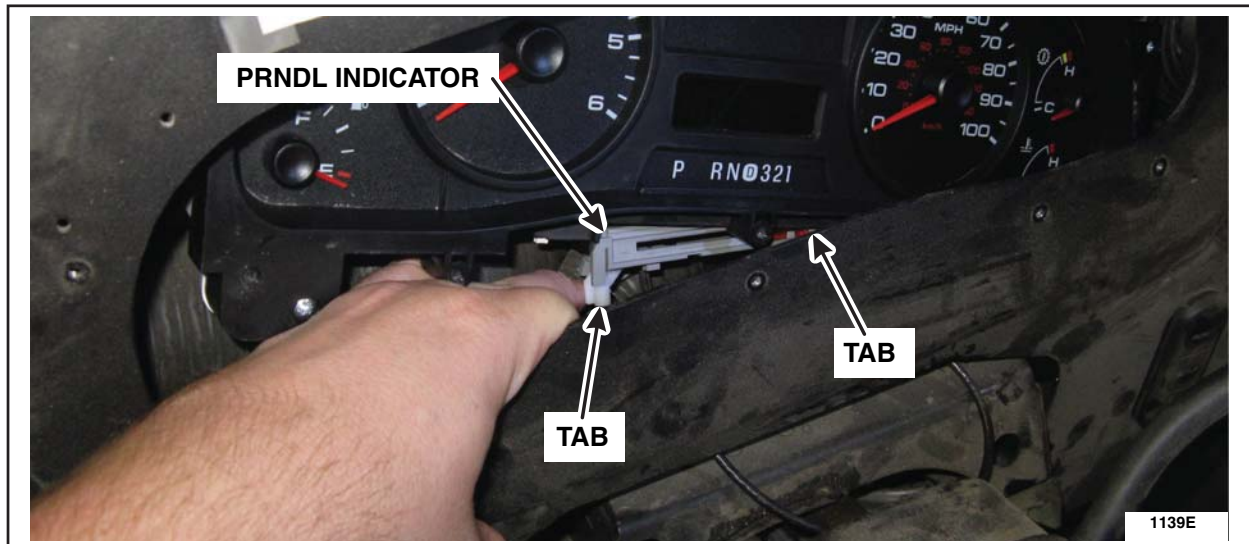

FIGURE 5



Installation

1. Install the *new* PRNDL indicator/cable assembly into the IC. See Figure 5.
2. Install/reassemble the IC. Refer to the Coach Builders repair manual for further information if necessary. See Figure 4.
3. Install the *new* shift lever arm and 2 bolts. Attach the transmission shift cable to the *new* shift lever arm. See Figure 3.
 - Tighten the shift lever arm bolts to 15 Nm (133 lb-in).
4. Attach the *new* PRNDL cable to the steering column and install the bolt. See Figure 2.
 - Tighten to 0.8 to 1.2 Nm (7-10 lb-in).
5. Attach the *new* PRNDL cable to the *new* shift lever arm. See Figure 1.
6. Adjust the *new* PRNDL indicator/cable assembly.
 - a. Place the gearshift lever in the "D" position.
 - b. Hang a 1.3 kg (3 lb) weight on the transmission range selector lever.
 - c. Rotate the thumbwheel on the PRNDL cable until the PRNDL indicator is approximately in the middle of the "D." See Figure 6.

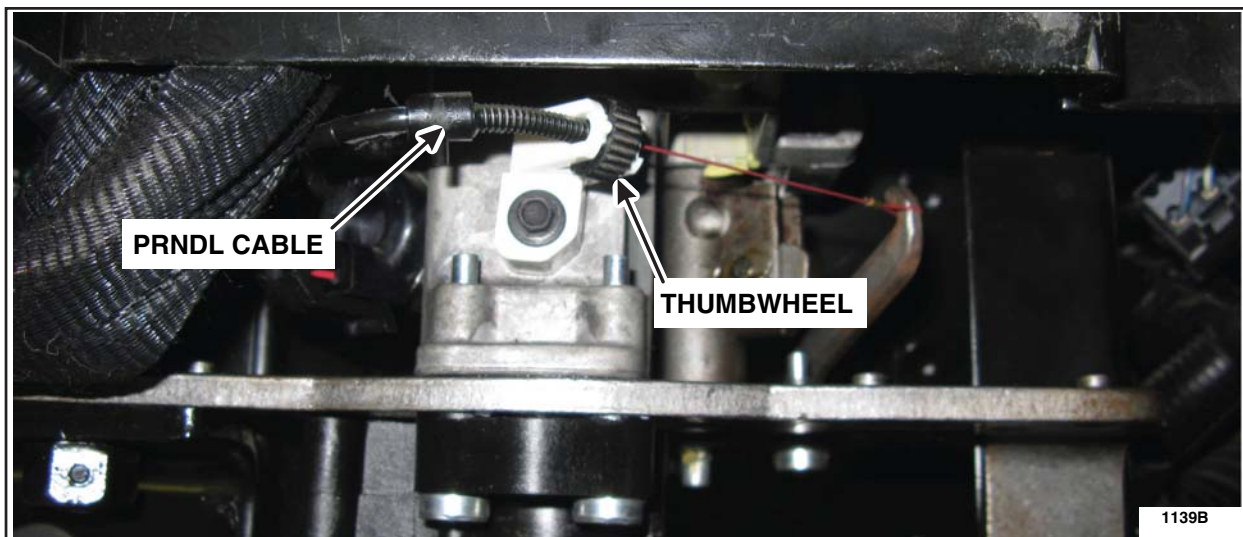

FIGURE 6

7. Install the lower steering column trim/knee bolster panel if necessary.
8. Return the vehicle to the customer.

