

Retail Operator General Manager	Sales New Motorcycles	Sales Pre-Owned Motorcycles	Business Manager (F&I)	Service	Parts & Accessories	Administration
Date: January 2013	Source: SI 01/2013					
Bulletin # 46 002 13 (002)	Name: Shawn McLean					
	Title: Service & Technical Manager					
	Phone: 201-307-4131					



**BMW Motorrad  
USA  
Service Information Bulletin**

**\*\*Notice of recall 12V-585\*\***

**Subject:** Side-stand pivot mount

**Model:** S 1000 RR (K46/11)

**Details:** Within the framework of quality monitoring, BMW Motorrad has ascertained that the screws securing the side-stand pivot mount can work loose. Due to a process fault, the part of the frame where the side-stand pivot mount attaches was not adequately cleaned. There is a possibility that traces of foreign matter remained between the frame, the pivot mount and in the threads of the pivot-mount threaded fasteners. This can result in the pivot mount of the side stand working loose. If this situation is not noticed in good time by the rider, the motorcycle can topple when propped on the stand.

**Vehicles affected:** In order to determine if a specific vehicle is affected by this Recall Campaign, it will be necessary to verify all vehicle VINs through a DCS Vehicle History Check. Based on the response of the system, either proceed with the repair or take no further action. Please note, affected VINs may not appear until 24-72 hours after the release of this bulletin.

**NHTSA Statement:** PERFORM THE PROCEDURE OUTLINED IN THIS SERVICE INFORMATION ON ALL AFFECTED VEHICLES BEFORE CUSTOMER DELIVERY OR THE NEXT TIME THE VEHICLE IS IN THE SHOP FOR MAINTENANCE OR REPAIRS.

BMW Motorcycle dealers must ensure recalls are completed after having been notified by BMW of North America, LLC (BMW Motorrad USA) that a safety-related defect or noncompliance exists in any motor vehicle or item of replacement equipment in the dealer's possession at the time of notification. In BMW NA's case, this notification would typically be made by the issuance of a recall notification in the form of a Service Information Bulletin (SIB) or transmission of a Dealer Communication System (DCS) recall message.

Under the National Traffic and Motor Vehicle Safety Act of 1966, as amended, if a recall campaign is announced by BMW NA, dealers must ensure that all recalls on vehicles and new items of replacement equipment are completed BEFORE delivery to the consumer. This means that dealers may not legally deliver new vehicles or new items of replacement equipment to consumers with an open recall.

The Safety Act also prohibits dealers from selling or leasing the vehicle or item of replacement equipment, unless and until the open recall has been completed BEFORE delivery. This also pertains to motorcycles in the Certified Pre-Owned program, and to items of replacement equipment.

Finally, BMW motorcycle dealers should not sell or use parts that have been recalled by BMW Motorrad USA. Please follow the specific instructions provided by BMW Motorrad USA on the return or disposition of the parts.

**Production Solution:** As of December 04, 2012 an improved cleaning process has been implemented in the assembly plant.

**Aftersales Solution:** On all motorcycles affected by this problem it will be necessary to clean the threaded bores in the frame, the mating surface for the pivot mount and the surrounding part of the frame with meticulous care prior to replacing the two threaded fasteners. See work item 00 60 261 on page 3.  
If the threads in the tapped bores have been damaged beyond repair, threaded inserts (Time-Sert) must be installed. See work item 00 60 262 starting on page 4.

**Warranty:** The repair described in this bulletin is covered under warranty regardless of time or mileage. Reimbursement for this Recall Campaign is through normal claim entry utilizing the following information:

<b>Warranty Processing Information:</b>	<b>Defect code:</b> 00 00 46 30 00	Pivot mount of side stand loose.
	<b>Labor codes:</b> 00 60 261*	Replacing threaded fastener for side-stand pivot mount (including removing/installing rear-wheel stand), 5 FRUs
	<b>or</b>	
	00 60 262*	Replacing threaded fastener for side-stand pivot mount (including thread repair and removing/installing rear-wheel stand), 19 FRUs
	<b>Part number:</b> 46 53 8 542 020	Hex screw, M8x30 (x2)

Under **no** circumstances are you to claim both labor codes listed above.

\*Main Work 00 60 261 and 00 60 262 - these main labor operations include all repair procedures to complete the task with allowance for necessary ancillary tasks (e.g., visual inspection, lubrication, cleaning parts etc.) and administrative tasks. Only one main labor operation can be claimed per repair visit. All other labor operations for any other line(s) must be claimed using plus code labor operations. Please refer to the Warranty Policy and Procedures Manual regarding add-ons, proper support, documentation, claims submission and archiving requirements as applicable.

**Additional information:** It is unlikely that thread repair will be necessary but if it is, only Time-Sert thread inserts are an approved method of repair. You have the option of sourcing these locally (M8x1.25, 10mm length, sublet code 4, \$2 for thread insert) or ordering the thread repair kit listed below. Only one tool set per workshop can be claimed through warranty.

**Special tool:** 83 30 2 348 050      Special tool set 46 5 810 for thread repair

**Contact:** Service and Technical Manager

**Work item: 00 60 261 Replacing threaded fastener for side-stand pivot mount (including removing/installing rear-wheel stand)**

**Preparatory work:** Installing rear-wheel stand.  
Disengaging left engine spoiler.

**Removing side-stand pivot mount with side stand**

Remove screws (1).  
Remove side-stand with pivot mount (2), and secure it so it does not hang by the wire harness.

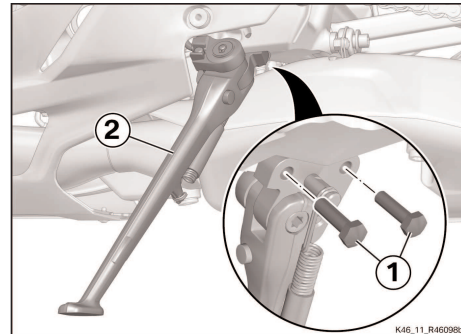

**Checking side-stand pivot mount threads in frame.**

Check threads (1) of the tapped bores for the side-stand pivot mount for damage.

**Result:**

Thread is damaged, continue with Work Item 00 60 262.

Thread is okay. Continue to next step.

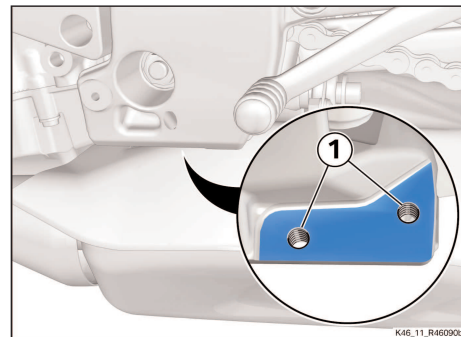

**Cleaning contact surfaces and threaded bores of side-stand pivot mount**

Clean the threads of tapped bores.  
Clean the contact faces (arrows) of main frame (1) and side-stand pivot mount (2) so they are free from grease and foreign matter.

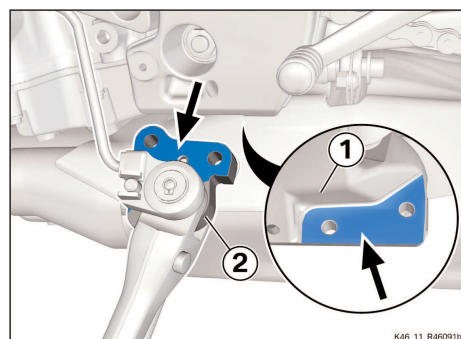

**Installing side-stand pivot mount with side stand**

Hold the side-stand pivot mount with side-stand (2) in position.  
Install new screws (1) and tighten.

Tightening torques	
Pivot mount of side-stand to frame	
M8 x 30, Replace screw Thread-locking compound (Micro-encapsulated)	30 Nm

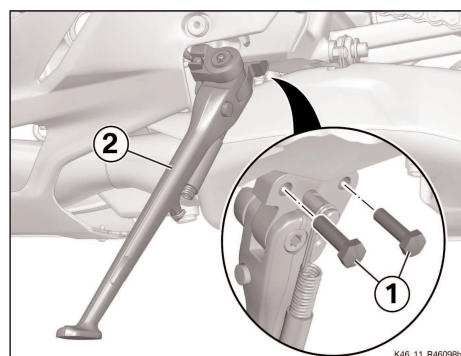

**Note:** If screws cannot be tightened to specified tightening torque, proceed with work described in Work Item 00 60 262, Billed as a separate item.

**Finishing work:** Secure the left engine spoiler.  
Removing rear-wheel stand.  
Final check of work performed.

**Work item: 00 60 262 Replacing threaded fastener for side-stand pivot mount (including thread repair and removing/installing rear-wheel stand)**

**Thread repair of side-stand threaded fastener**

Overview of thread repair set (46 5 810):

- Drill bit (A)
- Shouldered milling cutter (B)
- Thread cutter (C)
- Screw-in tool (E)
- Threaded bush 10 mm (D)

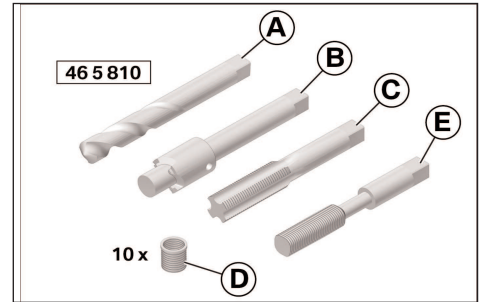

**Note:** Time-Sert M8x1.25 (10.0mm long).

**Preparatory work:**

- Installing rear-wheel stand.
- Removing side panel, left complete with engine spoiler.
- Removing side panel, right, complete with engine spoiler.
- Removing cover of exhaust-flow control valve.
- Disengaging bowden cables from exhaust-flow control valve.
- Disengaging bowden cable of balance-pipe valve.
- Removing silencer.
- Removing bracket for radiator.
- Disengaging cables for oxygen sensors.
- Removing exhaust manifold.



When repairing thread in front tapped bore (1) do not exceed maximum drilling depth (A) in order to prevent damage to the threads of tapped bore (2) for the engine-spoiler fastener.

Technical data	
Maximum drilling depth, front tapped bore for side-stand threaded fastener	20+1 mm

When repairing the threads of the rear tapped bore (3) there is a possibility of the bore coming through the frame (arrow). Deburr as necessary.

Drill out damaged thread with drill bit (A) and tool holder (1).

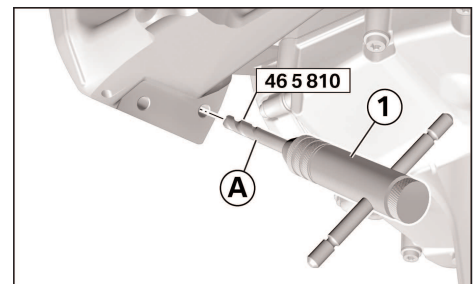
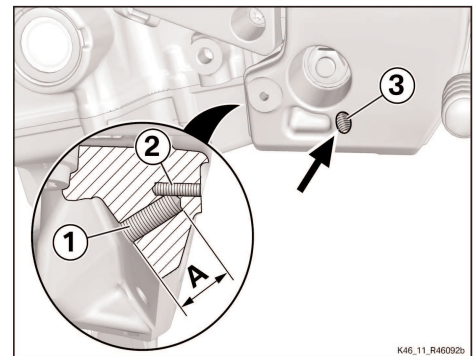

Use shouldered milling cutter (B) and tool holder (1) to mill a shoulder (arrow) in the frame (2). Make sure that the shoulder (arrow) is milled out to the depth of the shouldered milling cutter (B).

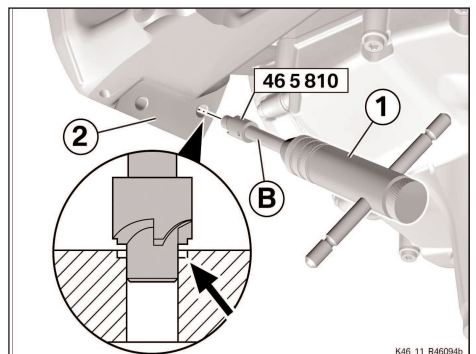

**Work item** 00 60 261 Replacing threaded fastener for side-stand pivot mount  
**continued:** (including removing/installing rear-wheel stand)

When cutting threads in aluminum, use brake cleaning fluid to lubricate the hole and the thread cutter.

Cleaner	
Brake cleaner	83 9 2 180 805/806

Using thread cutter (C) and tool holder (1) cut threads in frame (2).

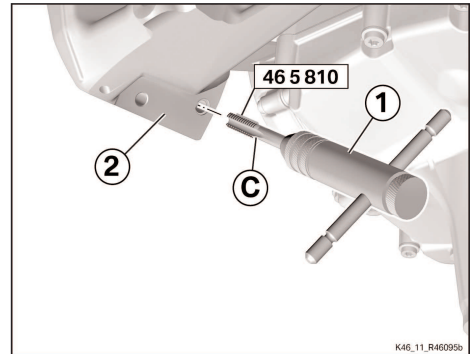

Screw in short threaded bush 10 mm (D) using screw-in tool (E) and tool holder (1).  
 Make sure that threaded bush (D) is installed firmly and flush and does not project beyond mating face (2).

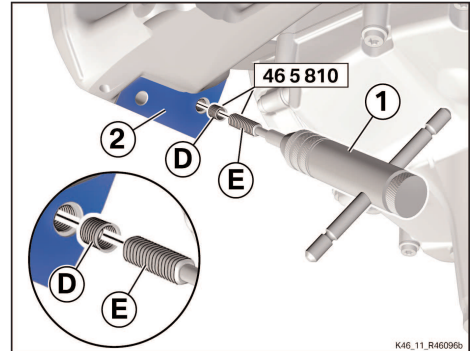

Similarly, you can follow the thread repair instructions that are contained in a typical Time-Sert kit if one is sourced locally.

**Cleaning contact surfaces and threaded bores of side-stand pivot mount**

Clean the threads of tapped bores.  
 Clean the contact faces (arrows) of main frame (1) and side-stand pivot mount (2) so they are free from grease and foreign matter.

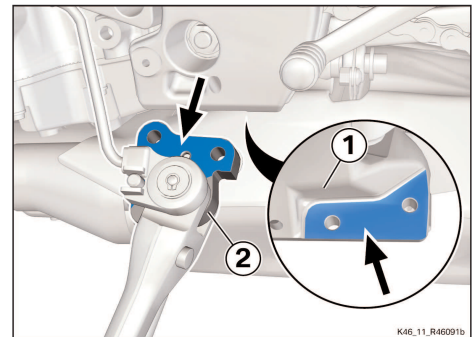

**Installing side-stand pivot mount with side stand**

Hold the side-stand pivot mount with side stand (2) in position.  
 Install new screws (1) and tighten.

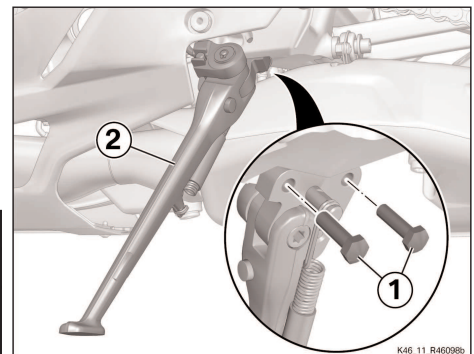

Tightening torques	
Pivot mount of side-stand to frame	
M8 x 30, Replace screw Thread-locking compound (Micro-encapsulated)	30 Nm

- Finishing work:**
- Installing exhaust manifold
  - Installing cables for oxygen sensors
  - Installing bracket for radiator
  - Installing Bowden cable of balance-pipe valve
  - Adjusting Bowden cable of balance-pipe valve
  - Securing Bowden cables to exhaust-flow control valve
  - Adjusting Bowden cable for exhaust-flow control valve
  - Installing cover of exhaust-flow control valve
  - Installing silencer