



Date: 25.10.2011

Model: Federal 2011MY Elise - Limited VIN Range
Within Port Facilities & Dealer Stock

Number: 2011/23
USA Issue 2

Copy files should be maintained by:

Service Manager		Service Reception		Supervisor		Parts Manager	
-----------------	--	-------------------	--	------------	--	---------------	--

TITLE:

Retrofitment of revised turn signal module (also referred to as a flasher relay or module) for demonstrator vehicles or inventory stock.

REASON:

At the time of production a limited number of 2011 MY Federal Elise's were fitted with turn signal modules which were not compatible with the revised front headlight configuration which includes the integral front LED turn signal units.

The incompatible module may, under certain conditions cause all the LED turn signal lamps to flash at an erratic frequency when the hazard warning switch is depressed. And in the event that either a front or rear turn signal lamp fails to illuminate or does not flash at the correct frequency when operated, the remaining functioning signal lamps on that vehicles side as well as the instrument turn tell tale lamp will not flash at an increased rate as intended.

Therefore it is possible that the driver will not be visually alerted to the fact that one or more of the vehicles turn signal lamps is not operating correctly.

ACTION:

Please check and identify any affected VIN numbers against your dealer inventory or dealer demonstrators VIN number records.

Affected VIN numbers are listed on page 3 of this bulletin, the campaign status of vehicles affected will also be displayed if the VIN is entered onto DC611 on Lotus Dealer Connect.

All Dealers have been mandatorily issued a quantity of the latest level turn signal modules and link harnesses. These are also available to order on Lotus Dealer Connect if further quantities are required.

Parts Required	Part Number	Qty
Turn signal module	A121M0060F	1
Link harness	A121M0068F	2

Procedure 1

1. Remove both rear RHR and LHR lamp covers located within the rear luggage compartment.
2. Inspect and confirm if there are turn signal ballast modules fixed to the inner LED lamps.
3. If ballast modules are not fitted and green colored link harnesses are connected to the fly leads of both outer LED lamps, then no further action is required. (see illustration on page 2).

If ballast modules **are** fitted to the inner LED lamps then go to procedure 2.

Continued.....

LOTUS CARS LIMITED

Procedure 2

1. Disconnect the harnesses of both ballast modules at their multi-plug connections to the RH & LH outer lamp fly leads.
2. Remove the M5 nyloc nuts and M5 washers securing the ballast modules to both LH & RH inner lamp assemblies.
3. Remove both modules from the vehicle and refit the inner LED lamps nuts and washers. Attach a warranty tag to the ballast modules and retain them with any other displaced warranty parts as per the current warranty procedures policy.
4. Attach a link harness to both of the outer lamp fly lead connectors.
5. Replace the turn signal module with new part number A121M0060F. The module is located in the passenger side footwell fuse and relay station. (The specific module location is listed in section MP11 of the Elise and Exige Service Notes).
6. Test that all of the vehicles exterior lamps are functioning correctly.
7. Test that the flash frequency now increases in the event of an LED turn lamp failure by disconnecting both rear outer lamps at their multi-plug connections at the vehicles rear harness.
8. Operate the turn signals, the rear lamps will obviously not flash, but the front turn signals, side repeater units and instrument panel tell-tale should flash at an increased rate.
9. Reconnect both of the outer lamp multi-plug connectors, re-test to ensure that all of the vehicles lamps are still functioning correctly and refit the rear lamp covers.

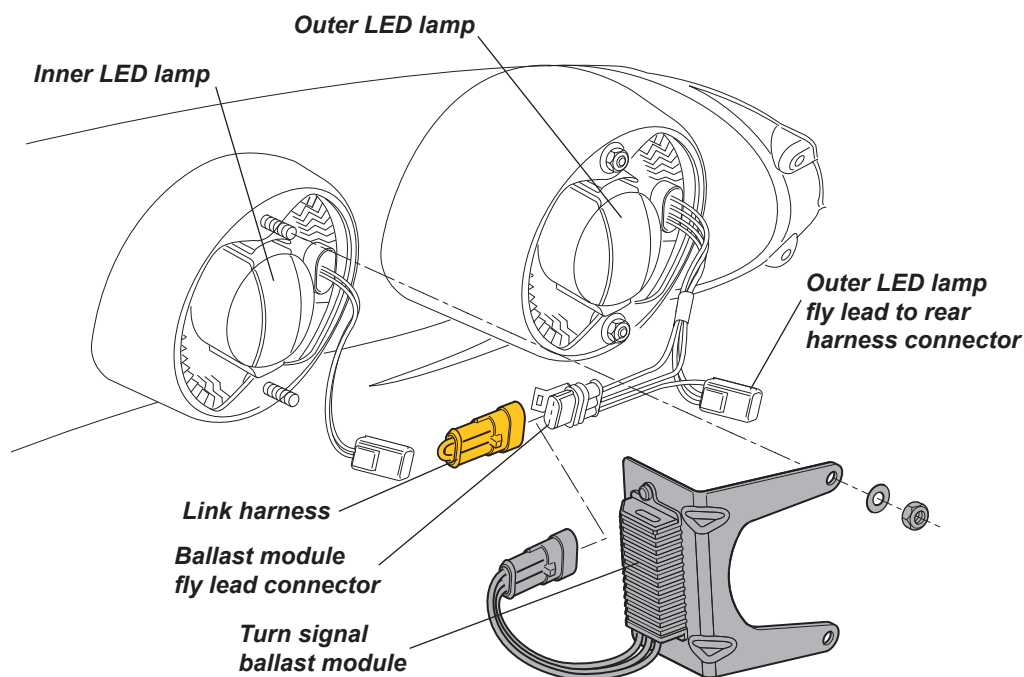

m271

...Continued

LOTUS CARS LIMITED



CHARGES:

Parts and labor dependant on the procedure carried out may be recovered by submitting a warranty claim on Lotus Connect, option DC603 Bulk Entry Campaign, campaign number 2011/23. Select inspection type:

- 01: Procedure 1, Inspection only, no action required (0.1 hrs).
- 02: Procedure 2, Inspect and remove both lamp ballast modules, replace turn signal module (0.6 hrs).

Displaced parts should be retained for potential inspection as per the procedure described in the Warranty Policy and Procedures manual, after which time if not already requested for return, they should be destroyed before disposal.

VINS LOCATED AT PORT FACILITIES OR IN DEALER STOCK AFFECTED BY CAMPAIGN 2011/23

(Please check campaign status on Lotus Connect before carrying out repair action)

- SCCLHCPC4BHA10334
- SCCLHCPC7BHA10344
- SCCLHCPC5BHA10410
- SCCLHCPC2BHA10414
- SCCLHCPC8BHA10496
- SCCLHCPC8BHA10515
- SCCLHCPC4BHA10527
- SCCLHCZC3BHA10533
- SCCLHCPC2BHA10588
- SCCLHCPC7BHA10599
- SCCLHCPC2BHA10607
- SCCLHCPC3BHA10647
- SCCLHCPCXBHB10650
- SCCLHCPC0BHA10654
- SCCLHCPC5BHA10665
- SCCLHCZC5BHA10694
- SCCLHCPC1BHB10701
- SCCLHCZC8BHA10754
- SCCLHCPC1BHA10789
- SCCLHCPC5BHA10794
- SCCLHCZC6BHA10803
- SCCLHCPC1BHA10811
- SCCLHCPC6BHA11159
- SCCLHCPC2BHA11689
- SCCLHCPC8BHA11695
- SCCLHCPC1BHA11697
- SCCLHCPC3BHA11698
- SCCLHCPC5BHA11704
- SCCLHCZC4BHA11769
- SCCLHCZC6BHA11773
- SCCLHCPC2BHA11806
- SCCLHCZC1BHA11809
- SCCLHCZC0BHA11817
- SCCLHCPC9BHA11835
- SCCLHCPC0BHA11836
- SCCLHCPC7BHA11865
- SCCLHCZC6BHA11868
- SCCLHCPC6BHA11873
- SCCLHCZC7BHA11930
- SCCLHCZC8BHA11936
- SCCLHCZC1BHA11938
- SCCLHCPCXBHA11987
- SCCLHCPC1BHA11988
- SCCLHCZC9BHA11993
- SCCLHCZC8BHA11998

Ends.

LOTUS CARS LIMITED