

CERTAIN 2010 MODEL YEAR RANGER VEHICLES EQUIPPED WITH A 2.3L ENGINE — FUEL LINE INSPECTION

OVERVIEW

In some of the affected vehicles, the engine fuel line in the area of the throttle body shield may not have a protective convolute properly installed. If the protective convolute on the fuel line is not assembled in the proper position, the edge of the shield may contact the fuel line. Over time this contact may chafe the fuel line, resulting in a fuel odor and a potential fuel leak. Dealers are to trim the throttle body shield, inspect the fuel line for wear, and replace the line if necessary.

SERVICE PROCEDURE

1. Remove the 2 bolts and the throttle body shield. See Figure 1

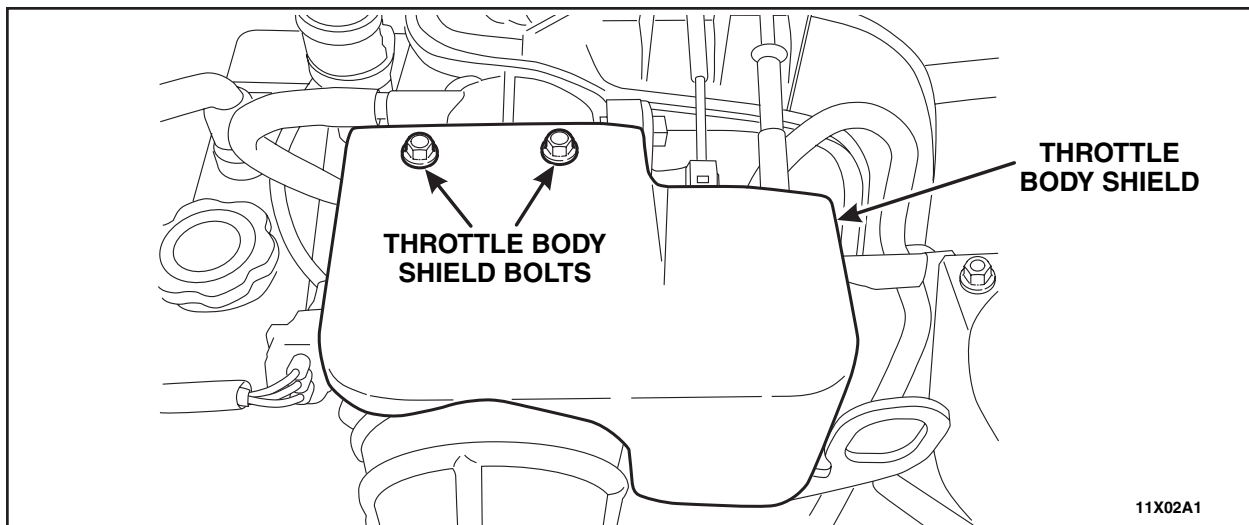

FIGURE 1

2. Trim the drivers side of the throttle body shield to increase throttle body shield to fuel line clearance. See Figure 2

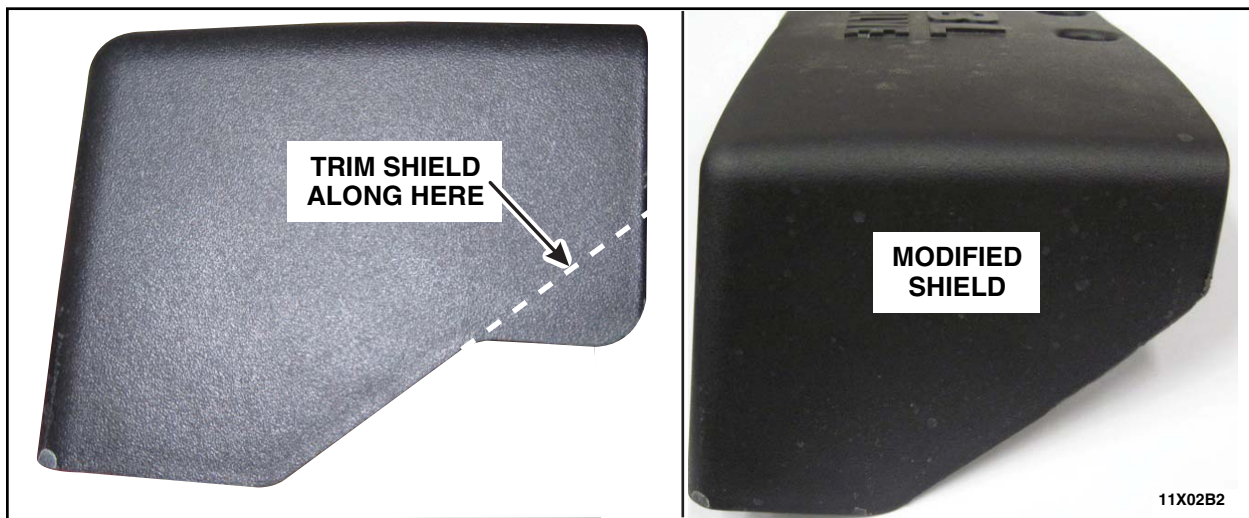

FIGURE 2



3. **NOTE:** The vehicle may or may not have a convolute tube covering part of the fuel line. If present, the convolute tube may need to be temporarily repositioned to inspect the fuel line for any wear. Wear on the convolute **ONLY** is acceptable and does not require replacement.

Inspect the fuel line for any wear caused by contact with throttle body shield. See Figure 3.

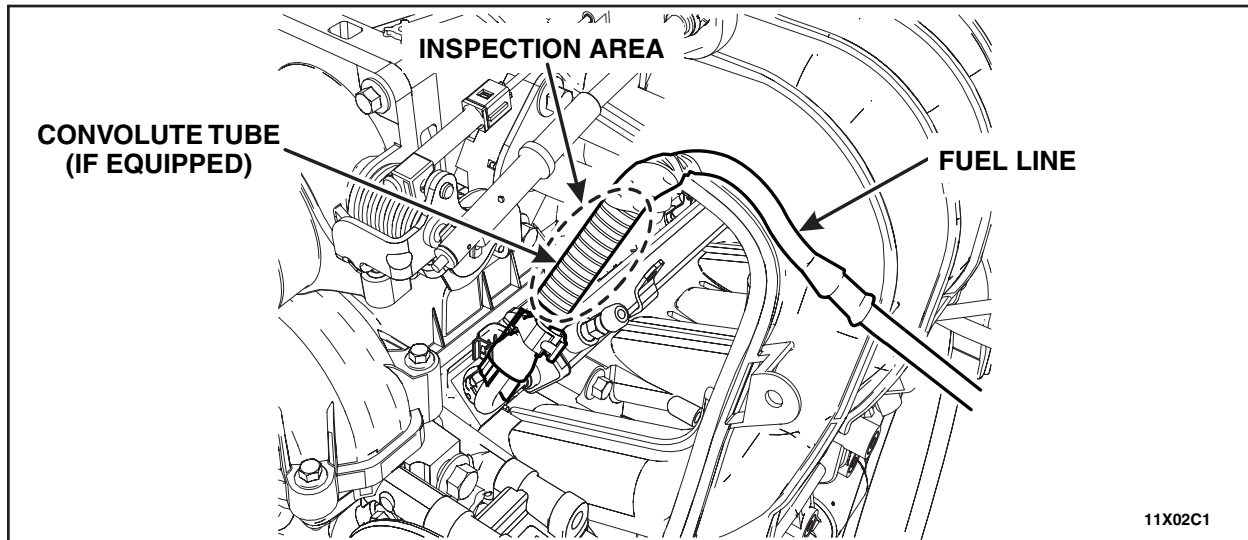

FIGURE 3

4. If there is any wear caused by contact with the throttle body shield on the fuel line, continue to Front Fuel Line Replacement on page 3.
5. If there is **not** any wear on the fuel line caused by contact with the throttle body shield, install the throttle body shield. See Figure 1.
 - Tighten to 8 Nm (71 lb-in).
6. Return vehicle to the customer.



Front Fuel Line Replacement

1. Release the fuel system pressure. For additional information, refer to WSM, Section 310-00: Fuel System.
2. Remove the bolt from the front fuel line bracket at the intake manifold. See Figure 4.

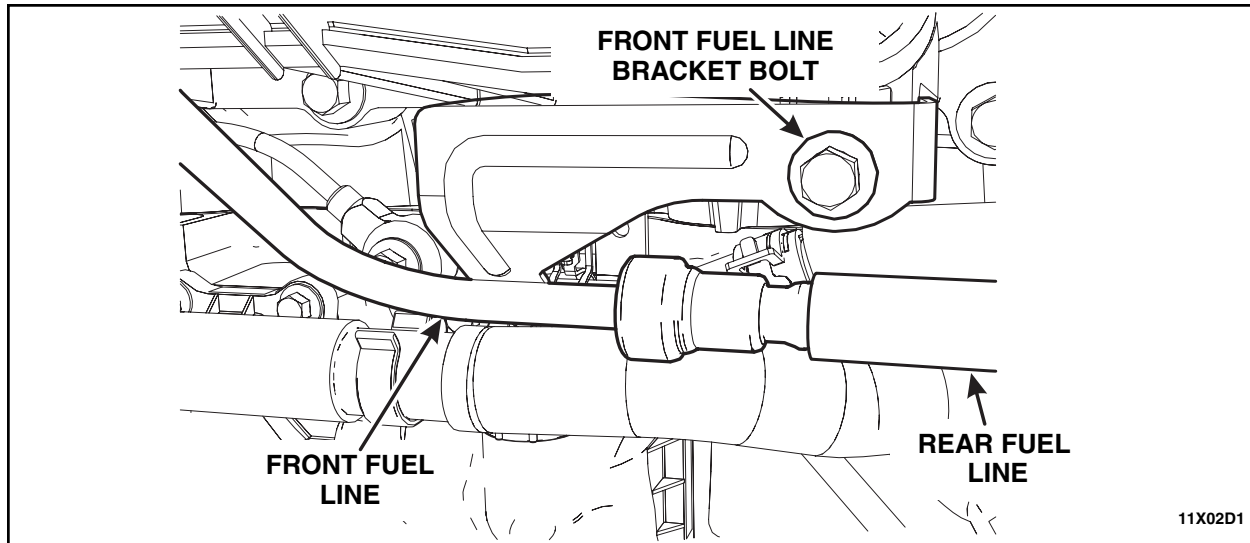

FIGURE 4

3. Disconnect the front fuel line-to-rear fuel line spring lock coupling (See Figure 4). For additional information, refer to WSM, Section 310-00: Fuel System.
4. Disconnect the front fuel line-to-fuel rail spring lock coupling (See Figure 5). For additional information, refer to WSM, Section 310-00: Fuel System.

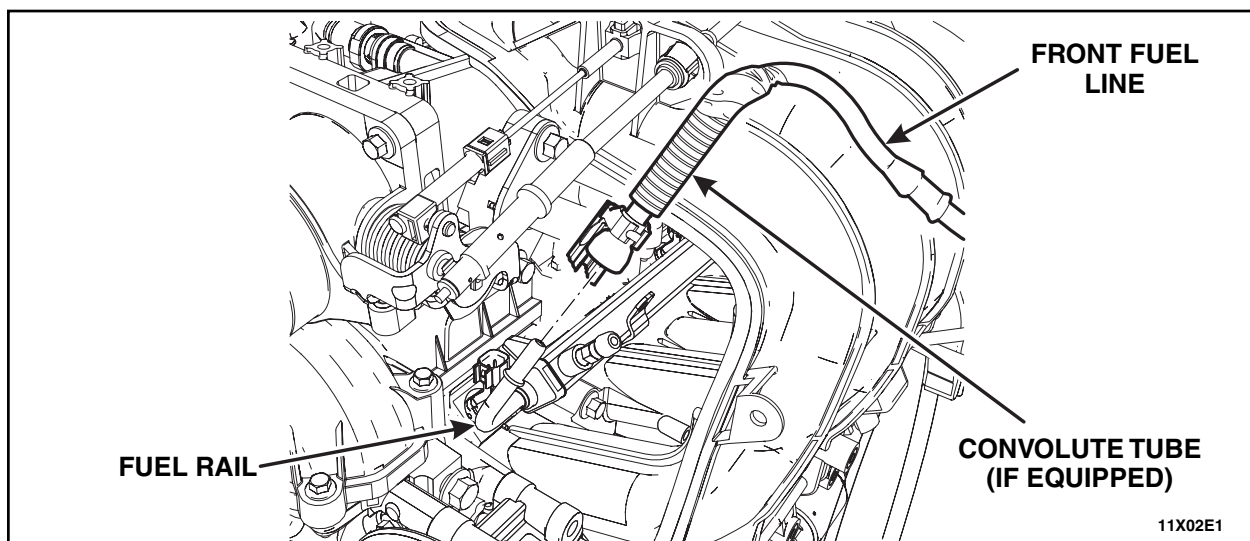

FIGURE 5



5. Remove the front fuel line.
6. Install the **new** front fuel line.
7. Connect the front fuel line-to-fuel rail spring lock coupling. See Figure 5.
8. Connect the front fuel line-to-rear fuel line spring lock coupling. See Figure 4.
9. Position the front fuel line bracket back to the intake manifold and install the bolt. See Figure 4.
10. Install the throttle body shield. See Figure 1.
 - Tighten to 8 Nm (71 lb-in).
11. Return the vehicle to the customer.

