



Vermeer
1210 Vermeer Road East
Plant 1 P.O. Box 200
Pella, IA 50219
Phone: (641) 628-3141
www.vermeer.com

11V-262
(5 Pages)

Via Email: RMD.ODI@dot.gov

To: Defects and Recall Information Analysis Division
Associate Administrator for Safety Assurance
National Highway Traffic Safety Administration
400 7th Street, SW
Washington DC 20590

PART 573 Defect and Noncompliance Report

Report Date: April 28, 2011

On 17 March, 2011, Vermeer Manufacturing Company, d/b/a Vermeer Corporation, determined that there is a defect which relates to motor vehicle safety with respect to certain motor vehicles listed below, and is furnishing notification to the National Highway Traffic Safety Administration in accordance with 49 CFR Part 573 Defect and Noncompliance Reports.

1. **Fabricating Manufacturer:**

Vermeer Manufacturing Company, d/b/a Vermeer Corporation
1210 Vermeer Road East
Pella, IA 50219

Telephone: 641-628-3141 **Fax:** 641-621-7739

Contact Name and Title: Lois Slings
Product Safety/Legal, Operations Manager

Name and Title of Person Who Prepared Report: Lois Slings
Product Safety/Legal, Operations Manager

Signed: Lois Slings **Date:** 4-28-11



PART 573 Defect and Noncompliance Report

Report Date: April 28, 2011

I. Identify the Vehicle Models Involved in the Recall

2. **Manufacturer's Identification Code:** IK00-1652

3. **Vehicle Identification:**

Make:	Vermeer	Model Years Involved:	2009 – 2011	
Model(s):	BC1200XL			
Production Dates:	Beginning:	7/24/2009	Ending:	2/14/2011
VIN Range:	Beginning:	1VR7141Y191000099	Ending:	1VR7141Y5B1000306
Vehicle Type:	Trailer – Single axle Brush Chipper			

Description which characterizes/distinguishes the recalled vehicles from those model vehicles not included in the recall: The VIN Range includes 208 units. The trailers affected are 140 units that received an optional, factory-installed flotation tire (Sales Code BC1200XL076).

Identify the approximate percentage of the production of all the recalled models manufactured by your company between the inclusive dates of manufacture provided above, that the recalled model population represents. For example, if the recall involved Widgets equipped with certain items of equipment from January 1, 1996 through April 1, 1997, then what was the percentage of the recalled Widgets of all Widgets manufactured during that time period.

66%

II. Identify the Recall Population

4. **Total Number of Vehicles Recalled Potentially containing the defect or noncompliance:**

Model	Year	Number of Vehicles Potentially Involved
BC1200XL	2009	19
BC1200XL	2010	97
BC1200XL	2011	24
Total Number Potentially Affected by the Recall:		<hr/> 140

5. **Approximate percentage of Total Number of Vehicles Estimated to actually contact the defect or noncompliance:** 100%

Identify and describe how the recall population was determined, in particular how the recalled models were selected and the basis for the beginning and final dates of manufacture of the recalled vehicles: From manufacturing records, we were able to determine the specific units which received the optional 285/75/R16 flotation tires (BC1200XL076).

III. Describe the Defect or Noncompliance

6. **Describe the defect or noncompliance. The description should address the nature and physical location of the defect or noncompliance. Illustrations should be provided as appropriate.**

During the assembly process at the Pella, Iowa manufacturing facility, incorrect lug nuts were installed on wheels for the 285/75/R16 flotation tire option. These incorrect lug nuts may loosen since the lug nuts do not match the countersink holes in the wheel disc. Loose lug nuts can damage the wheel disc and result in wheel separation from the brush chipper.

The following Exhibits are attached for reference:

- **Exhibit A:** Product brochure for Vermeer Model BC1200XL. The tires shown on the product in the brochure displays the standard tire option, not the flotation tire option.
- **Exhibit B:** BC1200XL Parts Manual Fig 2-3: Flotation Wheel & Tire
- **Exhibit C:** Photos of the incorrect lug nut (60 degree) installed (Vermeer Part #243133031) and photo of the correct lug nut (90 degree) to be installed (Vermeer Part #123306007)

Describe the cause(s) of the defect or noncompliance condition.

Manufacturing personnel on the BC1200XL assembly line affixed the incorrect lug nuts during the assembly process.

Describe the consequence(s) of the defect or noncompliance condition.

Lug nuts could loosen resulting in wheel separation from the brush chipper.

Identify any warning which can (a) precede or (b) occur.

(a) Loose lug nuts.

If the defect or noncompliance is in a component or assembly purchased from a supplier, identify the supplier by corporate name and address.

Not applicable.

Identify the name and title of the chief executive officer or knowledgeable representative of the supplier.

PART 573 Defect and Noncompliance Report

Report Date: April 28, 2011

Not applicable.

IV. Provide the Chronology in Determining the Defect/Noncompliance

If the recall is for a defect, complete item 6, otherwise item 7.

7. **With respect to a defect, furnish a chronological summary (including dates) of all the principle events that were the basis for the determination of the defect. The summary should include, but not be limited to, the number of reports, accidents, injuries, fatalities, and warranty claims.**

10 Mar, 2011: First field notification received relating to BC1200XL, VIN 1VR7141Y4B1000295, a unit built on 3 January, 2011, and shipped to a Vermeer dealer in New Zealand. This unit is equipped with the flotation tire option installed. While performing a pre-delivery retail sale inspection, the dealer discovered that incorrect lug nuts were installed and notified Vermeer Corporation's factory service department.

11 Mar, 2011: Factory service personnel contacted Vermeer dealer in New Zealand and instructed dealer to submit the issue on a quality notification form (QNF).

14 Mar, 2011: Vermeer dealer in New Zealand submitted QNF identifying the issue as "Wheel nuts are pulling through the wheel tapers. Damaged threads may result."

16 Mar, 2011: QNF issue forwarded to Vermeer Corporation's product safety department for further investigation.

17 Mar, 2011: Product Safety department personnel investigation concluded that the production assembly line had installed incorrect lug nuts on the units having the flotation tire option. *(See Exhibit C for photos of difference in lug nuts.)*

29 Mar, 2011: Documentation processed to begin field campaign.

08 Apr, 2011: Product Safety department staff and engineering/service department staff met to discuss field campaign.

15 Apr, 2011: Product Safety department staff met to discuss field campaign details.

28 Apr, 2011: Production assembly checklist edited to include verification of lug nuts according to tire option.

28 Apr, 2011: No warranty claims have been submitted to date for the following associated BC1200 flotation tire option parts:

P/N 163647422: Flotation, Wheel Assembly

P/N 163647345: Wheel, 16x8 XCX Silver

With respect to a noncompliance, identify and provide the test results or other data (in chronological order and including dates) on which the noncompliance was determined.

Not applicable.

Furnish a description of the manufacturer's remedy for the defect or noncompliance. Clearly describe the differences between the recall condition and the remedy.

Replace the incorrect lug nuts with the correct lug nuts.

Clearly describe the distinguishing characteristics of the remedy component/assembly versus the recalled component/assembly.

Field kit instructions are currently under development. Replacement lug nuts, 8 lug nuts per wheel and 2 wheels per unit, are on order with the lug nut supplier. *Refer to Exhibits for further identifying characteristics of lug nuts.*

Identify and describe how and when the recall condition was corrected in production. If the production remedy was identical to the recall remedy in the field, so state. If the product was discontinued, so state.

Manufacturing personnel have been advised of the issue and further training and instructions provided to install the correct lug nuts on the flotation tire option.

VI. Identify the Recall Schedule

Furnish a schedule or agenda (with specific dates) for notification to other manufacturers, dealers/retailers, and purchasers. Please, identify any foreseeable problems with implementing the recall.

1. 13 May, 2011: Complete development of field modification Kit, including receipt of replacement parts from supplier and installation instructions.
2. 16 May, 2011: Factory will publish Service Bulletin to all Dealers introducing field modification Kit via company internet site.
3. 16 May, 2011: Factory will provide owner listing of affected units in their area to Dealers via fax.
4. 01 June, 2011: Factory will notify owners of mandatory field modification via certified/registered mail

VII. Furnish Recall Communications

11. Furnish a final copy of all notices, bulletins, and other communications that relate directly to the defect or noncompliance and which are sent to more than one manufacturer, distributor, or purchaser. This includes all communications (including both original and follow-up) concerning this recall from the time your company determines the defect or noncompliance condition on, not just the initial notification. A DRAFT copy of the notification documents should be submitted to this office by Fax (202-366-7882) or by E-Mail to RMD.ODI@dot.gov for review prior to mailing. Note that these documents are to be submitted separately from those provided in accordance with Part 579.5 requirements.

Vermeer
Brush Chipper

BC-1200XL



Vermeer®

BC1200XL

One proven name.

When there's tough brush-clearing work to do, you can count on the Vermeer BC1200XL to handle it. Available with either a 85-hp (63.4 kW) or 110-hp (82 kW) Cummins Tier 3 diesel engine, the BC1200XL is rugged, powerful, and offers innovative features designed for safety and performance.

Not only does the BC1200XL tear through material up to 12" (30.5 cm) in diameter, its patented productivity enhancements help make the job easier for you. Our exclusive SmartFeed system automatically monitors engine speed and stops or reverses the feed rollers if needed, reducing strain on the engine. The dual-pump hydraulic system helps deliver an impressive 3600 lb (1632.9 kg) of theoretical pull-in force for the heavy work. The operator controls are conveniently located close to the infeed area, helping you monitor the machine while it works.

The BC1200XL includes a number of exclusive safety features. The strategically located bottom feed stop bar makes it possible for an operator's leg to either intentionally or automatically strike the bar and shut off the feed mechanism in an emergency. The optional winch features a new patent-pending winch line interlock, which requires the end of the winch line to be attached to an interlock hook in order for the feed rollers to be operable.

In the world of quality, dependable tree-care equipment, Vermeer stands tall.



Dual horizontal offset feed rollers improve performance by aggressively grabbing and feeding material to the drum. The offset helps the upper feed roller climb over big logs or material with lots of branches or forks.



Easily lifts heavy material. An optional winch allows operators to move large logs effortlessly. The 150' (45.7 m) winch line can handle logs up to 2000 lb (907.2 kg) and can be used to lift the log onto the feed table.



Engine options to fit your needs. With two Cummins diesel engine options providing 85 hp (63.4 kW) or 110 hp (82 kW), contractors have the ability to choose an appropriate horsepower option based on their jobsite. A steel engine enclosure helps provide additional durability.

Brush Chipper



BC1200XL Specifications

General

Weight (with winch): 5600 lb (2540.1 kg)
Weight (without winch): 5325 lb (2415.4 kg)
Transport length: 14' (4.3 m)
Width: 79" (200.7 cm)
Height: 103" (261.6 cm)

Engine Options

Make/Model: Cummins QSB3.3 Turbo Tier 3
Horsepower: 110 hp (82 kW)
Max torque: 304 ft-lb (412.2 Nm) @1600 rpm
Fuel type: Diesel
Number of cylinders: 4
Cooling medium: Liquid

Make/Model: Cummins B3.3TAA Turbo Tier 3
Horsepower: 85 hp (63.4 kW)
Max torque: 215 ft-lb (291.5 Nm) @1600 rpm
Fuel type: Diesel
Number of cylinders: 4
Cooling medium: Liquid

Capacities

Fuel tank: 25 gal (94.6 L)
Hydraulic tank: 12 gal (45.4 L)

Cutting System

Drum size: 20" dia. X 20" (50.8 cm dia. x 50.8 cm) wide
Speed: 2000 rpm
Knives: Two A8 chipper steel
Shear bar: Four useable edges

Feed/Discharge System

Infeed throat/feed capacity: 13.3" x 17"
(33.7 cm x 43.2 cm)
Infeed opening: 52" x 32" (132.1 cm x 81.3 cm)
Feed table length: 30.1" (76.5 cm)
Feed table height: 32" (81.3 cm)
Feed roller style: Dual horizontal offset
Infeed rate: 0 fpm – 122 fpm (0 m/min – 37.2 m/min)

Chassis

Frame: 7" x .25" (17.8 cm x .6 cm) Z-channel
Tires (option 1): ST235/80/R16 Load Range E
Tires (option 2): ST285/75/R16 Load Range E
Axle/Suspension: 7000 lb (3175.2 kg) rubber torsion
Electric brakes with breakaway switch

Electrical

System voltage: 12 V
Lights: Brake, turn, tail, license, side indicators



A clutchless PTO system reduces premature wear to the belt-drive system by preventing high-speed engagement of the cutter drum. The throttle is integrated with the belt drive to help ensure the PTO can be engaged only while the engine is at low speed.



The 3-year / 3,000-hour extended limited warranty on drum housings, cutter drums, shaft, and ring feeder hubs offers you peace of mind, in addition to the 1-year / 1,000-hour Vermeer equipment limited warranty.

The Vermeer dealer network: Reliable support, all over the world.



With nearly 200 locations across the globe - you're never far from an independent, authorized Vermeer dealer. Our dealers are in place to support your success with product expertise that's second to none.



When you need service, you can count on your local Vermeer dealer. With multiple locations, remote service trucks, and factory-offered technician training, your local Vermeer dealer offers reliable service that keeps your equipment running.



Vermeer parts are designed and manufactured to original specifications, so whether they're new parts or replacement parts, they'll live up to the Vermeer name.



Vermeer EMEA
(Europe, Middle East, Africa and CIS)
P.O. Box 323
4460 AS Goes
the Netherlands
Phone: +31 113 272700
Fax: +31 113 272727

Vermeer Corporation
1210 Vermeer Road East
P.O. Box 200
Pella, Iowa 50219 U.S.A.
Phone: (641) 628-3141
Fax: (641) 621-7773
International fax: +1 (641) 621-7730
www.vermeer.com

Vermeer Asia Pacific
48 Toh Guan Road East
#01-105 Enterprise Hub
Singapore 608586
Phone: +65 6516 9560
Fax: +65 6515 9218

Call toll-free 1-888-VERMEER
1-888-837-6337 (USA only)

Building Industry Alliances to Serve You Better.

Vermeer has forged strong strategic alliances with tree-industry giants that include Sherrill Incorporated and ArborMaster Training. These alliances ensure that top-quality industry support is the standard at Vermeer dealerships. Membership with the NAA and ISA helps Vermeer stay in touch with the customers it serves and the issues they face.



Equipment shown is for illustrative purposes only and may display optional accessories or components. Please contact your local Vermeer dealer for more information on machine specifications. Vermeer Corporation reserves the right to make changes in engineering, design and specifications; add improvements; or discontinue manufacturing at any time without notice or obligation.

Vermeer and Vermeer logo are trademarks of Vermeer Manufacturing Company in the U.S. and/or other countries.
CAT is a trademark of Caterpillar, Inc. ArborMaster Training is a trademark of ArborMaster. Sherrill is a trademark of Sherrill Incorporated.
© 2010 Vermeer Corporation. All Rights Reserved.

EXHIBIT B

Axle/Tires/Wheels - Section 2

BC1200XL Brush Chipper

Floatation Wheel & Tire Fig 2-3

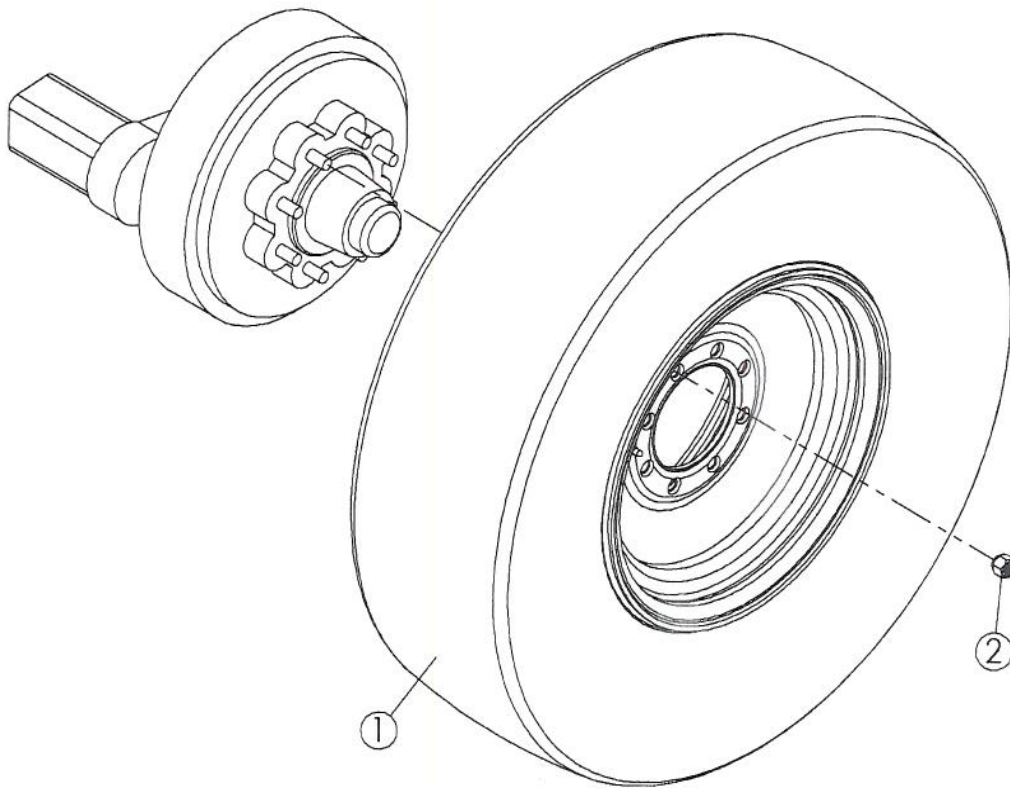

Floatation Wheel & Tire Fig 2-3

REF. NO.	*	PART NO.	DESCRIPTION	QTY.	REMARKS
1		163647422	FLOTATION - WHEEL ASSEMBLY	2	
		163647421	FLOTATION TIRE-LT285/75R16	1	each
		163647345	WHL-16"X 8 XCX SILVER,8 ON 6.5";5/8" STD; 1/2 OFFSET	1	each
		2250001	STEM- TR415 DILL VALVE	1	each
2		123306007	WHEEL NUT-9/16-18 UNF	9	

EXHIBIT C

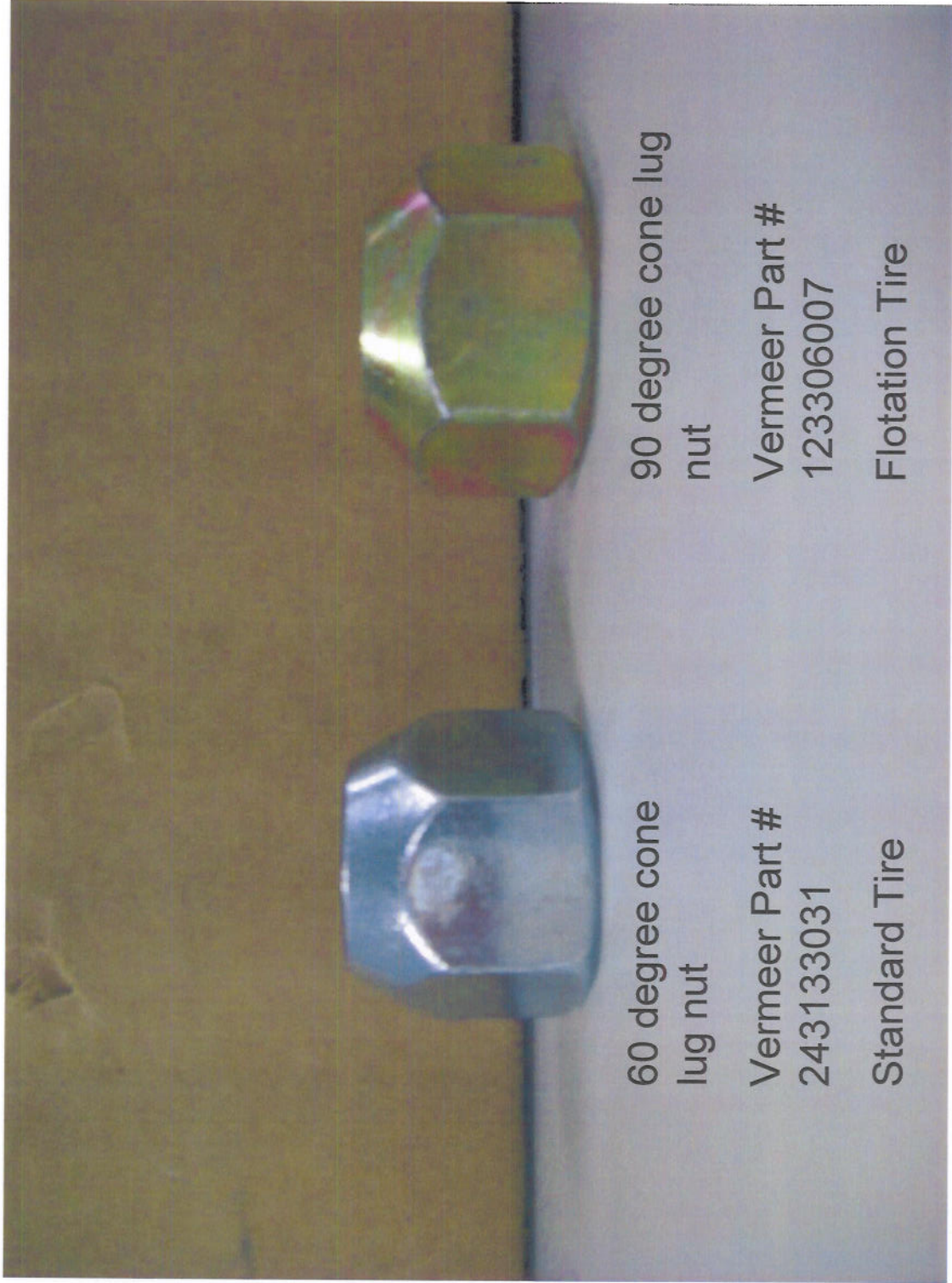

60 degree cone
lug nut

Vermeer Part #
243133031

Standard Tire

90 degree cone lug
nut

Vermeer Part #
123306007

Flotation Tire