



**TO:** All Mazda Dealership General Managers, Service Managers, and Parts Managers

**DATE:** December 2010

**SUBJECT:** 2009-2010 Mazda5 Fuel Pump Connector Safety and Emission Recall 6110K

Mazda Motor Corporation has decided that a defect which relates to motor vehicle safety exists in certain 2009-2010 Mazda5 vehicles, produced from June 29, 2009 through April 28, 2010.

On certain Mazda5 vehicles, water may not be removed completely from the harness connector of the fuel pump due to variations in the fuel tank leak check process performed before vehicle assembly. As a result, the connector pin may corrode, potentially causing the pin to break which can lead to an inoperative fuel pump, engine stall and the inability to restart the engine.

**Owners of affected vehicles will be notified by first class mail beginning December 22, 2010.**

This package contains important information about Safety and Emission Recall 6110K:

Attachment I	Dealer Service and Parts information
Attachment II	Repair procedure
Attachment III	Owner notification letter

**Important Emission Notice:** California Department of Motor Vehicles, Vermont Department of Motor Vehicles, and the Commonwealth of Massachusetts, in conjunction with the California Air Resources Board and the Environmental Protection Agency for the State of Massachusetts and Vermont, have implemented the Registration Renewal/Recall Tie-In Program, which requires the completion of Emission Recalls prior to registration renewal. Mazda dealers must provide customers a *Vehicle Emission Recall – Proof of Correction Certificate* upon completion of the recall. Instruct customers to keep the certificate until needed for registration renewal.

**Important Safety Notice:** The National Traffic and Motor Vehicle Safety Act prohibits the delivery of any subject vehicle without performing the necessary repair for defects or failures. Failure to perform applicable recalls before delivery can result in extensive dealer fines and penalties from the Federal Government. Therefore, you must complete this recall for all affected vehicles in your inventory prior to delivery.

To help you effectively perform this recall, Mazda has developed the following resources:

1. Service and Parts recall instructions follow (Attachment I), were e-mailed to your Service Department, and are also available on eMDCS and the MS3 (Mazda Service Support System) websites.
2. Inspection and repair procedures follow (Attachment II), and are also available on the MS3 (Mazda Service Support System) and eMDCS websites.
3. We recommend using the Recall Reminder Report available in Web Reporting to encourage customers to come in for the recall (with recall reminder postcards). Dealers may use such owner information for the sole purpose of conducting and performing this recall, and for no other purpose. **Using it for marketing activities is strictly prohibited and could subject your dealership to serious fines.** The information in this report is protected by state privacy and other applicable laws regarding disclosure of personal and/or confidential, restricted or blocked information. It is the dealer's responsibility to protect the confidentiality of owner records and prevent the release of information to other parties.
4. For technical assistance, call the Technical Assistance Hotline at (888) 832-8477, Option 3 for English speaking Hotline Specialist, option 4 for Spanish speaking Hotline Specialist.
5. For warranty questions, contact the Warranty Hotline at (877) 727-6626 Option 3.

Please make certain the appropriate personnel in your dealership are aware of these resources and are familiar with the details of this recall before responding to customer inquiries.

We apologize for any inconvenience this recall may cause you and your customers. Your understanding and support in carrying out this campaign is greatly appreciated.

Sincerely,

Kiyoshi Yagi  
Director, Technical Services Division

Mazda North American Operations

**ATTACHMENT I - DEALER INFORMATION**  
**Safety & Emission Recall 6110K**

**CONDITION OF CONCERN**

On certain Mazda5 vehicles, water may not be removed completely from the harness connector of the fuel pump due to variations in the fuel tank leak check process performed before vehicle assembly. As a result, the connector pin may corrode, potentially causing the pin to break which can lead to an inoperative fuel pump, engine stall and the inability to restart the engine.

**SUBJECT VEHICLES**

Model	VIN Range	Build Date Range
2009-2010 Mazda5	JM1 CR**** 90 357301 – 359646 JM1 CR**** A0 359647 – 382263	From June 29, 2009 through April 28, 2010

Note: The asterisk symbol “\*” can be any letter or number.

**OWNER NOTIFICATION**

Mazda will notify U.S. owners by first class mail beginning **December 22, 2010**.

**PARTS INFORMATION**

Description	Part Number	Quantity	Notes
Fuel Filter Body	LFB6-13-ZE0	1	When necessary
Short Cord Kit	CEY1-67-SH0A	1	When necessary Includes: short cord, PVC cover, heat shrink tubes, harness anchors and pad
Gasket	GN3A-42-166	1	When necessary
Campaign Label	9999-95-065A-05	1=50 labels	Obtain in MStore (no charge)

**Orders will only be accepted through the Dealer Assistance Group (DAG) website “eMail Inquiries” page as follows:**

1. Go to the Dealer Assistance Group web page, or click on the link below:  
[https://portal.mazdausa.com/dealershome/service\\_parts/dag/index.htm](https://portal.mazdausa.com/dealershome/service_parts/dag/index.htm)
2. Click on “eMail Inquiries” at the top of the screen
3. Click on “Corporate Dealer Assistance Group”
4. Fill in the following required fields:
  - First name
  - Last name
  - Phone Number
  - Email Address
  - MNAO Sales Order: (enter the PO number you would like to use for the order or simply enter N/A)
  - Part Number
  - Techline Ref #: (Leave Blank)
  - Comments: Enter the VIN(s) of the vehicle(s) requiring the part(s). VIN is required for the order to be placed. Also, if you require more than one part number, enter the additional part numbers here.

Once all the fields have been entered, click on the “Submit” button. This sends an email to DAG. Your order will be placed as a CSO order with the freight charge waived, and you will

**ATTACHMENT I - DEALER INFORMATION**  
**Safety & Emission Recall 6110K**

be emailed confirmation of the order and the order number. You do not need to call DAG once this email request has been sent.

For parts ordering assistance, contact the Corporate Dealer Assistance Group at (877) 727-6626, option 2.

**WARRANTY CLAIM PROCESSING INFORMATION**

	<b>Inspection Only</b>	<b>Inspection &amp; Replacement of Fuel Filter Body and Short Cord</b>
Warranty Type	R	R
Symptom Code	99	99
Damage Code	99	99
Process Number	<b>AA035A</b>	<b>AA035B</b>
Part Number Main Cause	LFB6-13-ZE0	LFB6-13-ZE0
Quantity	0	1
Related Part Number / Quantity	-	CEY1-67-SH0A / 1 GN3A-42-166 / 1
Labor Operation Number	XXF4WXRX	XXF4XXRX
Labor Hours	0.6 hrs	1.1 hrs

**RENTAL CAR INFORMATION**

Mazda will authorize rental and service loaner vehicles on a limited basis. We are requesting dealer understanding and partnership regarding rental and loaner vehicle utilization. ***Please make every effort to utilize alternative transportation solutions in place of rental use.***

**Rental Vehicle Quick Reference Chart**

<b>Condition</b>	<b>Parts Available</b>	<b>Parts not Available from Mazda</b>
A. Customers returning vehicles for recall	Rental is covered if customer has no alternative means of transportation (1 day limit)	Rental is covered until parts arrive if customer refuses to drive their vehicle, and customer has no alternative means of transportation
B. Experienced recall symptoms	Rental is covered until repair completed if customer has no alternative means of transportation	

**ATTACHMENT I - DEALER INFORMATION**  
**Safety & Emission Recall 6110K**

**Rental Car Warranty Claim Information**

Please submit rentals on a separate claim problem number as follows:

	<b>Rental Agency Vehicle</b>	<b>Dealer Loaner Car Fleet Vehicle</b>
Warranty Type Code	A	A
Symptom Code	99	99
Damage Code	99	99
Part Number Main Cause	<b>5555-61-10KR</b>	<b>5555-61-10KL</b>
Part Quantity	0	Number of days loaner car was used Mazda pays \$35.00/day
Labor Operation Code	MM024XRX	MM024XRX
Labor Hours	0.0	0.0
Sublet – Rental Car		
Sublet Invoice Number	Number from Rental Invoice or Dealer Purchase Order	
Sublet Type Code	Enter “Z9” (other)	
Sublet Amount	Up to \$30.00 per day for the number of days customer had rental car	
Sublet Text	Number of days rental car was supplied to customer	

Rental expenses exceeding the two-day limit will require prior DSM Authorization, as outlined in the Mazda Rental Car Reimbursement Program policy.

**VERIFY THE VEHICLE NEEDS THE RECALL**

1. Verify the vehicle is within the following ranges:

<b>Model</b>	<b>VIN Range</b>	<b>Build Date Range</b>
2009-2010 Mazda5	JM1 CR**** 90 357301 – 359646 JM1 CR**** A0 359647 – 382263	From June 29, 2009 through April 28, 2010

If the vehicle is within the above range, go to step 2.

If vehicle is not within the above range, return it to inventory or the customer.

2. Perform a Warranty Vehicle Inquiry using your eMDCS System and inspect vehicle for an Authorized Campaign Label **RECALL 6110K** attached to the vehicle's hood or bulkhead.

**eMDCS System - Vehicle Status Inquiry Results**

<b>If eMDCS displays:</b>	<b>Campaign Label is:</b>	<b>Action to perform:</b>
<b>RECALL 6110K</b>	Present	Contact the Warranty Hotline at (877) 727-6626, option 3, to update vehicle history
	Not present	Proceed to “REPAIR PROCEDURE”.
<b>RECALL 6110K CLOSED</b>	Present	Return vehicle to inventory or customer.
	Not present	Complete a label and apply to vehicle's hood or bulkhead.
<b>RECALL 6110K is not displayed</b>	Does not apply	Recall does not apply to this vehicle. Return vehicle to inventory or customer.

**Note:** Verify the recall number as the vehicle may have multiple labels.

**REPAIR PROCEDURE**

Please refer to Attachment II.

## MAZDA5 FUEL PUMP CONNECTOR VOLUNTARY SAFETY AND EMISSION RECALL 6110K 6110K

**A. VEHICLE INSPECTION PROCEDURE**

- Verify that the vehicle is within the following ranges:
  - Year Range (2009-2010) Model (Mazda5 vehicles) Build Date Range (From June 29, 2009 through April 28, 2010)
  - VIN Range: (2009: JM1 CR\*\*\*\* 90 357301 – 359646; 2010: JM1 CR\*\*\*\* A0 359647 – 382263).
  - If the vehicle is within the above range, proceed to step 2.
  - If the vehicle is not within the above range, return the vehicle to the customer or inventory.
- Perform a Warranty Vehicle Inquiry using your eMDCS System and inspect vehicle for a Campaign Label **6110K** attached to the vehicle's hood or bulkhead. Refer to eMDCS System - Warranty Vehicle Inquiry Results table below.

**NOTE:** Verify Recall number as the vehicle may have multiple Recalls.

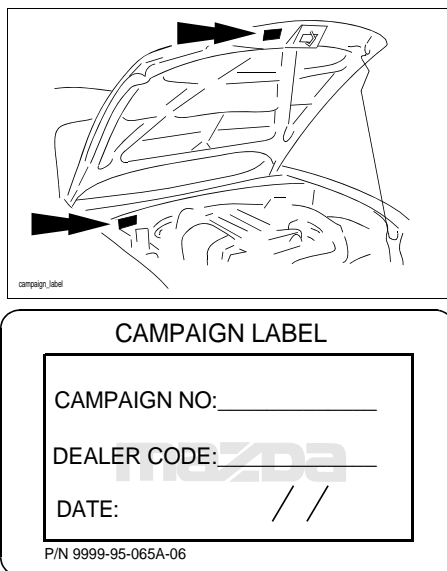

1326b

**eMDCS System - Warranty Vehicle Inquiry Results**

If eMDCS displays:	Campaign Label is:	Action to perform:
6110K OPEN	Present	Contact the Warranty Hotline at (877) 727-6626 to update vehicle history.
	Not present	Proceed to "REPAIR PROCEDURE OUTLINE".
6110K CLOSED	Present	Return vehicle to customer.
	Not present	Proceed to "F. CAMPAIGN LABEL INSTALLATION".
6110K is not displayed	Does not apply	Recall does not apply to this vehicle. Return vehicle to customer.

## B. REPAIR PROCEDURE OUTLINE

1. Check the condition of the connector terminals (A) at the fuel pump (B).
  - If there is no corrosion, no repair is required.
  - If there is corrosion, repair the harness with the short cord kit and replace the the fuel filter body with a new one.

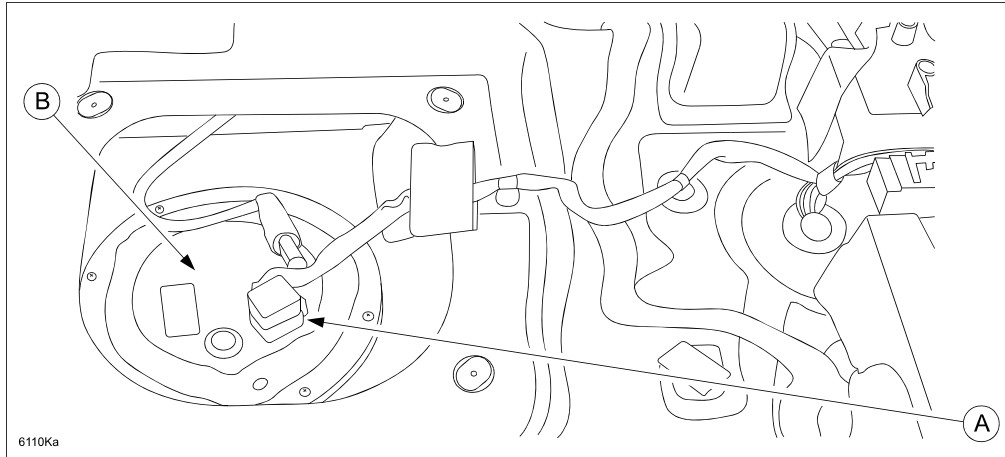

Connector of Body Side Harness

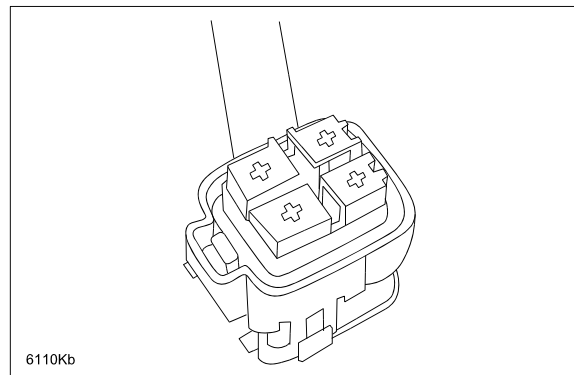

Connector of Fuel Filter Body Side

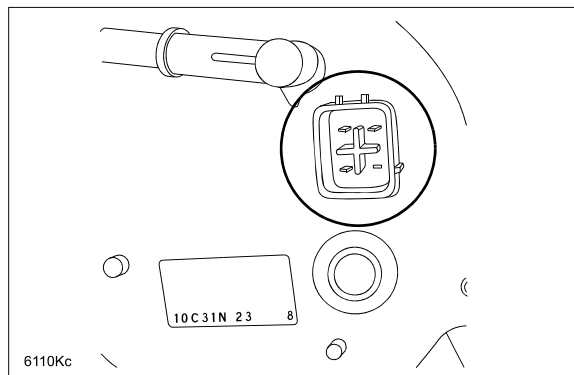



### C. REPLACEMENT PARTS (IF NECESSARY)

Short Cord Kit (CEY1-67-SH0A)

A: Harness Anchors

B: Heat Shrink Tube

C: PVC Cover

D: Short Cord

E: Pad

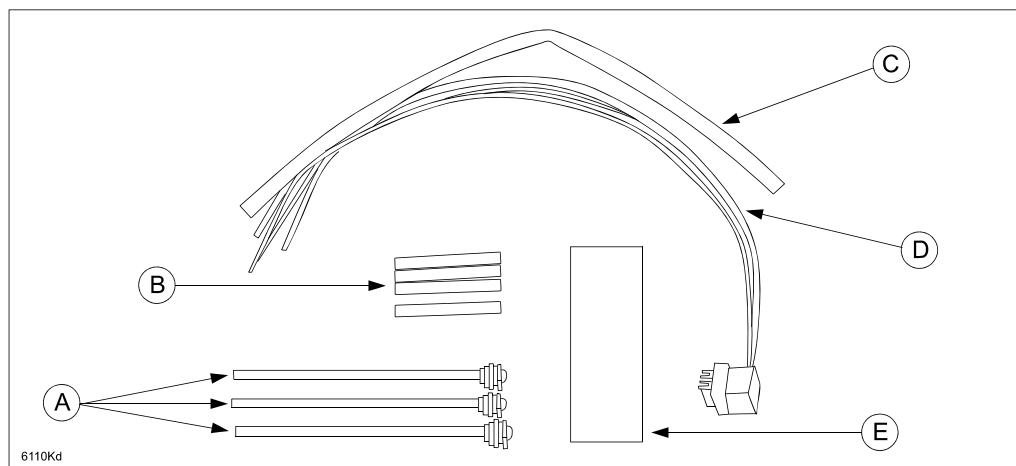

Fuel Filter Body Kit (LFB6 13 ZE0)

A	O-Ring (Large)	F	E-Ring
B	O-Ring (Small)	G	Harness
C	Plastic Ring (Large)	H	Bracket
D	O-Ring (Middle)	I	Spring
E	Plastic Ring (Small)	J	Fuel Filter Body

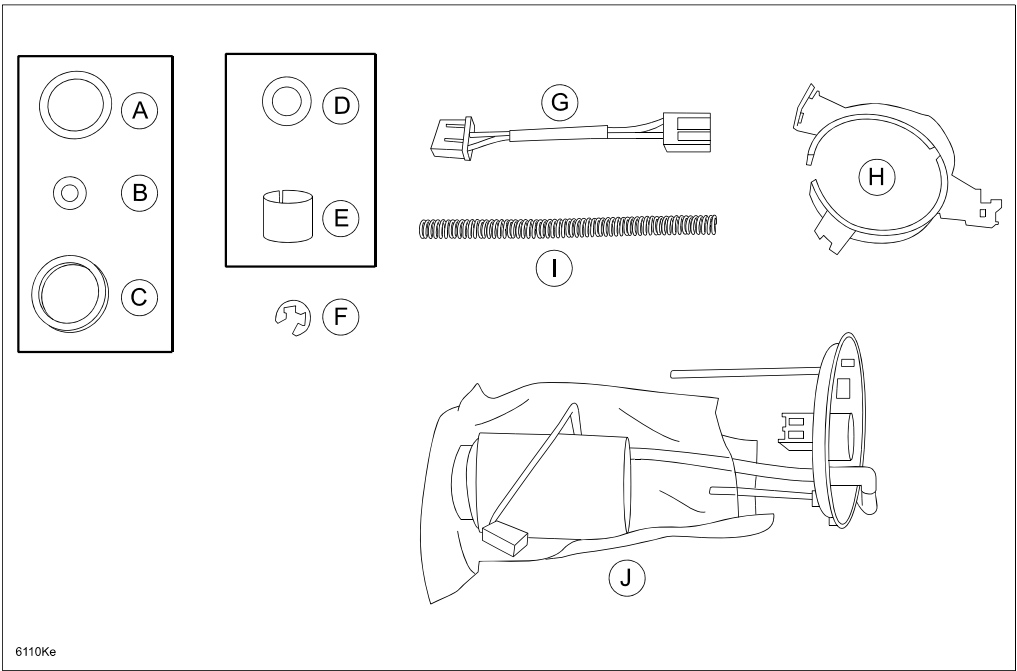

Gasket (GN3A 42 166)

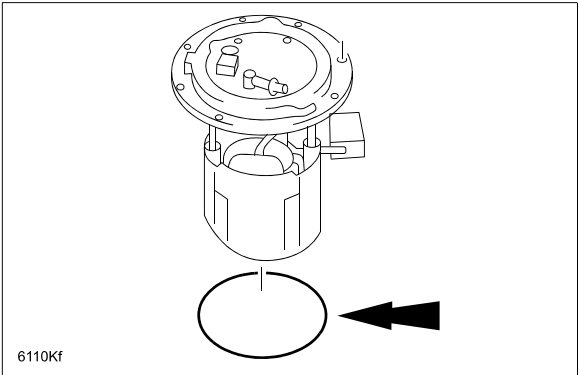

## D. INSPECTION PROCEDURE

1. Remove the battery cover.
2. Remove the negative battery cable.
3. Remove the second row seat.
  - a. Remove the covers (A).
  - b. Remove the bolts (B).

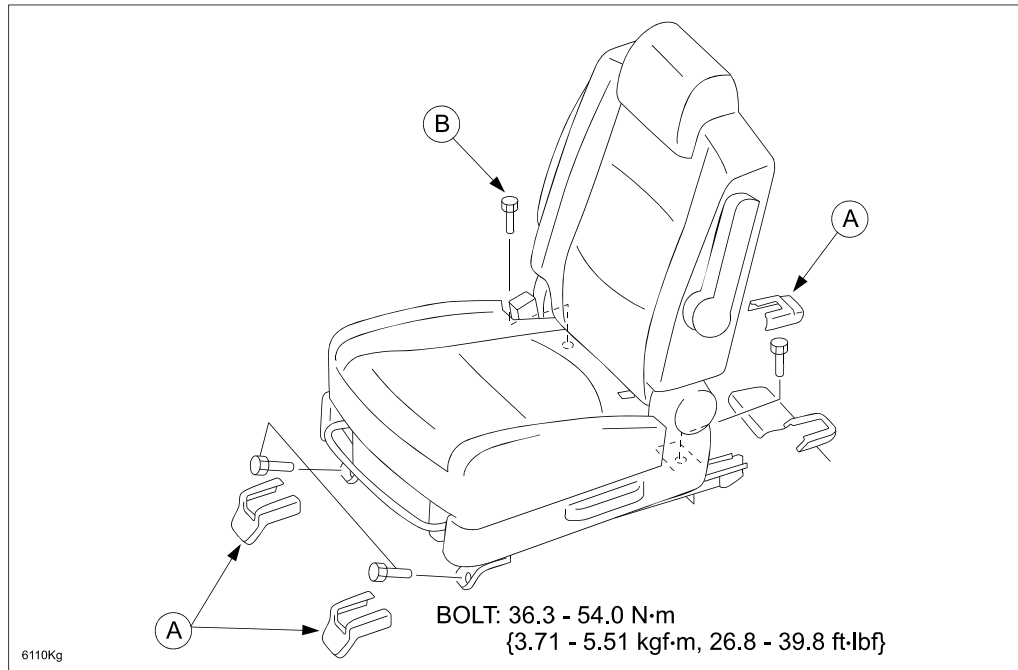

4. Pull the sub-trunk upward to release the clips (A), then remove the sub-trunk (B).

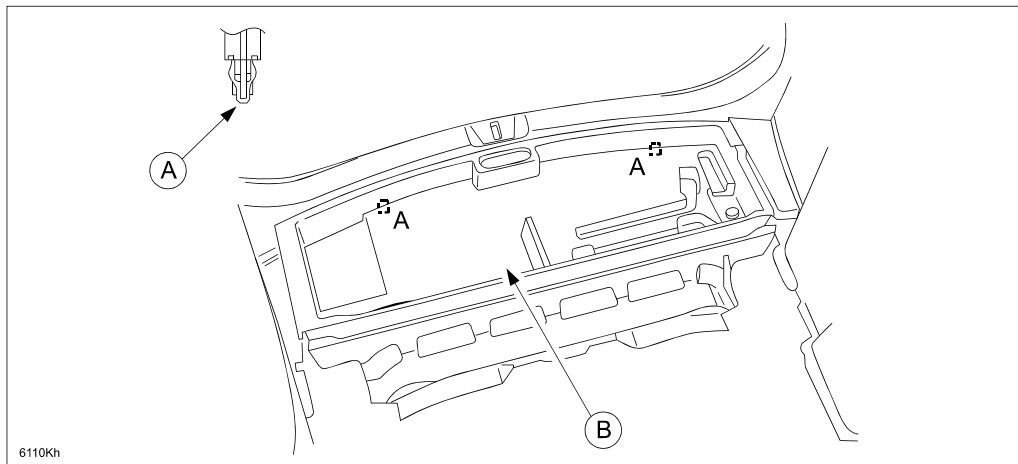

5. Remove the third-row seat.
  - a. Remove the floor covering installation fasteners.

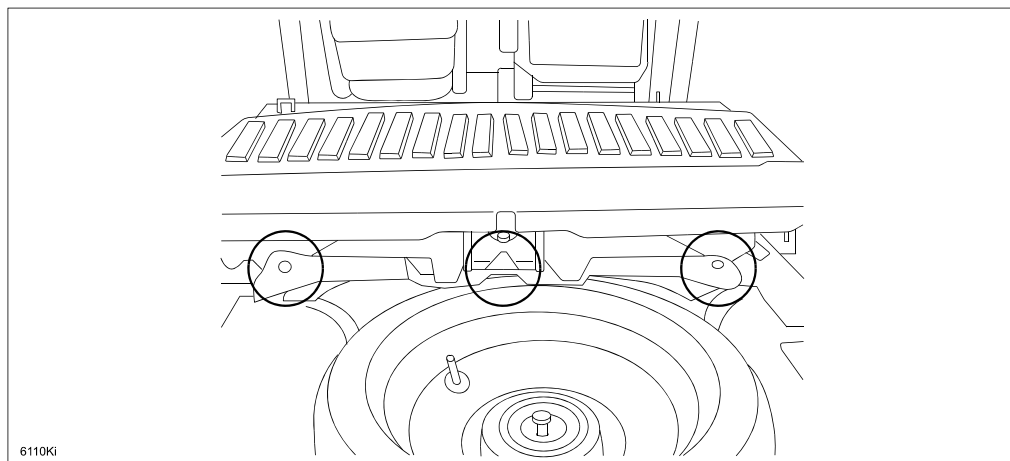

- b. Remove the covers (A).
  - c. Remove the bolts (B), then remove the third-row seat.

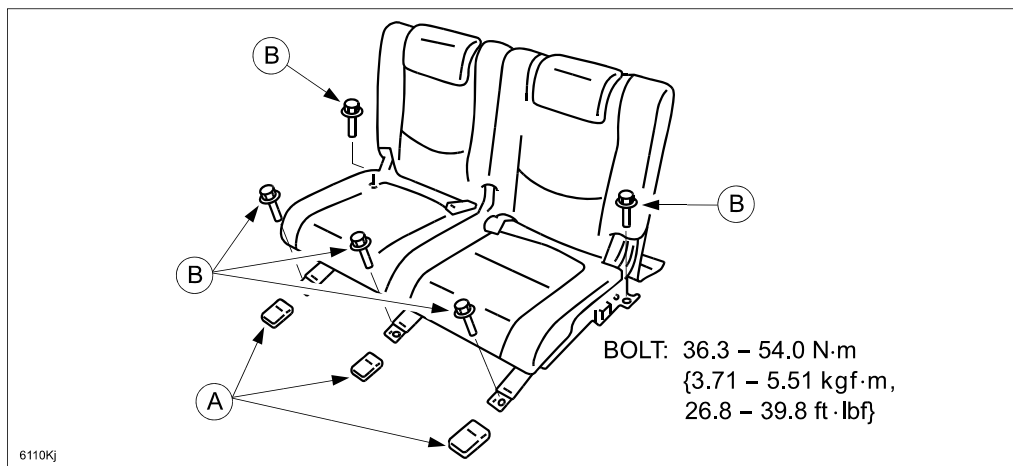

6. Remove the rear scuff plate by pulling up to release the tab (A1) clips (A2, B and C), and pins (D and E).

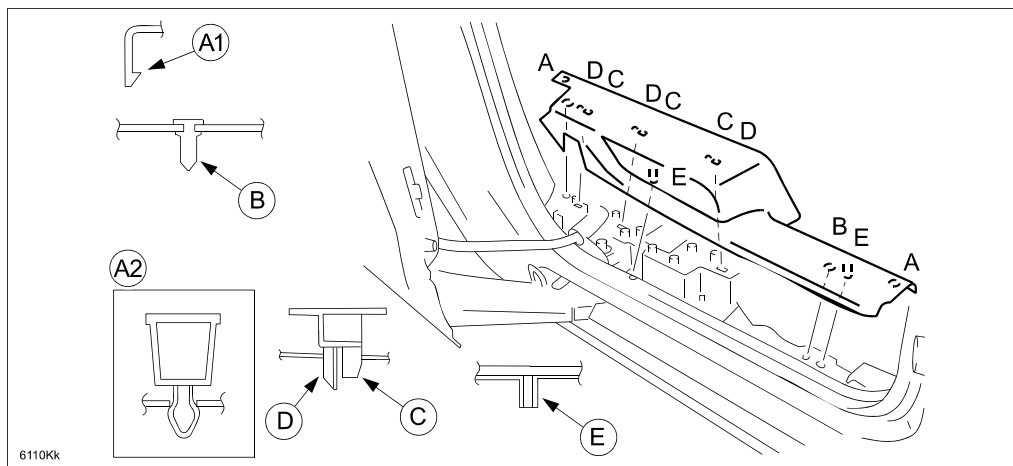

7. Pull the floor covering from the rear towards the front of the vehicle.

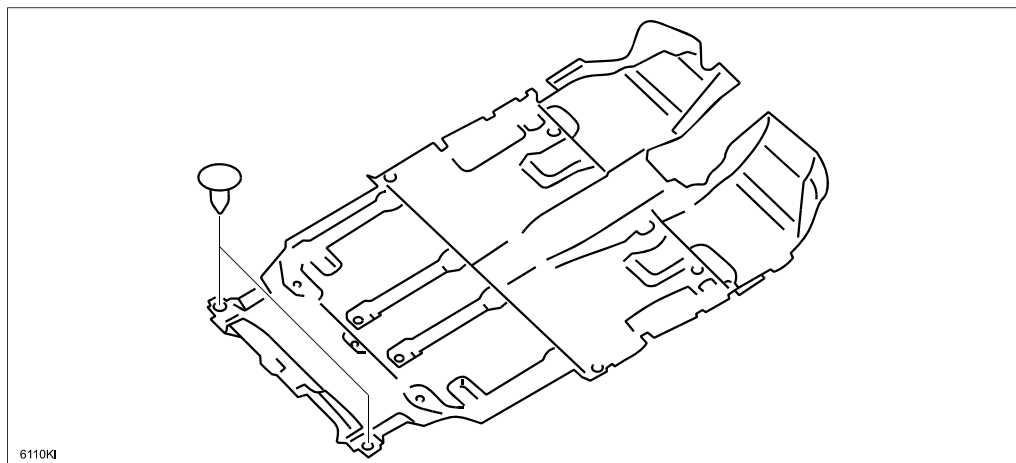

8. Remove the service hole cover.

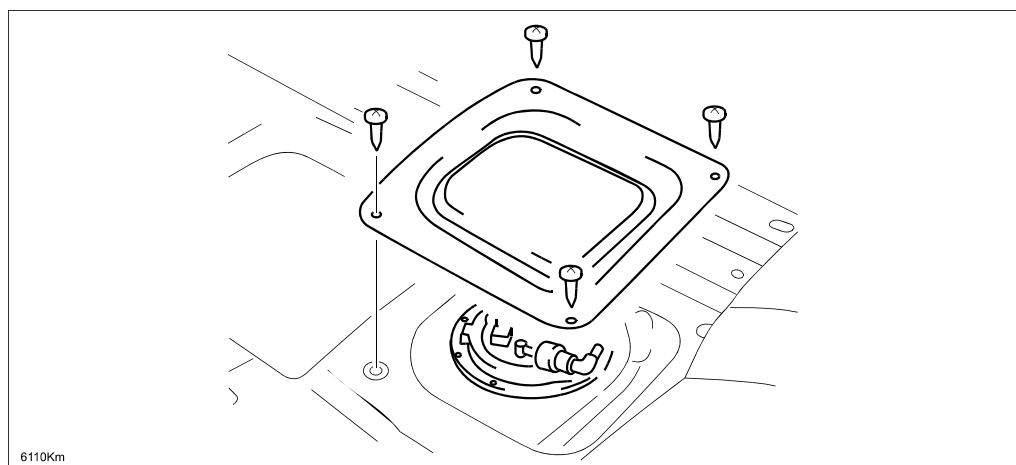

9. Disconnect the fuel pump connector (A) from the fuel filter body (B).

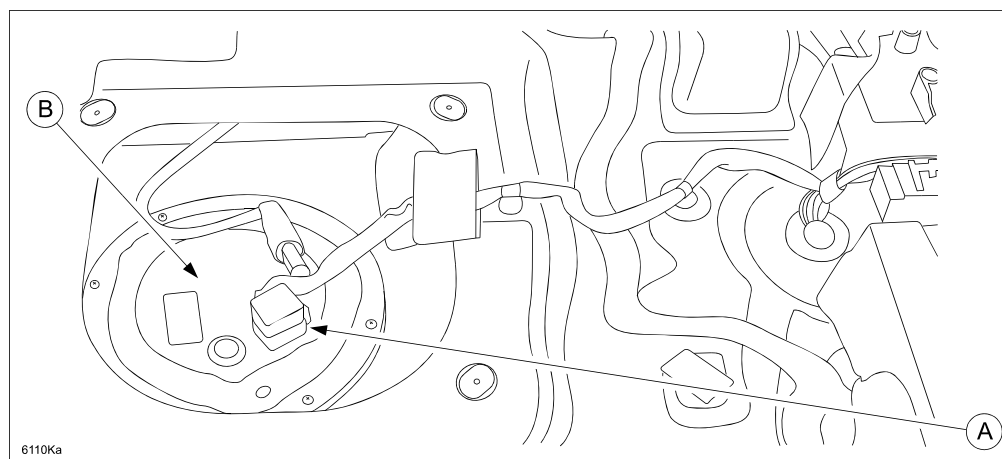

10. Check the condition of the connector terminals of the fuel filter body and the harness.

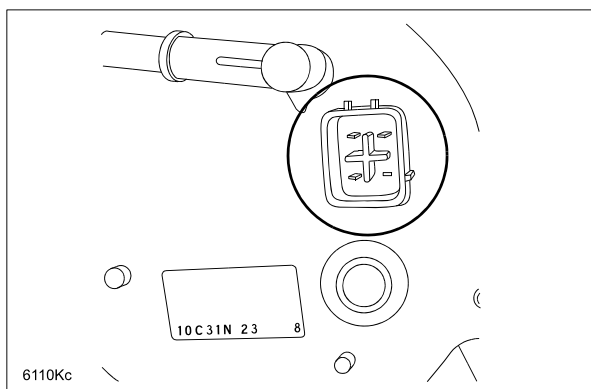
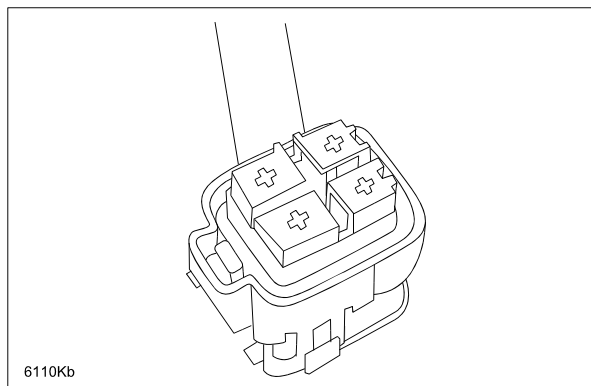

- If there is no corrosion, no repair is required. Install the removed parts.
- If there is traces of water, green rust, whitish powder-like rust, and/or black marks around the terminals, proceed to E. REPAIR PROCEDURE.

Examples of connectors with problems.

Sample 1: Coupler insertion area has green rust and a trace amount of water intrusion.



**ATTACHMENT II**  
**6110K**

Sample 2: No rust or water entry is found, however, whitish powder-like rust is found around the bottom of terminal.

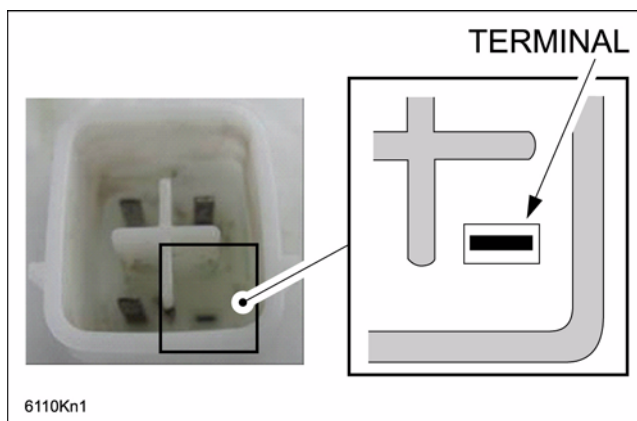

Sample 3: The terminal is broken.

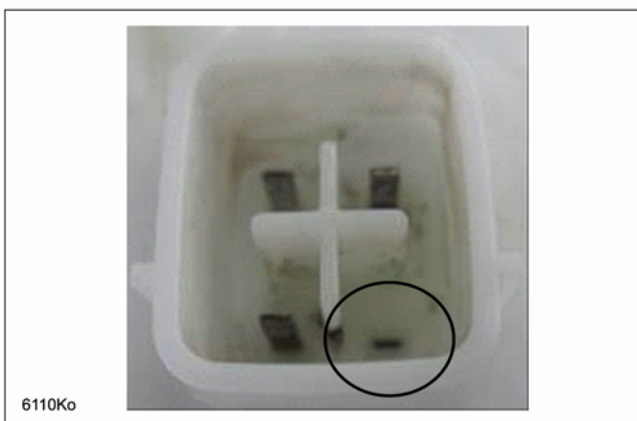

Sample 4: Surface of the connector around the terminal is black.

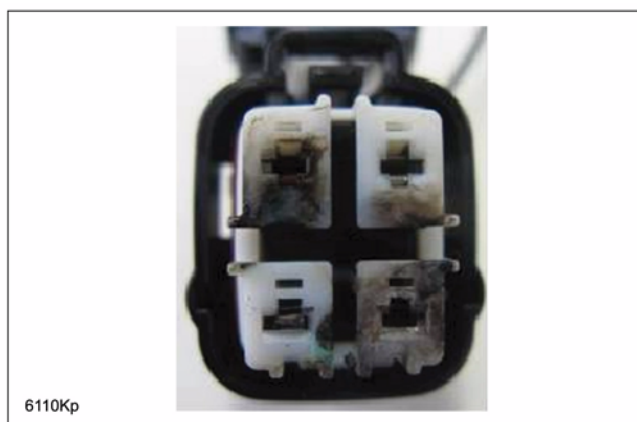

## E. REPAIR PROCEDURE

Repair the harness with the short cord kit :

1. Cut the harness at the base of the second harness anchor from the connector as shown.  
A: Connector  
B: First Harness Anchor  
C: Second Harness Anchor

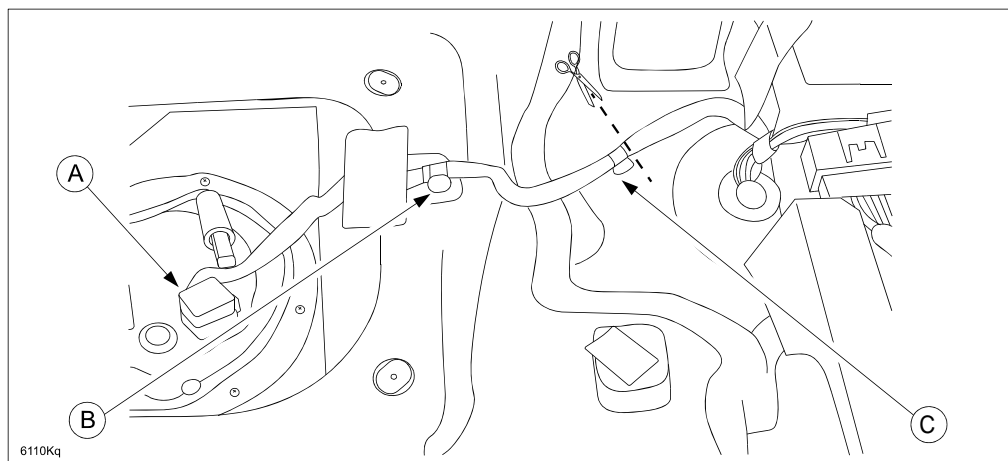

2. Slice the PVC cover on the vehicle side 60-70 mm (2.36 - 2.75 in) from the end to expose the wires.

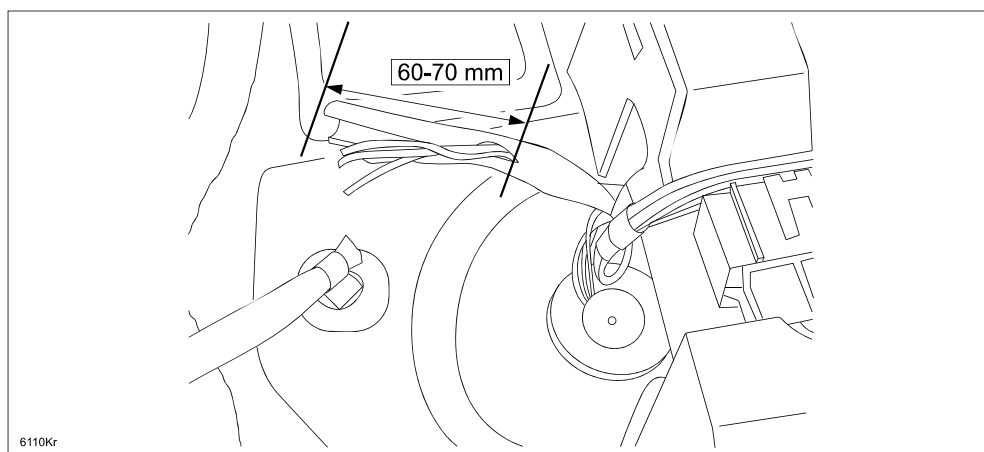



3. Slice the PVC cover in the short cord kit 80-90 mm (3.15 - 3.5 in) from the end.

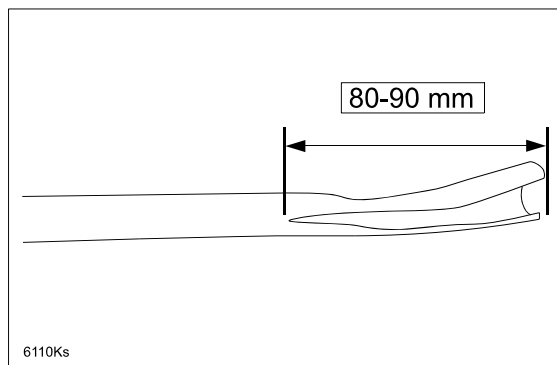

4. Cut the harness of the short cord 400 mm (15.75 in) from the connector.

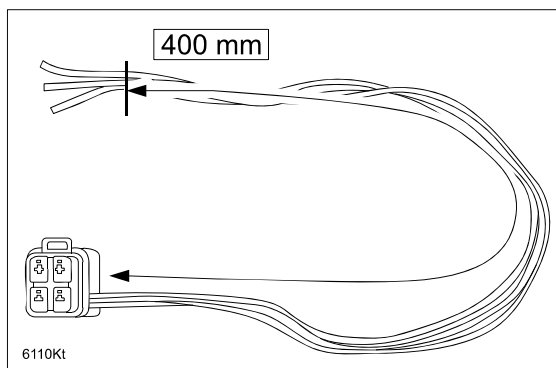

5. Remove about 15 mm (0.6 in) of the covering from the harness wires one by one (vehicle harness side and short cord side)

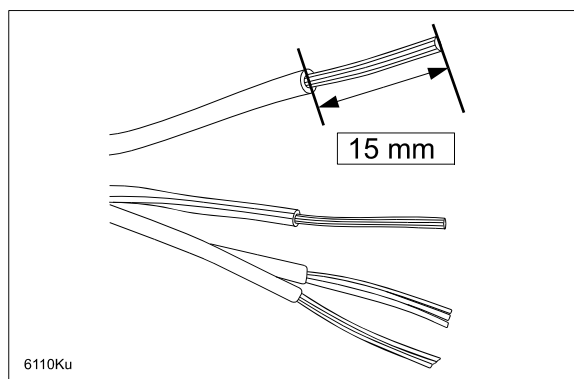

6. Insert the short cord into the PVC cover.

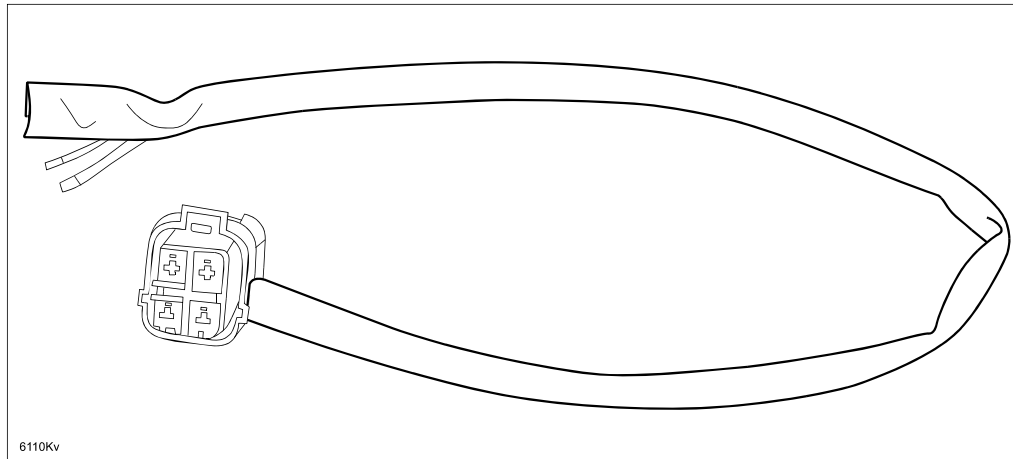

7. Place one heat shrink tube (A) over one wire to be soldered.

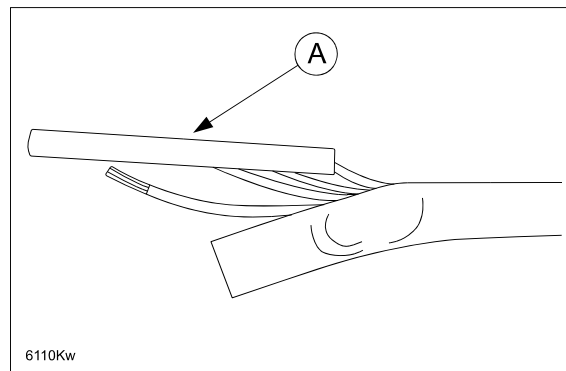

**NOTE:** To prevent the heat shrink tube from shrinking due to the heat generated when soldering, the heat shrink tube (B) must be kept away from the soldering area (C).

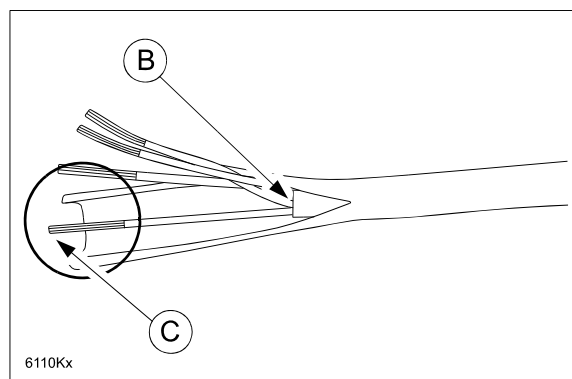

8. Match the color of the wire from the short cord kit to the vehicle harness, then twist the wires together.
- a. Combine the uncoated wires in the center.

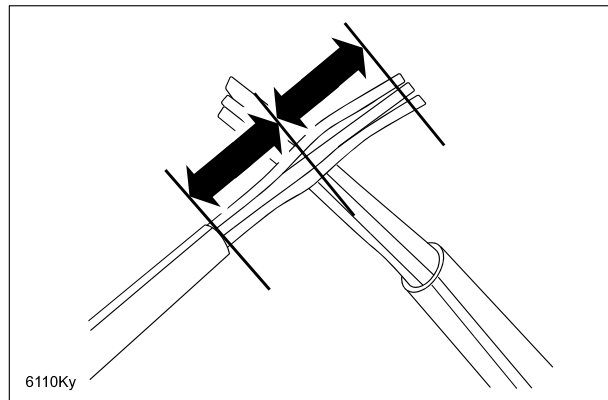

- b. Twist them 2-3 times.

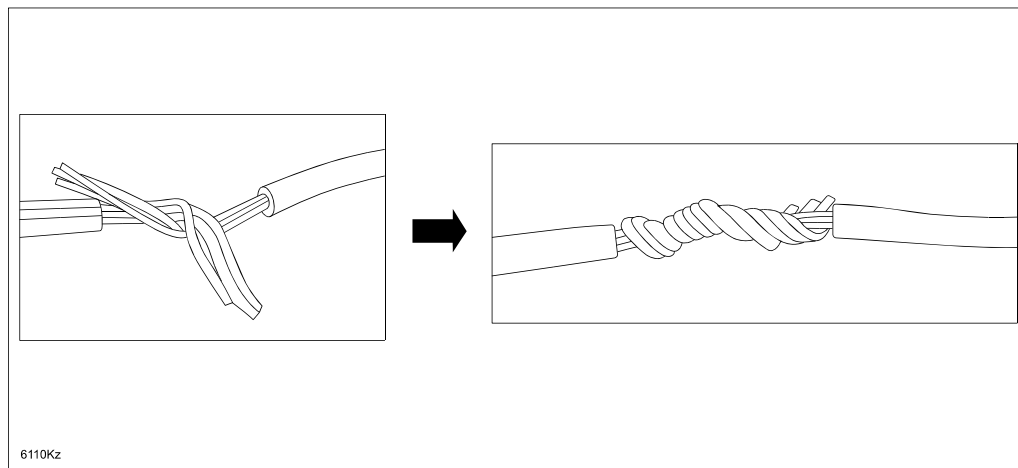

9. Put soldering on the twisted wire area.

**CAUTION:**

- Before starting the work, make sure the soldering iron is fully warmed up and its edge is cleaned with a sponge or rag soaked in water.
- Warm up the wire with the soldering iron and put the wire solder to the heated wire, then spread the solder out among the wires.

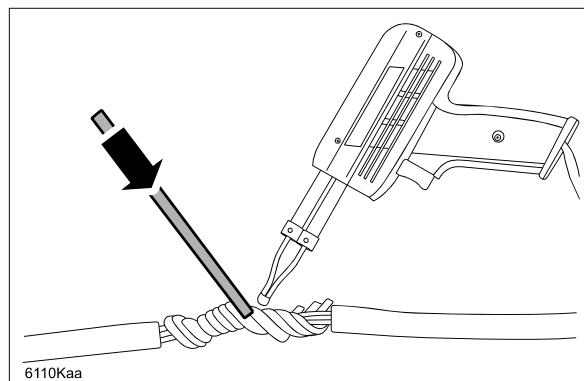

Thoroughly put the soldering to the inside of the wire core.

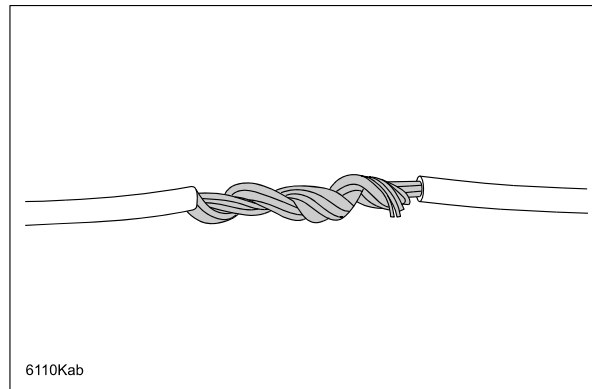

10. Move the heat shrink tube (A) that has been kept away over the soldering area at the center.

**NOTE:** If the tube is moved right after soldering, it may shrink when being moved. Therefore, this process should be done after the soldering spot gets cold.

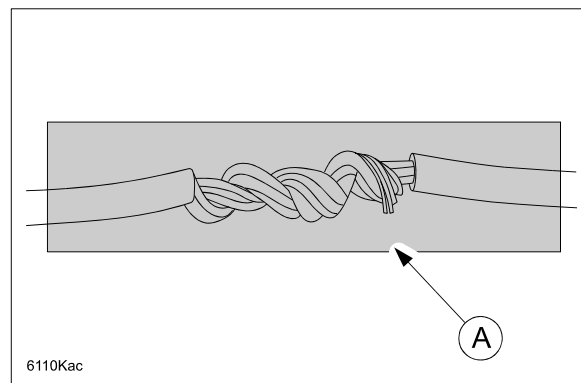

11. Using a heater-drier, apply heated air until the tubing shrinks securely over the wires.

**NOTE:**

- When using a heater-drier, be careful not to heat any other parts.
- Use 100mm (3.94 in) or more distance between the heat shrink tube and heater-drier when applying heated air.

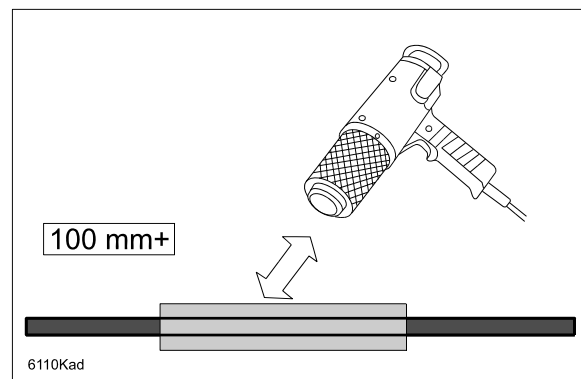

- After shrinkage, make sure the tubes are closely stuck to the wires.

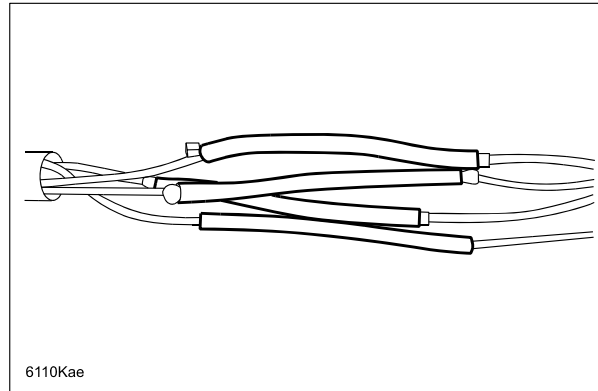

- Warm the wire up until plastic comes out from the edge, but do not touch the plastic right after shrinkage when it is soft.

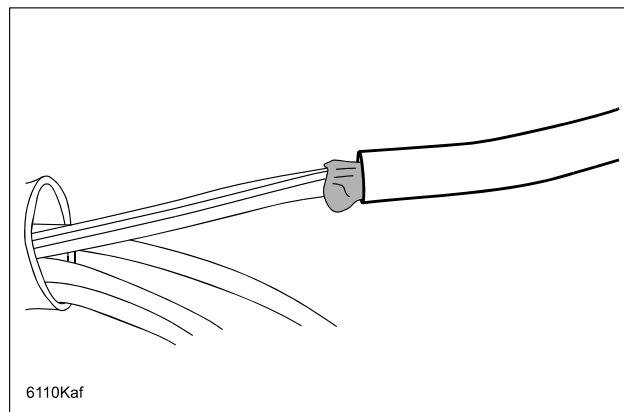

12. Repeat steps 7-11 for each wire.

13. Cover the soldering area with the PVC tube and wrap the tape (A) around the cut.

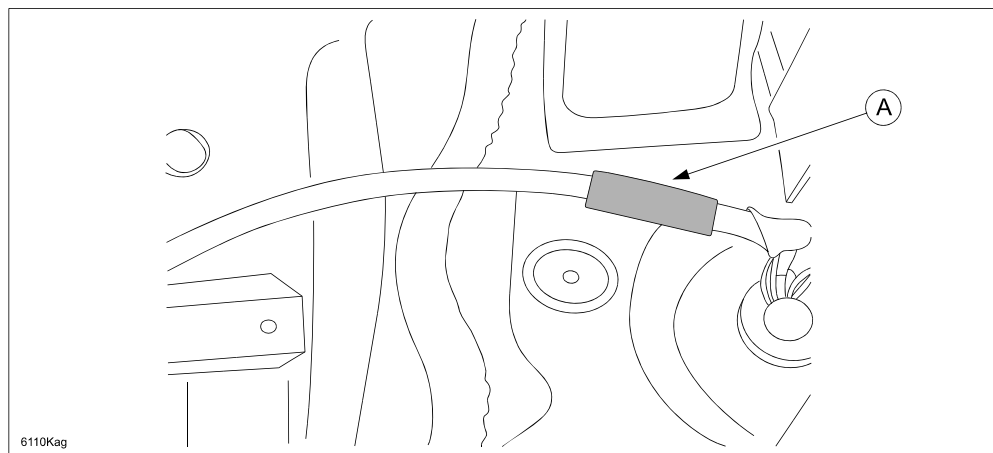

14. Attach the harness anchor while paying close attention to the harness routing. Attach it to the hole to fix the harness anchor on the vehicle side.

**NOTE:** Attach the second harness anchor to the edge of the soldered heat shrink tube (A).

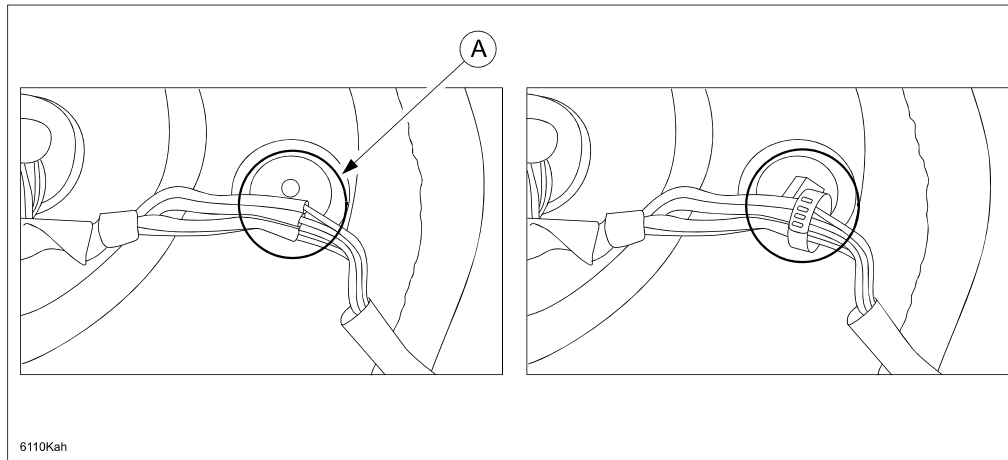

15. Attach the pad (A) to prevent damage to the harness (B) at the service hole area, with the adherent surface towards the harness.
- Place the center line of the pad at the edge of the service hole (C).
  - Attach the harness at 1/4 of the pad.

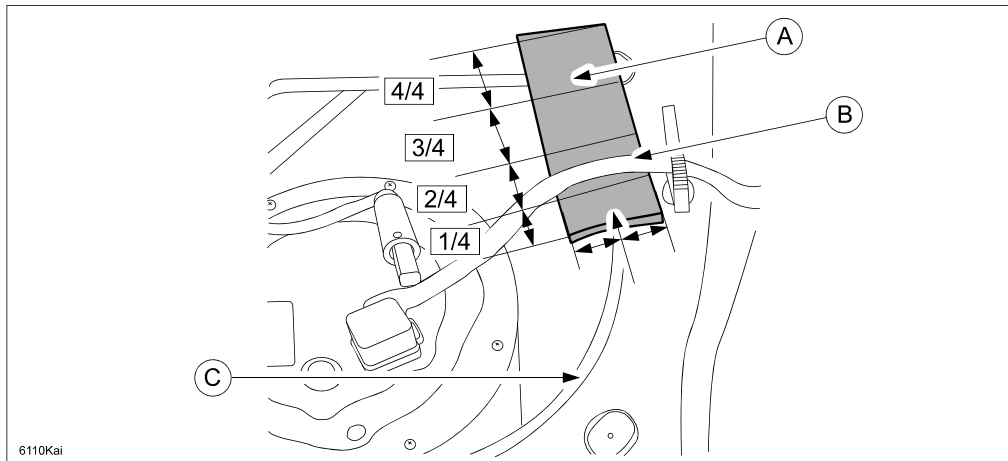

- c. Bend the pad over at the center (A) and attach it.

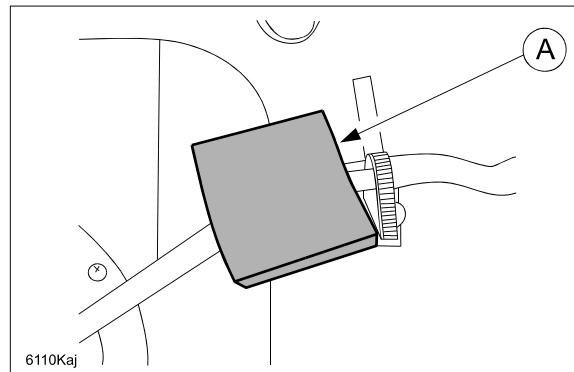

16. Make sure the harness anchor (A) is tightly fixed and cut the extra band off.

**NOTE:** There is one extra harness anchor per kit (3 total).

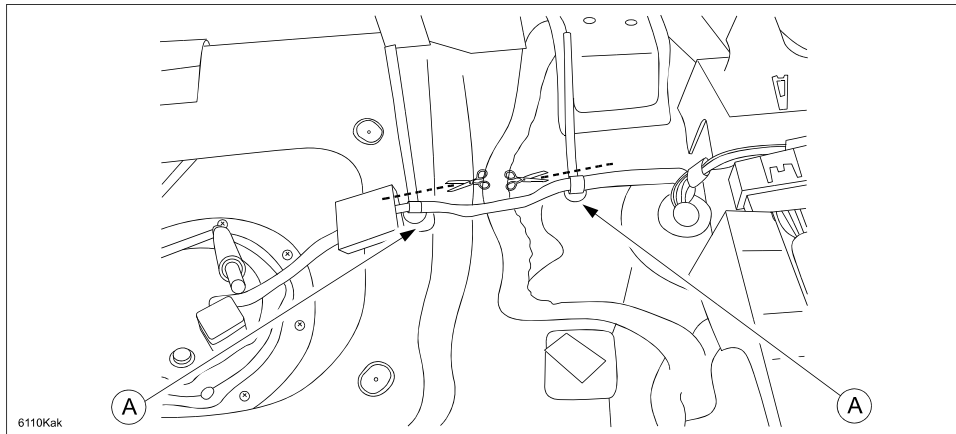

17. Remove the harness connector that has been temporarily connected and conduct "Replacement of the Fuel Filter Body."

**NOTE:** Once the work above is finished, remove the soldering iron and heater-drier from the vehicle because fuel is handled in the following work, which can be dangerous.

**Replacement of Fuel Filter Body:**

**WARNING:**

- Fuel vapor is hazardous. It can easily ignite, causing serious injury or death and damage. Always keep sparks and flames away from the fuel.
- A person charged with static electricity could cause a fire or explosion, resulting in death or serious injury. Before performing work on the fuel system, discharge static electricity by touching the vehicle body.

**CAUTION:**

- If there is foreign material on the connecting area of the quick release connector, it might damage the connector or fuel pipe. To prevent this, disconnect the connector and clean the connecting area before connecting.
- When doing this repair, be very careful about fire and static electricity.

*Replacement Parts for Fuel Filter Body*

Parts with <R> have to be replaced with new ones.

A	Fuel Filter Body <R>	H	E-Ring <R>
B	Spring <R>	I	Harness <R>
C	O-Ring (Small) <R>	J	Bracket <R>
D	O-Ring (Large) <R>	K	O-Ring (Middle) <R>
E	Plastic Ring (Large) <R>	L	Plastic Ring (Small) <R>
F	Pressure Regulator	M	Pump
G	Fuel Filter	N	Lower Case

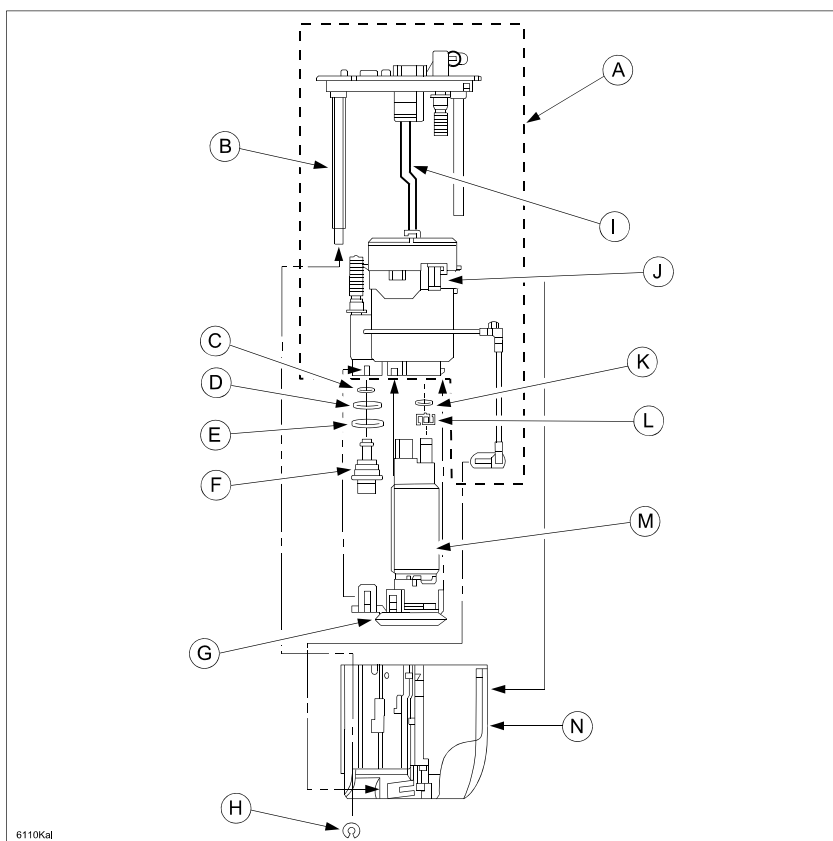



*Procedure*

1. After closing the right sliding door, open the fuel filler cap to reduce the inner pressure of the fuel tank. After reducing the inner pressure, attach the cap and close the lid, then open the right sliding door.

**WARNING:** Fuel line spills and leakage from the pressurized fuel system are dangerous. Fuel can ignite, causing serious injury or death and damage. Fuel can also irritate the skin and eyes. To prevent this, always refer to the complete "Fuel Line Safety Procedure" in the Workshop Manual.

2. Connect the negative battery cable.
3. Start the engine. After the engine stops, repeat cranking a few times and remove the ignition key.
4. Disconnect the negative battery cable again.
5. Touch the lower anchor attachment bolt of the second row seat belt to remove static electricity.

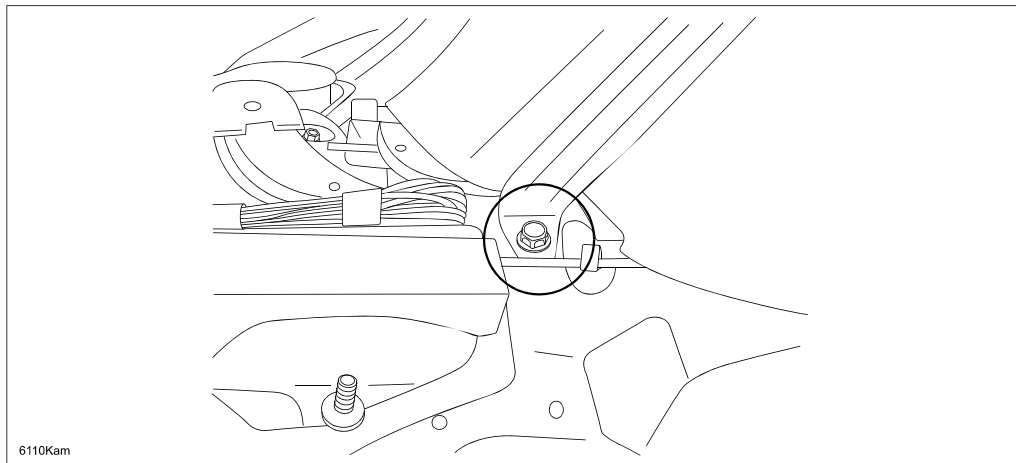

6. Remove the quick connector using SST 49 N013 103A or 49E042 001.

**NOTE:** Absorb any remaining fuel with a shop towel.

A: Screw

B: Quick Connector

C: Gasket

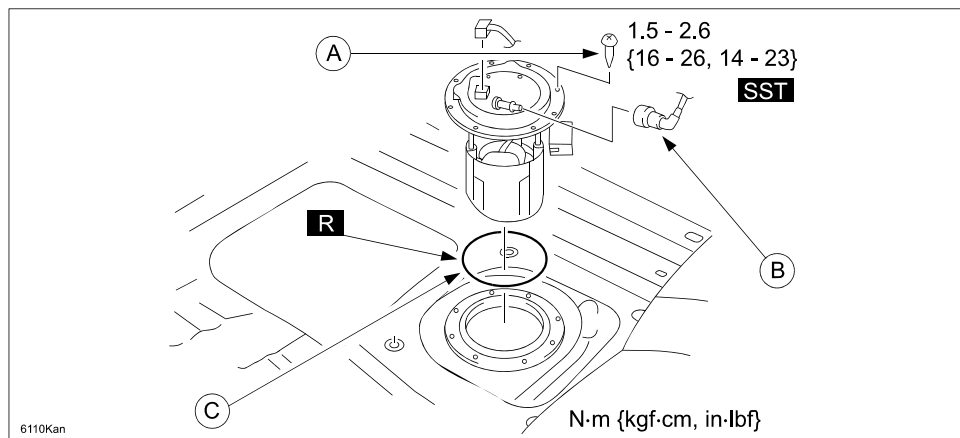

7. Loosen the screws and remove the fuel pump, making sure that the float (D) of the fuel gauge sender unit (E) is not bent.

**CAUTION:**

- Wear safety goggles when working with fuel.
- In order for the fuel remaining in the lower case of the fuel filter body not to overflow inside and outside the vehicle, put the pump into a pan and bring it outside the vehicle.

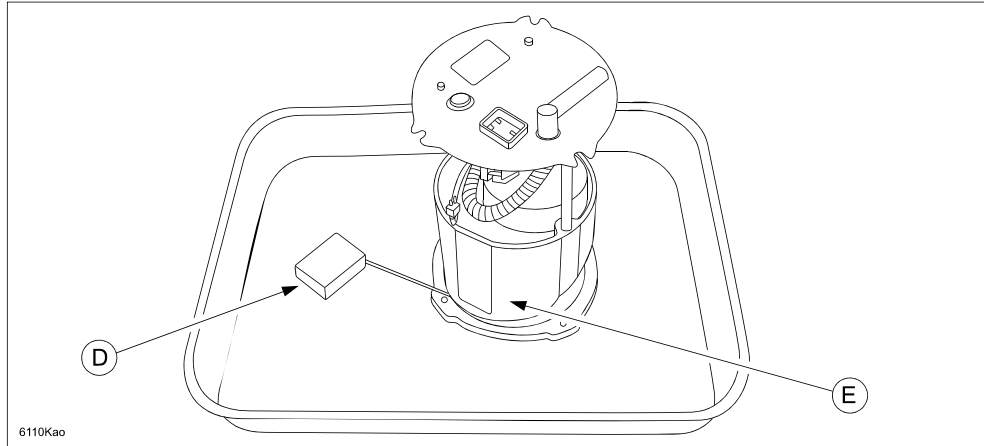

- As the fuel pump is disassembled, throw away any remaining fuel in the lower case.

**NOTE:** An impact driver might be required to loosen the screws.

8. Pull out the connectors of the fuel gauge sender unit and the pump.

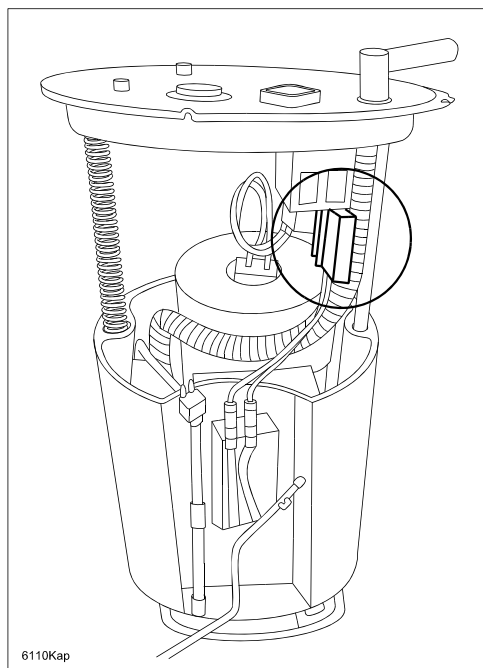

9. Remove the E-clip (A) that connects the fuel filter body and the lower case (B) and discard it.

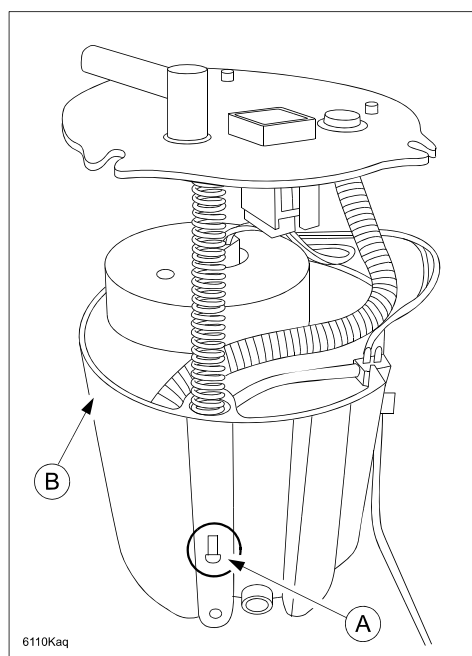

10. Remove each fitting area of the fuel filter body and the lower case and separate the body and the lower case.

**NOTE:** The lower case will be reused.

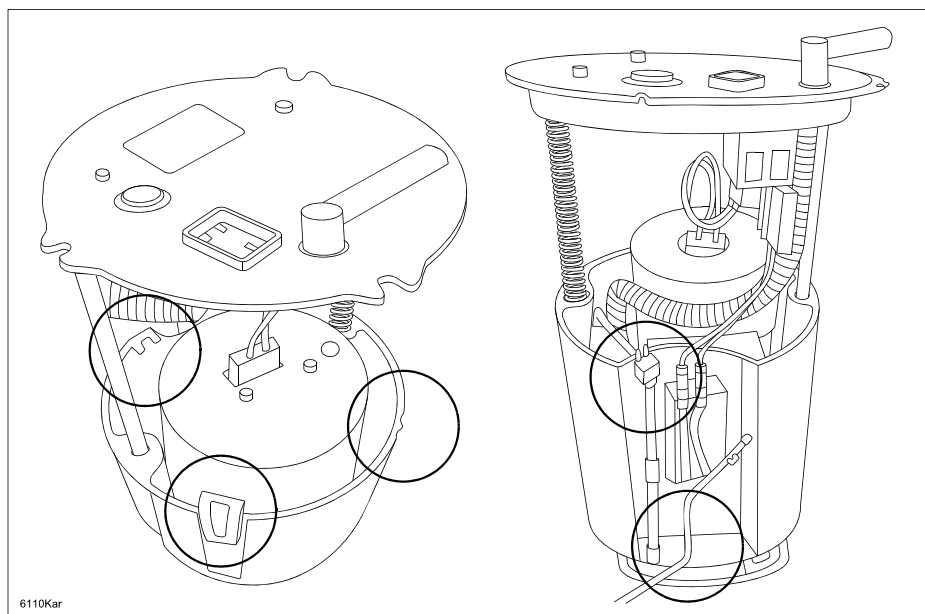

11. Remove the fuel filter (low pressure side) (A) from the fuel filter body.

**NOTE:** The fuel filter will be reused.

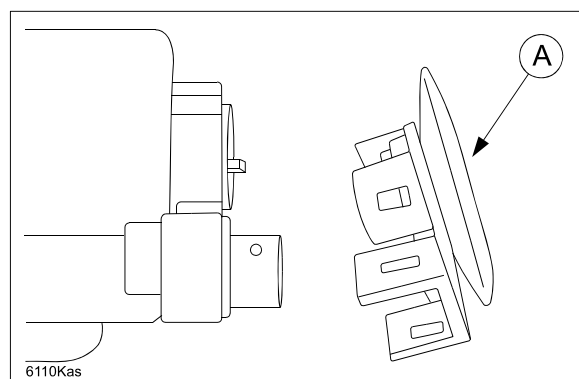

12. Remove the fuel pump (A) and the pressure regulator (B) from the fuel filter body.

**NOTE:** The fuel pump and pressure regulator will be reused, but the harness (C) will be replaced.

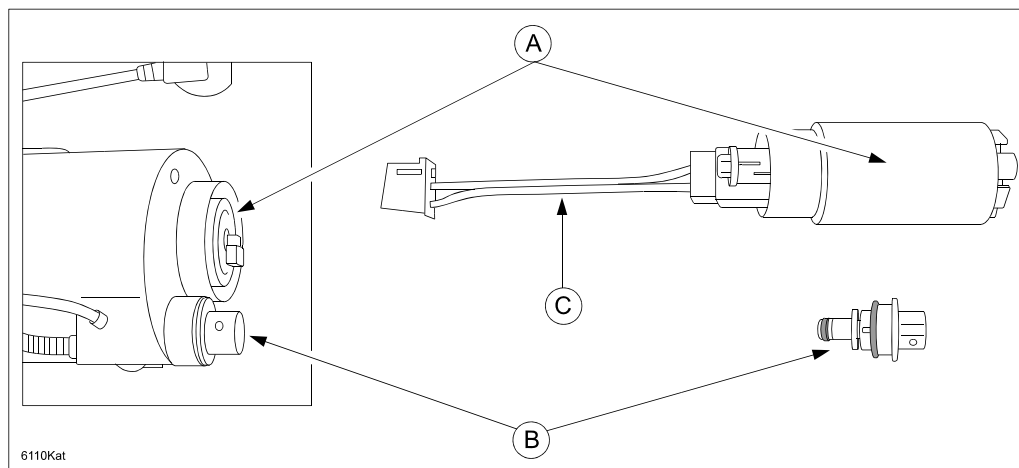

13. Replace the O-ring and other parts of the removed fuel pump and pressure regulator with the new parts included in the kit.

**NOTE:** Apply gasoline to the O-rings as needed to ease assembly.

A: O-ring and plastic ring (middle) - O-ring may remain on the body.

B: O-ring (middle): Replace.

C: Plastic ring (middle): Replace.

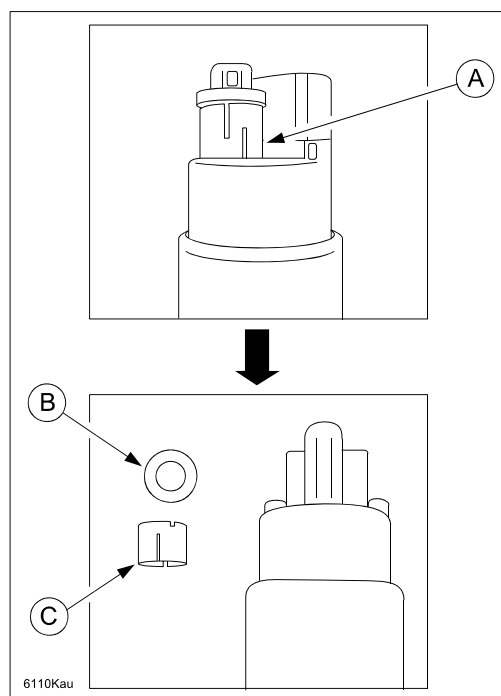

- D: Filter: Do not remove.  
E: O-ring (small): Replace.  
F: C-clip: Reuse.  
G: O-ring (large): Replace.  
H: Plastic ring (large): Replace.

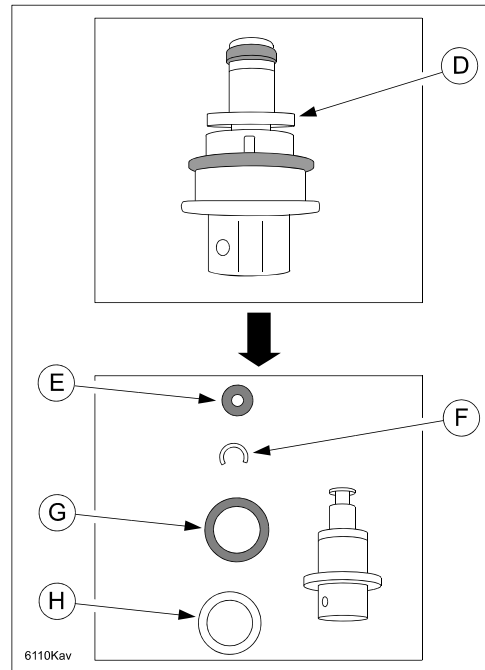

14. Attach the fuel pump and the pressure regulator with each part replaced to the new fuel filter body included in the kit.
15. Attach the fuel filter (low pressure side).
16. Attach the plastic bracket in the kit to the new fuel filter body while referring to the removed fuel filter body.

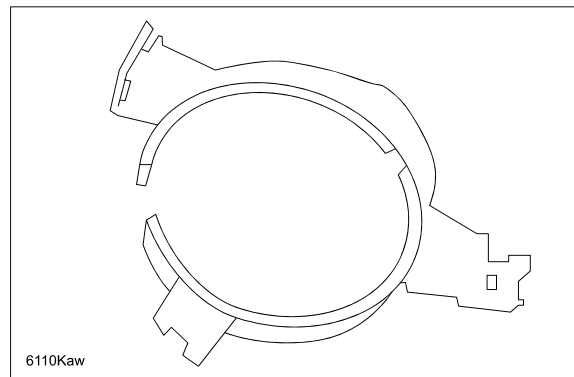

17. Install the fitting areas of the fuel filter body and the lower case respectively and attach the spring and the E-clip included in the kit.
18. Attach the connectors of the fuel gauge sender unit and the pump.  
**NOTE:** Replace the fuel pump harness with the new one included in the kit.
19. Install the new gasket to the fuel pump assembly.

## ATTACHMENT II 6110K

20. Install the assembled pump into the fuel tank while making sure the float of the fuel gauge sender unit does not get bent.
21. Connect the quick connector to the fuel pump unit.
22. After connecting the rear harness connector and the negative battery cable, start the engine and confirm there are no leaks and no abnormal operation of the fuel gauge.
23. Install the removed parts.
24. Proceed to "F CAMPAIGN LABEL INSTALLATION".

### F. CAMPAIGN LABEL INSTALLATION

1. Fill out a blue "Campaign Label" (9999-95-065A-06) with Campaign No: "6110K", your dealer code, today's date.

CAMPAIGN LABEL	
CAMPAIGN NO:	_____
DEALER CODE:	_____
DATE:	/  /

P/N 9999-95-065A-06

1326b

2. Affix it to the hood or bulkhead as shown:

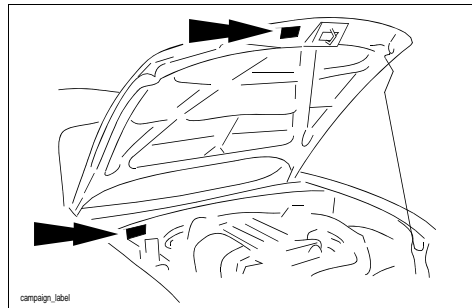

3. Return the vehicle to customer.







December 2010

## **2009-2010 Mazda5 Fuel Pump Connector Safety and Emission Recall 6110K**

Dear Mazda Owner:

This notice is sent to you in accordance with the requirements of the National Traffic and Motor Vehicle Safety Act.

Mazda Motor Corporation has decided that a defect which relates to motor vehicle safety exists in certain 2009-2010 Mazda5 vehicles, produced from June 29, 2009 through April 28, 2010.

**If you are a recipient of this notice, your vehicle is included in this recall.**

### **What is the problem?**

On certain Mazda5 vehicles, water may not be removed completely from the harness connector of the fuel pump due to variations in the fuel tank leak check process performed before vehicle assembly. As a result, the connector pin may corrode, potentially causing the pin to break which can lead to an inoperative fuel pump, engine stall and the inability to restart the engine.

### **What will Mazda do?**

Your Mazda dealer will inspect the fuel pump connector, and if necessary, replace the fuel filter body with a new one and repair the harness **free of charge**. The repair may take approximately one hour to complete; however, it may take longer depending on the necessary repair and service workload at your Mazda dealership.

### **What should you do?**

Mazda is concerned about your safety, and we encourage you to make an appointment with any authorized Mazda dealer to have the fuel pump connector inspected as soon as possible. You do not need to bring this notice to the dealer, but it may assist in the check-in process.

### **Emission Law Information:**

To ensure your full protection under the emission warranty made applicable to your vehicle by State or Federal Law, and your right to participate in future recalls, it is recommended you have your vehicle or engine serviced as soon as possible. Failure to do so could be determined as lack of proper maintenance of your vehicle. Also, your vehicle may fail a state or local emission inspection if this recall is not completed.



Page 2

*Important notice to owners registering vehicles in California, Massachusetts, and Vermont:* California Department of Motor Vehicles, Vermont Department of Motor Vehicles, and the Commonwealth of Massachusetts, in conjunction with the California Air Resources Board and the Environmental Protection Agency for the State of Massachusetts and Vermont, have implemented the Registration Renewal/Recall Tie-In Program, which requires the completion of Emission Recalls prior to registration renewal. Mazda dealers will provide a *Vehicle Emission Recall - Proof of Correction Certificate* upon completion of the recall. Be sure to keep the proof of correction certificate provided by the Mazda Dealer until needed for the registration renewal process.

**What if you already paid for repair on fuel pump, fuel filter and/or harness?**

If you have already paid for the inspection, repair or replacement of the fuel pump, fuel filter and/or harness due to corrosion on the fuel pump connector terminal, prior to receiving this notice, you may be eligible for reimbursement of reasonable repair expenses based on Mazda's repair standards.

Please complete the enclosed "Reimbursement Application Form", include the necessary documentation, and mail it to us in the pre-addressed envelope provided, allowing 6-8 weeks for processing.

**Where is the closest Mazda dealer?**

To locate your nearest Mazda dealer, visit our web site and try our "Locate a Dealer" feature at [www.MazdaUSA.com](http://www.MazdaUSA.com) or consult your local yellow pages.

**Moved or no longer own this vehicle?**

If you have moved or no longer own your Mazda vehicle, please complete the enclosed prepaid *Information Change Card* as soon as possible. This enables us to update our records and notify the current owner.

**Federal law requires that any vehicle lessor receiving this recall notice must forward a copy of this notice to the lessee within ten days.**

**Still have questions?**

If you have any questions regarding this campaign, please contact our Customer Assistance Center at (800) 222-5500, option #6.

If Mazda or its dealers do not repair the defect free of charge and within a reasonable amount of time, you may notify the Administrator of the National Highway Traffic Safety Administration, 1200 New Jersey Ave., SE., Washington, DC 20590; or call the toll-free Vehicle Safety Hotline at 1-888-327-4236 (TTY: 1-800-424-9153); or go to <http://www.safercar.gov>.



Page 3

We actively work to improve our products and search for solutions to improve your ownership experience. Please accept our apologies for any inconvenience this recall may have caused you.

Sincerely,

**Mazda North American Operations**



## REIMBURSEMENT PLAN

### **Requirements for Reimbursement**

If you meet **all** of the following requirements, you are eligible to receive reimbursement under this plan:

1. You own or have owned a 2009-2010 Mazda5 vehicles built between June 29, 2009 and April 28, 2010.
2. You have paid for the inspection, repair or replacement of the fuel pump, fuel filter and/or harness due to corrosion on the terminal of fuel pump connector.
3. You have an original or legible copy of the paid repair order or invoice receipt showing:
  - Description of the concern reported
  - Inspection, repair or replacement of the fuel pump, fuel filter and/or harness due to corrosion on the fuel pump connector terminal
  - Vehicle model and year, and vehicle identification number (VIN)
  - Your name and address at the time of repair
4. Mail this reimbursement application form in the enclosed envelope to:

**Mazda North American Operations  
Attn: Recall Reimbursement Dept  
P.O. Box 57085  
Irvine CA 92619-7085**

### **Procedure for Reimbursement Request**

Once your vehicle has had the fuel pump, fuel filter and/or harness inspected, repaired or replaced by an authorized Mazda dealer due to corrosion on the fuel pump connector terminal, you may apply for reimbursement by doing the following:

1. Complete the Reimbursement Application Form found on the reverse side of this page.
2. Mail the Reimbursement Application Form with a legible copy of the paid repair order and/or invoice using the enclosed envelope.
3. **Retain copies** of the paid repair order or invoice and this application form for your records.
4. You will be reimbursed for the amount you have paid for the inspection, repair or replacement of the fuel pump, fuel filter and/or harness due to corrosion on the fuel pump connector terminal.

If you wish to correspond with Mazda regarding this reimbursement plan, please write to the above address and refer to your vehicle identification number (VIN).

Any reimbursement application form that is incomplete, illegible, or sent without the legible copy of the paid repair order or invoice will be returned for completion. If Mazda has any questions concerning your application for reimbursement, you may be contacted. Please allow 6-8 weeks for processing.

## REIMBURSEMENT APPLICATION FORM

### 2009-2010 Mazda5 Fuel Pump Connector Safety and Emission Recall 6110K

(Please type or print)

Name: \_\_\_\_\_  
First Middle Last

Address: \_\_\_\_\_  
Street Address

\_\_\_\_\_ City State Zip Code

Home: \_\_\_\_\_  
Phone Number: Work: \_\_\_\_\_

Vehicle Identification Number (VIN): \_\_\_\_\_  
(17 digits in length)

Total Amount of Reimbursement Requested: \_\_\_\_\_  
Dollars Cents

#### INSTRUCTIONS FOR GENERAL RELEASE DESCRIBED BELOW:

- Please read thoroughly
- Fill in vehicle identification number
- Sign the General Release (below)

### General Release

I am submitting to Mazda Motor Corporation ("Mazda") a claim for reimbursement for all inspection, repair or replacement of the fuel pump, fuel filter and/or harness performed to date in connection with corrosion on the fuel pump connector terminal. The vehicle identification number (VIN) is:

VIN: \_\_\_\_\_

**In exchange for Mazda's payment of that claim, I hereby release Mazda, its agents, and its related entities from all claims for such inspection/repair costs. This release shall benefit Mazda and its authorized agent Mazda North American Operations, its regions/distributors (foreign and domestic), its authorized dealerships, and all their respective directors, officers, agents, employees, divisions, subsidiaries, and affiliated companies. This release shall bind my heirs, successors and assigns.**

Dated: \_\_\_\_\_ Signed: \_\_\_\_\_