

**RECEIVED**

By Recall Management Division at 9:36 am, Jun 23, 2010



**KONGSBERG**

Power Products Systems

June 15, 2010

Mr. Dan Smith  
Associate Administrator for Enforcement  
National Highway Traffic Safety Administration  
Attention: Recall Management Division (NVS-215)  
1200 New Jersey Avenue, SE.  
Washington, DC 20590.

10V-284  
(4 Pages)

Re: Defect Information Report, Adjustable Brake Pedal Assembly

Dear Mr. Smith,

In accordance with 49 CFR § 573, Kongsberg Power Products Systems I, Inc. ("KPPS"), is submitting the attached Defect Information Report regarding approximately 2270 recreational vehicles manufactured by the now bankrupt Monaco Coach Corporation and equipped with adjustable brake pedal assemblies supplied by KPPS.

KPPS recently obtained information regarding the last known owners of these vehicles from Monaco RV, LLC, a company which purchased some of the assets of Monaco Coach Corporation. The accuracy of this information is unknown. Nevertheless, KPPS, although not required to do so by the Motor Vehicle Safety Act and the applicable regulations, is voluntarily conducting this recall as the supplier of the pedal assemblies.

This report follows Equipment Recall 09E-064 filed by KPPS on December 3, 2009.

Please contact me if you have any questions.

Sincerely,

KPPS

By: \_\_\_\_\_

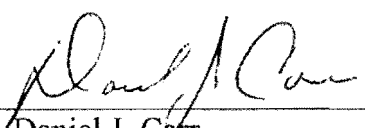
  
Daniel J. Carr  
Vice President R&D

Power Products Systems  
300 S. Cochran, P O Box 588, Willis TX 77378-0588 USA  
936-856-2971  
[www.kongsbergautomotive.com](http://www.kongsbergautomotive.com)

**49 CFR § 573.6**  
**DEFECT INFORMATION REPORT**  
**June 15, 2010**

**(c)(1) Manufacturer:** Monaco Coach Corporation (bankrupt entity)  
Report filed by Kongsberg Power Products Systems I,  
Inc. (“KPPS”) (component supplier)

**Brands:**

**(c)(2) Identification of Vehicles**

**Models Affected (make/line):**

Monaco Coach Corporation models manufactured between  
April 2004 and present equipped with adjustable pedal  
assemblies supplied by KPPS.

**Model Years Affected:** 2004 to present

**Basis for Determination of Recall Population**

Models containing Adjustable Pedal, Pneumatic and  
Hydraulic Braking Systems, supplied by KPPS. Part Nos.  
6562618, 6565118, 77025-001, 77025-002, 77025-501,  
77050-004.

**Component Manufacturer**

Kongsberg Power Products Systems I, Inc.  
101 Western Maryland Parkway  
Hagerstown, MD 21740  
Contact: Daniel J. Carr (267) 382-0399

**(c)(3) Total Number of Vehicles Potentially Affected for Each Group in (c)(2)**

Approximately 1960 vehicles (according to information obtained from  
Monaco RV).

**(c)(4) Percentage of Vehicles Estimated to Have the Defect**

Unknown. KPPS is recalling 100% of the vehicles equipped with the  
subject pedal assemblies.

**(c)(5) Description of the Defect**

In situations where the drive pin does not meet the minimum size specification, it may become disengaged from the brake arm causing a separation or loosening of the pedal from the remainder of the assembly.

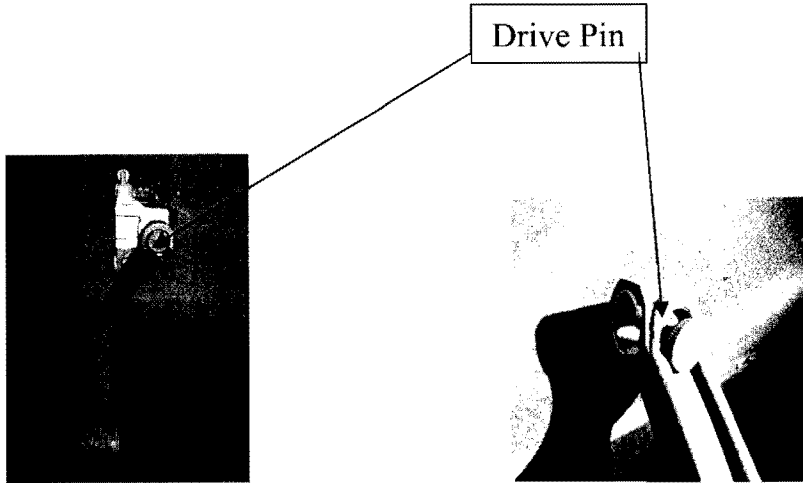

**Cause(s) of the defect or noncompliance condition.**

Analysis to date has shown that some drive pins may be undersized and not within the specification requirements.

**Potential consequence(s) of the defect or noncompliance condition.**

If the drive pin becomes disengaged on the brake pedal assembly, it could result in a loss of vehicle braking function and/or cause the brake pedal to interfere with the throttle pedal function.

**Warnings which can precede or occur.**

Potential tactile looseness of the pedal assemblies and/or visual observation of a misplacement of the pedal.

**(c)(6) Chronology of Principal Events**

See Equipment Recall 09E-064 filed by KPPS on December 3, 2009.

Date	Event
December 2009 – February, 2010	Various KPPS OEM customers filed §573 reports and began conducting recalls to apply the remedy provided by KPPS.
January 2010 – April 2010	KPPS communicates with Monaco RV regarding recall of units produced prior to Monaco Coach Corporation’s bankruptcy and obtains a listing of customers who may have purchased Monaco Coach vehicles containing the subject brake pedal assemblies.
May 2010 – June 2010	KPPS develops plan and logistics for conducting recall of Monaco Coach Corporation vehicles.

**(c)(7) Non-Compliance Test.** Not applicable.

**(c)(8) (i) Remedial Program**

- a. KPPS will send a customer notification letter (Exhibit A) to all customers on the listed obtained from Monaco RV, LLC.
- b. KPPS will provide a Clamp Assembly Kit and the Installation Instructions (Exhibit B) to all confirmed current owners.
- c. KPPS will reimburse the cost of installing the Clamp Assembly Kit as set forth in Exhibit A.

**(ii) Estimated Owner Notification Date**

KPPS expect to notify customers within 30 days of the filing of this notice.

**(c)(9) Information for Tire Recalls.** Not applicable.

**(c)(10) Communications Sent to Manufacturers, Distributors, Dealers or Purchasers.**

See Equipment Recall 09E-064 filed by KPPS on December 3, 2009.

**(c)(11) Manufacturers Campaign Number.**

N/A

# KPPS ADJUSTABLE BRAKE PEDALS

RECALL CAMPAIGN - \_\_\_\_\_

Date: \_\_\_\_\_

## C-clamp Installation

1. With the C-clamp assembly in your hand, install the top bolt (bolt with lock washer) of the assembly in the guide hole at the top of the brake arm casting.
2. Rotate the assembly clockwise until the C-clamp is against the brake arm casting and centered on a gold colored pin at the underside of the brake pedal.
3. Tighten the bottom bolt with a ratchet and 10mm socket or 10mm box wrench until the bolt makes contact with the gold colored pin. After the bottom bolts makes contact with the gold colored pin; then tighten 3 additional turns.

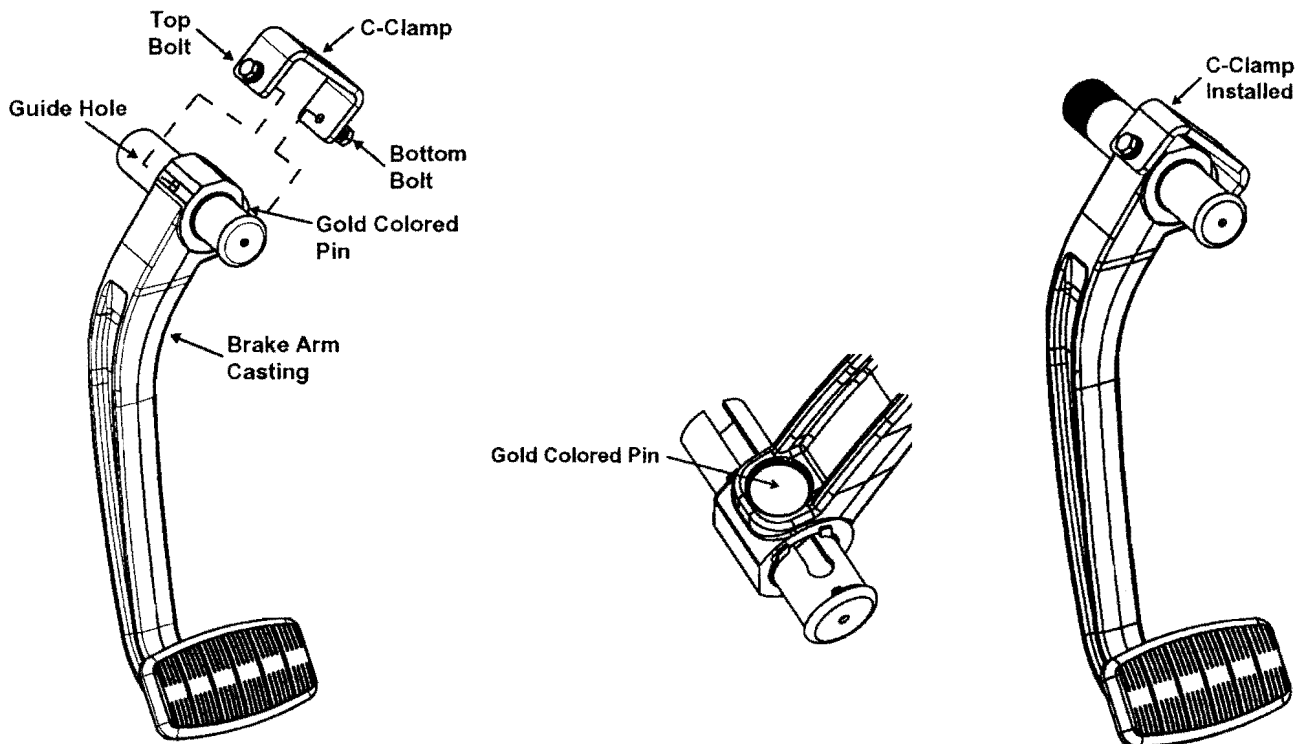

Model Name	Units per Model Year			Total Units per Model
	2008	2009	2010	
Ambassador	161	46	0	207
Camelot	0	165	0	165
Cheetah	0	51	0	51
Contessa	0	28	0	28
Diplomat	422	91	0	513
Dynasty	0	166	5	171
Endeavor	315	70	5	390
Executive	0	13	0	13
Imperial	9	26	0	35
Knight	169	63	0	232
Marquis	0	19	0	19
Monterey	0	11	0	11
Navigator	11	20	0	31
Patriot	5	12	0	17
Scepter	0	34	0	34
Signature	18	25	0	43
Totals Units per Model Year	1110	840	10	1960