



PORSCHE

VIA FEDERAL EXPRESS

March 31, 2010

Ms. Kathleen Demeter
Associate Administrator for Enforcement
National Highway Traffic Safety Administration
1200 New Jersey Avenue, S.E. (W45-302)
Washington, DC 20590

Porsche Cars North America, Inc.

980 Hammond Drive
Suite 1000
Atlanta, Georgia 30328
(770) 290-3500 Fax: (770) 290-3700

RE: Defect Notification Report for the Model Year 2010 Porsche Panamera Models

Dear Ms. Demeter:

Porsche Cars North America, Inc. on behalf of Dr. Ing. h.c.F. Porsche AG hereby informs you of Porsche's intention to conduct a safety related recall and remedy campaign involving the 2010 Porsche Panamera vehicles.

On behalf of Dr. Ing. h.c.F. Porsche AG, Porsche Cars North America, Inc. has enclosed a defect report pursuant to the provisions of Part 573 of Title 49 of the Code of Federal Regulations.

Should you have any questions or require further information, please do not hesitate to contact me at (770) 290-3627.

Sincerely,

Walter J. Lewis, Manager
Regulatory Affairs

Enclosures

cc: George Person, NHTSA - ODI via facsimile

PORSCHE

PART 573 Defect and Noncompliance Report

On March 24, 2008, Porsche decided that a defect, which relates to motor vehicle safety exists in the motor vehicles listed below, and is furnishing notification to the National Highway Traffic Safety Administration in accordance with 49 CFR Part 573 Defect and Noncompliance Reports.

Date this report was prepared: **March 31, 2010**

Manufacturer's identification code: **AA01**

1. Identify the full corporate name of the fabricating manufacturer of the vehicle being recalled. If the recalled vehicle is imported, provide the name and mailing address of the designated agent as prescribed by 49 U.S.C. §30164.

Manufacturer

**Dr. Ing. h.c.F. Porsche AG
70435 Stuttgart
Germany**

Agent

**General Counsel
Porsche Cars North America, Inc.
980 Hammond Drive
Suite 1000
Atlanta, GA 30328**

Corporate official, whom the agency should contact with respect to this recall:

**Walter J. Lewis
Regulatory Affairs Manager
Tel. No: (770) 290-3627
Fax No.: (770) 290-5508**

Signed

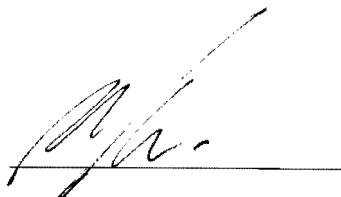



PART 573 Defect and Noncompliance Report

I. Identify the Vehicle Models involved in the Recall

2. Vehicles Involved in the Recall:

Make: **Porsche**

Model Year: **2010**

Models: **Panamera S, Panamera 4S, Panamera Turbo**

Production Dates: **July 4, 2009 to February 15, 2010**

VINs: **Panamera S, Panamera 4S -
WPOAB2A75AL060071 to WPOAB2A78AL063613.**

**Panamera Turbo –
WPOAC2A79AL090042 to WPOAC2A71AL091217**

Vehicle Type: **Passenger Car**

Bodystyle: **4-door sedan**

Descriptive information which characterizes/distinguishes the recalled vehicles from those models not included in the recall:

None.

Identify the approximate percentage of the production of all the recalled models manufactured by your company between the inclusive dates of manufacture provided above, that the recalled model population represents.

100%.

PORSCHE

PART 573 Defect and Noncompliance Report

II. Identify the Recall Population

3. Furnish the total number of vehicles recalled potentially containing the defect or noncompliance.

Total Number Potentially Affected by the Recall: **3,176**

4. Approximate percentage of the total number of vehicles above estimated to actually contain the defect or noncompliance:

100%.

Identify and describe how the recall population was determined:

To be determined.

III. Describe the Defect or Noncompliance

5. Describe the defect or noncompliance.

If the front seats are adjusted towards an extreme position, resulting in unfavorable tolerance of the mating components, it is possible that the function of the locking mechanism of the seat belt mount can no longer be guaranteed. The seat belt mount could detach from the anchoring system when the seat belt is fastened or opened.

Describe the cause of the defect or noncompliance condition.

See above.

Describe the consequence of the defect or noncompliance condition.

The restraint function of the safety belts can no longer be guaranteed.

PART 573 Defect and Noncompliance Report

Identify any warning, which can (a) precede or (b) occur.

None.

Identify the supplier by corporate name and address, and the name and title of the chief executive officer or knowledgeable representative of the supplier:

Not applicable.

IV. Provide the Chronology in Determining the Defect/Noncompliance

6. With respect to a defect, furnish a chronological summary (including dates) of all the principle events that were the basis for the determination of the defect. The summary should include, but not be limited to, the number of reports, accidents, injuries, fatalities, and warranty claims.

To be determined.

7. With respect to a noncompliance, identify and provide the test results or other data (in chronological order and including dates) on which the noncompliance was determined.

Not applicable.

V. Identify the Remedy

8. Furnish a description of the manufacturer's remedy for the defect or noncompliance. Clearly describe the differences between the recall condition and the remedy.

The affected vehicles will be recalled to the dealer to have an additional locking element installed on the seat-belt anchoring system for both front seats.

PORSCHE

PART 573 Defect and Noncompliance Report

Clearly describe the distinguishing characteristics of the remedy component/assembly versus the recalled component/assembly.

Please refer to the attached draft Technical Information bulletin.

Identify and describe how and when the recall condition was corrected in production. If the production remedy was identical to the recall remedy in the field, so state. If the product was discontinued, so state.

To be determined.

VI. Identify the Recall Schedule

Furnish a schedule or agenda (with specific dates) for notification to dealers and purchasers.

To be determined.

VII. Furnish Recall Communications

9. Furnish a final copy of all notices, bulletins, and other communications that relate directly to the defect or noncompliance and which are sent to more than one manufacturer, distributor, or purchaser. This includes all communications (including both original and follow-up) concerning this recall from the time your company determines the defect or noncompliance condition on, not just the initial notification.

Will be forwarded as soon as possible.

Recall campaign AA01 - Fitting additional locking element on belt anchoring system for front seats

Vehicle Type: **Panamera S/Panamera 4S/Panamera Turbo**

Model Year: **2010**

Concerns: **Front seat belts**

Situation: **If the front seats are adjusted very far, resulting in unfavourable tolerances, it is possible that the function of the locking mechanism for the seat belt mount can no longer be guaranteed.**

As a result, the seat belt mount can become detached from the anchoring system when you fasten or open the seat belt. The restraint function of the belt system can then no longer be guaranteed.

The fitting cannot become detached from the anchoring system when the belt is fitted correctly.

Action Required: Fit an additional locking element on the seat-belt anchoring system at the front seats to hold the seat belt mount at the correct position.

Affected Vehicles: Only the vehicles listed in the dealer notification list (see also PIWIS Vehicle Information).

Part Nos.: 000.043.300.74 ⇒ Plastic washer 2 ea.

- Procedure: 1 Fit an additional locking element on the **left front seat**.
- 1.1 Move seat to the very front, uppermost position.
 - 1.2 Check that the seat belt is anchored correctly at the front seat.

To do this, pull on the seat belt (⇒ Figure 1 -arrow A-).

The seat belt mount (⇒ Figure 1 -item 1-) must be anchored at the front seat and must become locked with the safety clip (⇒ Figure 1 -item 2-) at the abutment head of the belt anchoring system (⇒ Figure 1 -item 3-) when the seat belt mount is moved in direction of arrow (⇒ Figure 1 -arrow B-).

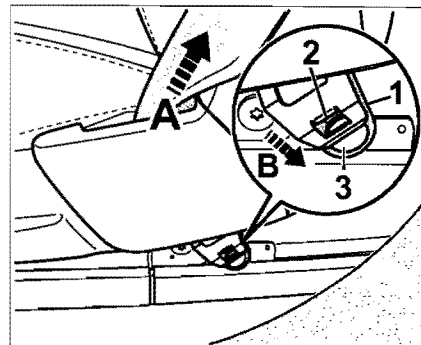

Figure 1

Anchor the seat belt mount correctly at the front seat if necessary and move it into the position shown in ⇒ Figure 1 .

- 1.3 Fit additional locking element on the belt anchoring system.

**Information**

The additional locking element must be fitted between the abutment head of the belt anchoring system and the seat belt mount.

The correct position of the locking element is shown in ⇒ *Figure 2 -top-* and ⇒ *Figure 3 -top-* using the **left front seat** as an example.

Overview:

- Item 1: Seat belt mount
- Item 2: Locking element
- Item 3: Abutment head of belt anchoring system

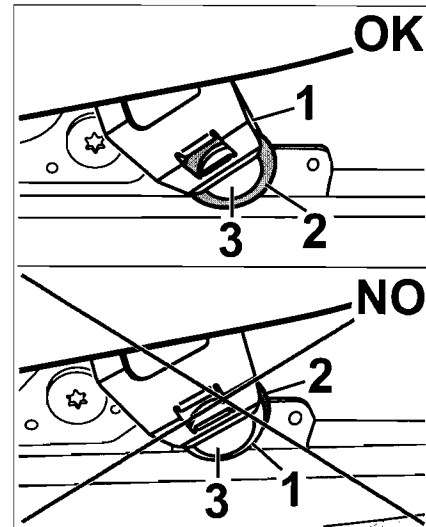

Figure 2

⇒ *Figure 3* shows the belt anchoring system on the **left front seat** from the perspective “looking onto the seat rail of the front seat from the rear footwell”.

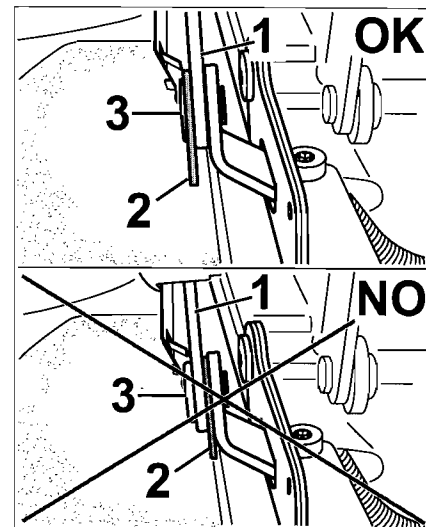

Figure 3

1.3.1 Position the locking element (⇒ Figure 4 -item 2-) between the seat belt mount (⇒ Figure 4 -item 1-) and the abutment head of the belt anchoring system (⇒ Figure 4 -item 3-).

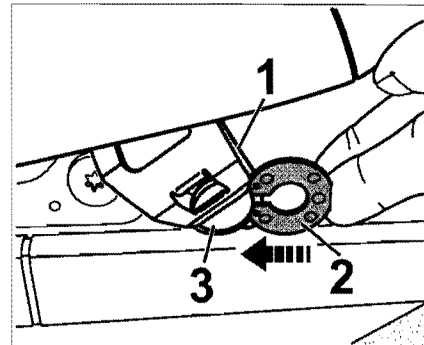

Figure 4

1.3.2 Press the seat belt mount (⇒ Figure 4 -item 1-) in slightly to make it easier to fit the locking element and hold it at this position.

1.3.3 Press the locking element (⇒ Figure 4 -item 2-) as shown in ⇒ Figure 4 onto the belt anchoring system (⇒ Figure 4 -arrow-) until the locking element clips onto the pin.

1.4 Check that the locking element (⇒ Figure 5 -item 2-) is positioned correctly between the seat belt mount (⇒ Figure 5 -item 1-) and the abutment head of the belt anchoring system (⇒ Figure 5 -item 3-) and that it is seated correctly on the belt anchoring system.

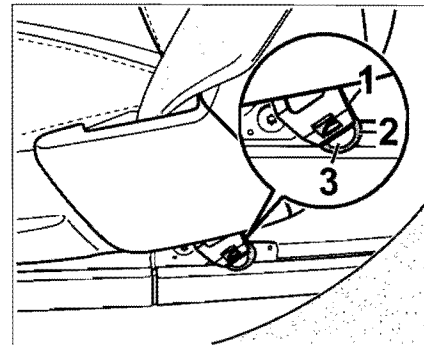

Figure 5

To do this, pull the locking element against the fitting direction. The locking element must remain in position.

1.5 Move the seat back to its original position.

2 Fit an additional locking element on the **right front seat**.
To do this, complete Steps 1.1 to 1.5 on the right front seat.

3 Enter the campaign in the Guarantee and Maintenance booklet.

Scope:

Working Time:

Fitting additional locking element on seat-belt anchoring system for front seats

Labor time: **30 TU**

Parts Required:

000.043.300.74 Plastic washer 2 ea.

Invoicing: ⇒ Damage Code AA01 99 000, Repair Code 1

PORSCHE*1/1/10
J.W.***Telefax**

To: Mr. George Person, Chief Defects Assessment Division (W48-302) Office of Defects Investigation NHTSA	Telefax: 202-366-7882
Date: March 31, 2010	No. of Pgs. (incl. cover) 10
From: Walter J. Lewis	Department: After Sales – Regulatory Affairs
Telephone: (770) 290-3627	Telefax: (770) 290-5508
Re: Part 573 Report for the Panamera	

Dear Mr. Person:

Attached is a copy of a Part 573 report, which we have sent to Ms. Kathleen Demeter today.

Please let me know if you have any questions.

Best regards,

