



## Recall Action Notice

**Service Bulletin 390  
February 2008**

---

**Affected Models** .....**Street Triple**  
**VIN Range**.....**VIN 316225 to VIN 343763**  
**Subject**.....**Rear Suspension Unit**  
**Markets** .....**All**

### Background information

In service quality feedback has identified a potential problem with the rear suspension unit (part number T2053190). It has been found that the rear suspension unit may suffer from a loss of damping action. Dealers are required to replace the rear suspension unit of affected motorcycles with a replacement item (part number T2053195).

### Customer contact instructions

Triumph subsidiaries and distributors must instigate a recall action in their country in accordance with the national recall code of practice. For vehicles in dealer stock, the recall **MUST** be actioned before delivery to the customer.

### Identification of affected motorcycles

Street Triple motorcycles in the VIN range listed above are affected.

### Warranty claim instructions

Fault code .....02055094  
Repair code .....99390  
Repair time allowance .....0.31 hrs to replace (inc. admin)  
Parts .....Rear Suspension Unit x 1 (Part No. T2053195)  
Locknut, M10 X 1.25 x 2 (Part No. T3350005)

**Parts ordering instructions**.....**For Triumph Subsidiary dealers using Triumph Warranty On-Line:** Order all repair parts by submitting a New Prior through the Warranty On Line system. Entering the above repair code in a New Prior will automatically add the necessary parts and labour times for this Service Bulletin.

**For Overseas Distributor dealers NOT using Triumph Warranty On-Line:** Orders should be placed using the normal parts ordering procedure.

**Parts return instructions** ..... Dealer to return labelled parts to Triumph as per normal warranty procedure, within 30 days of the date of repair.  
The original rear suspension unit **must** be returned in the same packaging in which the replacement unit was supplied.  
All replacement rear suspension units will have a white, blue or green paint mark on the lower eye to identify new replacement units from original units.

## Other Instructions

Once completed, please mark the service record book that the requirements of this bulletin have been complied with.

## Replacement Procedure

Replace following the procedure listed below:

### **Warning**

Throughout the following procedure, ensure the motorcycle is stabilised and adequately supported. This will help prevent it from falling and causing injury to the operator or damage to the motorcycle.

### **Warning**

A torque wrench of known accurate calibration must be used. Failure to tighten any of the fasteners to the correct torque specification may result in loss of motorcycle control and an accident.

## Removal

1. Position the motorcycle on a paddock stand.
2. Support the rear of the motorcycle under the frame or engine so that it can be raised or lowered to allow removal of the rear suspension unit and fixings.
3. Remove the seat as described in either the owners handbook or service manual.
4. Disconnect the battery, negative (black) lead first.

### **Caution**

To prevent bodywork damage, do not spill brake fluid onto any area of the bodywork.

5. Remove the fixing and detach the rear brake fluid reservoir from the frame. Without allowing the reservoir to become inverted, position it aside.

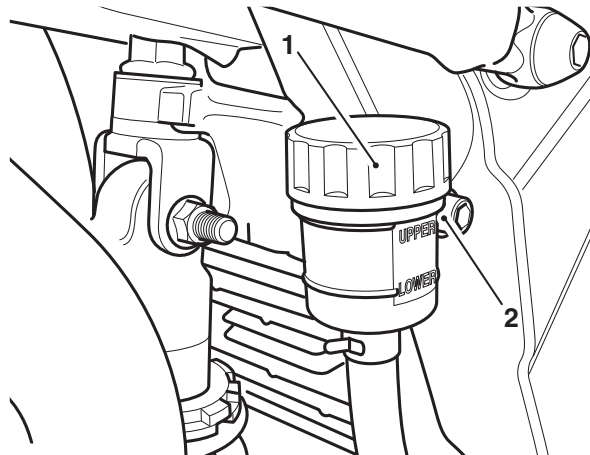

1. Rear brake fluid reservoir
2. Fixing

## Warning

Ensure the motorcycle is stabilised and adequately supported. This will help prevent it from falling and causing injury to the operator or damage to the motorcycle.

6. Remove the rear suspension unit upper mounting nut and bolt. Discard the nut.
7. Detach the rear suspension unit from the upper frame mounted clevis.

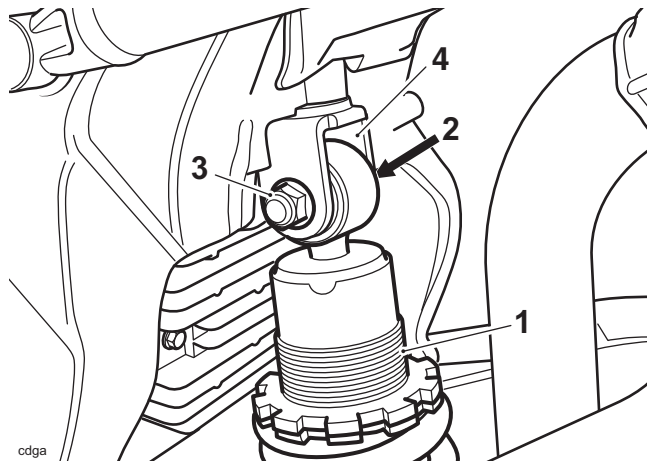

1. Rear suspension unit
2. Bolt
3. Nut
4. Frame mounted Clevis

8. Release the rear suspension unit lower fixing. Discard the nut.

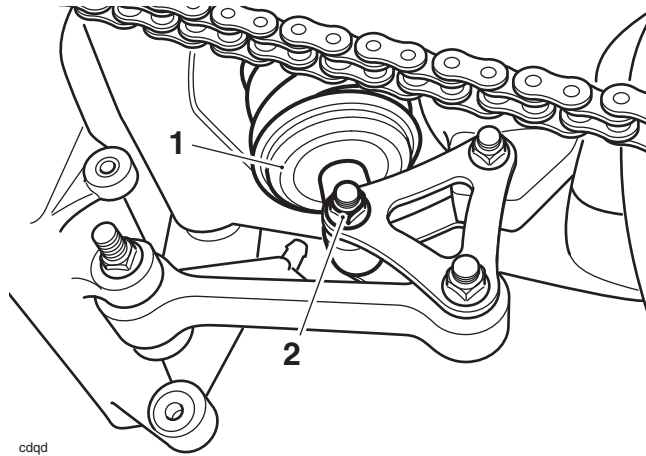

- 1. Rear suspension unit**  
**2. Lower bolt**

9. Lower the rear of the motorcycle until the lower bolt can be withdrawn past the intermediate exhaust pipe clamp. Support the rear suspension unit as the bolt is removed.
10. Raise the rear of the motorcycle and carefully manoeuvre the unit upwards through the swinging arm and clear of the motorcycle.

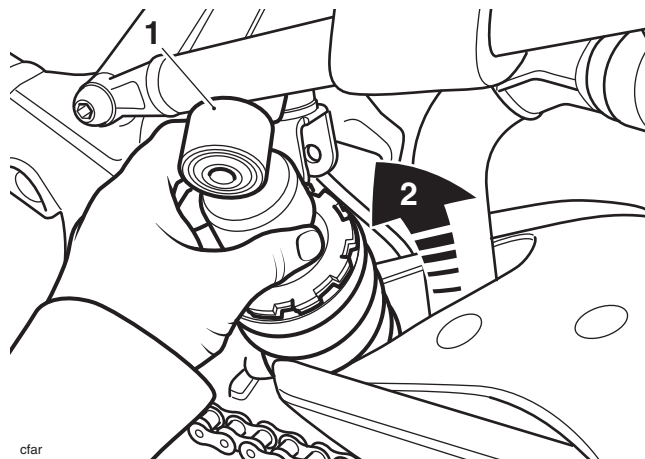

- 1. Rear suspension unit**  
**2. Removal direction**

## Installation

1. Position the rear suspension unit to the motorcycle, lowering it downwards through the swinging arm.

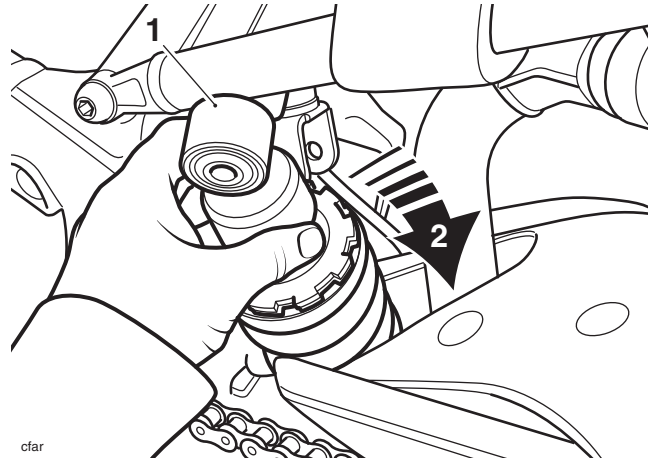

### 1. Rear suspension unit

### 2. Installation direction

2. Align the rear suspension unit lower mounting to the rear suspension drop links.
3. Lower the rear of the motorcycle until the lower bolt can be installed past the intermediate exhaust pipe clamp.
4. Install the lower bolt from the right hand side. Fit a new nut, but do not fully tighten at this stage.
5. Raise the rear of the motorcycle and align the rear suspension unit upper mounting to the frame mounted devis.
6. Install the upper bolt, from the right hand side, and fit a new nut. Do not fully tighten at this stage.
7. Lower the rear of the motorcycle until the weight of the motorcycle is fully supported on the rear suspension.
8. Tighten both rear suspension unit fixings to **48 Nm**.
9. Refit the brake fluid reservoir to the frame and tighten the fixing to **7 Nm**.
10. Check for correct rear brake operation. Rectify as necessary.

## ! Warning

It is dangerous to operate the motorcycle with defective brakes; you must have your authorised Triumph dealer take remedial action before you ride the motorcycle again. Failure to take remedial action may result in reduced braking efficiency leading to loss of motorcycle control and an accident.

11. Connect the battery, positive (red) lead first.
12. Mark the service record book that the requirements of this bulletin have been complied with.
13. Fit the seat as described in either the owners handbook or service manual.

## Circulation

(Initial and date when read and return to central file holder)

Service Manager	Parts Manager	Sales Manager	Workshop Supervisor	Technician 1	Technician 2