

SAFETY RECALL BULLETIN

ATTENTION: SERVICE MANAGERS
PARTS MANAGERS

SUBJECT: Steering Gear Mounting Fastener Torque

SAFETY RECALL INFORMATION:

The bolts that attach the steering gear to the frame may not have been tightened to the correct torque.

VEHICLES AFFECTED:

Certain VNL, VNM, and VT model vehicles manufactured from July 2, 2007 through September 21, 2007.

There are 2,084 vehicles (1,491 US; 226 Canada; 367 Export) affected by this recall.

NOTE: To verify or determine if a particular vehicle is affected by this recall (or any other recall), you should enter the Vehicle Identification Number into the VIN search field in eWarranty, and the screen will display any open recall.

If a "Dealer Listing" is enclosed it identifies the vehicles that were sold or shipped to your dealership. Be sure to check the eWarranty Vehicle Detail screen before performing the recall to verify that the recall is still open.

REPAIR:

The recall repair will consist of tightening the bolts.

TIME ALLOWANCE:

0.3 hour per vehicle

Note: If the recall repair is the only repair being administered, then a take charge time allowance of 0.3 hrs can be claimed.

PART ORDERING PROCEDURES:

There are no parts required for this recall

DEALER PARTS INVENTORY:

Dealer parts inventory is not affected by this recall.

CLAIMS FOR CREDIT:

Expenses associated with the performance of this recall will be reimbursed based on the guidelines identified in this bulletin, and section 2-41 of the Warranty Manual, Policies and Procedures and chapter 20 of the Parts Operations Manual.

CLAIM CODING INFORMATION:

Authorization Number: RVXX0706

Causal Part Number: 963347

STANDARD REPAIR CODES AND TIME:

Repair: 64231-0-02 (0.3 hour)

Take charge time (if applicable): 17003-0-01 (0.3 hour)

IMPORTANT NOTE: Claims for a recall repair **MUST** be submitted within 2 working days from the repair date.

OWNER RECALL RESPONSE CARD:

The "Owner Recall Response Card" is to provide the vehicle owner with a convenient way to notify Volvo Trucks North America of changes affecting the ownership of the subject vehicle. The owner recall response card is not intended for dealer usage other than to assist you in the preparation of the repair orders necessary to perform the applicable recall on the subject vehicle. Please do not use the card as a way to inform Volvo Trucks North America that the vehicle has been inspected or modified. Your DCS claim on line is the appropriate means of informing Volvo Trucks North America that the vehicle has been inspected or modified.

DEALER RECALL RESPONSIBILITY:

Dealers are to perform the recall on all vehicles subject to the recall at no charge to the owner regardless of mileage, age of vehicle, or ownership from this time forward. Whenever a vehicle subject to this recall is taken into or is in your vehicle inventory or dealership for service, we strongly recommend you make every effort to perform the recall correction before the vehicle is sold or released to the owner.



IMPORTANT NOTICE:

Please note that the National Traffic and Motor Vehicle Safety Act requires that the owner's vehicle(s) be corrected at no charge and within a reasonable time after parts are available to you. The law states that failure to repair a vehicle within sixty (60) days after tender for repair shall be a prima facia evidence of unreasonable time. However, circumstances of a particular situation may reduce the sixty-day period. If an owner's vehicle is not repaired within a reasonable time, he or she may be entitled, without charge, to a reasonable equivalent vehicle or refund of the purchase price, less reasonable allowance for depreciation.

Repair Procedures:

You must read and understand the precautions and guidelines in Service Information, group 60, "General Safety Practices" before performing this procedure. If you are not properly

1. Park the vehicle on a level surface, apply the park brakes and block the wheels to prevent the vehicle from moving, and place the transmission in neutral.

2.

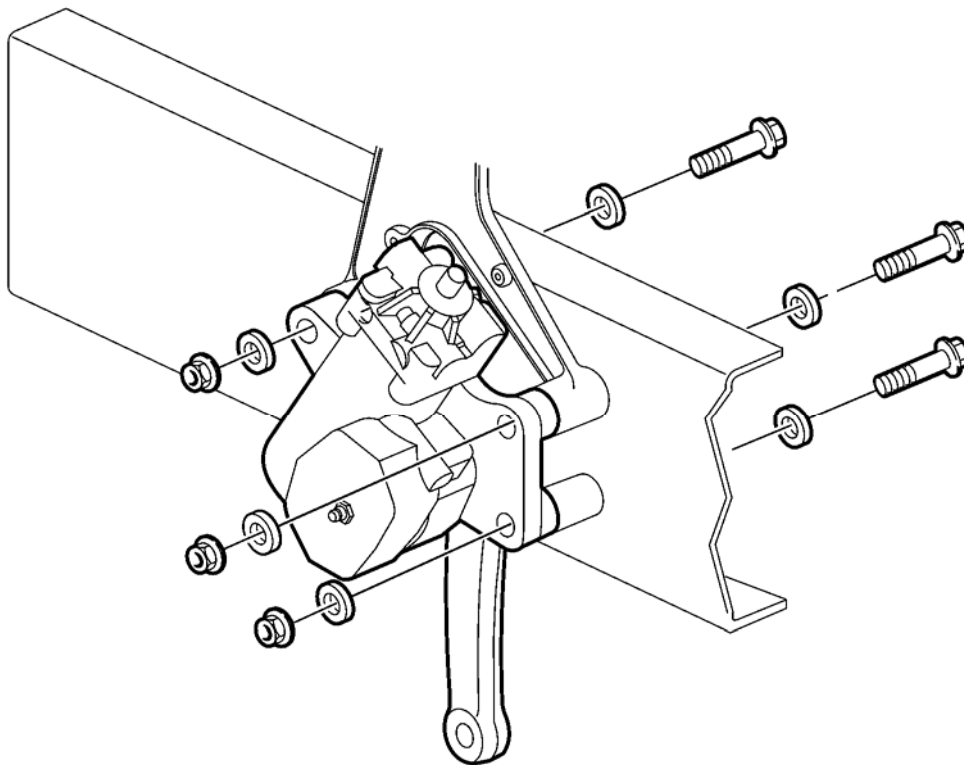

W6001615

Using an accurately calibrated torque wrench on the mounting nuts (outer) and a wrench on the bolts (inner), tighten the fasteners to 398 ± 66 ft-lb (540 ± 90 Nm). **Note:** Some vehicle may have four bolts securing the steering gear.

3. Mark each nut with a yellow paint stick to signify that the fasteners have been torqued to specification.