

Safety Recall

Subject: Fuel Pipe Bracket

Date: 06/29/2007

Bulletin: R0020

Campaign #: A5371

Affected Models: 2008 NA6J (145), NB6J (165), NC6J (185)

Important: *Verify on the Hino DCS Warranty System that the vehicle still needs to have this work performed.*

Description:

This bulletin involves the inspection and possible replacement of the common rail supply pipe, and installation of revised holding bracket.

Condition:

The fuel pipe between the supply pump and the common rail may crack due to high stress which is a result of insufficient bracket stiffness and over tightening of the clip. If the fuel pipe cracks the engine warning light will alert the driver to the problem. However, if the warning light is ignored by the driver, this could ultimately cause a fire and engine stall, potentially resulting in an accident, personal injury, death or property damage.

Subject Vehicles:

2008 model year NA6J (145), NB6J (165), and NC6J (185) vehicles equipped with the J05D-TF model engine produced in the United States.

Before You Begin:

Read and understand all instructions and procedures before you begin. Read and observe all Caution and Warning safety alerts that precede these instructions while following these procedures. The alerts help to avoid damage to components, serious personal injury, or both.

Safety Recall



Once Recall is completed

Fill out the Recall Completion sticker as shown in the picture to the left. This sticker should be attached to the left door jam above the V.I.N. Plate.

Required Parts:

NEW PART NUMBER	DESCRIPTION	QUANTITY
82702E0S50	Bracket S/A, Wiring Harness	1
21576E0010	Clip S/A	4
SL15010808	Nut	2

Optional Parts:

NEW PART NUMBER	DESCRIPTION	QUANTITY
23811E0161	Fuel Pipe	1

Note: To obtain parts for this Recall please call.
Steve Chiodo
Regional Service Manager
248-648-6483

 **WARNING**

1. Apply parking brake and wheel chocks to prevent the vehicle from moving
2. Confirm that the engine has cooled down and is at a low temperature to prevent exposure to high temperatures.
3. Use care when opening or closing the hood to prevent injury.

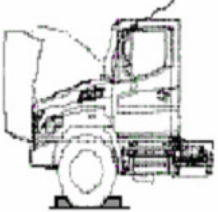

Safety Recall

Repair Procedure:

1. Disconnect negative battery cables.
2. Inspect the fuel pipe that runs from the common rail to the supply pump for clip deformation. (See figure A) If there is no deformation the pipe will **NOT** need to be replaced.

If the clip is deformed due to crushing (See figure B) the fuel pipe **MUST** be replaced during bracket installation.

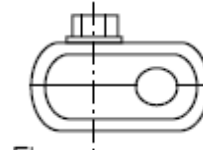

Fig
A

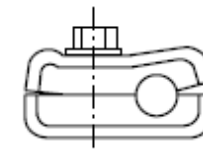
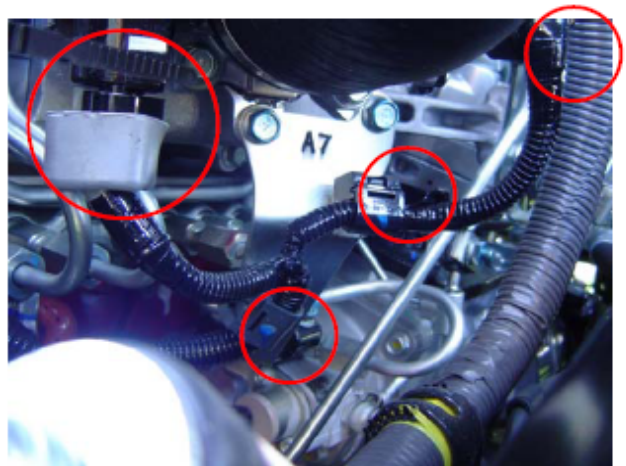

Fig.
B

3. Disconnect the throttle position sensor connector, throttle motor connector, and unclip the two (2) P-clips from the bracket. Lay the harness to the side.



4. Remove nut from holding clip and remove the upper clip.





A Toyota Group Company

TRUCKS™

Safety Recall

5. Remove the bracket mounting bolts and the bracket.

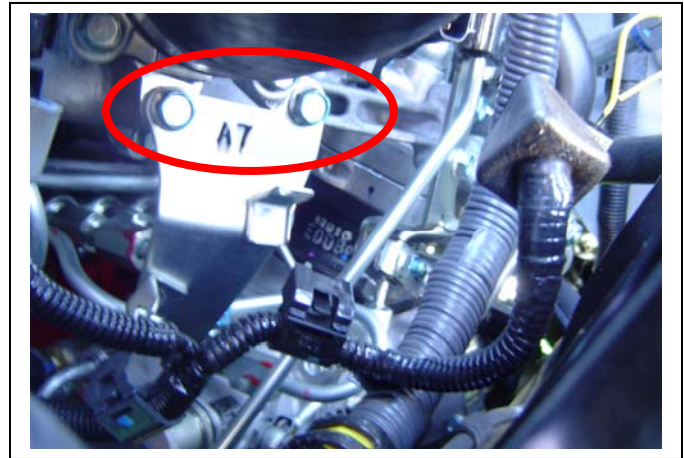

Note: Steps 6 and 7 are for pipe replacement if clip damage was found in step 2. If no damage was present proceed to step 8.

6. Remove pipe by loosening flare nuts at both ends of the pipe. Remaining fuel may run out of the pipe, clean with a rag and be careful that no dirt or debris is allowed to enter the common rail or pump fittings.

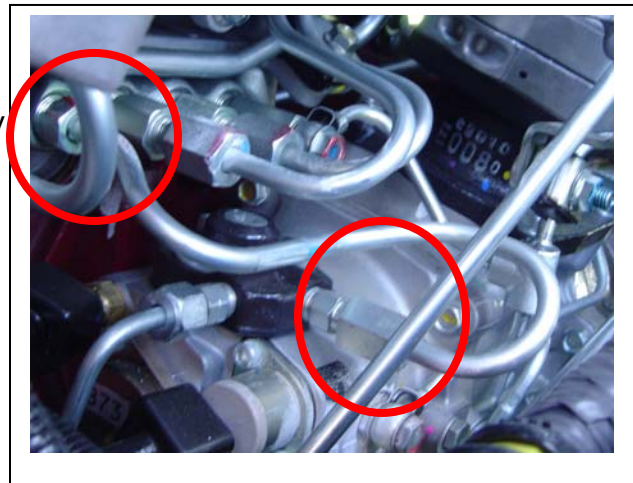

7. Install the new fuel pipe and hand tighten nuts at both ends. Once pipe is in place torque nuts.

**Fuel Pump 32 lbf/ft (44 Nm)
Common Rail 39 lbf/ft (54 Nm)**

Safety Recall

Installation:

8. Install a clip on each stud of the bracket.



9. Install bracket so the fuel pipe will rest in the grooves of the clips.

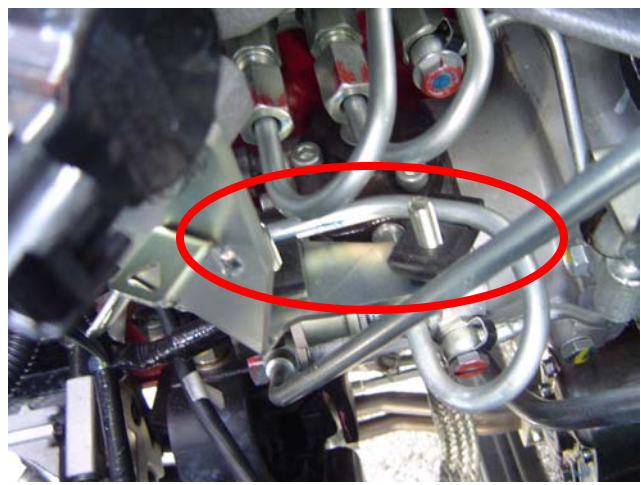

10. Install two (2) bracket mounting bolts.

Note: Make sure bolts do not cross thread, intake damage may result.

Torque to 21 lbf/ft (28.5 Nm)

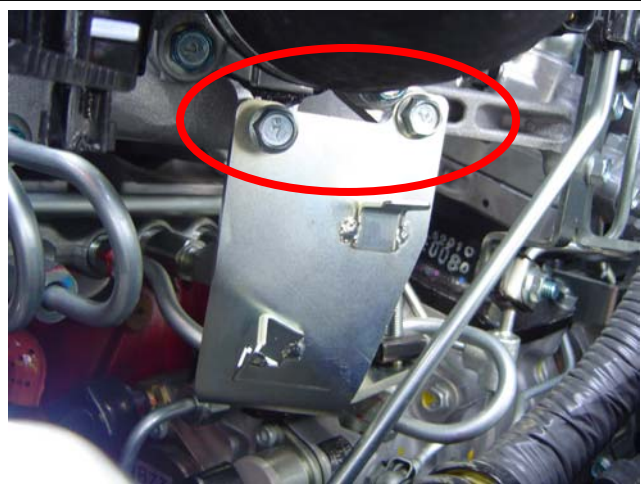

Safety Recall

11. Install two (2) upper clips and nuts.

Torque to 30 lbf/in (3.4 Nm)

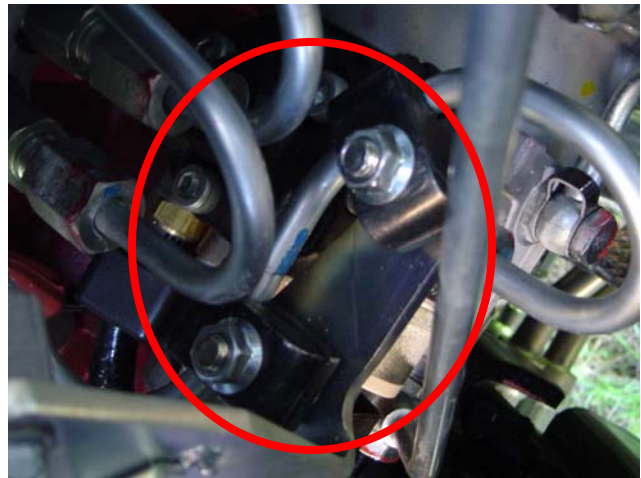

12. Reinstall throttle position sensor connector, throttle motor connector, and two (2) harness P-clips to the bracket.

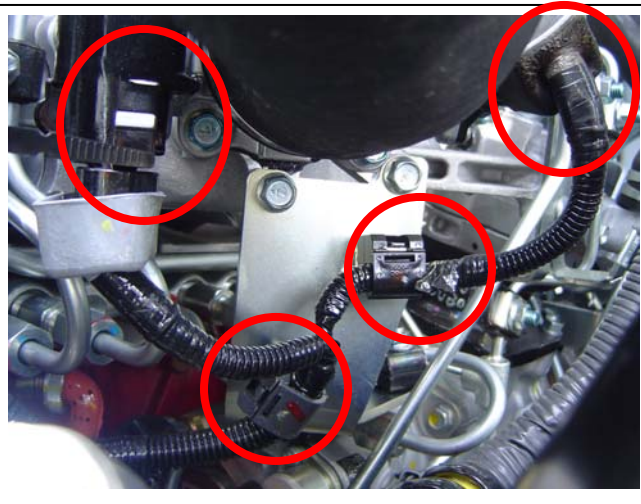

13. Reconnect negative battery cables.

Confirmation:

Double check the fuel line torque, both bracket bolts, and both clip nuts have proper torque.

Check that harness is properly routed.

Start engine to check for fuel leaks.

Claim Information:

- a) Campaign No. A5371
- b) Time Allowance: 1.0h / Unit
- c) Warranty Code: 0618998
- d) Operation Code: 06150AOT
- e) Original Part No. 9999999999