



## DCCBNA Recall Bulletin

### Exhaust Elbow Failures

**Recall Number:**

Transport Canada Recall Number: 07-242.

National Traffic and Motor Vehicle Safety Number (NHTSA): NHTSA 07V-326.

**Subject: SAFETY DEFECT – Exhaust Elbow 070774434**

**Certain Vehicles Affected:**

**Models:** Orion VII

**Model year(s): 2004-2007, Those having an ISL engine only.**

**General Information:** This notice is sent to you in accordance with the requirements of the National Traffic and Motor Vehicle Safety Act and the Canadian Motor Vehicle Safety Act. DaimlerChrysler Commercial Buses of North America (DCCBNA) has decided that a defect, which relates to motor vehicle safety, exists in some of its transit buses.

**Defect:** A weld on an exhaust elbow, part number 070774434, was incorrectly manufactured.

**Failure to upgrade:** Failure to upgrade this exhaust elbow can lead to exhaust leaking into the engine compartment and subsequent heat damage.

**Cost to Remedy:**

Parts will be provided free of charge. Labor time to perform this work has been predetermined at **1 hour to remove and replace a defective exhaust elbow**. See Claims for credit as required.

**Record of Completion:**

Report the completion of this work for each vehicle and deliver to:

**DaimlerChrysler Commercial Buses of North America  
Attention Warranty Department**

**Claims for Credit:**

Reimbursements will be issued only after the record of completion report has been submitted to **(DCCBNA)**. Include the campaign number and the date the work was performed on the copy of the work order along with the claim form. Provide claim form completion instructions.

We are sorry to cause you this inconvenience, however, we have taken this action in the interest of your continued satisfaction with our products.

If you have had this repair performed before you received this letter, you may be eligible to receive a reimbursement for the cost. Notify **(DCCBNA)** to obtain a

pre-notification remedy to the problem associated with this recall.

## In Case of Dispute

If, after contacting DCCBNA, at the location listed above, you are still unable to have the safety defect remedied, US residents may submit a complaint to the Administrator, National Highway Traffic Safety Administration, 400 Seventh Street, S.W., Washington, DC 20590. Vehicle Safety Hotline's toll free number: 1-888-327-4236 (TTY: 1-800-424-9153); or go to <http://www.safercar.gov>. Canadian residents may submit a complaint to the Director, Vehicle Safety and Energy Operations, Road Safety and Motor Vehicle Regulation, Transport Canada, Ottawa, ON, K1A 0N5 or call (613) 993-9542.

## Introduction

The following parts must be used to ensure that the procedure is successfully completed:

PART NUMBER	DESCRIPTION	QUANTITY
070774434	EXHAUST ELBOW	1

## Safety Precautions

1. Follow workshop safety procedures before starting work on the bus.
2. Follow all safety procedures outlined in the Orion VII service manual.

## Inspection

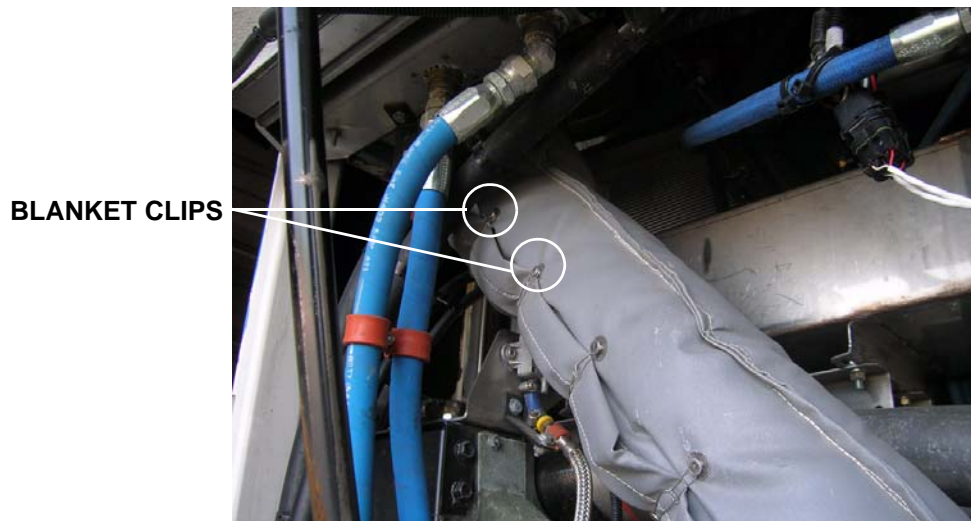

**Figure 1-1 Exhaust Blanket Clips**

1. Turn the battery isolator switch to the OFF position.

2. Open the engine compartment access door.
3. Undo the top exhaust flex pipe blanket clips. [See Figure 1-1](#)
4. Pull back the exhaust flex pipe blanket section to gain access to exhaust elbow.

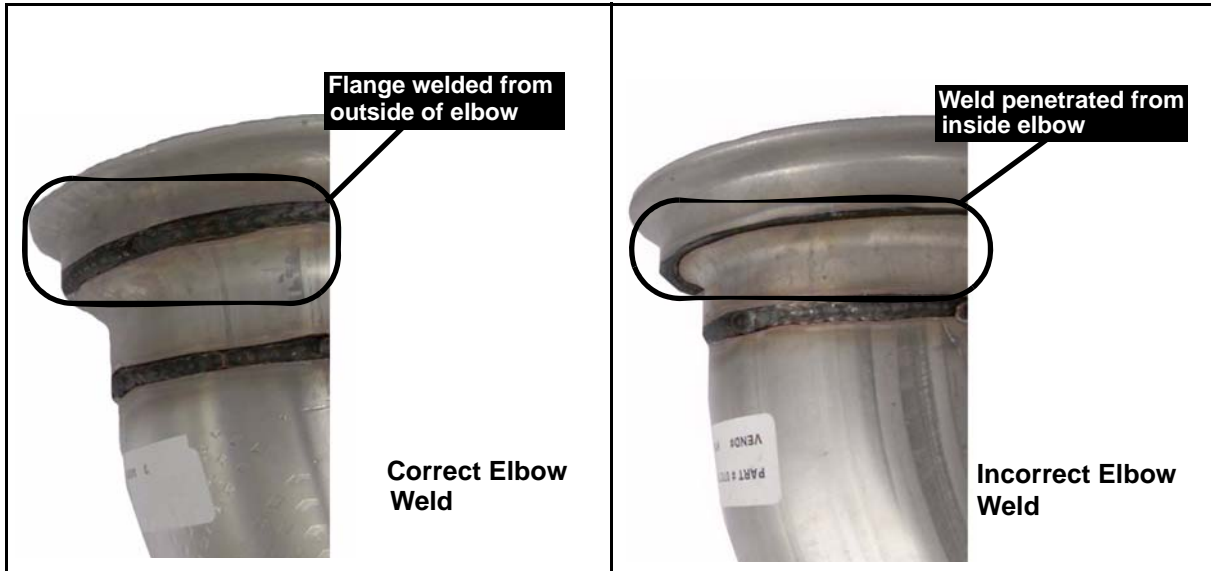
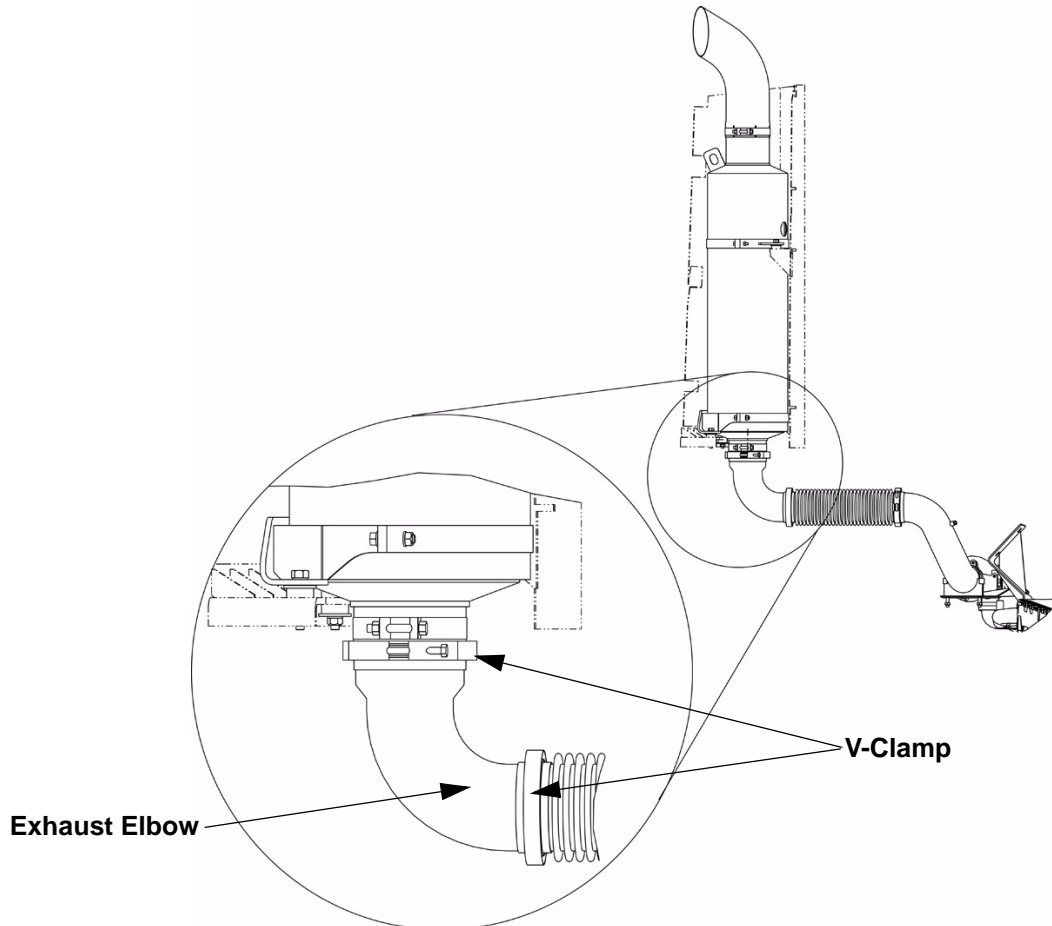

**Figure 1-2 Exhaust Elbow Welds**

5. Inspect exhaust elbow for correct welds. [See Figure 1-2](#)
  - a. If welds are found to be incorrect, exhaust elbow must be replaced. [See "Procedure" on page 4.](#)
  - b. If welds are found to be correct, no procedure needed, secure exhaust blanket clips, close engine compartment access door and turn battery isolator switch to the ON position.

## Procedure

### Removal



**Figure 1-3 V-Clamp**

1. Disconnect the exhaust elbow v-clamps. **See Figure 1-3**
2. Remove exhaust elbow.

### Installation

1. Install new exhaust elbow **070774434** at the exhaust flex pipe.
2. Secure the two exhaust elbow v-clamps.
3. Close the engine compartment access door.
4. Secure exhaust blanket clips.
5. Turn battery isolator switch to the ON position.