

VOLKSWAGEN of America, Inc.



Product Compliance
3800 Hamlin Road
Auburn Hills, MI 48326
Phone: 1 (248) 754-5000
Fax: 1 (248) 754-5093

December 14, 2006

Ms. Patricia Wallace
Recall Analyst for Safety Assurance
National Highway Traffic Safety Administration
NSA-11
U.S. Department of Transportation
400 Seventh Street, S.W.
Washington, DC 20590

Subject: Recall Campaign JS (06V-403)

Dear Ms. Wallace:

Pursuant to the requirements set forth in Part 573.6 of Title 49 of the Code of Federal Regulations, we are submitting three (3) copies of the following communications for recall campaign JS (06V-403): **Revised** dealer letter and dealer notification (including customer notification, work procedure, and accounting procedure).

If you have any questions or require additional information please contact Chris Sandvig at 248-754-5563 or Maria Cotter at (248) 754-4856.

Sincerely,

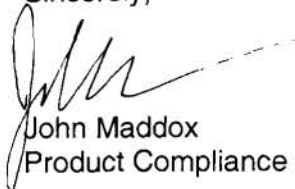

John Maddox
Product Compliance Officer

Enclosures

Audi of America, Inc.



December 2006

Subject: Revision to Safety Recall JS

Audi of America, Inc.
3800 Hamlin Road
Auburn Hills, MI 48326
United States of America
www.audiusa.com

Dear Audi Dealer Principal and Service Manager:

This letter is to inform you that the work procedure for 1996-1997 Audi A4 vehicles repaired under Safety Recall JS has been revised. The revised work procedure now includes an inspection of the ignition switch part number. If the vehicle contains ignition switch part number 4B0 905 849, no replacement of the ignition switch is required.

Please refer to the **revised Safety Recall Circular JS** posted on ElsaWeb and on AccessAudi for additional information. Please be sure to share this information with all personnel with campaign-related responsibilities.

Thank you for your cooperation and assistance in this important matter. If you have questions regarding this or any other action, please contact the Campaign Helpline at 1-800-741-2919.

Audi Product Compliance

IMPORTANT INFORMATION

Please inform and provide a copy of this document to every person in your dealership with campaign-related responsibilities, including Service, Parts and Accounting personnel. By law, dealers must correct, prior to delivery for sale or lease, any vehicle that fails to comply with an applicable Federal Motor Vehicle Safety Standard or that contains a defect relating to motor vehicle safety. If you have questions regarding this or any other campaign, please call (800) 741-2919.



Safety Recall Circular

REVISION #1 Code: JS

**Subject: 1996 - 1997 Model Year Audi A4
Replace Ignition Switch**

December 2006

Revision Summary

An inspection of the ignition switch part number has been added to the work procedure. Vehicles containing the 4B0 905 849 part number do not require replacement.

NEW information appears in red in the work procedure.

Problem Description

As a result of a problem in the production process of the ignition switch the anchor point of the spring may crack. This could potentially cause the return spring force to be insufficient for returning the ignition key to the running position after starting the engine. This condition causes electrical accessories, such as windshield wipers and headlights, to become inoperative, increasing the risk of a crash.

Corrective Action

Install a new ignition switch with an optimized anchor point.

VIN Range & Production Dates of Affected Vehicles

Produced between October 1995 & February 1997

1996-1997 Audi A4 (USA)

WAU__8D_TA047001 - WAU__8D_VA294397

1996-1997 Audi A4 (CAN)

WAU__8D_TA056819 - WAU__8D_VA292599

NOTE: Check ElsaWeb on the day of repair to verify vehicle eligibility and attach the screen print to the repair order. This is the only valid campaign inquiry and verification source. Some vehicles may be involved in an additional action(s); any additional work can be done while the vehicle is in for this action.

Allocation Report of Affected Vehicles

In the Service Manager's Package, dealers with affected vehicles will receive a report containing the complete VIN with customer name and address data. Dealers will not receive a report if they have no affected vehicles.

NOTE: The allocation report contains owner names and addresses obtained from Motor Vehicle Registration Records. By law, this data may only be used for recall purposes. Use for any other reason may be a violation of law in many states/provinces. Accordingly, you must limit the use of this report.

Parts Information and Allocation

On or about November 17, 2006 you will have received a 25% initial allocation of parts. If you have exhausted your allocated parts for vehicles affected by this safety recall, but have exceeded your Upper Order Limit, please submit your requests for additional material via email to upperorderlimits@audi.com.

Owner Notification Mailing

On or about November 27, 2006 Audi will notify all known owners of affected vehicles by first-class mail. A sample copy of the owner letter is enclosed.

Claim Entry Procedure

Immediately upon completion of the repair work, enter the correct code listed below. Claims will only be paid for vehicles that show this campaign open in ElsaWeb on the day of the repair. To help ensure prompt and proper payment, attach the screen print to the repair order.

Customer Assistance Expiration Date

The additional CAP budget provided to dealers for customer satisfaction assistance is available for 18 months, through May 1, 2008, after which time it will expire and will no longer be available.

Damage Code	Time Units	Work Scope
JS11	90 T.U.	– Inspect Ignition Switch, no replacement required
JS12	100 T.U.	– Remove and Replace Ignition Switch 1 Switch 4A0 905 849B
JS20	0 T.U.	– Customer refused repairs
There is NO reimbursement for Vehicle Wash or Loaner The system will enter labor & part applicable to the codes above		
SUB LABOR		LOANER/RENTAL
None		\$0 Utilize Service Loaner

The repair information in this document is intended for use only by skilled technicians who have the proper tools, equipment and training to correctly and safely maintain your vehicle. These procedures are not intended to be attempted by "do-it-yourselfers," and you should not assume this document applies to your vehicle, or that your vehicle has the condition described. To determine whether this information applies, contact an authorized Audi dealer. ©2006 Audi of America, Inc. and Audi Canada. All Rights Reserved.

CUSTOMER ASSISTANCE COVERAGE

PID: JSCA

Claim Type: W5

Dealers have been provided additional CAP budget for customer satisfaction for the JS Safety Recall. Customer assistance reimbursement will expire 18 months after initiation of the JS Safety Recall campaign

Audi recommends the following:

- Interior detailing or car wash
- Gift certificate for use from Audi Collection
- Complete fill-up of fuel tank
- Loaner if dealer does not belong to Service Loaner Program

Customer Letter Example (USA)

November 2006

**Subject: Safety Recall JS
1996-1997 Model Year Audi A4
Replace Ignition Switch**

Dear Audi Owner:

This notice is sent to you in accordance with the requirements of the National Traffic and Motor Vehicle Safety Act. Audi has decided that a defect, which relates to motor vehicle safety, exists in some 1996-1997 model year Audi A4 vehicles. Our records show that you are the owner of one of these vehicles.

What Is The Problem?

As a result of a problem in the production process of the ignition switch, the anchor point of the spring may crack. This could potentially cause the return spring force to be insufficient for returning the ignition key to the running position after starting the engine. This condition causes electrical accessories, such as windshield wipers and headlights to become inoperative, increasing the risk of a crash.

What Audi Will Do

In order to correct this defect, a new ignition switch with an optimized anchor point will be installed.

What We Would Like You To Do

Please contact your authorized Audi dealer and arrange for an appointment without delay. This service will take about one hour and will be free of charge. Please keep in mind that your dealer may need additional time for the preparation of the repair, as well as to accommodate their daily workshop schedule.

Lease Vehicles

If you are the lessor and registered owner of the vehicle identified in this action, the law requires you to forward this information immediately via first-class mail to the lessee within ten (10) days of receipt of this notification.

Have You Changed Your Address Or Sold The Vehicle?

If you have, please fill out the enclosed prepaid Owner Reply card and mail it to us so we can update our records.

Reimbursement of Expenses

If you have previously paid for replacement of the ignition switch, the enclosed form explains how to request reimbursement. We would be pleased to review your reimbursement request.

Service Help from Us

If your authorized Audi dealer fails or is unable to complete this work free of charge within a reasonable time, please call or write to:

*Audi of America, Inc.
Attn: Customer Relations – Hills East (JS)
3499 West Hamlin Road
Rochester Hills, MI 48309
1-800-822-2834*

If you still cannot obtain satisfaction, you may file a complaint with: Administrator, National Highway Traffic Safety Administration, U.S. Department of Transportation, 400 Seventh Street, SW, Washington, DC 20590; or call the toll-free Vehicle Safety Hotline at 1-888-327-4236 (TTY: 1-800-424-9153); or go to <http://www.safercar.gov>.

We regret any inconvenience this matter may cause. Thank you for your continued loyalty!

Audi Product Compliance

Customer Letter Example (CANADA)

November 2006

**Subject: Safety Recall JS
1996-1997 Model Year Audi A4
Replace Ignition Switch**

Dear Audi Owner:

This notice is sent to you in accordance with the requirements of the Canadian Motor Vehicle Safety Act. Audi has decided that a defect, which relates to motor vehicle safety, exists in some 1996-1997 model year Audi A4 vehicles. Our records show that you are the owner of one of these vehicles.

What Is The Problem?

As a result of a problem in the production process of the ignition switch the anchor point of the spring may crack. This could potentially cause the return spring force to be insufficient for returning the ignition key to the running position after starting the engine. This condition causes electrical accessories, such as windshield wipers and headlights to become inoperative, increasing the risk of a crash.

What Audi Will Do

In order to correct this defect, a new ignition switch with an optimized anchor point will be installed.

What We Would Like You To Do

Please contact your authorized Audi dealer and arrange for an appointment without delay. This service will take about one hour and will be free of charge. Please keep in mind that your dealer may need additional time for the preparation of the repair, as well as to accommodate their daily workshop schedule.

Lease Vehicles

If you are the lessor and registered owner of the vehicle identified in this action, the law requires you to forward this information immediately via first-class mail to the lessee within ten (10) days of receipt of this notification.

Have You Changed Your Address Or Sold The Vehicle?

If you have, please fill out the enclosed prepaid Owner Reply card and mail it to us so we can update our records.

Reimbursement of Expenses

If you have previously paid for replacement of the ignition switch, the enclosed form explains how to request reimbursement. We would be pleased to review your reimbursement request.

Service Help from Us

If your authorized Audi dealer fails or is unable to complete this work free of charge within a reasonable time, please call or write to:

*Audi Canada
Attn: Customer Relations (JS)
P.O. Box 842, Stn. A
Windsor, ON N9A 9Z9
1-800-822-2834*

We regret any inconvenience this matter may cause. Thank you for your continued loyalty!

Audi Product Compliance

Parts:

Quantity	Part Number	Part Name
1	4A0 905 849 B	Ignition switch

Work Sequence

Section A - Disassembly

- **Open hood** and disconnect ground cable (GND) from the negative (-) battery terminal

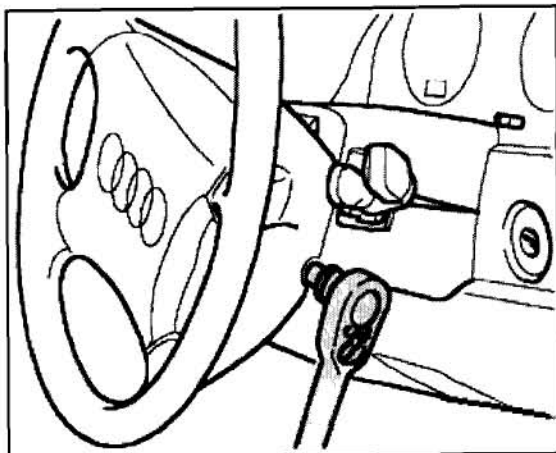

Note: Observe all safety precautions before starting work on any part of the airbag system

- ⇐ Remove two bolts securing air bag to steering wheel using a T30 torx bit

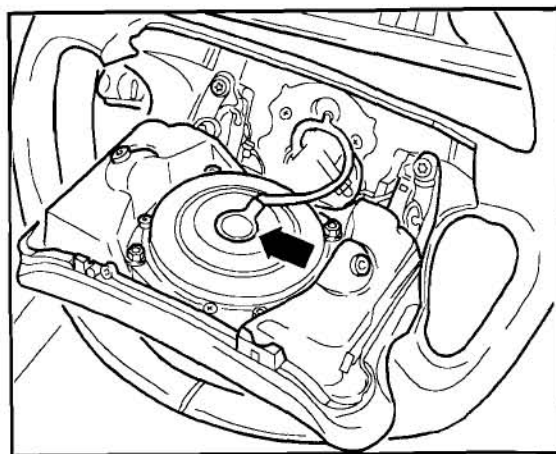

- ⇐ Disconnect harness connector -arrow- from spiral spring
- ⇐ Remove air bag and set aside by placing airbag unit down with padded side facing upward
- Pull out adjustable steering column as far as it will go and set to lowest position

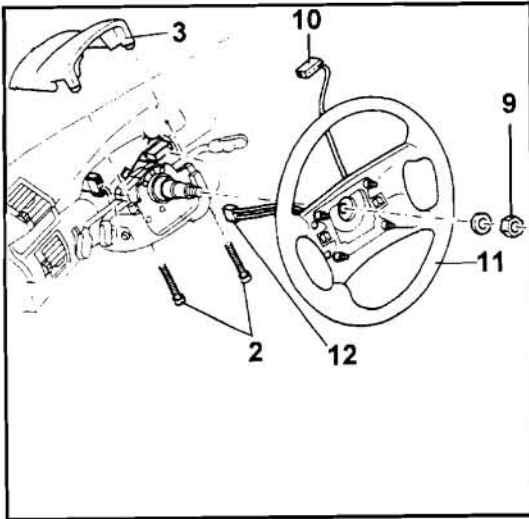

- ⇐ Remove two Phillips screws -2- from lower half of trim for steering column
- ⇐ Carefully remove upper half -3- of steering column cover
- ⇐ Disconnect harness connector -10- for horn contact and -12- for air bag spiral spring
- Turn steering wheel to straight-ahead position and mark steering wheel for reassembly
- ⇐ Remove nut -9- securing steering wheel and carefully remove steering wheel -11- with spiral spring

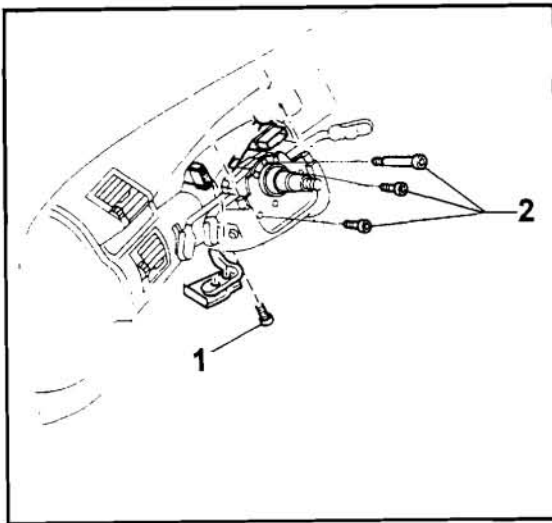

- ⇐ Remove three Phillips head screws -2- from steering column lower cover
- ⇐ Remove the M4 socket head bolt -1- from bottom of the lower steering column cover
- Carefully pull lower steering column cover rearward and off steering column shaft



Tip: Cover cannot be fully removed without removing the steering column lock lever. The cover can temporarily hang on the lock lever

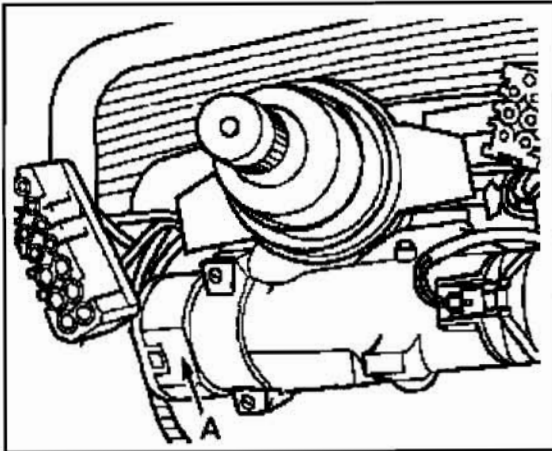

- ⇐ Disconnect ignition harness connector from end -A- of ignition switch

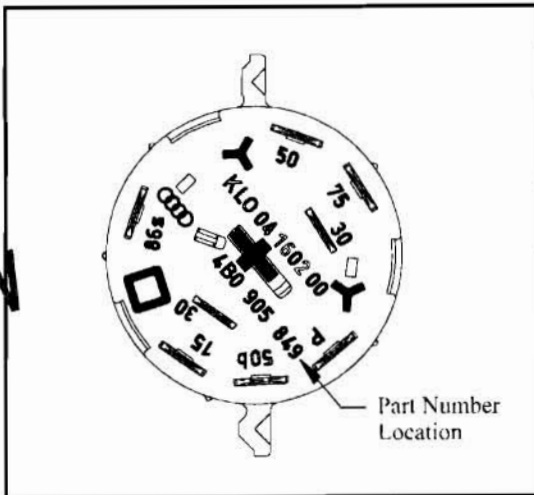

NEW

- ⇐ Look at end of ignition switch for part number 4B0 905 849
- If ignition switch has part number 4B0 905 849, **no** new ignition switch is needed, go to Section C
- If ignition switch does not have part number 4B0 905 849 at this location, proceed to Section B

Section B – Ignition Switch Removal and Installation

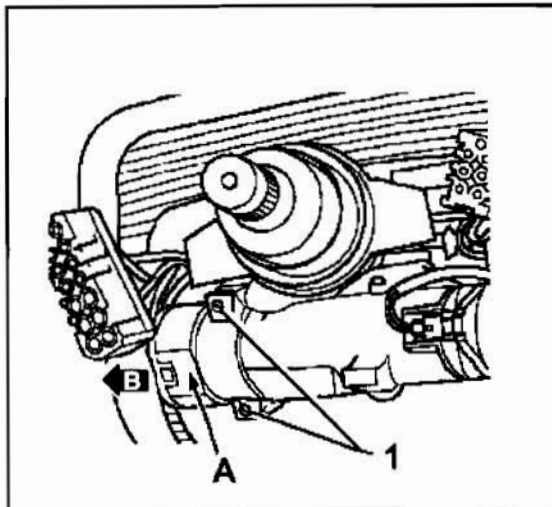

- ⇐ Remove paint seal covering screws -1-
- ⇐ Loosen two screws -1- with a small flat screwdriver, and pull ignition switch -A- out of housing in direction of -arrow B-



Tip: Ignition switch and lock cylinder must be in the same position, e.g. "Ignition off" when installing new switch; otherwise, switch will not go into housing

- Install new ignition switch (4A0 905 849 B) fully into housing and tighten screws
- Seal screws with any color of locally available paint

Section C - Reassembly

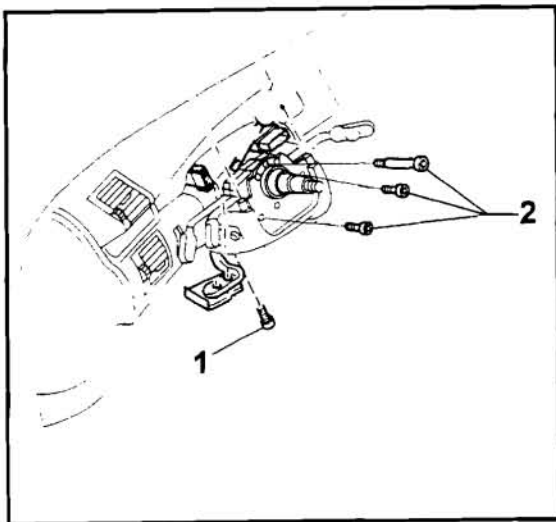

- Reconnect ignition harness connector to ignition switch
- ⇐ Reinstall lower steering column cover and secure with 3 Phillips screws -2- and socket head bolt -1-

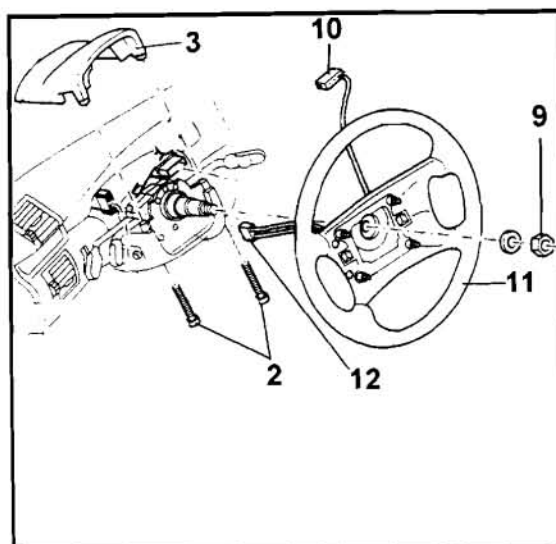

- ⇐ Carefully reinstall steering wheel -11- with spiral spring onto steering column
- ⇐ Secure steering wheel with nut -9- and tighten to 40 Nm (30 ft. lbs.)
- ⇐ Reconnect airbag electrical connector -12- and horn electrical connector -10-
- ⇐ Reinstall upper steering column cover -3- and secure with two screws -2-
- Carefully place air bag on steering wheel and reconnect harness connector from spiral spring to air bag



Tip: When reconnecting harness, make sure connector audibly engages (*clicks*)

- Secure air bag to steering wheel reusing bolts and tighten 7 Nm (62 in. lbs.)



WARNING!

Make certain the passenger compartment is not occupied before connecting the battery

- Turn ignition switch on and reconnect ground cable (GND) to the negative (-) battery terminal and torque bolt to 5 Nm (44 in. lbs.)

- Reset time on clock
- Reset radio stations presets
- Check system with VAG 1551 or VAS 5051 and clear any faults
- Set engine basic settings as required
- Program windows for "one-touch up/down" feature, where applicable
- Destroy and properly discard all removed parts

WORK IS COMPLETE