

# PREVOST

Saint-Nicolas, October 12, 2006

Mr. Daniel Smith,  
Associate Administrator for Safety Assurance  
National Highway Traffic Safety Administration  
400, Seventh Street S.W.  
Washington, DC 20590 USA  
Fax: (202) 366-7882

## **SUBJECT: SAFETY RECALL NOTIFICATION**

Dear Mr. Smith,

As a coach manufacturer, Prévost Car Inc. advises you in accordance with your safety law, Part 573.6, that we have found a defect on some of our vehicles that does not meet the US Federal Motor Vehicle Standards and Regulations part 573.5.

The vehicles potentially affected by the defect are as follows:

**MAKE: PRÉVOST**

<b>Model</b>	<b>VIN's</b>		<b>Manufacturing Dates</b>
H3-45 VIP equipped with ISS MODEL YEAR : 2004 - 2005	From 2PCV3349641014793	To 2PCV3349851010116	Between May 2003 and October 2004
XLII Vehicles equipped with ISS MODEL YEAR : 2004 - 2005	From 2PCY3349741028215	To 2PCY3349951028539	Between May 2003 and October 2004

The total number of vehicles potentially affected by the defect is estimated to be 423 in the U.S. and 35 in Canada, and the total number of the potentially affected vehicles in North America manufactured between May 2003 and October 2004 is 458.

The estimated percentage of the potentially affected vehicles that contain the defect is 2 % of the total manufactured quantity.

## **THE DEFECT MAY BE DESCRIBED AS FOLLOWS:**

It has come to the attention of Prévost Car Inc. that on the above-mentioned vehicles, material that does not meet Prévost Car requirements may have been installed on the independent front suspension. Overheating of the bell crank and idler arm mounting spindles during the forging process has significantly weakened the material, therefore, requiring replacement. In certain heavy loading conditions these defective parts could break, resulting in a loss of steering control which could result in a crash.

For more information on this recall or technical assistance on how to perform this safety recall, please contact your service manager or the nearest service center.

## **THE EVENTS THAT WERE THE BASIS FOR THE DETERMINATION OF THE EXISTENCE OF A SAFETY DEFECT ARE:**

Since February 2006, we have experienced 2 spindle shaft failures. The affected vehicles are equipped with independent front suspension. Along with the supplier, our engineers have investigated the possible causes of the problem. The affected part has been produced by the same supplier for over 10 years and no failures had happened before. The supplier has revised each step of the shaft fabrication and determined that the first failure was due to human error in the fabrication process. A month after a second part failed in very similar circumstances. With this additional information, the root cause of the problem was identified as over heating of the raw material before the forging process. This had negatively changed the molecular structure of the parts and 4 to 5 other parts in the chain of fabrication have been determined critical also. Quickly the decision has been made to create a safety recall. The batch containing those possible defective shafts has been identified and the related coach list has been prepared.

### **PRÉVOST CAR INC.**

MANUFACTURIER D'AUTOCARS • HIGHWAY COACH MANUFACTURER  
AFTER-SALES SERVICE DEPARTMENT / SERVICE APRÈS-VENTE

650, ch. Olivier, Saint-Nicolas, (Qc), Canada, G7A 2N1 • Tél. : (418) 831-2046, Fax : (418) 831-9301

**MEASURES TO BE TAKEN TO REPAIR THE DEFECT:**

Safety recall no. 06-07 will explain the complete procedure required.

As requested in paragraph 573.2 (8), three (3) copies of the letter that our customers (Defect Notification) will receive on that matter, and three (3) copies of Safety recall no. 06-07 are enclosed for your perusal.

If you require any information on that campaign, do not hesitate to contact us.

Truly yours,

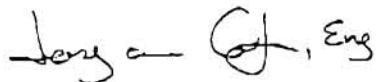
A handwritten signature in black ink, appearing to read "Josyane Côté, Eng." with a stylized flourish at the end.

Josyane Côté, Eng.

Technical Publications Manager



**PREVOST**

ENREGISTRÉ - REGISTERED  
ISO 9001 & ISO 14001

## SAFETY RECALL

Sr06-07



DATE : OCTOBER 2006	SECTION : 14
SUBJECT : REPLACING BELL CRANK AND IDLER ARM MOUNTING SPINDLE	

### APPLICATION

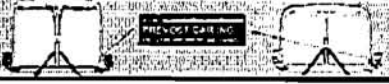
Model	VIN	
H3-45 VIP equipped with ISS Model Year : 2004 - 2005	From 2PCV3349641014793 up to 2PCV3349851010116 incl.	
XLII Vehicles equipped with ISS Model Year : 2004 - 2005	From 2PCY3349741028215 up to 2PCY3349951028539 incl.	
This Safety Recall does not necessarily apply to all the above-mentioned vehicles, some vehicles may have been modified before delivery. The owners of the vehicles affected by this recall will be advised by a letter indicating the Vehicle Identification Number (VIN) of each vehicle concerned.		

### DESCRIPTION

On the above-mentioned vehicles, material that does not meet PrevoSt Car requirements may have been installed on the independent front suspension. Overheating of the bell crank and idler arm mounting spindles during the forging process has significantly weakened the material, therefore, requiring replacement. In certain heavy loading conditions these defective parts could break, resulting in a loss of steering control which could result in a crash.

For more information on this recall or technical assistance on how to perform this safety recall, please contact your service manager or the nearest service center.

### MATERIAL

Part No.	Description	Identification	Qty
160983	Spindle, Mounting, Bell Crank and Idler Arm		2
507351	Boot, Dust		2
977939	Nut, Hex Flange Nylon Insert CP M14-2		8

#### NOTE

Material can be obtained through regular channels.

## PROCEDURE



### DANGER

Raise vehicle or park vehicle over a repair pit, apply parking brake, stop engine and set battery master switch(es) to the OFF position prior to working on the vehicle. Prior to working under an air-suspended vehicle, it is strongly recommended to securely support the body at the recommended jacking points.

### Bell Crank and Idler Arm Removal

1. Remove cotter pin from bell crank ends and from tie rod end (Refer to figures 1 and 2).
2. Remove cotter pin from idler arm ends and from tie rod end (Refer to figures 1 and 2).

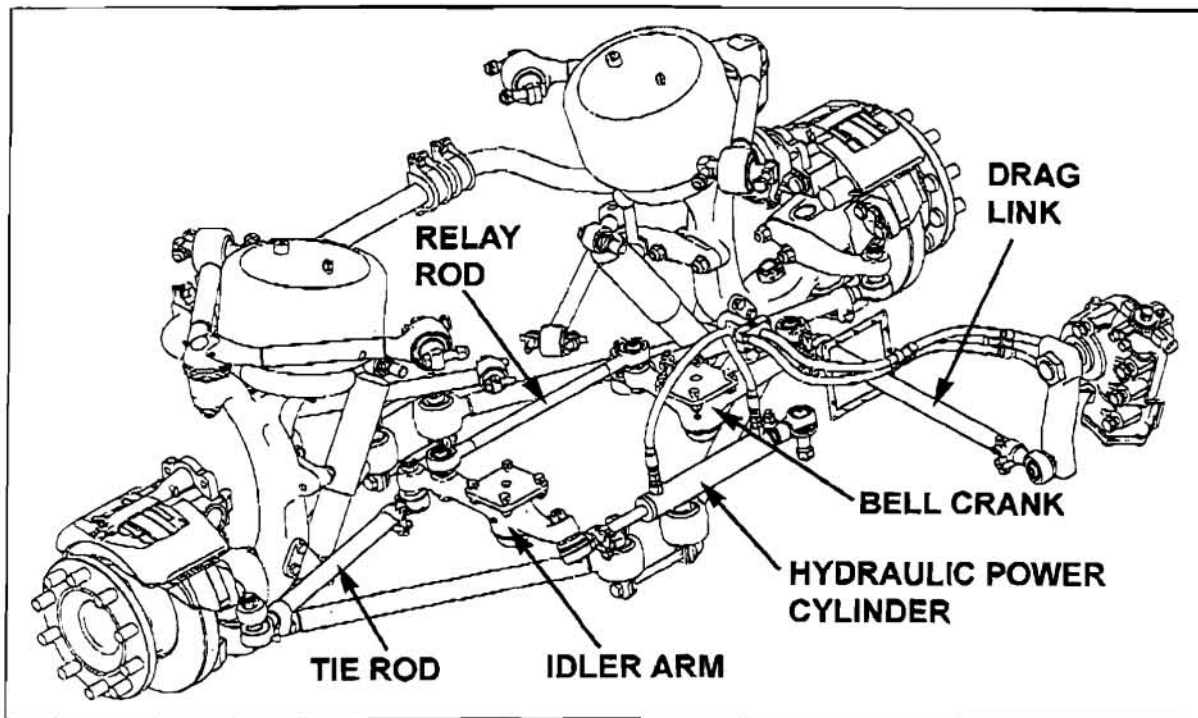

FIGURE 1: IFS

3. Unscrew fixing nut from drag link end, from relay rod end and from tie rod end. Separate socket assemblies from bell crank.

#### NOTE

Use a piece of wire to anchor loosen end of relay rod and tie rod in order to prevent placing an excessive load on opposite socket end.

4. Unscrew fixing nut from hydraulic power cylinder end, from relay rod end and from tie rod end. Separate socket assemblies from idler arm.
5. Remove relay rod and set aside.

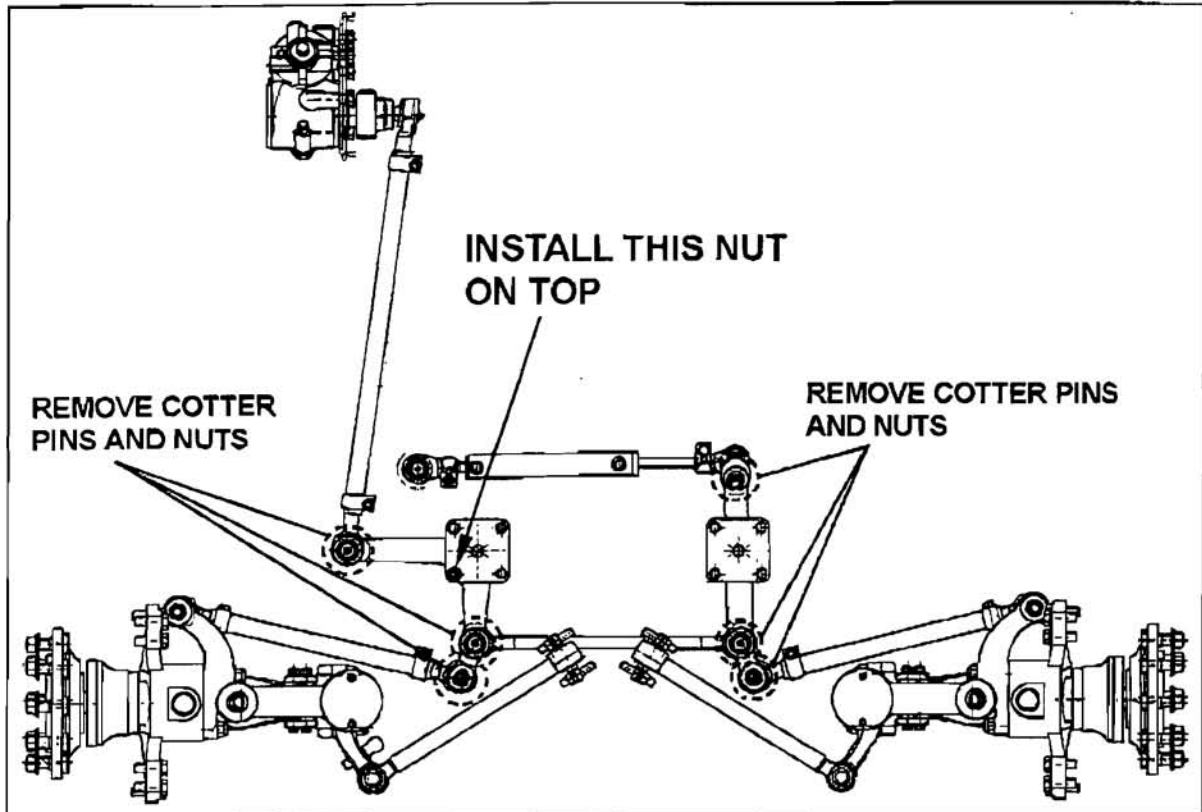

FIGURE 2: LOCATION OF COTTER PINS AND NUTS

6. Move tie rods and drag link out of the way.
7. Remove bell crank and idler arm cap.
8. Remove cotter pin then unscrew bell crank and idler arm fixing nut.



### CAUTION

Be careful when removing fixing nut, bearing assembly may fall.

9. Remove bell crank and idler arm from their respective mounting spindle.
10. Unscrew four nuts fixing bell crank mounting spindle to suspension subframe.
11. Unscrew four nuts fixing idler arm mounting spindle to suspension subframe.
12. Remove bell crank and idler arm mounting spindles from suspension subframe.
13. Separate backup ring from former bell crank and idler arm mounting spindles.

### NOTE

*Heating up the backup ring using a blow torch may be necessary to separate from mounting spindle.*

14. Clean up backup rings.
15. Remove old grease and clean up the inside of bell crank and idler arm.

## Bell Crank and Idler Arm Installation

1. Install backup ring onto new bell crank and idler arm mounting spindles (160983).
2. Remove rust if necessary and using alcohol, clean up the bearing surface between bell crank mounting spindle and suspension subframe and also between idler arm mounting spindle and suspension subframe.
3. Install the bell crank and idler arm mounting spindles onto the vehicle suspension subframe and secure using new nuts (977939). Torque to 90-105 Lbs-ft dry (122-142 Nm).

### NOTE

Install the bell crank rear left hand side nut on top as indicated in figure 2.

4. Apply a film of grease onto the backup rings and install onto the bell crank and idler arm mounting spindles.
5. Install new dust boot (507351) onto bell crank and idler arm.

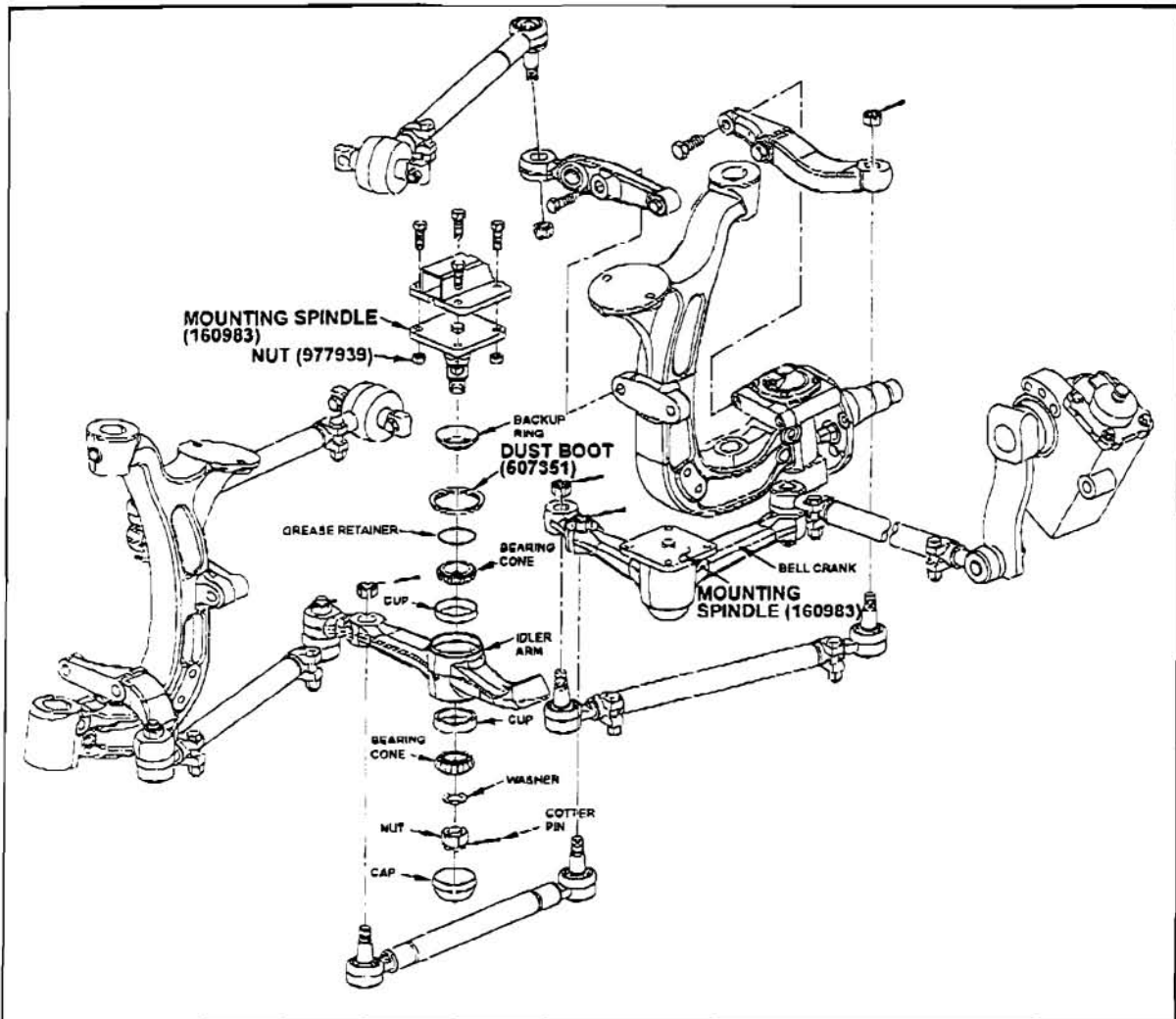

FIGURE 3: BELL CRANK AND IDLER ARM STEERING RODS ARRANGEMENT

6. Install bell crank onto its mounting spindle, while holding the bell crank, slide on the bearing assembly, thrust washer and secure using nut.
7. Install idler arm onto its mounting spindle, while holding the bell crank, slide on the bearing assembly, thrust washer and secure using nut.
8. Firmly tighten nut (Fig. 4).

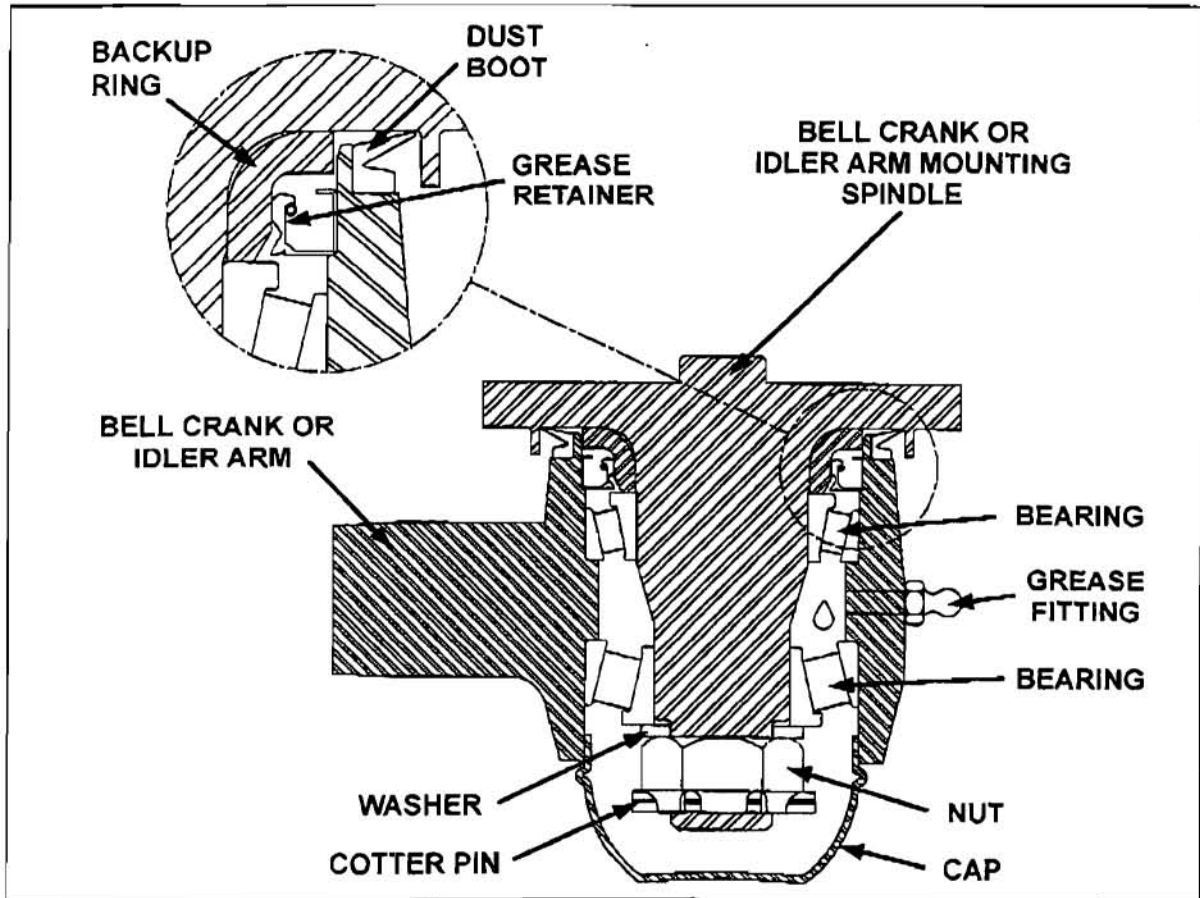

FIGURE 4: BELL CRANK OR IDLER ARM MOUNTING SPINDLE INSTALLATION

9. Unscrew nut until bell crank or idler arm starts to turn by the application of 1 to 3 pounds load (Fig. 5).

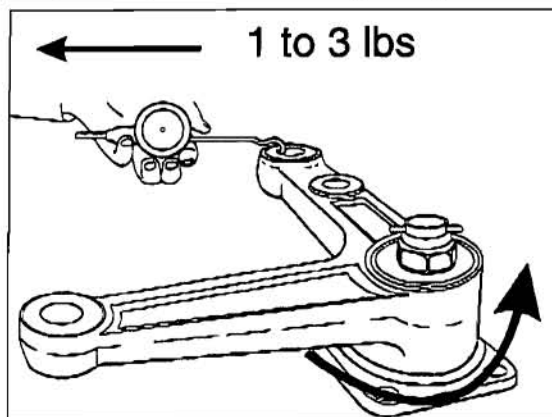

FIGURE 5: APPLICATION OF 1 TO 3 POUNDS LOAD 18045

10. Check for loose bearings by applying an up and down load on bell crank or idler lever. **The lever is not supposed to move in the vertical axis direction.**
11. Align nut with cotter pin slot (tighten) and install a new cotter pin.

**NOTE**

*Bend cotter pin around the nut (Fig. 4). Do not bend the cotter pin in the direction of the cap, because it may interfere with the cap.*

12. Install cap onto bell crank and idler arm.
13. Reconnect relay rod ends, tie rod ends and drag link end to bell crank and idler arm.
14. Torque nuts to 150-200 Lbs-ft dry (203-271 Nm).
15. Align nuts with cotter pin slots (tighten) and install new cotter pins.
16. Lubricate bell crank and idler arm through grease fitting.

## **WARRANTY**

This modification is covered by Prevost Car's normal warranty. We will reimburse you the parts and four hours (4.0) of labor upon receipt of the PARTS and a completed A.F.A. form on which you must specify as per "Safety Recall 06-07". **You also have to fill the "Safety Recall Certification Sheet" provided with this bulletin and return it with your A.F.A. form to be reimbursed.**

**Parts disposition:**

- Return to Prevost Car with A.F.A. for full reimbursement.

October 12, 2006

**DEFECT NOTIFICATION**

Dear Customer:

This notice is sent to you in accordance with the requirements of the National Traffic and Motor Vehicle Safety Act of U.S.A.

Prévost Car Inc. has decided that a defect which relates to motor vehicle safety exists in certain 2004-2005 H3-45 VIP equipped with ISS and in certain 2004-2005 XLII Vehicles equipped with ISS. Prévost Car Inc., as coach manufacturer, has recently noticed that:

On the above-mentioned vehicles, material that does not meet Prévost Car requirements may have been installed on the independent front suspension. Overheating of the bell crank and idler arm mounting spindles during the forging process has significantly weakened the material, therefore, requiring replacement. In certain heavy loading conditions these defective parts could break, resulting in a loss of steering control which could result in a crash.

For more information on this recall or technical assistance on how to perform this safety recall, please contact your service manager or the nearest service center.

<b>Model</b>	<b>Serial Numbers</b>
H3-45 VIP equipped with ISS Model Year : 2004 - 2005	From 2PCV3349641014793 up to 2PCV3349851010116 incl.
XLII Vehicles equipped with ISS Model Year : 2004 - 2005	From 2PCY3349741028215 up to 2PCY3349951028539 incl.

**CORRECTIVE ACTIONS:**

You must refer to the enclosed Safety Recall no. 06-07 and perform the stated procedure. Federal regulation requires that any vehicle lessor receiving this recall notice must forward a copy of this notice to the lessee within ten days.

**REPORTING REQUIREMENT:**

In order to verify and document the corrective action taken on your vehicle(s) pursuant to the requirements of the Federal Motor Vehicle Safety Regulations, we are enclosing a "**SAFETY RECALL CERTIFICATION**" sheet. When the vehicle(s) is (are) repaired, this (these) sheet(s) must be completed and returned to PRÉVOST CAR INC. head office.

**LABOR & PARTS REIMBURSEMENT:**

Prévost Car Inc. will reimburse you parts and labor incurred.

Federal laws require that you be informed of your right to notify the Department of Transportation if you are unable to have the defect remedied without charge. The address for this purpose is:

National Highway Traffic Safety Administration  
Washington, DC 20590  
USA  
Auto Safety Hotline: 1-888-327-4236.

If any assistance is required, please contact your local distributor or the PRÉVOST CAR INC. after sales service department.

We regret any inconvenience which this situation may cause you. However, we are concerned about your safety; rest assured that PRÉVOST CAR INC. is making all efforts to remedy the defect as quickly as possible in the interest of motor vehicle safety.

Truly yours,

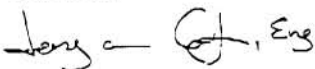

Josyane Côté, Eng.  
Technical Publications Manager.