

# DAIMLERCHRYSLER

RECEIVED  
NVS-215

2006 JUN 20 A 8:08

OFFICE OF  
DEFECTS INVESTIGATION

DaimlerChrysler Corporation

Stephan J. Speth

Director

Vehicle Compliance & Safety Affairs

June 14, 2006

Mr. Daniel Smith  
Associate Administrator, Safety Assurance  
National Highway Traffic Safety Administration  
400 Seventh Street, S.W.  
Washington, D.C. 20590

Dear Mr. Smith:

Reference: NHTSA Identification Number 06V-149

Enclosed are representative copies of communications relating to the 2006 model year vehicles involved in the referenced recall. DaimlerChrysler expects to notify dealers during the week of June 19, 2006 and to begin owner notification during the week of June 26, 2006. The exact number of manufactured vehicles in the recall is 44,366.

The involved Vehicle Identification Number range is:

<u>Low</u>	<u>High</u>
6H151134	6H418776

(VIN last eight characters) - 6 = 2006; H = Brampton Assembly Plant, Ontario Canada; and the last six digits = sequential number.

**We caution that the above range represents only the lowest and highest VIN sequential numbers included in the recall. This range cannot be used to determine conclusively that a vehicle is involved in the recall because most vehicles with a VIN within the range are not affected by the recall.**

This completes DaimlerChrysler's package of information for this recall as required by the Defects Report Regulation.

Sincerely,

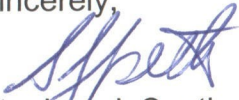

Stephan J. Speth, Director  
Vehicle Compliance and Safety Affairs

Enclosure: Recall F18

cc: K.C. DeMeter



June 2006

2006 JUN 20 A 8:08

Dealer Service Instructions for:

**Safety Recall F18 - Rear Brake Tubes****Models****2006 (LX) Chrysler 300, Dodge Charger and Magnum**

*NOTE: This recall applies only to the above vehicles equipped with a 2.7L engine ("R" in the 8<sup>th</sup> VIN Position) and mid-model year tracking (sales code XZZ) built through February 20, 2006 (MDH 022009).*

**IMPORTANT:** Some of the involved vehicles may be in dealer new vehicle inventory. Federal law requires you to complete this recall service on these vehicles before retail delivery. Dealers should also consider this requirement to apply to used vehicle inventory and should perform this recall on vehicles in for service. Involved vehicles can be determined by using the VIP inquiry process.

**Subject**

The rear brake tubes on about 44,000 of the above vehicles may rub against the Exhaust Gas Recirculation (EGR) tube and cause a brake fluid leak. Brake fluid leaking onto a hot exhaust manifold can cause an engine compartment fire. A brake fluid leak could also increase the vehicle's stopping distance and cause a crash without warning.

**Repair**

The rear brake tubes must be inspected for damage and a plastic retainer clip must be installed on all vehicles to secure the brake tubes to the right front shock tower. If a brake tube has been damaged, it must be replaced.



**Alternate Transportation**

Dealers should attempt to minimize customer inconvenience by placing the owner in a loaner vehicle if inspection determines that brake tube replacement is required and the vehicle must be held overnight.

**Parts Information****A. Brake Tube Retaining Clip**

<u>Part Number</u>	<u>Description</u>
CAF0F181	Clip, Plastic Brake Tube Retaining

Each package contains the following component:

<u>Quantity</u>	<u>Description</u>
1	Clip, Plastic Brake Tube Retaining

**Each dealer** to whom vehicles in the recall were assigned will receive enough Brake Tube Retaining Clip Packages to service about 20% of those vehicles.

**B. Rear Brake Tubes**

<u>Part Number</u>	<u>Description</u>
CAF0F182	Brake Tube (Left Rear Wheel)
CAF0F183	Brake Tube (Right Rear Wheel)

Due to the small number of involved vehicles expected to require brake tube(s), no parts will be distributed initially. Brake tube(s) **should be ordered only after inspection determines that replacement is required.** *Very few vehicles are expected to require brake tube(s) replacement.*

**Service Procedure****A. Inspect Rear Brake Tubes**

1. Open the hood.
2. Inspect the rear brake tubes that route along the right shock tower for contact with the engine EGR tube (Figure 1).
  - If neither brake tube has contacted the EGR tube or has lightly contacted the EGR tube without rubbing through the black protective coating on the tube, continue with **Section C – Install Rear Brake Tube Retaining Clip**.
  - If either brake tube has contacted the EGR tube and is leaking brake fluid or has rubbed through the black protective coating, continue with **Section B – Replace Rear Brake Tube(s)**.

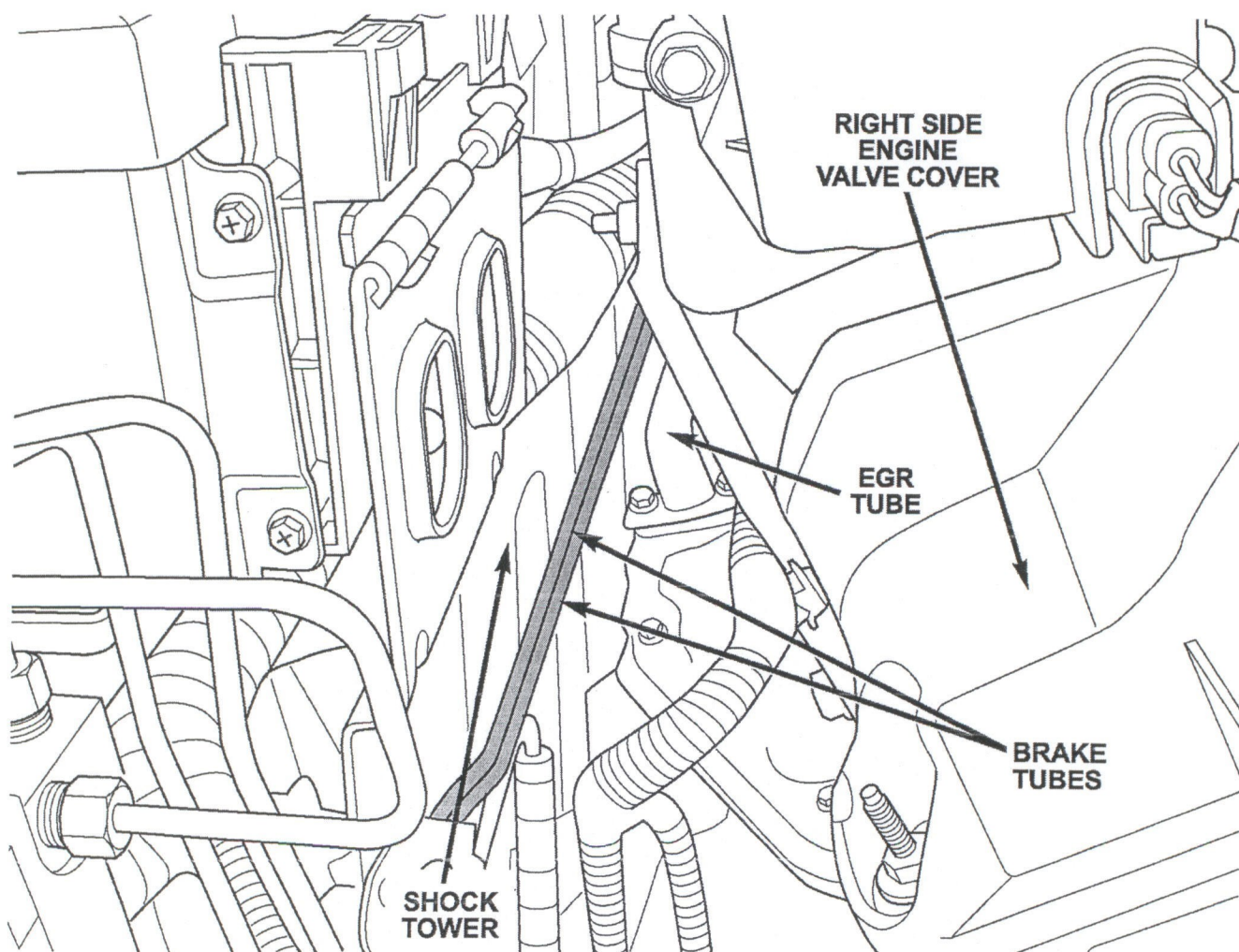

Figure 1



## Service Procedure (Continued)

### B. Replace Rear Brake Tube(s)

**NOTE:** The following procedure is required if the brake tube(s) require replacement per the inspection in Section “A.” *Very few vehicles are expected to require this repair. Only the damaged brake tube needs to be replaced. (Brake tubes do not need to be replaced in sets).*

1. Clean the surface of the aluminum junction block where the brake tube attaches to prevent dirt from entering the braking system when the brake tube is disconnected.

**NOTE:** A junction block is used on vehicles that are not equipped with Antilock Brake System (ABS). The junction block mounts in the same location as the ABS Integrated Control Unit (ICU) does on vehicles with ABS.

2. Disconnect the damaged brake tube at the brake system aluminum junction block/ICU (Figure 2).
3. Place a small piece of tape over the open port on the junction block/ICU.
4. Unclip the brake tube from the brake tube plastic retainer (Figure 2).
5. Lift the vehicle on the hoist.
6. Remove the brake tube metal heat shield (Figure 3).
7. Unclip the brake tube from the plastic brake tube retainers located under the metal brake tube heat shield.
8. Mark the location of the plastic tie strap located on the tube bundle.
9. Cut and discard the plastic tie strap at the tube bundle.

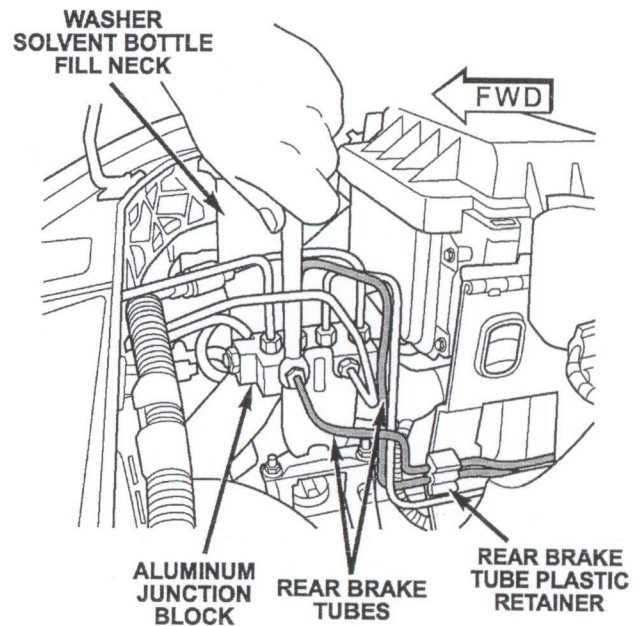

Figure 2 – Without ABS Shown

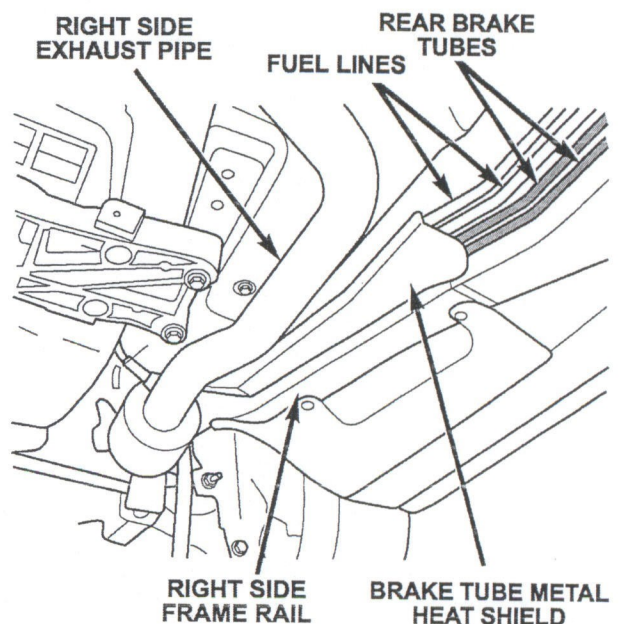
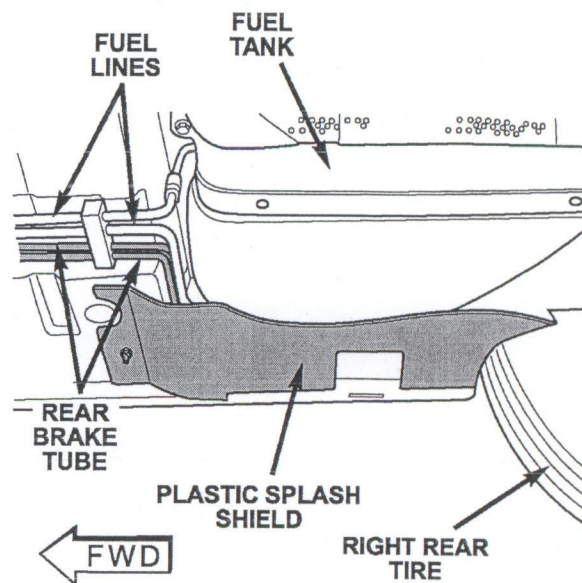

Figure 3

**Service Procedure (Continued)**

10. Unclip the brake tube from the plastic retainers along the floor pan.
11. Remove the plastic splash shield located by the right rear wheel to gain access to the brake tubes (Figure 4).
12. Remove the plastic retainer pin, pull the plastic retainer down from between the body and fuel tank and unclip the brake tube from the retainer.
13. Unclip the remaining brake tube retainers along the rear suspension.
14. Disconnect the brake tube at the rear wheel flex hose.
15. Remove the brake tube from the vehicle.
16. Transfer the rubber brake tube protector(s) to the new brake tube (Figure 5).

**Figure 4**

**CAUTION:** The rubber brake tube protectors must be transferred to the identical location on the new brake tube.

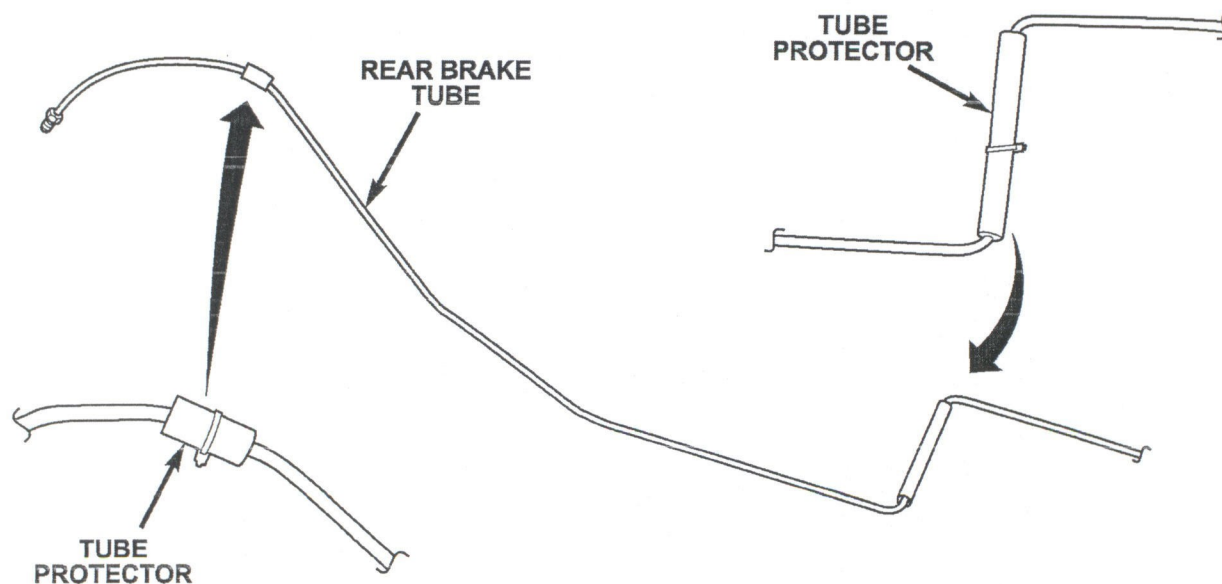
**Figure 5 – Right Side Tube Shown**



**Service Procedure (Continued)**

17. Discard the old brake tube.
18. Place the new brake tube into position on the vehicle.
19. Connect the new brake tube to the flex hose. Tighten the tube nut to 177 in. lbs. (20 N·m).
20. Starting at the rear of the vehicle, clip the brake tube into all the underbody plastic retainers.
21. Install the plastic splash shield (Figure 4).
22. Install the tie strap around the tube bundle in the location previously marked in Step 8.
23. Install the brake tube metal heat shield (Figure 3).
24. Lower the vehicle from the hoist.
25. Connect the new brake tube to the aluminum brake junction block/ICU (Figure 2). Tighten the tube nut to 177 in. lbs. (20 N·m).
26. Clip the new brake tube into the plastic retainer (Figure 2).
27. Repeat Steps 2 through 26 if the other rear brake tube requires replacement.
28. Bleed the brake system (Figure 6).
29. Continue with **Section C – Install Rear Brake Tube Retaining Clip**.

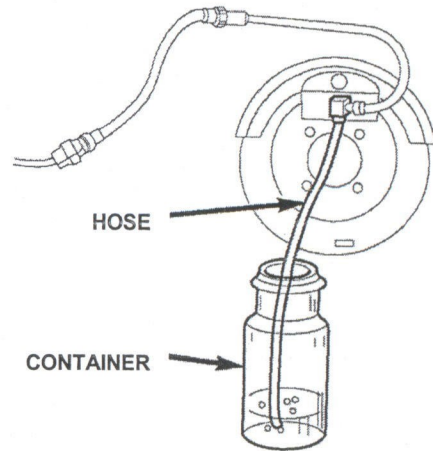
**Figure 6**

**Service Procedure (Continued)****C. Install Rear Brake Tube Retaining Clip**

1. Locate the existing hole in the side of the right shock tower, just below the main wiring harness.
2. Insert the brake tube plastic retaining clip stud into the hole in the shock tower (Figure 7).
3. Clip the rear brake tubes into the new brake tube retainer clip (Figure 7).

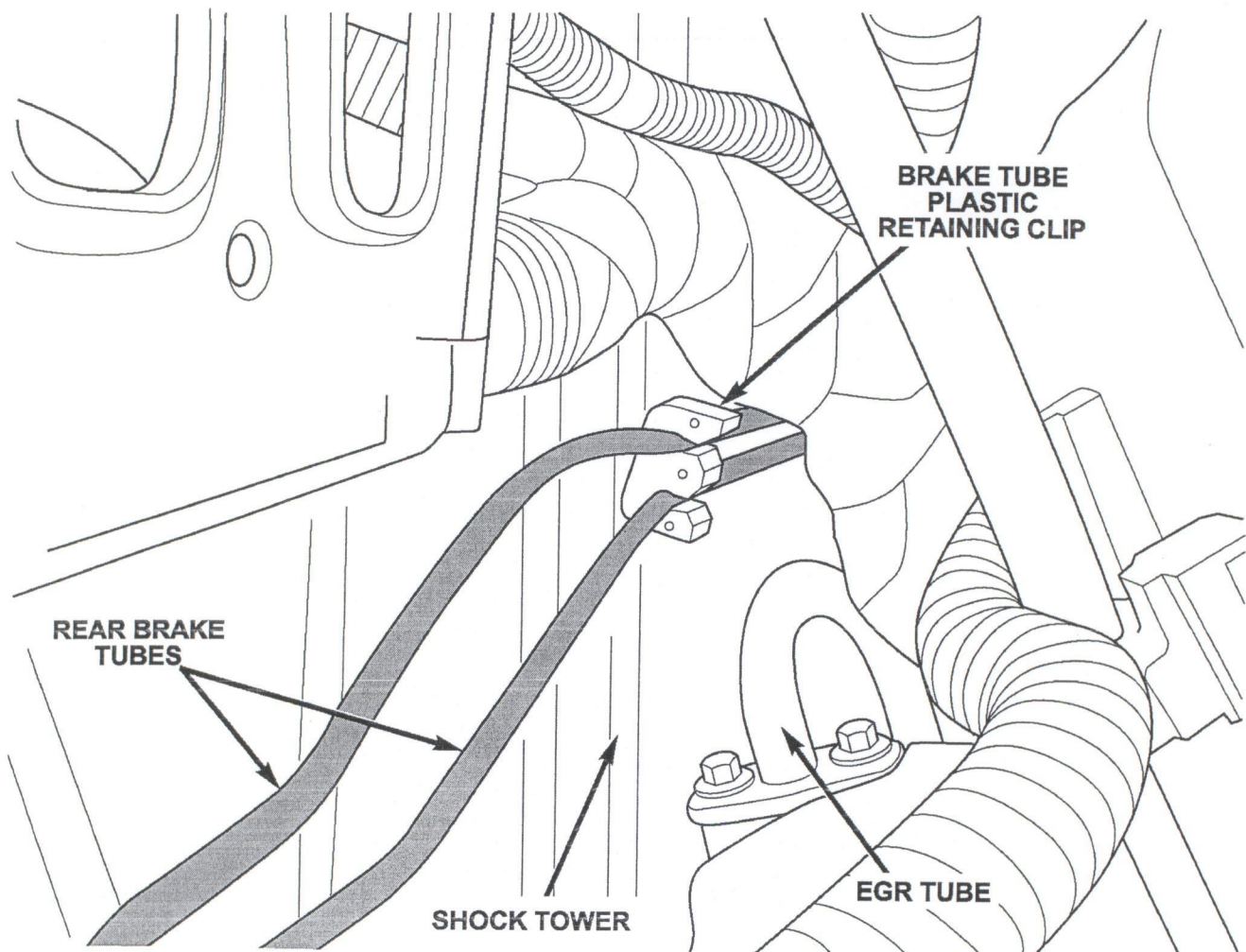

Figure 7



**Completion Reporting and Reimbursement**

Claims for vehicles that have been serviced must be submitted on the DealerCONNECT Claim Entry Screen located on the Service tab. Claims submitted will be used by DaimlerChrysler to record recall service completions and provide dealer payments.

Use one of the following labor operation numbers and time allowances:

	<b><u>Labor Operation Number</u></b>	<b><u>Time Allowance</u></b>
Inspect brake tubes and install brake tube retainer clip	05-F1-81-82	0.2 hours
Inspect and replace right rear brake tube and install retainer clip	05-F1-81-83	1.2 hours
Inspect and replace left rear brake tubes and install retainer clip	05-F1-81-84	1.3 hours
Inspect and replace both rear brake tubes and install retainer clip	05-F1-81-85	1.6 hours

Add the cost of the recall parts package plus applicable dealer allowance to your claim.

NOTE: See the Warranty Administration Manual, Recall Claim Processing Section, for complete recall claim processing instructions.

**Dealer Notification**

All dealers will receive a copy of this dealer recall notification letter by mail. Two additional copies will be sent through the DCMMS. To view this notification on DealerCONNECT, select “Global Recall System” on the Service tab, then click on the description of this notification.

**Owner Notification and Service Scheduling**

All involved vehicle owners known to DaimlerChrysler are being notified of the service requirement by first class mail. They are requested to schedule appointments for this service with their dealers. A generic copy of the owner letter is attached.

Enclosed with each owner letter is an Owner Notification postcard to allow owners to update our records if applicable.

**Vehicle Lists, Global Recall System, VIP and Dealer Follow Up**

All involved vehicles have been entered into the DealerCONNECT Global Recall System (GRS) and Vehicle Information Plus (VIP) for dealer inquiry as needed.

GRS provides involved dealers with an updated VIN list of their incomplete vehicles. The owner's name, address and phone number are listed if known. Completed vehicles are removed from GRS within several days of repair claim submission.

To use this system, click on the “**Service**” tab and then click on “**Global Recall System.**” Your dealer's VIN list for each recall displayed can be sorted by: those vehicles that were unsold at recall launch, those with a phone number, city, zip code, or VIN sequence.

**Dealers must perform this repair on all unsold vehicles before retail delivery.** Dealers should also use the VIN list to follow up with all owners to schedule appointments for this repair.

*Recall VIN lists may contain confidential, restricted owner name and address information that was obtained from the Department of Motor Vehicles of various states. Use of this information is permitted for this recall only and is strictly prohibited from all other use.*

**Additional Information**

If you have any questions or need assistance in completing this action, please contact your Service and Parts District Manager.

Customer Services Field Operations  
DaimlerChrysler Corporation



*Buckle up  
for Safety!***SAFETY RECALL F18 – REAR BRAKE TUBES**

Dear: (Name)

This notice is sent to you in accordance with the requirements of the National Traffic and Motor Vehicle Safety Act. DaimlerChrysler Corporation has decided that a defect, which relates to motor vehicle safety, exists in some **2006 model year Chrysler 300, Dodge Charger and Magnum vehicles equipped with a 2.7L engine.**

**The problem is...** The rear brake tubes on your vehicle (VIN: xxxxxxxxxxxxxxxxx) may rub against the Exhaust Gas Recirculation (EGR) tube and cause a brake fluid leak. Brake fluid leaking onto a hot exhaust manifold can cause an engine compartment fire. A brake fluid leak could also increase the vehicle's stopping distance and cause a crash without warning.

**What your dealer will do...** DaimlerChrysler will repair your vehicle free of charge (parts and labor). To do this, your dealer will inspect the rear brake tubes and install an additional brake tube retainer clip. If a brake tube has been damaged it will be replaced. Inspection of the brake tubes and installation of the retainer clip will take about ½ hour to complete. If brake tube replacement is required and additional 1½ hours will be required. However, additional time may be necessary depending on how dealer appointments are scheduled and processed.

**What you must do to ensure your safety...** Simply **contact your dealer** right away to schedule a service appointment. Ask the dealer to hold the parts for your vehicle or to order them before your appointment. **Remember to bring this letter with you to your dealer.**

**If you need help...** If you have questions or concerns which your dealer is unable to resolve, please contact DaimlerChrysler at 1-800-853-1403.

Please help us update our records, by filling out the enclosed prepaid postcard, if any of the conditions listed on the card apply to you or your vehicle. Be sure to print the last eight (8) characters of the VIN (VVVVVVVV) and notification code F18 on the postcard.

If you have already experienced this condition and have paid to have it repaired, you may send your original receipts and/or other adequate proof of payment to the following address for reimbursement: DaimlerChrysler P.O. Box 4639 Oak Ridge, TN 37831, Attention: Reimbursement.

If your dealer fails or is unable to remedy this defect without charge and within a reasonable time, you may submit a written complaint to the Administrator, National Highway Traffic Safety Administration, 400 Seventh Street, S.W., Washington, DC 20590, or call the toll-free Vehicle Safety Hotline at 1-888-327-4236 (TTY 1-800-424-9153), or go to <http://www.safercar.gov>.

We're sorry for any inconvenience, but we are sincerely concerned about your safety. Thank you for your attention to this important matter.

Customer Services Field Operations  
DaimlerChrysler Corporation  
Notification Code F18

Note to lessors receiving this recall: Federal regulation requires that you forward this recall notice to the lessee within 10 days.