

SAFETY RECALL NOTICE



A-0601

FEBRUARY, 2006

ATTENTION: SERVICE MANAGERS / PARTS MANAGERS

SUBJECT: BATTERY DISCONNECT SWITCH

VEHICLES

AFFECTED: CERTAIN AUTOCAR WX, WXLL AND WXR MODEL, HEAVY-DUTY CLASS 8 VEHICLES DELIVERED BETWEEN 4/19/04 & 1/28/05 WITH VIN NUMBER RANGE 200654 TO 203388

RECEIVED
2006 MAR 15 4:45
DEFECTS INVESTIGATION

Safety Recall Information

Autocar, LLC has determined that a defect that relates to motor vehicle safety exists in certain WX, WXLL, and WXR model, heavy-duty class 8 vehicles manufactured between April 2004 and January 2006. Affected vehicles are fitted with a longitudinally-mounted battery box, which is parallel to the frame, with a battery disconnect switch, and are built with a combination of Autocar sales codes 812063 (RH battery box mounted parallel to frame) and 814011 (battery disconnect switch).

Exposed 12v terminals on the battery disconnect switch are in close proximity to a hinged metal latch on the battery box lid. When latching or unlatching the battery box lid, it is possible that a person wearing metal jewelry (like a watch or finger ring) might ground the metal latch to the exposed terminals on the battery disconnect switch through such jewelry. The resulting electrical short circuit may heat up the metal jewelry and could cause burns.

Number of Vehicles Affected

There are thirty (30) vehicles affected by this recall with VIN number range 200654 to 203388.

NOTE: To verify or determine if a particular vehicle is affected by this recall (or any other recall), you should consult the *Dealer Access* link through the Autocar public website: (www.autocartruck.com). By entering the Vehicle Identification Number into the VIN Profile, the screen will display any outstanding recall(s).

If a *Dealer Listing* is enclosed, it identifies the vehicles that were sold or shipped to your dealership. Be sure to check the VIN Profile screen on the Autocar website before performing the recall to verify that the recall is still open. If the recall has been completed by another dealer the word "Completed" will be shown behind the recall number.

SAFETY RECALL NOTICE



A-0601

FEBRUARY, 2006

Repair Instructions:

The battery disconnect switch must be moved down and away from the metal catch, and insulating rubber protectors must be installed over the battery disconnect switch terminals. See also, **REPAIR PROCEDURE** on the following page.

Time Allowance:

Repair: 1.0 hour per vehicle

Recall Parts:

Quantity of two (2) isolating rubber protectors - Autocar part number GZ180006-001; supplier part number 5775R.

Claims for Reimbursement:

Submit a claim following the instructions in the **Claim Preparation** section of the **Service Operations Manual**.

Parts can be obtained from Autocar, LLC, by contacting Sally Johnson at 765.489.6016. Sally can also be reached via e-mail at: sjohnson@autocartruck.com. Please provide the recall number and the last 6 digits of the VIN number. The parts will be shipped at no cost to the dealer or the owner.

Claim Coding Information:

Authorization Number: A-0601
Repair: 31172-0-05 1.0 hour per vehicle

Owner Recall Response Card:

The **Owner Recall Response Card** provides the vehicle owner with a convenient way to notify Autocar, LLC of changes affecting the ownership of the subject vehicle. The owner card is not intended for dealer usage other than to assist you in the preparation of the repair orders necessary to perform the applicable recall on the subject vehicle. Please do not use the card as a way to inform Autocar, LLC that the vehicle has been inspected or modified. Your claim for reimbursement is sufficient.

SAFETY RECALL NOTICE



A-0601

FEBRUARY, 2006

Dealer Recall Responsibility:

Dealers are to perform repairs on all vehicles subject to the recall at no charge to the owner regardless of vehicle mileage, age, or ownership. Whenever a vehicle subject to this recall is taken into your dealership for service, you must make every effort to perform the recall remedy before the vehicle is released to the owner.

NOTE: It is illegal to sell a vehicle from your inventory with any outstanding recalls.

REPAIR PROCEDURE:

To prevent eye injury, always wear eye protection when performing vehicle maintenance, service or inspection.



DANGER

Before working on a vehicle, set the parking brake, place the transmission in neutral and block the wheels. Failure to do so can result in unexpected vehicle movement and can cause serious personal injury or death.

- Step 1:** Turn the battery disconnect switch to the **OFF** position.
- Step 2:** Use a 9/16" wrench to loosen and remove the nut that fastens the black cable to the negative terminal of the battery.
- Step 3:** Remove the black cable from the negative terminal of the battery. **REMOVE THE NEGATIVE CABLE BEFORE MOVING TO STEPS 4 AND 5!**

SAFETY RECALL NOTICE



A-0601

FEBRUARY, 2006

Step 4: Use a 9/16" wrench to loosen and remove the nut that fastens the red cable to the positive terminal of the battery.

Step 5: Remove the red cable from the positive terminal of the battery.

Step 6: Use an 11/16" wrench to loosen and remove the nut and bolt from the TOP terminal of the disconnect switch. Do not disconnect the bottom terminal until *Step 13*.

Step 7: Remove the cable(s) from the TOP terminal of the disconnect switch.

NOTE: Some body builders may have attached additional cables to the terminals of the battery disconnect switch and/or to the negative battery terminal to provide electrical power for the load body. Remove and install these cables in the same manner, and with the same safety precautions, as you would remove and install the primary cable(s) from the battery to the disconnect switch and from the battery disconnect switch to the starter motor.

Step 8: Inspect the cable(s), cable routing, conduit, and clipping for wear and proper protection against chafing; replace if necessary.

Step 9: Inspect the terminal ring(s) on the cable(s) and the disconnect switch terminal. Make sure all terminals are clean before proceeding.

Step 10: Slip one of the terminal protectors (part number GZ180006-001) over the end terminal of the battery cable, at the disconnect switch-end. If connecting two cables to the terminal, place the terminal protector on the second cable (top ring) that is to be installed on the terminal. See *Figure 1* (before installation) and *Figure 2* (after installation) below:



Figure 1

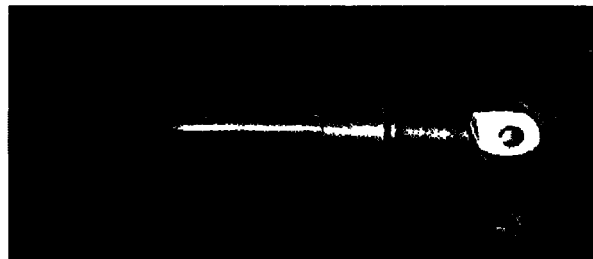

Figure 2

SAFETY RECALL NOTICE



A-0601

FEBRUARY, 2006

- Step 11:** Reconnect the cable(s) to the TOP terminal of the disconnect switch. **DO NOT CONNECT THE RED CABLE TO THE POSITIVE TERMINAL OF THE BATTERY AT THIS TIME.**
- Step 12:** Peel the front end of the terminal protector back, and use an 11/16" wrench to tightly secure the cable(s) to the TOP terminal of the disconnect switch with the nut and bolt. After the nut is secured, flip the front end of the terminal protector in place so that the nut and ring terminal are completely covered.
- Step 13:** Use an 11/16" wrench to loosen and remove the nut and bolt from the BOTTOM terminal of the disconnect switch. **DO NOT PERFORM THIS STEP UNTIL THE CABLE FROM THE BATTERY TO THE TOP TERMINAL OF THE DISCONNECT SWITCH HAS BEEN PROPERLY SECURED TO THE DISCONNECT SWITCH.**
- Step 14:** Remove the cable(s) from the BOTTOM terminal of the disconnect switch.
- Step 15:** Inspect the cable(s), cable routing, conduit, and clipping for wear and proper protection against chafing; replace if necessary.
- Step 16:** Inspect the terminal ring(s) on the cable(s) and the disconnect switch terminal. Make sure all terminals are clean before proceeding.
- Step 17:** Slip one of the terminal protectors (part number GZ180006-001) over the end terminal of the cable to the starter motor, at the disconnect switch-end. If connecting two cables to the terminal, place the terminal protector on the second cable (top ring) that is to be installed on the terminal. See **Figure 1** (before installation) and **Figure 2** (after installation) on the previous page.
- Step 18:** Reconnect the cable(s) to the BOTTOM terminal of the disconnect switch.
- Step 19:** Peel the front end of the terminal protector back, and use an 11/16" wrench to tightly secure the cable(s) to the BOTTOM terminal of the disconnect switch with the nut and bolt. After the nut is secured, flip the front end of the terminal protector in place so that the nut and ring terminal are completely covered.
- Step 20:** Use a 7/16" socket to remove the nuts and bolts used to mount the lockout bracket that holds the disconnect switch.

SAFETY RECALL NOTICE



A-0601

FEBRUARY, 2006

Step 21: Use a 9/16" socket to remove the nuts and bolts used to mount the disconnect switch bracket shown in *Figure 3*.

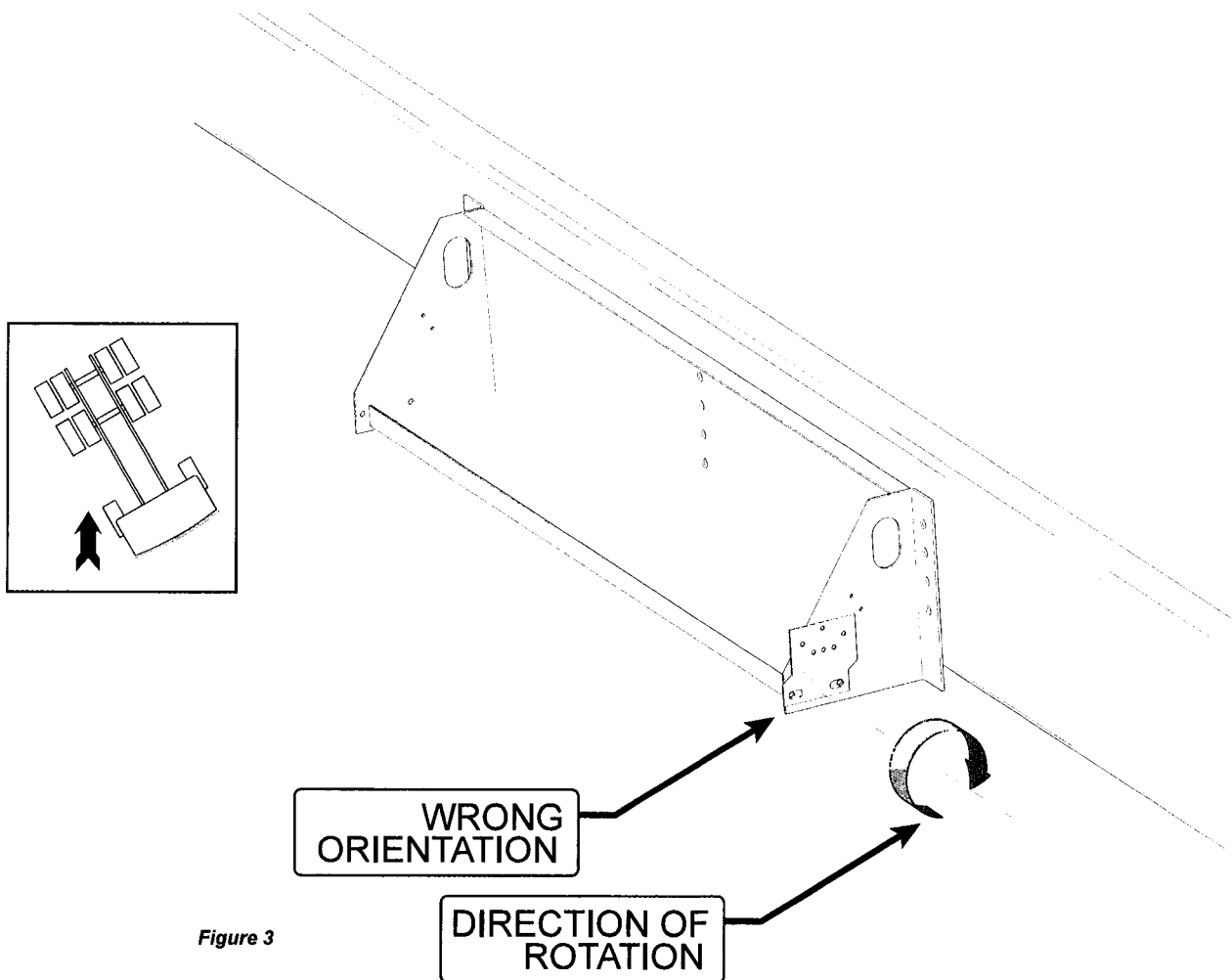

Figure 3

Step 22: Rotate the disconnect switch bracket 180° around the longitudinal (front-to-rear) axis of the vehicle as shown in *Figure 3*.

SAFETY RECALL NOTICE



A-0601

FEBRUARY, 2006

Step 23: Replace the disconnect switch bracket as shown in *Figure 4*.

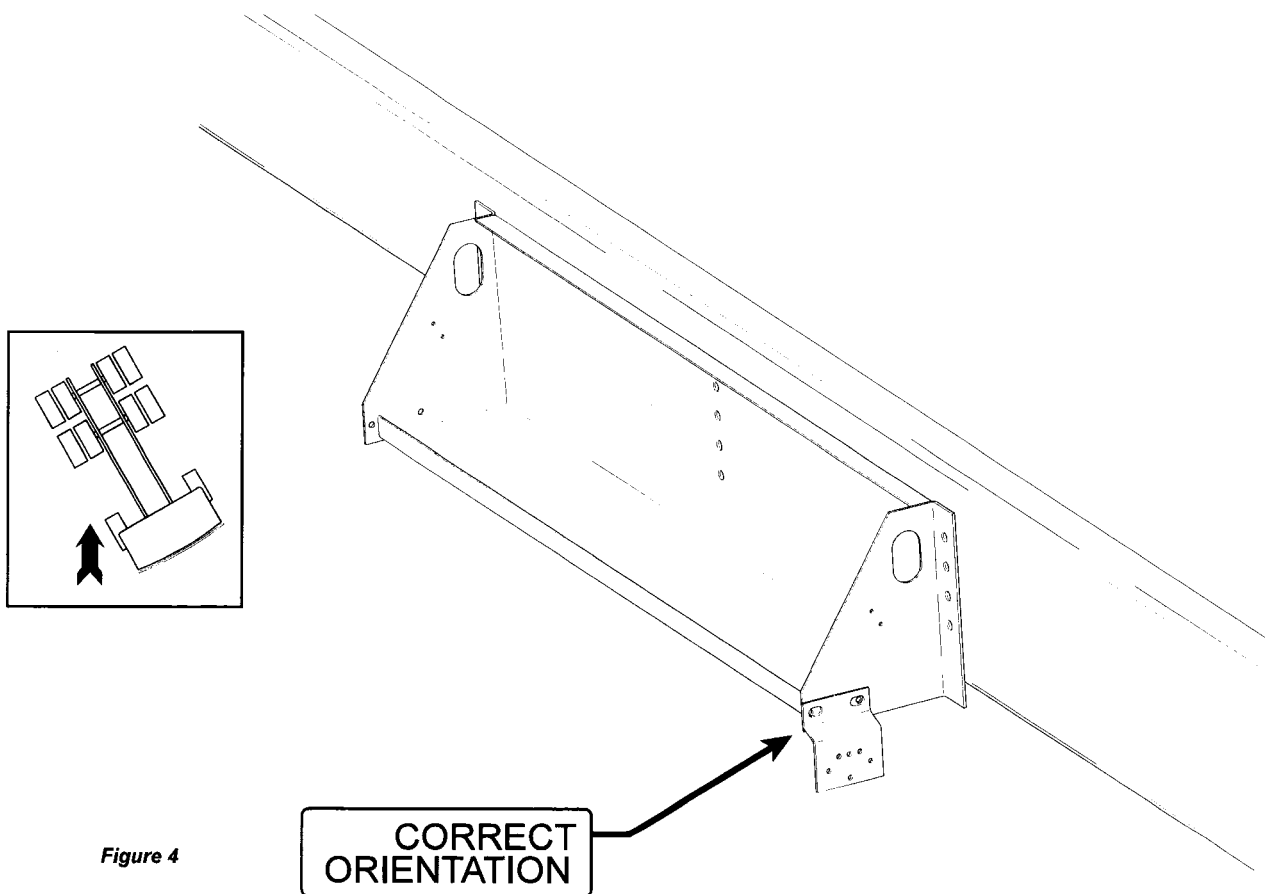

Figure 4

NOTE: *Figures 3* and *4* are included in the installation instructions for all parallel-to-frame battery boxes. The following instructions are applicable whether the switch is mounted on the front end or the rear end of the battery box.

Step 24: Replace the nuts and bolts used to mount the disconnect switch bracket.

Step 25: Use a 9/16" socket and a torque wrench to tighten the bolt and nut used to mount the disconnect switch bracket shown in *Figure 4* to a torque of exactly 65 N-m (48 ft-lb).

SAFETY RECALL NOTICE



A-0601

FEBRUARY, 2006

- Step 26:** Replace the lockout bracket that holds the disconnect switch.
- Step 27:** Replace the nuts and bolts used to mount the lockout bracket that holds the disconnect switch.
- Step 28:** Use a 7/16" socket to tightly secure the nuts and bolts used to mount the lockout bracket that holds the disconnect switch.
- Step 29:** Make sure the battery disconnect switch is still in the **OFF** position.
- Step 30:** Reconnect the red cable to the positive terminal of the battery.
- Step 31:** Replace the nut used to fasten the red cable to the positive terminal of the battery.
- Step 32:** Use a 9/16" wrench to tightly secure the nut that fastens the red cable to the positive terminal of the battery.
- Step 33:** Reconnect the black cable to the negative terminal of the battery.
- Step 34:** Replace the nut used to fasten the black cable to the negative terminal of the battery.
- Step 35:** Use a 9/16" wrench to tightly secure the nut that fastens the black cable to the negative terminal of the battery.
- Step 36:** Turn the battery disconnect switch to the **ON** position.

This concludes the Repair Procedure for this Safety Recall Notice.

We regret any inconvenience this recall may cause, but hope you will share in our concern for our customers' safety and satisfaction with their vehicles.

Sincerely,

AUTOCAR, LLC