



SUZUKI MOTOR CORPORATION  
SERVICE DEPARTMENT

Page: 1 / 2

Date: December 12, 2005

TO : A.S.M.C.

ATTN: Mr. Masaaki Kato, President (加藤社長殿)

Mr. Nobuo Fukui, Executive Director (福井 ED 殿)

**RE: Recall Campaign for VZ800, VL800/T/Z K5/6 Ignition Switch**

This is to notify you of the RECALL CAMPAIGN for ignition switch of VZ800, VL800/T/Z K5/6 models.

Ignition switch lead wire of these models is routed behind the switch body, with main harness, clutch cable and throttle cable. Due to tight layout on this position, outer cover of lead wire may be rubbed and damaged causing short circuit. When this lead wire short circuit with ignition switch, fuse will be burned causing engine stall due to electric power supply down.

Considering the situation, we decided to carry out the recall campaign.

You are kindly requested to organize the recall campaign on the affected units in your market. The modification is to be completed by changing the routing of this lead wire. In the case, if outer cover of lead wire is already damage, please replace the ignition switch with new one, with new routing.

The numbers of the affected units in your market is shown below.

Please refer to the attached sheet for detail s.

Affected units: 23,299 units

We apologize for any inconvenience this may cause to you and thank you in advance for your kind understanding and cooperation.

Best regards,

Takao Kudo, Group Leader  
Service department  
Overseas Motorcycle Field Service Group



**Affected Model and VIN Range**

MODEL	ASSEMBLING DATE	START VIN	END VIN	Qty.
VZ800K5	2004/12/02 – 2005/05/24	JS1VS56A 52100031	JS1VS56A 52105190	4,602
VZ800K6	2005/06/21 – 2005/07/06	JS1VS56A 62100010	JS1VS56A 62100763	655
VL800/T/ZK5	2004/05/11 – 2005/06/01	JS1VS55A 52100020	JS1VS55A 52117470	15,686
VL800/TK6	2005/06/01 – 2005/07/06	JS1VS55A 62100013	JS1VS55A 62102646	2,356

Total: 23,299

**Campaign Parts and Special tool**

Campaign job is to change the routing of ignition switch lead wire, and this job requires no replacement part, nor special tool.

In the case if lead wire cover is already damaged, please replace the ignition switch referring to our service manuals. For the customer's convenience you may be required to replace as LOCK SET consist of four components: ignition switch, fuel tank cap, side cover lock, and helmet lock, see our parts catalogue for appropriate parts number. Replacing the LOCK SET requires T30 and T40 Torx wrenches.

**Replacement Procedure**

Please refer to the attached sheets for changing the routing. In the case if change the LOCK SET, refer to our Service manuals.

**Warranty Handling Information**

This is a recall campaign that is acceptable only one time for one unit. The labor cost will be reimbursed upon your warranty applications.

Claim category	2 (Campaign)
Trouble Code	99-JH
Causal Part	Lock assy, steering
Causal Part No.	37100-41F90
Quantity	0
Basic code	SF9999
Labor hour	0.3 *

\* If changing the LOCK SET, apply 1.0 for labor hour.

END

## VZ800, VL800/T/Z K5/K6 Ignition switch lead wire rerouting procedure

Note: Refer to the service manual for details which are not specified in this procedure.

### 1. Necessary Tools

- Hex. Wrench (6mm)
- Wrench (10 x 12 mm)

### 2. Job detail

Reroute the lead wire of ignition switch as to avoid tight binding of wires and cables. In the case if lead wire is already damaged, replace ignition switch as LOCK SET with new routing, referring service manual.

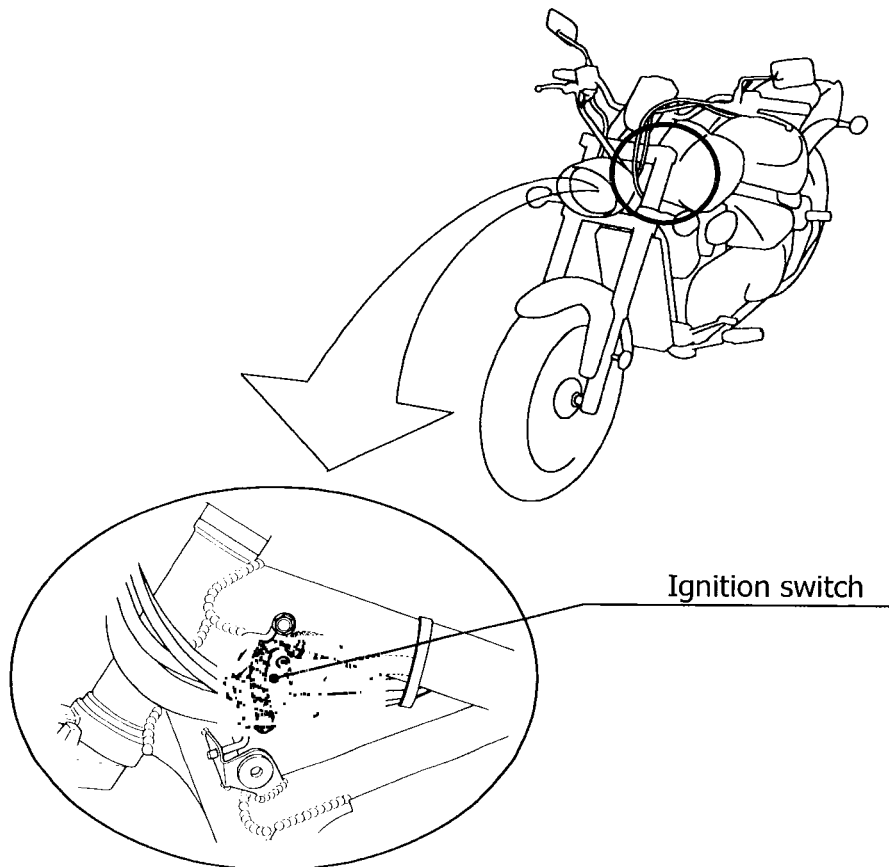

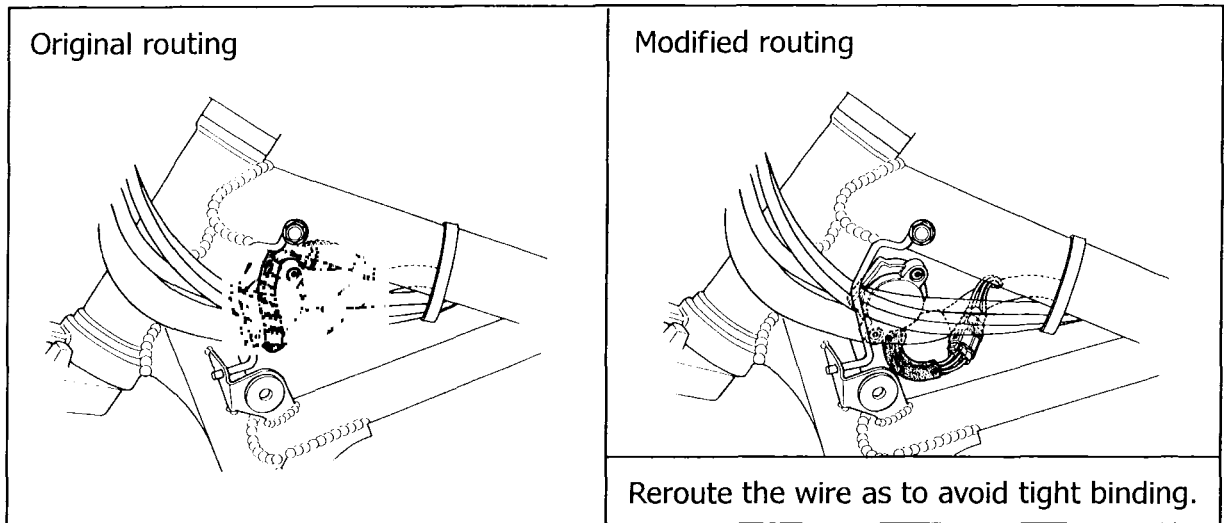

**Job procedure**

1. Seats removal

- Remove a bolt, and pillion seat
  
- Remove two bolts, band and seat assy.

Note:

Place removed seats on proper place, not to damage or mess them.

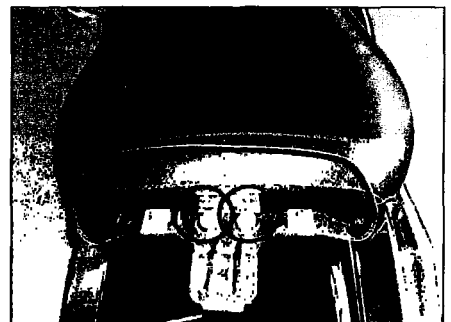

2. Fuel tank removal

- Remove a bolt



- Lift and slide the fuel tank approx. 50mm rearward.

Note:

- Protect frame and side covers by rag to prevent scratch.
- Note that lead wires and fuel hoses are being connected during this job. Pay attention their connection and routing, not to damage.
- Place handlebar straight. Steering right or left fully may hit the fuel tank with handlebar.



### 3. Frame head cover removal

- Remove ignition key, and remove RH frame cover.
- Remove LH frame cover.

Note:

Frame cover can be removed by lift 10 mm upward then slide backward.

Be careful of loss the cap of RH cover

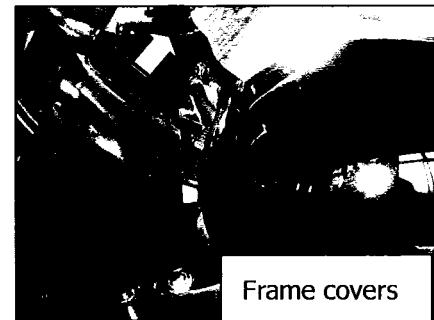

### 4. Check and reroute the lead wire

If the ignition switch lead wire is pinched in between ignition switch body and cables, remove throttle cable guide and reroute the lead wire. Ignition switch lead wire and coupler should be located underneath the switch body, see below picture.

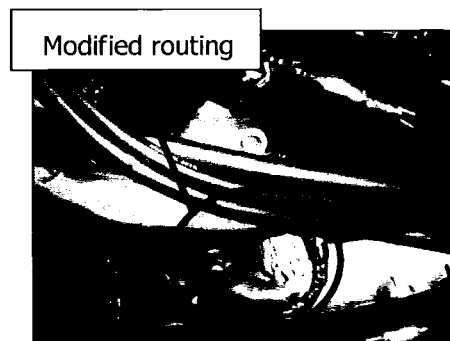
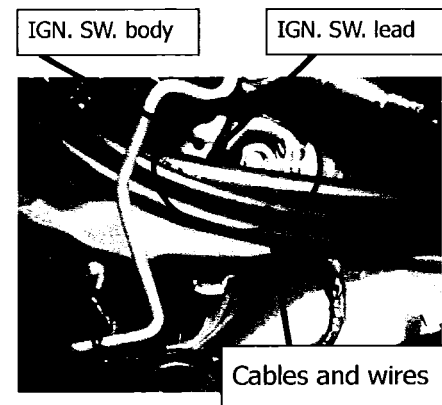

Note:

In the case of wire damage...

If ignition switch lead wire is already damaged, replace the ignition switch as LOCK SET which consists of ignition switch, fuel tank cap, side cover lock and helmet lock, referring service manual.

#### 4. Reassembly

- Reassemble Throttle cable guide, frame head covers, fuel tank, seats in reverse order of disassembly.
- Check and reconfirm any damage and proper assembly.

Note:

Fuel tank and pillion rider seat of VZ800 and VL800 are not same, but above job procedure is common for both models.

END