



TO: All Mazda Dealership General Managers, Service Managers, and Parts Managers
DATE: July 2012
SUBJECT: 2002-2004 Tribute Accelerator Cable Safety Recall 2704L – **UPDATE**

IMPORTANT UPDATE:

A CAUTION has been added to the Repair Procedure (Attachment II) to help prevent damage to the speed control cable while performing the accelerator cable replacement procedure.

Mazda Motor Corporation has decided that a defect which relates to motor vehicle safety exists in certain 2002-2004 Tribute vehicles produced from May 30, 2001 through December 19, 2003.

On certain 2002-2004 Tribute vehicles equipped with 3.0L engines, the accelerator cable may prevent the throttle from returning to the idle position, possibly resulting in elevated engine speeds while driving. An unexpected increase in engine idle speed may increase stopping distance and may result in a vehicle crash without warning.

Owners of affected vehicles were notified by first class mail on January 28, 2005.

This package contains important information about Safety Recall 2704L:

Attachment I	Dealer Parts and Service Information
Attachment II	Inspection and Repair Procedures

The National Traffic and Motor Vehicle Safety Act prohibits selling or leasing any subject vehicle without performing the necessary repair for defects or failures. Failure to perform applicable recalls before sales can result in extensive fines and penalties from the Federal Government. Therefore, you must complete this recall for all affected vehicles in your inventory prior to sale or lease.



-Page 2-

To help you effectively perform this recall, Mazda has developed the following resources:

1. Service and Parts recall instructions were emailed to your Service Department, and are also available on eMDCS and MS3 (Mazda Service Support System) via MXConnect.
2. Inspection and repair procedures follow (Attachment II), and are also available on eMDCS and MS3 (Mazda Service Support System) via MXConnect.
3. We recommend using the Recall Reminder Report available in Web Reporting to encourage customers to come in for the recall (with recall reminder postcards). Dealers may use such owner information for the sole purpose of conducting and performing this recall, and for no other purpose. **Using it for marketing activities is strictly prohibited and could subject your dealership to serious fines.** The information in the report is protected by state privacy and other applicable laws regarding disclosure of personal and/or confidential, restricted or blocked information. It is the dealer's responsibility to protect the confidentiality of owner records and prevent the release of information to other parties.
4. For repair authorization/technical assistance, call the Technical Assistance Hotline at (888) 832-8477, Option 3 for English speaking Hotline Specialist, Option 4 for Spanish speaking Hotline Specialist.
5. For warranty questions, contact the Warranty Hotline at (877) 727-6626, Option 3.
6. For parts questions, contact the Corporate Dealer Assistance Group at (877) 727-6626, Option 2.

Please make certain the appropriate personnel in your dealership are aware of these resources and are familiar with the details of this recall before responding to customer inquiries.

A rental car may be provided to the customer, if eligible, based on the terms and conditions of the Rental Car Reimbursement Program, Section 12.0. Rental car reimbursement are available only on 2001 and newer vehicles within the mileage and time limitations under the New Vehicle Limited Warranty.

We apologize for any inconvenience this recall may cause you and your customers. Your understanding and support in carrying out this campaign is greatly appreciated.

Sincerely,

Mazda North American Operations

ATTACHMENT I –PARTS AND SERVICE INFORMATION
Safety Recall 2704L

CONDITION OF CONCERN

On certain 2002-2004 Tribute vehicles equipped with 3.0L engines, the accelerator cable may prevent the throttle from returning to the idle position, possibly resulting in elevated engine speeds while driving. An unexpected increase in engine idle speed may increase stopping distance and may result in a vehicle crash without warning.

SUBJECT VEHICLES

Model	VIN Range	Build Date Range
Tribute 3.0L engine:		
2002 model year	4F2BU**1*2KM00001 - 4F2BU**1*2K M66656 4F2CU**1*2KM00001 - 4F2CU**1*2K M66656 4F2UU**1*2KM00001 - 4F2UU**1*2K M66656 4F2YU**1*2KM00001 - 4F2YU**1*2K M66656	May 30, 2001 through December 19, 2003
2003 model year	4F2CZ**1*3KM00001 - 4F2CZ**1*3K M56713 4F2YZ**1*3KM00001 - 4F2YZ**1*3K M56713	
2004 model year	4F2CZ**1*4KM00004 - 4F2CZ**1*4K M34822 4F2CZ**1*4KM00004 - 4F2CZ**1*4K M34822	

Note: The asterisk symbol “*” can be any letter or number.

Please perform a Warranty Vehicle Inquiry using eMDCS to determine if this vehicle needs the recall performed.

OWNER NOTIFICATION

Owners of affected vehicles were notified by first class mail on January 28, 2005.

PARTS INFORMATION

Description	Part Number	Quantity	Notes
Accelerator Cable	EC05-41-660F	1	
Campaign Label	9999-95-065A-06	1=50 labels	Obtain in MStore (no charge)

PARTS ORDERING

Dealers automatically received a quantity of Accelerator Cables based on the number of 2002-2004 Tribute vehicles registered in the dealer’s vicinity. Parts shipments began 1/19/05 and arrived on the dealers’ next stock order. Dealers received the Accelerator Cables by 1/28/05.

Existing Service Parts Inventory

Please return any inventory you have of EC-05-41-660, EC05-41-660D and EC05-41-660E on your next obsolescence return and you will receive credit on your next parts statement. The return of these parts will not go against your obsolescence accrual.

WARRANTY CLAIM PROCESSING INFORMATION

	Accelerator Cable Replacement
Warranty Type	R
Symptom Code	99
Damage Code	99
Process Number	J0501A
Part Number Main Cause	EC05-41-660F
Quantity	1
Labor Operation Number	YY373XRX
Labor Hours	0.4 hrs

RENTAL CAR

A rental car may be provided to the customer, if eligible, based on the terms and conditions of the Rental Car Reimbursement Program, Section 12.0. Rental car reimbursements are available only on 2001 and newer vehicles within the mileage and time limitations under the New Vehicle Limited Warranty. If the customer was placed in a rental car while the campaign was being completed, add a sublet to the claim using the information below.

Rental claims for vehicles beyond the New Vehicle Limited Warranty require DSA and DCSM Authorization.

Sublet – Rental Car:

	Rental Car
Warranty Type Code	A
Symptom Code	99
Damage Code	99
Part Number Main Cause	5555-RE-NTAL
Part Quantity	0
Labor Operation Code	MM012XRX
Labor Hours	0.0
Sublet – Rental Car	
Sublet Invoice Number	Number from rental invoice or dealer purchase order
Sublet Type Code	Enter "L"
Sublet Amount	Up to \$30 per day for the number of days customer had rental car

Rental expenses that exceed the two-day limit with require DSA or prior DCSM Authorization, as outlined in the Rental Car Reimbursement Program Policy.

2002 - 2004 TRIBUTE ACCELERATOR CABLE [RECALL 2704L]

A. VEHICLE INSPECTION PROCEDURE

IMPORTANT UPDATE:

- A CAUTION has been added to the Repair Procedure on page 3 to help prevent damage to the speed control cable while performing the accelerator cable replacement procedure.

1. Verify the vehicle is within the following ranges:

- 2002-2004 Tribute vehicles equipped with 3.0L engine built between May 30, 2001 through December 19, 2003.

VIN Ranges:

2002 Tribute 4F2*U** 1* 2K M00001 – 4F2*U** 1* 2K M66656

2003 Tribute 4F2*Z** 1* 3K M00001 – 4F2*Z** 1* 3K M56713

2004 Tribute 4F2*Z** 1* 4K M00004 – 4F2*Z** 1* 4K M34822

- If the vehicle is within one of the above ranges, proceed to step 2.
- If the vehicle is not within one of the above ranges, return vehicle to the customer or inventory.

2. Perform a Warranty Vehicle Inquiry using your eMDCS System and inspect vehicle for an Authorized Modification Label **Recall 2704L** attached to the vehicle's hood. Refer to eMDCS System - Warranty Vehicle Inquiry Results table below.

NOTE: Be sure to verify RECALL number as the vehicle may have multiple Recall labels.

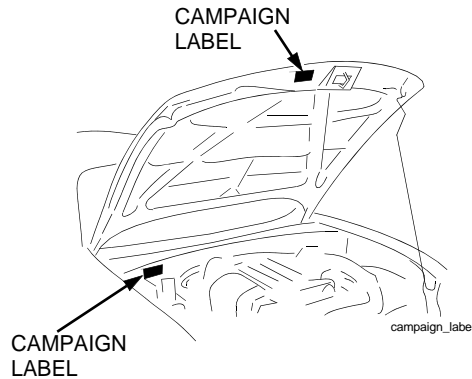

eMDCS System - Warranty Vehicle Inquiry Results:

If eMDCS displays:	Campaign Label is:	Action to perform:
RECALL 2704L OPEN	Present	Contact the Warranty Hotline at (877) 727-6626 option 3 to update vehicle history.
	Not present	Proceed to "B. REPAIR PROCEDURE".
RECALL 2704L CLOSED	Present	Return vehicle to inventory or customer.
	Not present	Complete a label and apply to vehicle's hood.
RECALL 2704L is not displayed	Does not apply	Recall does not apply to this vehicle. Return vehicle to inventory or customer.

B. REPAIR PROCEDURE

REMOVAL

1. From inside the vehicle, disconnect the accelerator cable from the pedal.
 - a. Remove the rubber plunger from the accelerator pedal.

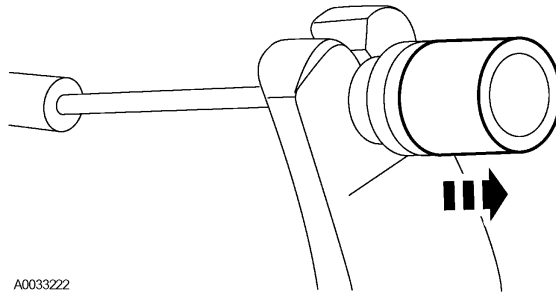

- b. Pull the plunger rearward and remove the accelerator cable from the pedal.

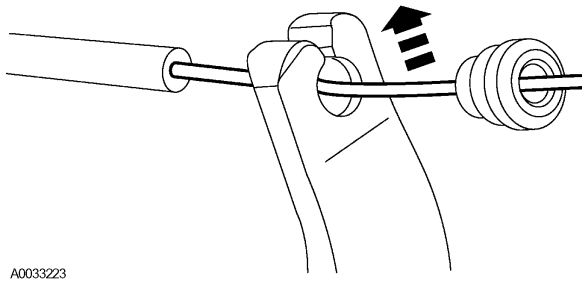

2. Remove the engine appearance cover, if equipped.

CAUTION: Damage to the speed control cable may result if the throttle body cam is rotated by lifting up on the speed control cable or the speed control cable connector end. When disconnecting the accelerator cable from the throttle body, rotate the throttle body cam only by lifting up on the cam itself. See Figure below.

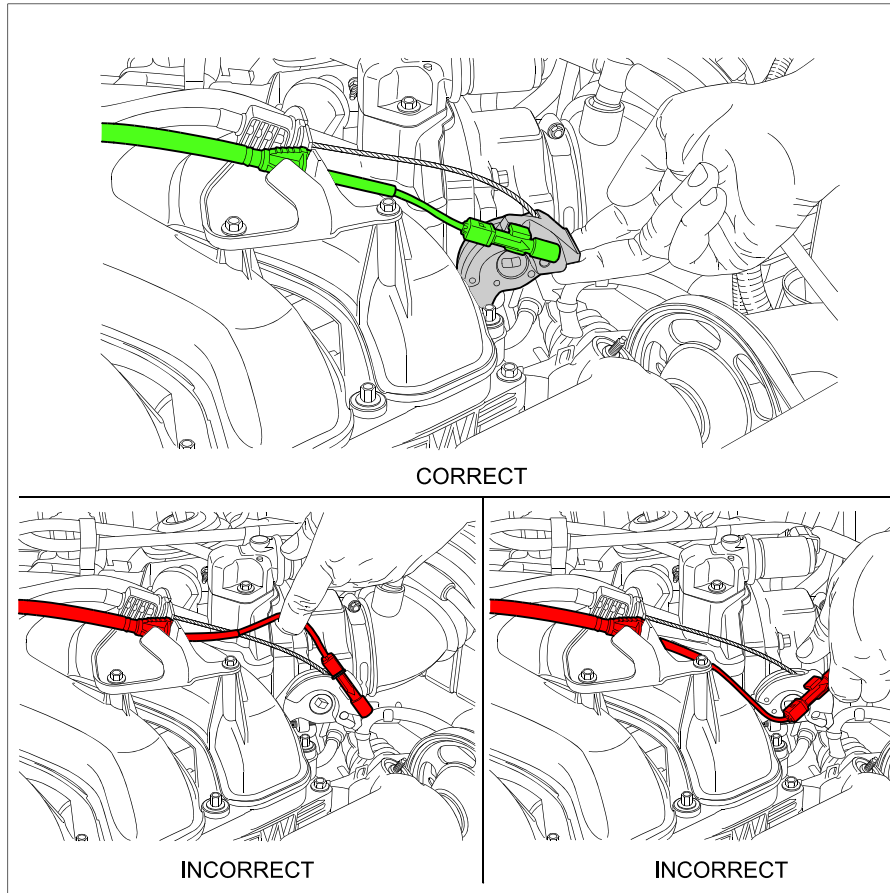

3. Disconnect the accelerator cable as follows.

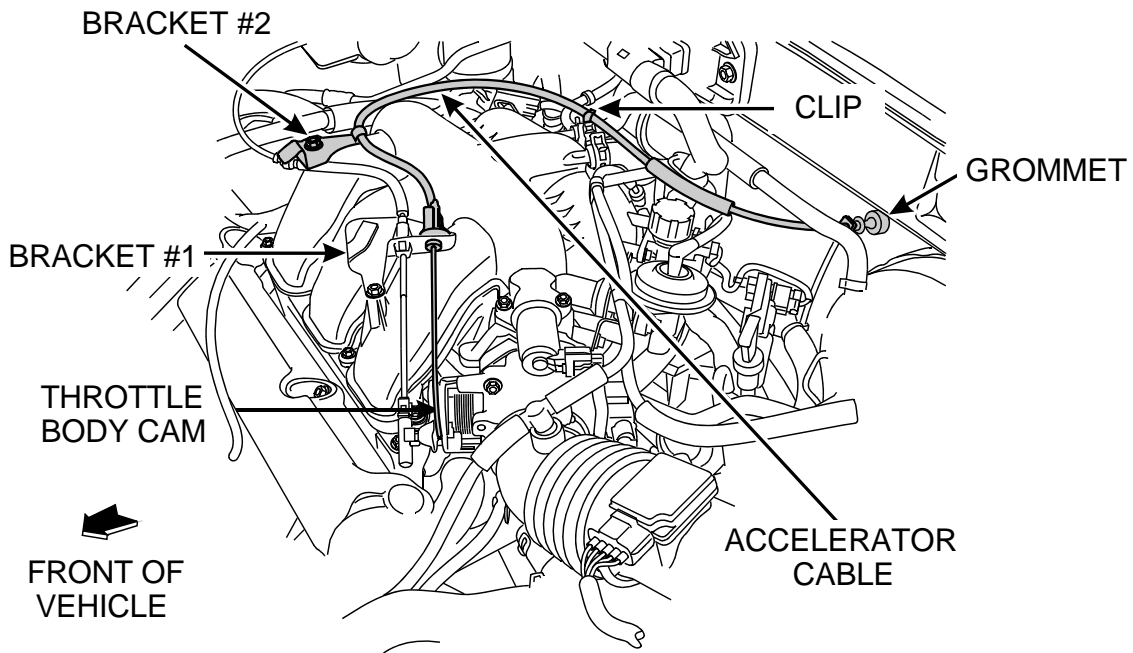

1001a

- a. Disconnect the cable by rotating the throttle body cam and sliding the cable barrel out of the cam.
- b. Remove the accelerator cable from bracket #1 by turning the cable housing 45 degrees either way and pulling it from the bracket.
- c. Open bracket #2 with a screwdriver and remove the accelerator cable from the bracket.

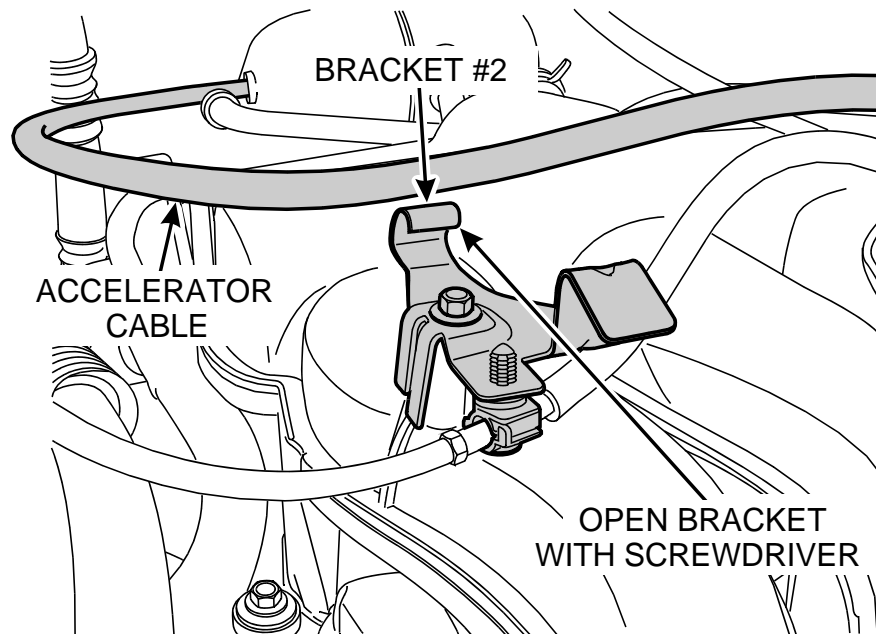

1001b

- d. Detach the accelerator cable from the clip located on the brake booster vacuum hose.
- e. Disengage the grommet at the dash panel and remove the accelerator cable from the vehicle.

INSTALLATION

1. Feed the **new** cable through the dash panel and fully seat the grommet.
2. Install and connect the accelerator cable as follows.

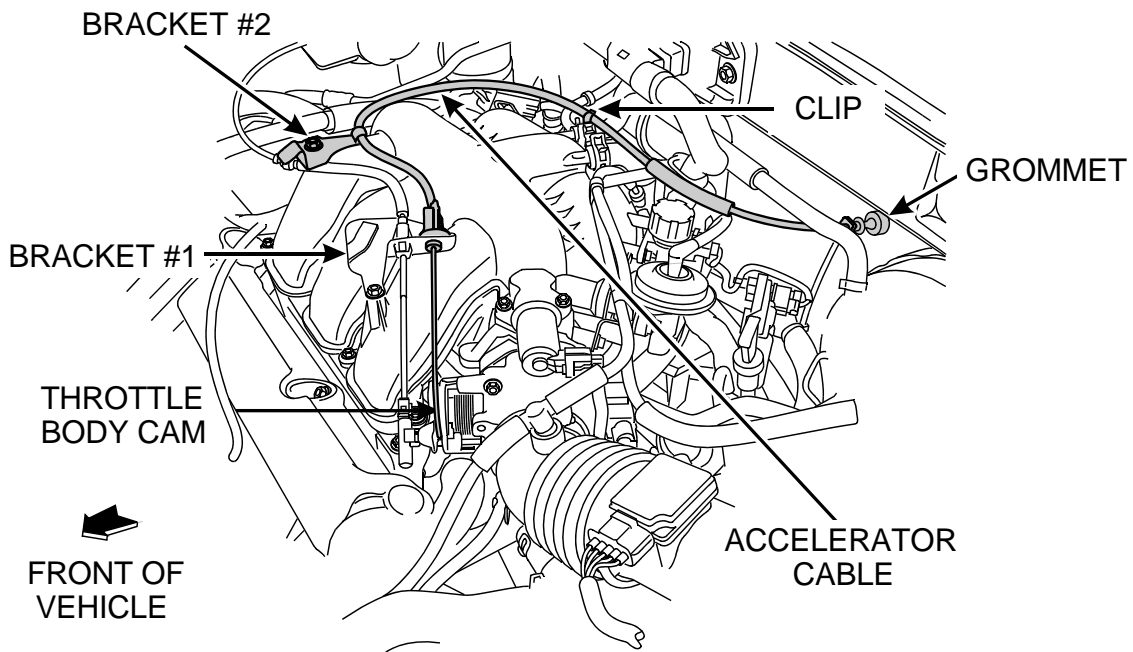

- a. Connect the cable to the throttle body by rotating the cam and sliding the cable barrel into the cam.
- b. Attach the accelerator cable to the clip located on the brake booster vacuum hose.
- c. Secure the accelerator cable to the bracket #1 by inserting it and rotating the cable housing 45 degrees to lock it in place.
- d. Position the accelerator cable in bracket #2 and, using a suitable tool, bend down the tab to retain the cable while ensuring the cable moves freely in the bracket.

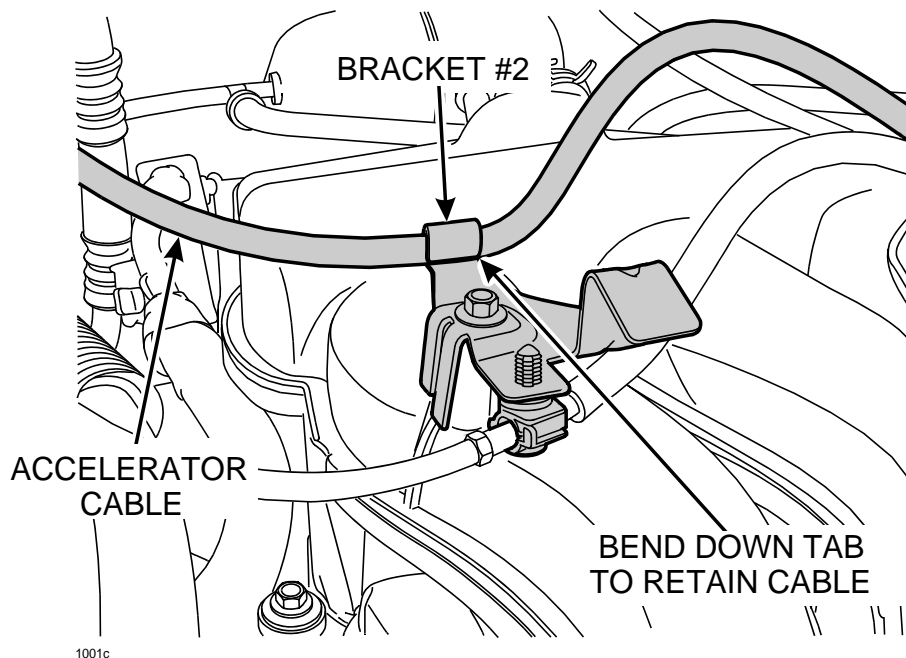

3. Connect the accelerator cable to the pedal.
 - a. Position the plunger rearward and install the accelerator cable into the pedal.

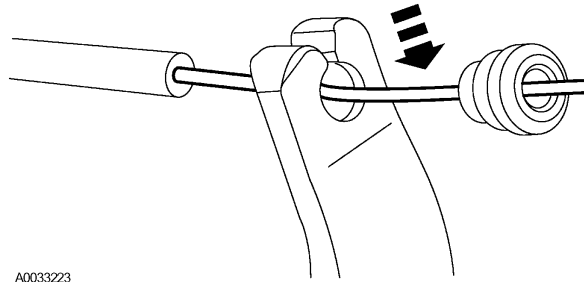

A0033223

- b. Install the rubber plunger ensuring the plunger is seated properly.

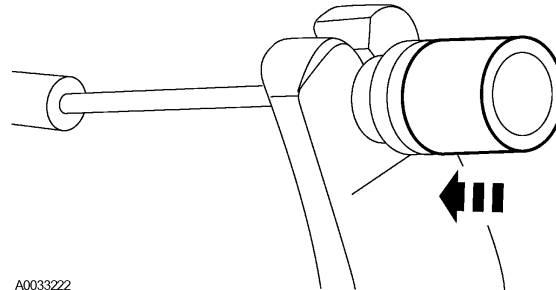

A0033222

4. Install the appearance cover.
5. Check for free movement of the accelerator pedal and that there is no binding.

C. AUTHORIZED MODIFICATION LABEL INSTALLATION

Complete an "Authorized Modification Label" with the Recall number written on the sticker and affix it to the vehicle's hood. Refer back to the illustration under "A. VEHICLE INSPECTION PROCEDURE".