

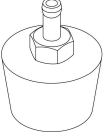

## STANDARD PROCEDURE - POWER STEERING SYSTEM BLEEDING

 **Special Tools:** Click to display a list of tools used in this procedure

[Click here to launch the form to order any tools you need.](#)

	<p><a href="#">9688A - Cap Adapter, Power Steering Pump</a></p> <p>Originally Shipped In Kit Number(s) <i>10075A-DOD, 10075-CHRYSLER, 10075-DODGE.</i></p>
	<p><a href="#">C-4207-A - Vacuum Pump, Hand</a></p>

**WARNING:** The fluid level should be checked with engine off to prevent injury from moving components.

**CAUTION:** Mopar® Power Steering Fluid + 4 or Mopar® ATF+4 Automatic Transmission Fluid is to be used in the power steering system. Both Fluids have the same material standard specifications (MS-9602). No other power steering or automatic transmission fluid is to be used in the system. Damage may result to the power steering pump and system if another fluid is used. Do not overfill the system.

**CAUTION:** If the air is not purged from the power steering system correctly, pump failure could result.

**NOTE:** Be sure the vacuum tool used in the following procedure is clean and free of any fluids.

1. Check the fluid level. As measured on the side of the reservoir, the level should indicate between MAX and MIN when the fluid is at normal ambient temperature. Adjust the fluid level as necessary. ([Refer to 19 - Steering/Pump/FLUID - Standard Procedure](#))

2. Tightly insert Power Steering Cap Adapter (4), Special Tool [9688A](#), into the mouth of the reservoir (3).

**CAUTION:** Failure to use a vacuum pump reservoir (1) may allow power steering fluid to be sucked into the hand vacuum pump.

3. Attach Hand Vacuum Pump (2), Special Tool [C-4207-A](#) or equivalent, with reservoir (1) attached, to the Power Steering Cap Adapter (4).

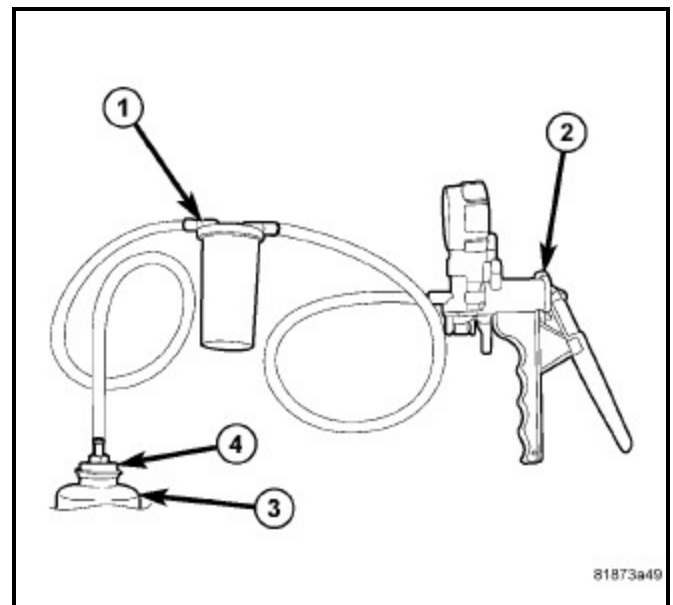

**CAUTION:** Do not run the engine while vacuum is applied to the power steering system. Damage to the power steering pump can occur.

**NOTE:** When performing the following step make sure the vacuum level is maintained during the entire time period.

4. Using Hand Vacuum Pump (2), apply 68-85 kPa (20-25 in. Hg) of vacuum to the system for a minimum of three minutes.
5. Slowly release the vacuum and remove the special tools.
6. Adjust the fluid level as necessary. Refer to [Step #1](#).
7. Repeat [Step #1](#) through [Step #6](#) until the fluid no longer drops when vacuum is applied.
8. Start the engine and cycle the steering wheel lock-to-lock three times.

**NOTE:** Do not hold the steering wheel at the stops.

9. Stop the engine and check for leaks at all connections.
10. Check for any signs of air in the reservoir and check the fluid level. If air is present, repeat the procedure as necessary.